



DATE DESPRE IMOBILUL NR. 5004

Oficiul de Cadastru și Publicitate Imobiliară TULCEA
Biroul de Cadastru și Publicitate Imobiliară Tulcea

A. Partea I. Descrierea imobilului

TEREN Extravilan

Nr. CF vechi:850
Nr. cadastral vechi:649

Adresa: Jud. Tulcea

Nr. Crt	Nr cadastral Nr. topografic	Suprafața* (mp)	Observații / Referințe
A1	30348	16.250.000	Sector cadastral:40 Teren neimprejmuit;

B. Partea II. Proprietari și acte

Inscrieri privitoare la dreptul de proprietate și alte drepturi reale		Referințe
32955 / 20/12/2007		
Act Normativ nr. 82 din 1993, din 20/11/1993 emis de Parlamentul Romaniei (legea nr. 213 din 1998, legea nr. 454 din 2001, h.g. nr. 248 din 1994, h.g. nr. 367 din 2002. h.g. nr. 1705 din 2006, anexa nr. 12);		
B1	Intabulare, drept de PROPRIETATE, dobandit prin Lege, cota actuala 1/1, cota initiala 1/1 1) STATUL ROMAN, CIF:9999999999999 OBSERVATII: (provenita din conversia CF 850)	A1
B2	Intabulare, drept de ADMINISTRARE, dobandit prin Lege, cota actuala 1/1, cota initiala 1/1 1) ADMINISTRATIA REZERVATIEI BIOSFEREI DELTA DUNARII, CIF:3722040 OBSERVATII: (provenita din conversia CF 850)	A1

C. Partea III. SARCINI .

Inscrieri privind dezmembramintele dreptului de proprietate, drepturi reale de garanție și sarcini	Referințe
NU SUNT	

Anexa Nr. 1 La Partea I

Teren

Nr cadastral	Suprafața (mp)*	Observații / Referințe
30348	16.250.000	

* Suprafața este determinată în planul de proiecție Stereo 70.

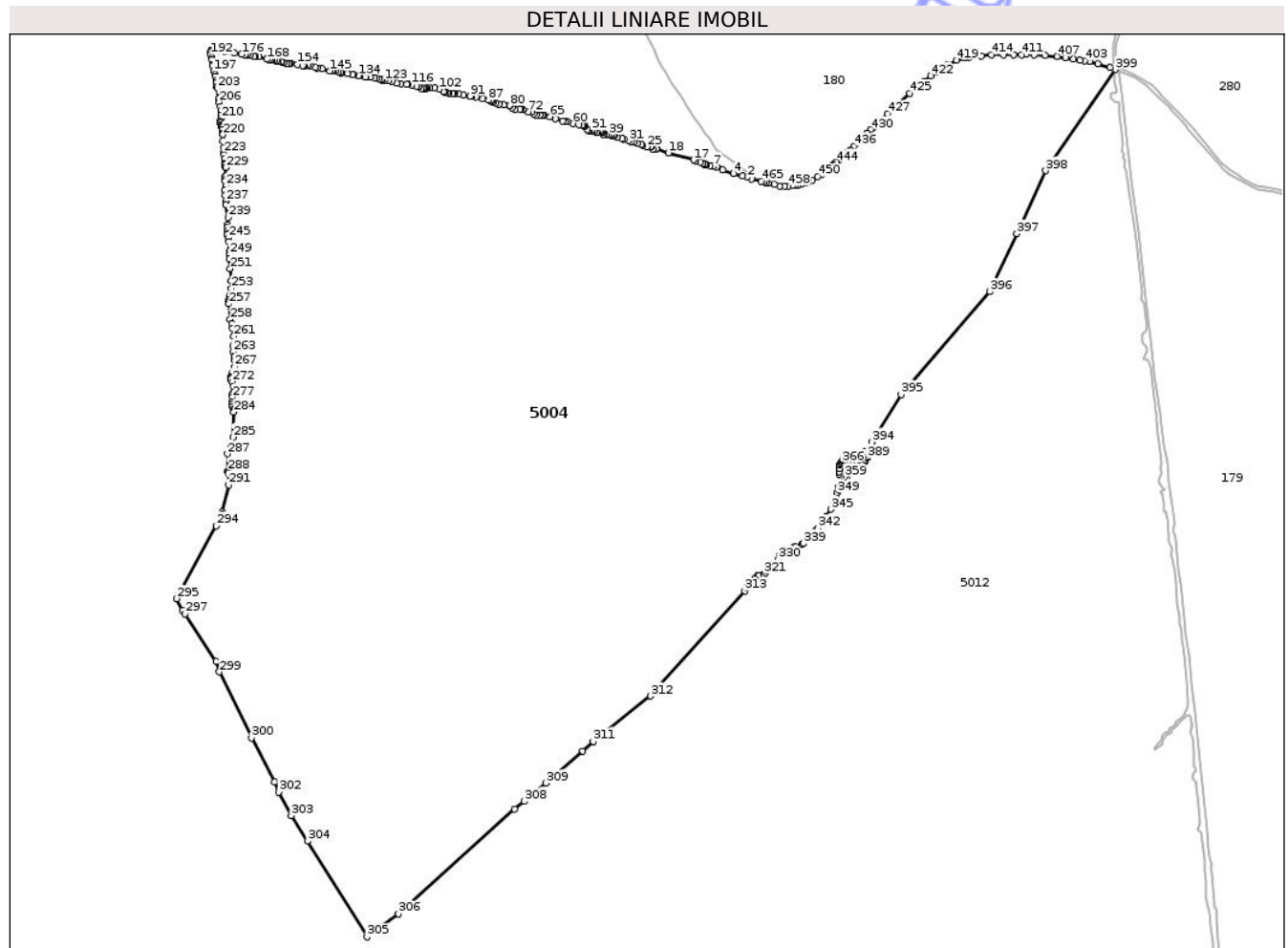

Date referitoare la teren

Crt	Categorie folosință	Intra vilan	Suprafața (mp)	Tarla	Parcelă	Nr. topo	Observații / Referințe
1	altele	NU	2.706.640	9	166	-	HS
2	altele	NU	11.349	9	167	-	HR
3	altele	NU	37.436	9	168	-	HB
4	altele	NU	19.403	9	169	-	HR
5	altele	NU	2.573	9	170	-	HB
6	altele	NU	432.894	9	171	-	HB
7	altele	NU	10.681.616	9	172	-	HS
8	altele	NU	2.833	9	173	-	HB
9	altele	NU	10.228	9	174	-	HB
10	altele	NU	2.804	9	175	-	HB
11	altele	NU	3.011	9	176	-	HB
12	altele	NU	12.049	9	177	-	HB
13	altele	NU	4.246	9	178	-	HB
14	altele	NU	5.127	9	179	-	HB
15	altele	NU	106.781	9	180	-	HB
16	altele	NU	9.372	9	181	-	HB

Crt	Categorie folosință	Intravilan	Suprafața (mp)	Tarla	Parcelă	Nr. topo	Observații / Referințe
17	altele	NU	78.753	9	182	-	HB
18	altele	NU	14.936	9	183	-	HS
19	altele	NU	3.700	9	184	-	HB
20	altele	NU	4.635	9	185	-	HB
21	altele	NU	11.205	9	186	-	HB
22	altele	NU	10.545	9	187	-	HB
23	altele	NU	7.066	9	188	-	HB
24	altele	NU	6.360	9	189	-	HB
25	altele	NU	5.351	9	190	-	HB
26	altele	NU	3.157	9	191	-	HB
27	altele	NU	3.973	9	192	-	HB
28	altele	NU	9.482	9	193	-	HB
29	altele	NU	14.170	9	194	-	HB
30	altele	NU	2.657	9	195	-	HB
31	altele	NU	76.581	9	196	-	HB
32	altele	NU	6.983	9	197	-	HB
33	altele	NU	60.698	9	198	-	HB
34	altele	NU	1.084.163	9	199	-	HB
35	altele	NU	15.487	9	200	-	HS
36	altele	NU	5.126	9	201	-	HS
37	altele	NU	3.581	9	202	-	HB
38	altele	NU	26.792	9	203	-	HB
39	altele	NU	7.383	9	204	-	HB
40	altele	NU	3.769	9	205	-	HS
41	altele	NU	34.705	9	206	-	HB
42	altele	NU	4.477	9	207	-	HR
43	altele	NU	17.242	9	208	-	HB
44	altele	NU	5.118	9	209	-	HB
45	altele	NU	4.764	9	210	-	HR
46	altele	NU	79.442	9	211	-	HB
47	altele	NU	1.703	9	212	-	HR
48	altele	NU	1.495	9	213	-	HS
49	altele	NU	3.419	9	214	-	HR
50	altele	NU	579.800	9	215	-	HS
51	padure	NU	2.920	9	216	-	

Lungime Segmente

1) Valorile lungimilor segmentelor sunt obținute din proiecție în plan.

Punct început	X / Y	Punct sfârșit	X / Y	Lungime segment	Punct început	X / Y	Punct sfârșit	X / Y	Lungime segment	Punct început	X / Y	Punct sfârșit	X / Y	Lungime segment
1	859.167,608 412.756,018	2	859.143,125 412.767,313	26.96 3	2	859.143,125 412.767,313	3	859.113,375 412.775,438	30.84	3	859.113,375 412.775,438	4	859.060,188 412.791,656	55.60 5
4	859.060,188 412.791,656	5	858.995,313 412.813,282	68.38 5	5	858.995,313 412.813,282	6	858.957,438 412.828,625	40.86 5	6	858.957,438 412.828,625	7	858.937,872 412.832,622	19.97
7	858.937,872 412.832,622	8	858.917,813 412.836,719	20.47 3	8	858.917,813 412.836,719	9	858.897,083 412.839,802	20.95 8	9	858.897,083 412.839,802	10	858.893,438 412.840,344	3.685

Punct început	X / Y	Punct sfârșit	X / Y	Lungime segment	Punct început	X / Y	Punct sfârșit	X / Y	Lungime segment	Punct început	X / Y	Punct sfârșit	X / Y	Lungime segment
10	858.893,438 412.840,344	11	858.892,287 412.841,378	1.547	11	858.892,287 412.841,378	12	858.891,002 412.842,535	1.729	12	858.891,002 412.842,535	13	858.884,438 412.848,438	8.828
13	858.884,438 412.848,438	14	858.875,438 412.852,063	9.703	14	858.875,438 412.852,063	15	858.859,188 412.861,063	18.576	15	858.859,188 412.861,063	16	858.833,063 412.868,282	27.104
16	858.833,063 412.868,282	17	858.819,563 412.872,781	14.23	17	858.819,563 412.872,781	18	858.667,875 412.915,313	157.538	18	858.667,875 412.915,313	19	858.597,125 412.939,344	74.72
19	858.597,125 412.939,344	20	858.594,872 412.938,869	2.303	20	858.594,872 412.938,869	21	858.572,5 412.934,157	22.863	21	858.572,5 412.934,157	22	858.559,632 412.950,21	20.574
22	858.559,632 412.950,21	23	858.559,5 412.950,375	0.211	23	858.559,5 412.950,375	24	858.559,079 412.950,389	0.421	24	858.559,079 412.950,389	25	858.538,75 412.951,031	20.339
25	858.538,75 412.951,031	26	858.512,938 412.961,125	27.715	26	858.512,938 412.961,125	27	858.505,688 412.964,094	7.834	27	858.505,688 412.964,094	28	858.479,438 412.972,938	27.7
28	858.479,438 412.972,938	29	858.462,25 412.979,969	18.57	29	858.462,25 412.979,969	30	858.445,438 412.980,75	16.83	30	858.445,438 412.980,75	31	858.429,0 412.988,969	18.378
31	858.429,0 412.988,969	32	858.398,438 412.996,813	31.553	32	858.398,438 412.996,813	33	858.391,063 413.000,313	8.163	33	858.391,063 413.000,313	34	858.362,063 413.008,156	30.042
34	858.362,063 413.008,156	35	858.342,5 413.017,938	21.872	35	858.342,5 413.017,938	36	858.335,063 413.018,313	7.446	36	858.335,063 413.018,313	37	858.325,313 413.019,875	9.874
37	858.325,313 413.019,875	38	858.319,813 413.023,782	6.746	38	858.319,813 413.023,782	39	858.310,063 413.023,406	9.757	39	858.310,063 413.023,406	40	858.295,188 413.021,438	15.005
40	858.295,188 413.021,438	41	858.282,25 413.021,844	12.944	41	858.282,25 413.021,844	42	858.277,938 413.027,719	7.288	42	858.277,938 413.027,719	43	858.274,813 413.037,094	9.882
43	858.274,813 413.037,094	44	858.267,375 413.039,063	7.694	44	858.267,375 413.039,063	45	858.265,063 413.042,969	4.539	45	858.265,063 413.042,969	46	858.256,813 413.043,75	8.287
46	858.256,813 413.043,75	47	858.240,813 413.037,5	17.177	47	858.240,813 413.037,5	48	858.234,125 413.037,5	6.688	48	858.234,125 413.037,5	49	858.217,313 413.042,969	17.679
49	858.217,313 413.042,969	50	858.209,5 413.043,344	7.822	50	858.209,5 413.043,344	51	858.202,813 413.048,063	8.184	51	858.202,813 413.048,063	52	858.193,438 413.051,188	9.882
52	858.193,438 413.051,188	53	858.186,0 413.048,438	7.93	53	858.186,0 413.048,438	54	858.177,813 413.054,313	10.077	54	858.177,813 413.054,313	55	858.165,313 413.075,844	24.896
55	858.165,313 413.075,844	56	858.160,439 413.078,367	5.488	56	858.160,439 413.078,367	57	858.154,75 413.081,313	6.407	57	858.154,75 413.081,313	58	858.147,082 413.081,798	7.683
58	858.147,082 413.081,798	59	858.130,063 413.082,875	17.053	59	858.130,063 413.082,875	60	858.092,5 413.089,906	38.215	60	858.092,5 413.089,906	61	858.060,063 413.100,469	34.114
61	858.060,063 413.100,469	62	858.046,75 413.103,219	13.594	62	858.046,75 413.103,219	63	858.029,938 413.105,969	17.035	63	858.029,938 413.105,969	64	857.988,813 413.119,25	43.216
64	857.988,813 413.119,25	65	857.953,25 413.132,563	37.973	65	857.953,25 413.132,563	66	857.919,188 413.142,344	35.439	66	857.919,188 413.142,344	67	857.907,438 413.143,531	11.81
67	857.907,438 413.143,531	68	857.893,375 413.142,344	14.113	68	857.893,375 413.142,344	69	857.871,063 413.142,344	22.312	69	857.871,063 413.142,344	70	857.855,438 413.150,938	17.832
70	857.855,438 413.150,938	71	857.846,0 413.159,563	12.785	71	857.846,0 413.159,563	72	857.824,125 413.159,563	21.875	72	857.824,125 413.159,563	73	857.790,438 413.174,032	36.663
73	857.790,438 413.174,032	74	857.778,75 413.179,125	12.749	74	857.778,75 413.179,125	75	857.772,875 413.177,938	5.994	75	857.772,875 413.177,938	76	857.745,5 413.176,0	27.444
76	857.745,5 413.176,0	77	857.727,875 413.186,156	20.342	77	857.727,875 413.186,156	78	857.712,668 413.199,026	19.922	78	857.712,668 413.199,026	79	857.712,625 413.199,063	0.057
79	857.712,625 413.199,063	80	857.712,427 413.199,08	0.199	80	857.712,427 413.199,08	81	857.676,625 413.202,219	35.939	81	857.676,625 413.202,219	82	857.647,25 413.208,844	30.113
82	857.647,25 413.208,844	83	857.626,938 413.214,719	21.145	83	857.626,938 413.214,719	84	857.610,5 413.218,25	16.813	84	857.610,5 413.218,25	85	857.601,615 413.223,74	10.444
85	857.601,615 413.223,74	86	857.594,063 413.228,407	8.878	86	857.594,063 413.228,407	87	857.583,5 413.231,938	11.138	87	857.583,5 413.231,938	88	857.550,25 413.238,594	33.91
88	857.550,25 413.238,594	89	857.508,75 413.249,531	42.917	89	857.508,75 413.249,531	90	857.482,563 413.254,625	26.678	90	857.482,563 413.254,625	91	857.473,938 413.255,813	8.706
91	857.473,938 413.255,813	92	857.434,438 413.262,844	40.121	92	857.434,438 413.262,844	93	857.404,688 413.269,5	30.485	93	857.404,688 413.269,5	94	857.379,688 413.273,813	25.369
94	857.379,688 413.273,813	95	857.374,078 413.273,067	5.659	95	857.374,078 413.273,067	96	857.367,938 413.272,25	6.194	96	857.367,938 413.272,25	97	857.347,188 413.271,469	20.765
97	857.347,188 413.271,469	98	857.334,25 413.276,157	13.761	98	857.334,25 413.276,157	99	857.324,5 413.275,375	9.781	99	857.324,5 413.275,375	100	857.315,426 413.283,153	11.951
100	857.315,426 413.283,153	101	857.313,563 413.284,75	2.454	101	857.313,563 413.284,75	102	857.287,688 413.297,282	28.75	102	857.287,688 413.297,282	103	857.257,563 413.303,532	30.767
103	857.257,563 413.303,532	104	857.228,625 413.306,282	29.068	104	857.228,625 413.306,282	105	857.215,75 413.304,313	13.025	105	857.215,75 413.304,313	106	857.206,06 413.303,171	9.757
106	857.206,06 413.303,171	107	857.205,938 413.303,156	0.123	107	857.205,938 413.303,156	108	857.205,742 413.303,233	0.211	108	857.205,742 413.303,233	109	857.196,938 413.306,656	9.446

Punct început	X / Y	Punct sfârșit	X / Y	Lungime segment	Punct început	X / Y	Punct sfârșit	X / Y	Lungime segment	Punct început	X / Y	Punct sfârșit	X / Y	Lungime segment
109	857.196,938 413.306,656	110	857.193,338 413.305,622	3.746	110	857.193,338 413.305,622	111	857.191,5 413.305,094	1.912	111	857.191,5 413.305,094	112	857.178,938 413.303,156	12.711
112	857.178,938 413.303,156	113	857.164,385 413.311,2	16.628	113	857.164,385 413.311,2	114	857.160,563 413.313,313	4.367	114	857.160,563 413.313,313	115	857.151,188 413.316,438	9.882
115	857.151,188 413.316,438	116	857.122,238 413.323,631	29.83	116	857.122,238 413.323,631	117	857.099,893 413.325,565	22.429	117	857.099,893 413.325,565	118	857.090,439 413.326,209	9.476
118	857.090,439 413.326,209	119	857.056,599 413.329,486	33.998	119	857.056,599 413.329,486	120	857.029,205 413.335,233	27.99	120	857.029,205 413.335,233	121	857.001,811 413.343,72	28.679
121	857.001,811 413.343,72	122	856.978,177 413.347,749	23.975	122	856.978,177 413.347,749	123	856.957,873 413.350,703	20.518	123	856.957,873 413.350,703	124	856.943,477 413.353,84	14.734
124	856.943,477 413.353,84	125	856.940,688 413.354,781	2.943	125	856.940,688 413.354,781	126	856.926,188 413.359,875	15.369	126	856.926,188 413.359,875	127	856.912,125 413.363,0	14.406
127	856.912,125 413.363,0	128	856.897,625 413.366,125	14.833	128	856.897,625 413.366,125	129	856.870,625 413.369,282	27.184	129	856.870,625 413.369,282	130	856.845,188 413.372,407	25.628
130	856.845,188 413.372,407	131	856.841,097 413.371,6	4.17	131	856.841,097 413.371,6	132	856.805,144 413.378,155	36.546	132	856.805,144 413.378,155	133	856.803,375 413.379,063	1.988
133	856.803,375 413.379,063	134	856.800,826 413.378,943	2.552	134	856.800,826 413.378,943	135	856.768,535 413.384,83	32.823	135	856.768,535 413.384,83	136	856.767,375 413.385,688	1.443
136	856.767,375 413.385,688	137	856.765,948 413.385,302	1.478	137	856.765,948 413.385,302	138	856.733,313 413.391,188	33.162	138	856.733,313 413.391,188	139	856.697,393 413.397,408	36.455
139	856.697,393 413.397,408	140	856.691,875 413.399,406	5.869	140	856.691,875 413.399,406	141	856.678,938 413.401,344	13.081	141	856.678,938 413.401,344	142	856.659,75 413.404,875	19.51
142	856.659,75 413.404,875	143	856.646,438 413.408,0	13.674	143	856.646,438 413.408,0	144	856.638,482 413.407,838	7.958	144	856.638,482 413.407,838	145	856.626,5 413.407,594	11.984
145	856.626,5 413.407,594	146	856.579,938 413.420,125	48.219	146	856.579,938 413.420,125	147	856.552,563 413.424,813	27.774	147	856.552,563 413.424,813	148	856.542,0 413.428,75	11.273
148	856.542,0 413.428,75	149	856.507,938 413.437,75	35.231	149	856.507,938 413.437,75	150	856.493,5 413.441,25	14.856	150	856.493,5 413.441,25	151	856.476,688 413.436,938	17.356
151	856.476,688 413.436,938	152	856.470,813 413.439,688	6.487	152	856.470,813 413.439,688	153	856.464,563 413.440,094	6.263	153	856.464,563 413.440,094	154	856.433,625 413.447,125	31.727
154	856.433,625 413.447,125	155	856.394,125 413.452,219	39.827	155	856.394,125 413.452,219	156	856.384,733 413.449,951	9.662	156	856.384,733 413.449,951	157	856.381,188 413.449,094	3.647
157	856.381,188 413.449,094	158	856.365,938 413.450,657	15.33	158	856.365,938 413.450,657	159	856.349,875 413.455,719	16.842	159	856.349,875 413.455,719	160	856.340,06 413.460,061	10.733
160	856.340,06 413.460,061	161	856.333,063 413.463,157	7.651	161	856.333,063 413.463,157	162	856.315,73 413.465,568	17.5	162	856.315,73 413.465,568	163	856.305,688 413.469,813	10.902
163	856.305,688 413.469,813	164	856.295,262 413.470,2	10.433	164	856.295,262 413.470,2	165	856.281,313 413.470,719	13.959	165	856.281,313 413.470,719	166	856.274,0 413.471,0	7.318
166	856.274,0 413.471,0	167	856.261,382 413.474,424	13.074	167	856.261,382 413.474,424	168	856.249,12 413.477,751	12.705	168	856.249,12 413.477,751	169	856.199,875 413.493,938	51.837
169	856.199,875 413.493,938	170	856.178,0 413.494,407	21.88	170	856.178,0 413.494,407	171	856.171,653 413.493,904	6.367	171	856.171,653 413.493,904	172	856.145,125 413.500,344	27.299
172	856.145,125 413.500,344	173	856.130,5 413.503,094	14.881	173	856.130,5 413.503,094	174	856.120,0 413.504,0	10.539	174	856.120,0 413.504,0	175	856.117,31 413.503,457	2.744
175	856.117,31 413.503,457	176	856.096,587 413.508,506	21.329	176	856.096,587 413.508,506	177	856.053,375 413.516,313	43.912	177	856.053,375 413.516,313	178	855.992,914 413.522,032	60.731
178	855.992,914 413.522,032	179	855.987,188 413.522,25	5.73	179	855.987,188 413.522,25	180	855.978,063 413.524,063	9.303	180	855.978,063 413.524,063	181	855.973,5 413.524,063	4.563
181	855.973,5 413.524,063	182	855.965,25 413.529,563	9.915	182	855.965,25 413.529,563	183	855.959,083 413.531,271	6.399	183	855.959,083 413.531,271	184	855.943,813 413.535,5	15.845
184	855.943,813 413.535,5	185	855.934,563 413.536,594	9.314	185	855.934,563 413.536,594	186	855.924,625 413.537,782	10.009	186	855.924,625 413.537,782	187	855.924,076 413.537,424	0.655
187	855.924,076 413.537,424	188	855.919,291 413.534,311	5.709	188	855.919,291 413.534,311	189	855.915,5 413.531,844	4.523	189	855.915,5 413.531,844	190	855.910,75 413.522,688	10.315
190	855.910,75 413.522,688	191	855.910,688 413.519,5	3.189	191	855.910,688 413.519,5	192	855.910,5 413.505,813	13.688	192	855.910,5 413.505,813	193	855.916,438 413.485,719	20.953
193	855.916,438 413.485,719	194	855.916,875 413.473,875	11.852	194	855.916,875 413.473,875	195	855.921,875 413.446,469	27.858	195	855.921,875 413.446,469	196	855.922,375 413.437,813	8.67
196	855.922,375 413.437,813	197	855.928,25 413.404,938	33.396	197	855.928,25 413.404,938	198	855.936,938 413.385,313	21.462	198	855.936,938 413.385,313	199	855.940,625 413.373,0	12.853
199	855.940,625 413.373,0	200	855.943,313 413.353,813	19.374	200	855.943,313 413.353,813	201	855.944,25 413.338,281	15.56	201	855.944,25 413.338,281	202	855.946,563 413.313,188	25.199
202	855.946,563 413.313,188	203	855.951,563 413.303,594	10.819	203	855.951,563 413.303,594	204	855.957,452 413.239,594	64.27	204	855.957,452 413.239,594	205	855.957,063 413.231,469	8.134
205	855.957,063 413.231,469	206	855.961,125 413.219,625	12.521	206	855.961,125 413.219,625	207	855.968,438 413.192,688	27.912	207	855.968,438 413.192,688	208	855.972,125 413.165,75	27.189

Punct început	X / Y	Punct sfârșit	X / Y	Lungime segment	Punct început	X / Y	Punct sfârșit	X / Y	Lungime segment	Punct început	X / Y	Punct sfârșit	X / Y	Lungime segment
208	855.972,125 413.165,75	209	855.973,938 413.140,188	25.626	209	855.973,938 413.140,188	210	855.974,375 413.122,844	17.35	210	855.974,375 413.122,844	211	855.969,375 413.106,406	17.182
211	855.969,375 413.106,406	212	855.967,563 413.095,0	11.549	212	855.967,563 413.095,0	213	855.970,75 413.084,5	10.973	213	855.970,75 413.084,5	214	855.976,688 413.077,656	9.061
214	855.976,688 413.077,656	215	855.977,125 413.069,875	7.793	215	855.977,125 413.069,875	216	855.980,313 413.065,782	5.188	216	855.980,313 413.065,782	217	855.982,125 413.054,375	11.55
217	855.982,125 413.054,375	218	855.980,75 413.032,906	21.513	218	855.980,75 413.032,906	219	855.981,688 413.027,907	5.086	219	855.981,688 413.027,907	220	855.984,438 413.024,688	4.234
220	855.984,438 413.024,688	221	855.984,438 412.986,344	38.344	221	855.984,438 412.986,344	222	855.989,875 412.946,657	40.058	222	855.989,875 412.946,657	223	855.987,188 412.915,594	31.179
223	855.987,188 412.915,594	224	855.990,813 412.901,907	14.159	224	855.990,813 412.901,907	225	855.993,563 412.878,625	23.444	225	855.993,563 412.878,625	226	855.993,125 412.853,063	25.566
226	855.993,125 412.853,063	227	855.994,0 412.841,657	11.44	227	855.994,0 412.841,657	228	855.997,625 412.831,75	10.549	228	855.997,625 412.831,75	229	856.000,063 412.826,813	5.506
229	856.000,063 412.826,813	230	856.000,313 412.774,563	52.251	230	856.000,313 412.774,563	231	855.995,688 412.767,688	8.286	231	855.995,688 412.767,688	232	855.996,875 412.757,375	10.381
232	855.996,875 412.757,375	233	855.998,0 412.745,907	11.523	233	855.998,0 412.745,907	234	856.001,438 412.713,813	32.278	234	856.001,438 412.713,813	235	855.995,688 412.687,469	26.964
235	855.995,688 412.687,469	236	855.996,875 412.659,938	27.557	236	855.996,875 412.659,938	237	856.000,313 412.624,407	35.697	237	856.000,313 412.624,407	238	856.000,313 412.602,625	21.782
238	856.000,313 412.602,625	239	856.016,313 412.525,844	78.43	239	856.016,313 412.525,844	240	856.014,063 412.482,281	43.621	240	856.014,063 412.482,281	241	856.012,875 412.466,219	16.106
241	856.012,875 412.466,219	242	856.011,75 412.444,469	21.779	242	856.011,75 412.444,469	243	856.010,625 412.428,407	16.101	243	856.010,625 412.428,407	244	856.008,313 412.421,532	7.253
244	856.008,313 412.421,532	245	856.018,625 412.402,032	22.059	245	856.018,625 412.402,032	246	856.020,938 412.379,125	23.023	246	856.020,938 412.379,125	247	856.023,188 412.324,094	55.077
247	856.023,188 412.324,094	248	856.022,784 412.307,238	16.861	248	856.022,784 412.307,238	249	856.022,656 412.301,881	5.359	249	856.022,656 412.301,881	250	856.022,063 412.277,094	24.794
250	856.022,063 412.277,094	251	856.027,813 412.217,5	59.871	251	856.027,813 412.217,5	252	856.034,688 412.145,281	72.546	252	856.034,688 412.145,281	253	856.035,813 412.099,438	45.857
253	856.035,813 412.099,438	254	856.026,625 412.059,313	41.164	254	856.026,625 412.059,313	255	856.018,625 412.028,375	31.956	255	856.018,625 412.028,375	256	856.015,188 412.016,906	11.973
256	856.015,188 412.016,906	257	856.020,938 412.006,594	11.807	257	856.020,938 412.006,594	258	856.027,813 411.912,594	94.251	258	856.027,813 411.912,594	259	856.036,696 411.886,938	27.15
259	856.036,696 411.886,938	260	856.041,732 411.860,417	26.995	260	856.041,732 411.860,417	261	856.049,789 411.811,403	49.672	261	856.049,789 411.811,403	262	856.044,418 411.755,339	56.321
262	856.044,418 411.755,339	263	856.043,41 411.716,732	38.62	263	856.043,41 411.716,732	264	856.050,75 411.687,938	29.715	264	856.050,75 411.687,938	265	856.052,375 411.681,0	7.126
265	856.052,375 411.681,0	266	856.056,125 411.665,282	16.159	266	856.056,125 411.665,282	267	856.054,563 411.627,156	38.158	267	856.054,563 411.627,156	268	856.038,875 411.585,625	44.395
268	856.038,875 411.585,625	269	856.029,875 411.565,438	22.102	269	856.029,875 411.565,438	270	856.029,875 411.556,469	8.969	270	856.029,875 411.556,469	271	856.032,125 411.549,719	7.115
271	856.032,125 411.549,719	272	856.039,938 411.537,375	14.609	272	856.039,938 411.537,375	273	856.048,366 411.511,557	27.159	273	856.048,366 411.511,557	274	856.050,944 411.484,7	26.98
274	856.050,944 411.484,7	275	856.043,197 411.470,474	16.199	275	856.043,197 411.470,474	276	856.042,39 411.461,084	9.425	276	856.042,39 411.461,084	277	856.042,188 411.444,25	16.835
277	856.042,188 411.444,25	278	856.036,625 411.413,969	30.788	278	856.036,625 411.413,969	279	856.037,75 411.401,625	12.395	279	856.037,75 411.401,625	280	856.042,188 411.388,156	14.181
280	856.042,188 411.388,156	281	856.048,563 411.374,125	15.411	281	856.048,563 411.374,125	282	856.050,375 411.370,156	4.363	282	856.050,375 411.370,156	283	856.050,5 411.366,438	3.72
283	856.050,5 411.366,438	284	856.049,01 411.354,283	12.246	284	856.049,01 411.354,283	285	856.045,72 411.203,306	151.013	285	856.045,72 411.203,306	286	856.029,27 411.151,186	54.654
286	856.029,27 411.151,186	287	856.012,384 411.103,929	50.183	287	856.012,384 411.103,929	288	856.013,938 411.001,25	102.691	288	856.013,938 411.001,25	289	856.015,063 410.991,375	9.939
289	856.015,063 410.991,375	290	856.015,375 410.988,406	2.985	290	856.015,375 410.988,406	291	856.018,36 410.915,768	72.699	291	856.018,36 410.915,768	292	855.978,913 410.752,947	167.531
292	855.978,913 410.752,947	293	855.975,137 410.744,135	9.587	293	855.975,137 410.744,135	294	855.942,375 410.671,563	79.624	294	855.942,375 410.671,563	295	855.705,829 410.231,989	499.179
295	855.705,829 410.231,989	296	855.742,236 410.161,673	79.182	296	855.742,236 410.161,673	297	855.755,664 410.140,271	25.266	297	855.755,664 410.140,271	298	855.942,25 409.854,156	341.579
298	855.942,25 409.854,156	299	855.962,518 409.791,457	65.894	299	855.962,518 409.791,457	300	856.155,914 409.394,963	441.146	300	856.155,914 409.394,963	301	856.296,169 409.130,177	299.638
301	856.296,169 409.130,177	302	856.318,681 409.067,646	66.46	302	856.318,681 409.067,646	303	856.396,22 408.927,575	160.101	303	856.396,22 408.927,575	304	856.493,769 408.772,498	183.207
304	856.493,769 408.772,498	305	856.851,948 408.197,209	677.68	305	856.851,948 408.197,209	306	857.041,543 408.335,278	234.541	306	857.041,543 408.335,278	307	857.739,834 408.966,235	941.125

Punct început	X / Y	Punct sfârșit	X / Y	Lungime segment	Punct început	X / Y	Punct sfârșit	X / Y	Lungime segment	Punct început	X / Y	Punct sfârșit	X / Y	Lungime segment
307	857.739,834 408.966,235	308	857.797,463 409.013,619	74.608	308	857.797,463 409.013,619	309	857.928,089 409.122,473	170.036	309	857.928,089 409.122,473	310	858.151,813 409.315,938	295.772
310	858.151,813 409.315,938	311	858.215,033 409.372,999	85.163	311	858.215,033 409.372,999	312	858.559,563 409.646,594	439.949	312	858.559,563 409.646,594	313	859.127,438 410.278,781	849.79
313	859.127,438 410.278,781	314	859.140,313 410.298,5	23.55	314	859.140,313 410.298,5	315	859.166,563 410.315,5	31.274	315	859.166,563 410.315,5	316	859.174,688 410.329,906	16.539
316	859.174,688 410.329,906	317	859.184,625 410.345,25	18.281	317	859.184,625 410.345,25	318	859.194,5 410.359,656	17.466	318	859.194,5 410.359,656	319	859.204,438 410.367,781	12.837
319	859.204,438 410.367,781	320	859.216,188 410.373,188	12.934	320	859.216,188 410.373,188	321	859.241,375 410.381,313	26.465	321	859.241,375 410.381,313	322	859.253,125 410.387,594	13.323
322	859.253,125 410.387,594	323	859.258,5 410.398,438	12.103	323	859.258,5 410.398,438	324	859.263,938 410.403,844	7.668	324	859.263,938 410.403,844	325	859.277,438 410.406,531	13.765
325	859.277,438 410.406,531	326	859.281,063 410.414,656	8.897	326	859.281,063 410.414,656	327	859.292,75 410.422,75	14.216	327	859.292,75 410.422,75	328	859.319,813 410.445,281	35.214
328	859.319,813 410.445,281	329	859.319,813 410.453,406	8.125	329	859.319,813 410.453,406	330	859.327,937 410.467,844	16.567	330	859.327,937 410.467,844	331	859.337,875 410.491,281	25.457
331	859.337,875 410.491,281	332	859.351,375 410.506,594	20.414	332	859.351,375 410.506,594	333	859.358,938 410.510,907	8.706	333	859.358,938 410.510,907	334	859.379,875 410.519,563	22.656
334	859.379,875 410.519,563	335	859.401,5 410.531,125	24.522	335	859.401,5 410.531,125	336	859.426,0 410.543,375	27.392	336	859.426,0 410.543,375	337	859.437,563 410.544,813	11.652
337	859.437,563 410.544,813	338	859.474,118 410.561,505	40.186	338	859.474,118 410.561,505	339	859.478,625 410.563,563	4.955	339	859.478,625 410.563,563	340	859.519,75 410.598,188	53.76
340	859.519,75 410.598,188	341	859.553,625 410.640,0	53.812	341	859.553,625 410.640,0	342	859.566,887 410.656,856	21.448	342	859.566,887 410.656,856	343	859.604,125 410.704,188	60.224
343	859.604,125 410.704,188	344	859.615,965 410.722,643	21.927	344	859.615,965 410.722,643	345	859.646,688 410.770,532	56.897	345	859.646,688 410.770,532	346	859.664,0 410.801,532	35.506
346	859.664,0 410.801,532	347	859.674,027 410.836,735	36.603	347	859.674,027 410.836,735	348	859.675,5 410.841,906	5.377	348	859.675,5 410.841,906	349	859.682,0 410.870,75	29.567
349	859.682,0 410.870,75	350	859.692,125 410.885,906	18.227	350	859.692,125 410.885,906	351	859.691,375 410.900,313	14.427	351	859.691,375 410.900,313	352	859.702,188 410.911,875	15.83
352	859.702,188 410.911,875	353	859.713,0 410.918,344	12.599	353	859.713,0 410.918,344	354	859.715,378 410.919,993	2.894	354	859.715,378 410.919,993	355	859.731,75 410.931,344	19.922
355	859.731,75 410.931,344	356	859.739,688 410.942,156	13.413	356	859.739,688 410.942,156	357	859.741,365 410.953,756	11.721	357	859.741,365 410.953,756	358	859.741,875 410.957,281	3.562
358	859.741,875 410.957,281	359	859.726,688 410.965,219	17.136	359	859.726,688 410.965,219	360	859.707,938 410.971,719	19.845	360	859.707,938 410.971,719	361	859.698,563 410.981,094	13.258
361	859.698,563 410.981,094	362	859.696,438 410.996,25	15.304	362	859.696,438 410.996,25	363	859.696,438 411.013,532	17.282	363	859.696,438 411.013,532	364	859.697,125 411.037,344	23.822
364	859.697,125 411.037,344	365	859.704,375 411.045,281	10.75	365	859.704,375 411.045,281	366	859.710,125 411.051,75	8.655	366	859.710,125 411.051,75	367	859.714,438 411.059,688	9.034
367	859.714,438 411.059,688	368	859.717,313 411.066,188	7.107	368	859.717,313 411.066,188	369	859.723,125 411.070,5	7.237	369	859.723,125 411.070,5	370	859.738,25 411.070,5	15.125
370	859.738,25 411.070,5	371	859.746,188 411.064,75	9.802	371	859.746,188 411.064,75	372	859.753,375 411.056,813	10.707	372	859.753,375 411.056,813	373	859.761,313 411.053,938	8.443
373	859.761,313 411.053,938	374	859.777,188 411.037,344	22.965	374	859.777,188 411.037,344	375	859.785,875 411.021,469	18.096	375	859.785,875 411.021,469	376	859.786,935 411.011,043	10.48
376	859.786,935 411.011,043	377	859.788,0 411.000,563	10.534	377	859.788,0 411.000,563	378	859.795,25 411.000,563	7.25	378	859.795,25 411.000,563	379	859.797,375 411.009,219	8.913
379	859.797,375 411.009,219	380	859.798,813 411.017,156	8.066	380	859.798,813 411.017,156	381	859.806,063 411.021,469	8.436	381	859.806,063 411.021,469	382	859.815,438 411.030,125	12.76
382	859.815,438 411.030,125	383	859.829,813 411.035,188	15.241	383	859.829,813 411.035,188	384	859.836,313 411.041,657	9.17	384	859.836,313 411.041,657	385	859.842,125 411.048,875	9.267
385	859.842,125 411.048,875	386	859.847,875 411.056,813	9.802	386	859.847,875 411.056,813	387	859.851,438 411.061,844	6.165	387	859.851,438 411.061,844	388	859.854,375 411.069,063	7.794
388	859.854,375 411.069,063	389	859.862,313 411.079,156	12.841	389	859.862,313 411.079,156	390	859.866,625 411.092,156	13.696	390	859.866,625 411.092,156	391	859.865,188 411.105,125	13.048
391	859.865,188 411.105,125	392	859.857,938 411.114,5	11.851	392	859.857,938 411.114,5	393	859.854,938 411.120,594	6.792	393	859.854,938 411.120,594	394	859.891,25 411.175,469	65.801
394	859.891,25 411.175,469	395	860.069,375 411.460,5	336.112	395	860.069,375 411.460,5	396	860.605,0 412.078,844	818.073	396	860.605,0 412.078,844	397	860.766,375 412.429,219	385.752
397	860.766,375 412.429,219	398	860.940,625 412.807,531	416.513	398	860.940,625 412.807,531	399	861.358,99 413.416,297	738.665	399	861.358,99 413.416,297	400	861.326,85 413.427,011	33.879
400	861.326,85 413.427,011	401	861.254,678 413.450,204	75.807	401	861.254,678 413.450,204	402	861.206,194 413.464,116	50.44	402	861.206,194 413.464,116	403	861.175,075 413.468,83	31.474
403	861.175,075 413.468,83	404	861.148,318 413.472,174	26.965	404	861.148,318 413.472,174	405	861.107,944 413.479,794	41.087	405	861.107,944 413.479,794	406	861.058,764 413.487,309	49.751

Punct început	X / Y	Punct sfârșit	X / Y	Lungime segment	Punct început	X / Y	Punct sfârșit	X / Y	Lungime segment	Punct început	X / Y	Punct sfârșit	X / Y	Lungime segment
406	861.058,764 413.487,309	407	861.008,301 413.495,127	51.065	407	861.008,301 413.495,127	408	860.937,574 413.501,691	71.031	408	860.937,574 413.501,691	409	860.871,308 413.503,912	66.303
409	860.871,308 413.503,912	410	860.825,253 413.506,525	46.129	410	860.825,253 413.506,525	411	860.793,57 413.506,199	31.685	411	860.793,57 413.506,199	412	860.747,254 413.506,044	46.316
412	860.747,254 413.506,044	413	860.685,586 413.505,417	61.671	413	860.685,586 413.505,417	414	860.612,254 413.504,246	73.341	414	860.612,254 413.504,246	415	860.553,08 413.498,608	59.442
415	860.553,08 413.498,608	416	860.498,82 413.492,65	54.586	416	860.498,82 413.492,65	417	860.478,543 413.489,723	20.487	417	860.478,543 413.489,723	418	860.453,994 413.485,752	24.868
418	860.453,994 413.485,752	419	860.404,5 413.472,469	51.245	419	860.404,5 413.472,469	420	860.348,73 413.444,163	62.542	420	860.348,73 413.444,163	421	860.283,885 413.403,859	76.35
421	860.283,885 413.403,859	422	860.246,467 413.376,893	46.122	422	860.246,467 413.376,893	423	860.207,13 413.345,335	50.431	423	860.207,13 413.345,335	424	860.154,151 413.298,301	70.845
424	860.154,151 413.298,301	425	860.120,443 413.272,693	42.332	425	860.120,443 413.272,693	426	860.051,083 413.211,777	92.312	426	860.051,083 413.211,777	427	859.987,064 413.149,848	89.071
427	859.987,064 413.149,848	428	859.921,492 413.086,048	91.488	428	859.921,492 413.086,048	429	859.900,086 413.066,515	28.979	429	859.900,086 413.066,515	430	859.887,075 413.054,107	17.979
430	859.887,075 413.054,107	431	859.864,231 413.031,697	32.001	431	859.864,231 413.031,697	432	859.846,036 413.015,73	24.208	432	859.846,036 413.015,73	433	859.829,125 412.997,214	25.076
433	859.829,125 412.997,214	434	859.814,688 412.982,75	20.436	434	859.814,688 412.982,75	435	859.806,836 412.974,282	11.548	435	859.806,836 412.974,282	436	859.784,938 412.953,0	30.536
436	859.784,938 412.953,0	437	859.762,232 412.931,069	31.568	437	859.762,232 412.931,069	438	859.751,187 412.921,236	14.788	438	859.751,187 412.921,236	439	859.741,628 412.912,633	12.86
439	859.741,628 412.912,633	440	859.727,821 412.901,181	17.938	440	859.727,821 412.901,181	441	859.717,119 412.891,227	14.616	441	859.717,119 412.891,227	442	859.707,74 412.883,04	12.45
442	859.707,74 412.883,04	443	859.692,087 412.869,393	20.767	443	859.692,087 412.869,393	444	859.679,886 412.858,423	16.407	444	859.679,886 412.858,423	445	859.662,778 412.843,079	22.981
445	859.662,778 412.843,079	446	859.651,092 412.833,421	15.16	446	859.651,092 412.833,421	447	859.631,949 412.817,715	24.762	447	859.631,949 412.817,715	448	859.618,738 412.806,51	17.323
448	859.618,738 412.806,51	449	859.593,084 412.787,178	32.122	449	859.593,084 412.787,178	450	859.568,467 412.771,525	29.172	450	859.568,467 412.771,525	451	859.535,41 412.752,105	38.339
451	859.535,41 412.752,105	452	859.513,461 412.742,359	24.015	452	859.513,461 412.742,359	453	859.492,875 412.733,969	22.23	453	859.492,875 412.733,969	454	859.470,264 412.727,391	23.548
454	859.470,264 412.727,391	455	859.447,688 412.722,266	23.15	455	859.447,688 412.722,266	456	859.432,977 412.719,681	14.936	456	859.432,977 412.719,681	457	859.416,25 412.717,75	16.838
457	859.416,25 412.717,75	458	859.389,082 412.714,561	27.355	458	859.389,082 412.714,561	459	859.367,865 412.713,308	21.254	459	859.367,865 412.713,308	460	859.339,368 412.715,984	28.622
460	859.339,368 412.715,984	461	859.306,746 412.724,445	33.701	461	859.306,746 412.724,445	462	859.270,892 412.732,606	36.771	462	859.270,892 412.732,606	463	859.255,748 412.735,73	15.463
463	859.255,748 412.735,73	464	859.241,057 412.738,76	15.0	464	859.241,057 412.738,76	465	859.228,08 412.742,64	13.545	465	859.228,08 412.742,64	1	859.167,608 412.756,018	61.934

** Lungimile segmentelor sunt determinate în planul de proiecție Stereo 70 și sunt rotunjite la 1 milimetru.

*** Distanța dintre puncte este formată din segmente cumulate ce sunt mai mici decât valoarea 1 milimetru.