

**DATE DESPRE IMOBILUL NR. 2027**

Oficiul de Cadastru și Publicitate Imobiliară SIBIU  
Biroul de Cadastru și Publicitate Imobiliară Agnita

**A. Partea I. Descrierea imobilului**

TEREN Extravilan

Adresa: Jud. Sibiu

Nr. Crt	Nr cadastral Nr. topografic	Suprafața* (mp)	Observații / Referințe
A1		108.500	Sector cadastral:9 Teren neimprejmuit;

**B. Partea II. Proprietari și acte**

Inscrieri privitoare la dreptul de proprietate și alte drepturi reale	Referințe
/	
Act Administrativ nr. 2553, din 03/07/2007 emis de CJPSDPAT SIBIU (titlu de proprietate);	
B1	A1
Intabulare, drept de PROPRIETATE, dobandit prin Constituire, cota actuala 1/1 1) COMUNA BRUIU, CIF:4480270	

**C. Partea III. SARCINI .**

Inscrieri privind dezmembramintele dreptului de proprietate, drepturi reale de garanție și sarcini	Referințe
NU SUNT	

## Anexa Nr. 1 La Partea I

## Teren

Nr cadastral	Suprafața (mp)*	Observații / Referințe
	108.500	

\* Suprafața este determinată în planul de proiecție Stereo 70.

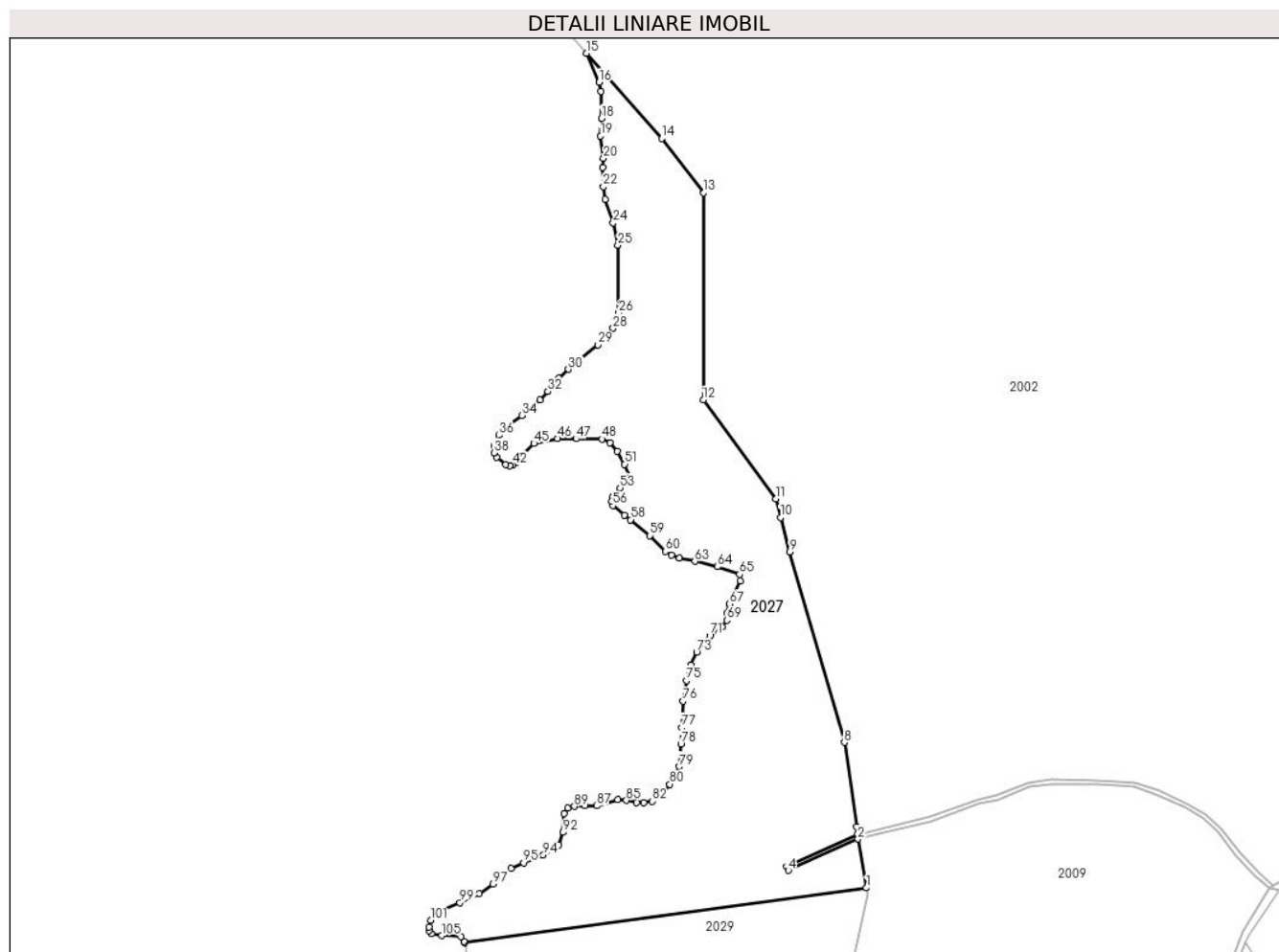

## Date referitoare la teren

Crt	Categorie folosință	Intravilan	Suprafața (mp)	Tarla	Parcelă	Nr. topo	Observații / Referințe
1	padure	NU	108.500	4	97/2	-	

## Lungime Segmente

1) Valorile lungimilor segmentelor sunt obținute din proiecție în plan.

Punct început	X / Y	Punct sfârșit	X / Y	Lungime segment	Punct început	X / Y	Punct sfârșit	X / Y	Lungime segment	Punct început	X / Y	Punct sfârșit	X / Y	Lungime segment
1	474.326,414 489.418,109	2	474.318,587 489.464,001	46.555	2	474.318,587 489.464,001	3	474.318,528 489.464,439	0.442	3	474.318,528 489.464,439	4	474.252,988 489.434,496	72.055
4	474.252,988 489.434,496	5	474.251,326 489.438,135	4.0	5	474.251,326 489.438,135	6	474.317,995 489.468,382	73.21	6	474.317,995 489.468,382	7	474.317,019 489.475,616	7.299
7	474.317,019 489.475,616	8	474.305,588 489.554,842	80.047	8	474.305,588 489.554,842	9	474.254,107 489.733,924	186.335	9	474.254,107 489.733,924	10	474.245,623 489.766,122	33.296
10	474.245,623 489.766,122	11	474.241,316 489.783,724	18.122	11	474.241,316 489.783,724	12	474.172,973 489.876,63	115.336	12	474.172,973 489.876,63	13	474.173,354 490.071,241	194.611
13	474.173,354 490.071,241	14	474.133,783 490.122,303	64.6	14	474.133,783 490.122,303	15	474.063,05 490.202,5	106.933	15	474.063,05 490.202,5	16	474.074,828 490.175,104	29.821
16	474.074,828 490.175,104	17	474.076,65 490.166,778	8.522	17	474.076,65 490.166,778	18	474.077,416 490.141,23	25.56	18	474.077,416 490.141,23	19	474.076,403 490.124,774	16.487

Punct început	X / Y	Punct sfârșit	X / Y	Lungime segment	Punct început	X / Y	Punct sfârșit	X / Y	Lungime segment	Punct început	X / Y	Punct sfârșit	X / Y	Lungime segment
19	474.076,403 490.124,774	20	474.079,18 490.103,659	21.297	20	474.079,18 490.103,659	21	474.078,432 490.095,24	8.452	21	474.078,432 490.095,24	22	474.078,937 490.077,079	18.168
22	474.078,937 490.077,079	23	474.080,691 490.065,302	11.906	23	474.080,691 490.065,302	24	474.088,301 490.043,232	23.346	24	474.088,301 490.043,232	25	474.092,654 490.021,982	21.691
25	474.092,654 490.021,982	26	474.093,418 489.958,531	63.456	26	474.093,418 489.958,531	27	474.092,358 489.952,698	5.929	27	474.092,358 489.952,698	28	474.088,163 489.944,047	9.614
28	474.088,163 489.944,047	29	474.074,037 489.928,38	21.095	29	474.074,037 489.928,38	30	474.046,064 489.905,493	36.144	30	474.046,064 489.905,493	31	474.037,251 489.897,183	12.112
31	474.037,251 489.897,183	32	474.026,847 489.884,496	16.408	32	474.026,847 489.884,496	33	474.019,168 489.876,817	10.859	33	474.019,168 489.876,817	34	474.002,593 489.862,026	22.215
34	474.002,593 489.862,026	35	473.987,417 489.851,151	18.67	35	473.987,417 489.851,151	36	473.981,076 489.843,541	9.905	36	473.981,076 489.843,541	37	473.976,409 489.833,651	10.936
37	473.976,409 489.833,651	38	473.976,048 489.826,917	6.744	38	473.976,048 489.826,917	39	473.978,66 489.822,587	5.057	39	473.978,66 489.822,587	40	473.987,32 489.816,058	10.846
40	473.987,32 489.816,058	41	473.991,306 489.814,752	4.195	41	473.991,306 489.814,752	42	473.994,124 489.815,508	2.918	42	473.994,124 489.815,508	43	473.997,492 489.818,463	4.481
43	473.997,492 489.818,463	44	474.001,822 489.823,824	6.891	44	474.001,822 489.823,824	45	474.013,515 489.835,842	16.768	45	474.013,515 489.835,842	46	474.035,847 489.840,365	22.785
46	474.035,847 489.840,365	47	474.053,273 489.840,12	17.428	47	474.053,273 489.840,12	48	474.077,649 489.839,937	24.377	48	474.077,649 489.839,937	49	474.085,347 489.836,546	8.411
49	474.085,347 489.836,546	50	474.092,037 489.828,391	10.548	50	474.092,037 489.828,391	51	474.098,91 489.816,203	13.992	51	474.098,91 489.816,203	52	474.104,657 489.804,282	13.233
52	474.104,657 489.804,282	53	474.094,603 489.794,118	14.297	53	474.094,603 489.794,118	54	474.088,188 489.785,87	10.448	54	474.088,188 489.785,87	55	474.086,722 489.781,471	4.637
55	474.086,722 489.781,471	56	474.087,821 489.777,348	4.268	56	474.087,821 489.777,348	57	474.098,543 489.768,092	14.164	57	474.098,543 489.768,092	58	474.104,683 489.764,06	7.346
58	474.104,683 489.764,06	59	474.122,644 489.749,214	23.302	59	474.122,644 489.749,214	60	474.137,398 489.734,369	20.93	60	474.137,398 489.734,369	61	474.142,896 489.730,795	6.558
61	474.142,896 489.730,795	62	474.150,502 489.727,862	8.152	62	474.150,502 489.727,862	63	474.164,981 489.725,022	14.755	63	474.164,981 489.725,022	64	474.186,242 489.719,982	21.85
64	474.186,242 489.719,982	65	474.206,957 489.712,85	21.908	65	474.206,957 489.712,85	66	474.207,907 489.706,673	6.25	66	474.207,907 489.706,673	67	474.197,422 489.684,975	24.098
67	474.197,422 489.684,975	68	474.195,406 489.676,27	8.936	68	474.195,406 489.676,27	69	474.195,039 489.669,672	6.608	69	474.195,039 489.669,672	70	474.190,824 489.663,623	7.372
70	474.190,824 489.663,623	71	474.179,094 489.655,009	14.553	71	474.179,094 489.655,009	72	474.170,663 489.646,487	11.988	72	474.170,663 489.646,487	73	474.166,631 489.639,522	8.048
73	474.166,631 489.639,522	74	474.161,224 489.627,609	13.083	74	474.161,224 489.627,609	75	474.157,284 489.612,947	15.183	75	474.157,284 489.612,947	76	474.154,022 489.593,519	19.699
76	474.154,022 489.593,519	77	474.152,63 489.568,725	24.833	77	474.152,63 489.568,725	78	474.151,96 489.553,261	15.479	78	474.151,96 489.553,261	79	474.150,226 489.532,187	21.146
79	474.150,226 489.532,187	80	474.141,402 489.515,546	18.836	80	474.141,402 489.515,546	81	474.135,01 489.506,886	10.763	81	474.135,01 489.506,886	82	474.124,84 489.499,66	12.475
82	474.124,84 489.499,66	83	474.117,003 489.498,02	8.008	83	474.117,003 489.498,02	84	474.110,267 489.498,364	6.744	84	474.110,267 489.498,364	85	474.100,645 489.500,357	9.826
85	474.100,645 489.500,357	86	474.092,398 489.500,975	8.271	86	474.092,398 489.500,975	87	474.072,54 489.495,259	20.664	87	474.072,54 489.495,259	88	474.061,343 489.495,408	11.197
88	474.061,343 489.495,408	89	474.051,813 489.494,675	9.559	89	474.051,813 489.494,675	90	474.045,581 489.493,026	6.446	90	474.045,581 489.493,026	91	474.042,191 489.487,986	6.074
91	474.042,191 489.487,986	92	474.041,091 489.470,299	17.721	92	474.041,091 489.470,299	93	474.037,247 489.458,339	12.563	93	474.037,247 489.458,339	94	474.022,488 489.448,947	17.493
94	474.022,488 489.448,947	95	474.004,069 489.441,616	19.825	95	474.004,069 489.441,616	96	473.992,156 489.436,301	13.045	96	473.992,156 489.436,301	97	473.975,111 489.421,914	22.305
97	473.975,111 489.421,914	98	473.962,373 489.412,841	15.638	98	473.962,373 489.412,841	99	473.944,045 489.404,227	20.251	99	473.944,045 489.404,227	100	473.922,968 489.394,88	23.057
100	473.922,968 489.394,88	101	473.916,553 489.387,549	9.741	101	473.916,553 489.387,549	102	473.914,904 489.381,226	6.535	102	473.914,904 489.381,226	103	473.914,996 489.377,744	3.483
103	473.914,996 489.377,744	104	473.917,286 489.375,361	3.305	104	473.917,286 489.375,361	105	473.926,817 489.373,253	9.761	105	473.926,817 489.373,253	106	473.944,87 489.372,428	18.072
106	473.944,87 489.372,428	107	473.948,077 489.367,938	5.518	107	473.948,077 489.367,938	108	473.948,396 489.366,531	1.443	108	473.948,396 489.366,531	1	474.326,414 489.418,109	381.521

\*\* Lungimile segmentelor sunt determinate în planul de proiecție Stereo 70 și sunt rotunjite la 1 milimetru.

\*\*\* Distanța dintre puncte este formată din segmente cumulate ce sunt mai mici decât valoarea 1 milimetru.



**DATE DESPRE IMOBILUL NR. 2028**

Oficiul de Cadastru și Publicitate Imobiliară SIBIU  
Biroul de Cadastru și Publicitate Imobiliară Agnita

**A. Partea I. Descrierea imobilului**

TEREN Extravilan

Adresa: Jud. Sibiu

Nr. Crt	Nr cadastral Nr. topografic	Suprafața* (mp)	Observații / Referințe
A1		284	Sector cadastral:9 Teren neimprejmuit;

**B. Partea II. Proprietari și acte**

Inscrieri privitoare la dreptul de proprietate și alte drepturi reale	Referințe
/	
Act Normativ nr. Legea 7, din 13/03/1997 emis de PARLAMENTUL ROMANIEI (CONFORM ART. 13 ALIN. 15);	
B1	Inscrierea provizorie, drept de PROPRIETATE, dobandit prin Lege, cota actuala 1/1
	1) <b>COMUNA BRUIU</b> , CIF:4480270, Proprietar neidentificat

**C. Partea III. SARCINI .**

Inscrieri privind dezmembramintele dreptului de proprietate, drepturi reale de garanție și sarcini	Referințe
NU SUNT	

## Anexa Nr. 1 La Partea I

## Teren

Nr cadastral	Suprafața (mp)*	Observații / Referințe
	284	

\* Suprafața este determinată în planul de proiecție Stereo 70.

## DETALII LINIARE IMOBIL

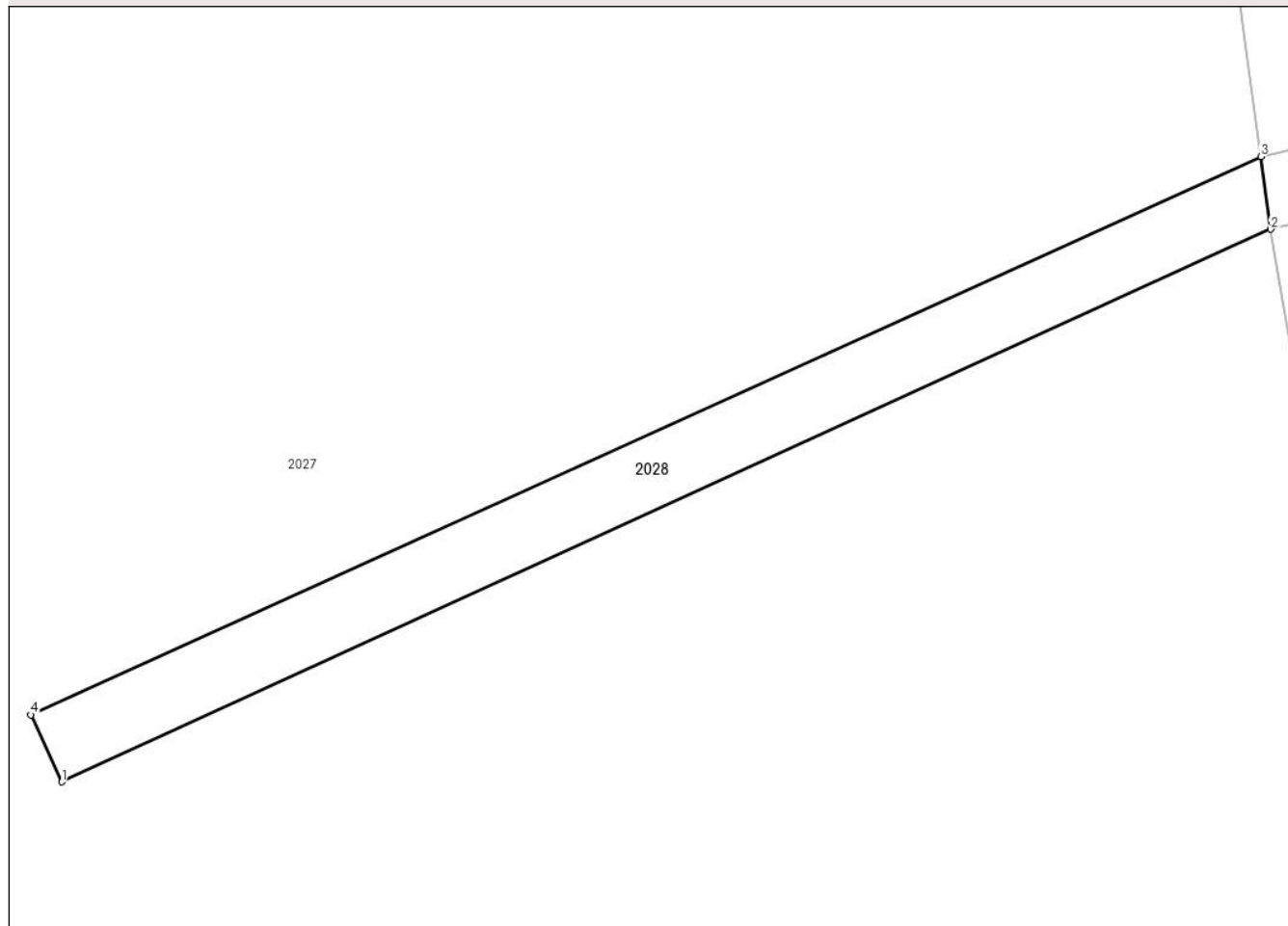

## Date referitoare la teren

Crt	Categorie folosință	Intra vilan	Suprafața (mp)	Tarla	Parcelă	Nr. topo	Observații / Referințe
1	drum	NU	284	4	96	-	

## Lungime Segmente

1) Valorile lungimilor segmentelor sunt obținute din proiecție în plan.

Punct început	X / Y	Punct sfârșit	X / Y	Lungime segment (** (m)
1	474.252,988 489.434,496	2	474.318,528 489.464,439	72.055
2	474.318,528 489.464,439	3	474.317,995 489.468,382	3.979
3	474.317,995 489.468,382	4	474.251,326 489.438,135	73.21
4	474.251,326 489.438,135	1	474.252,988 489.434,496	4.0

\*\* Lungimile segmentelor sunt determinate în planul de proiecție Stereo 70 și sunt rotunjite la 1 milimetru.

**\*\*\* Distanţa dintre puncte este formată din segmente cumulate ce sunt mai mici decât valoarea 1 milimetru.**





**DATE DESPRE IMOBILUL NR. 2029**

Oficiul de Cadastru și Publicitate Imobiliară SIBIU  
Biroul de Cadastru și Publicitate Imobiliară Agnita

**A. Partea I. Descrierea imobilului**

TEREN Extravilan

Adresa: Jud. Sibiu

Nr. Crt	Nr cadastral Nr. topografic	Suprafața* (mp)	Observații / Referințe
A1		453.124	Sector cadastral:9 Teren neimprejmuit;

**B. Partea II. Proprietari și acte**

Inscrieri privitoare la dreptul de proprietate și alte drepturi reale	Referințe
/	
Act Administrativ nr. 97, din 13/03/2002 emis de CJPSDPAT SIBIU (titlu de proprietate);	
B1	A1
Intabulare, drept de PROPRIETATE, dobandit prin Constituire, cota actuala 1/1 1) COMUNA BRUIU, CIF:4480270	

**C. Partea III. SARCINI .**

Inscrieri privind dezmembramintele dreptului de proprietate, drepturi reale de garanție și sarcini	Referințe
NU SUNT	

## Anexa Nr. 1 La Partea I

## Teren

Nr cadastral	Suprafața (mp)*	Observații / Referințe
	453.124	

\* Suprafața este determinată în planul de proiecție Stereo 70.

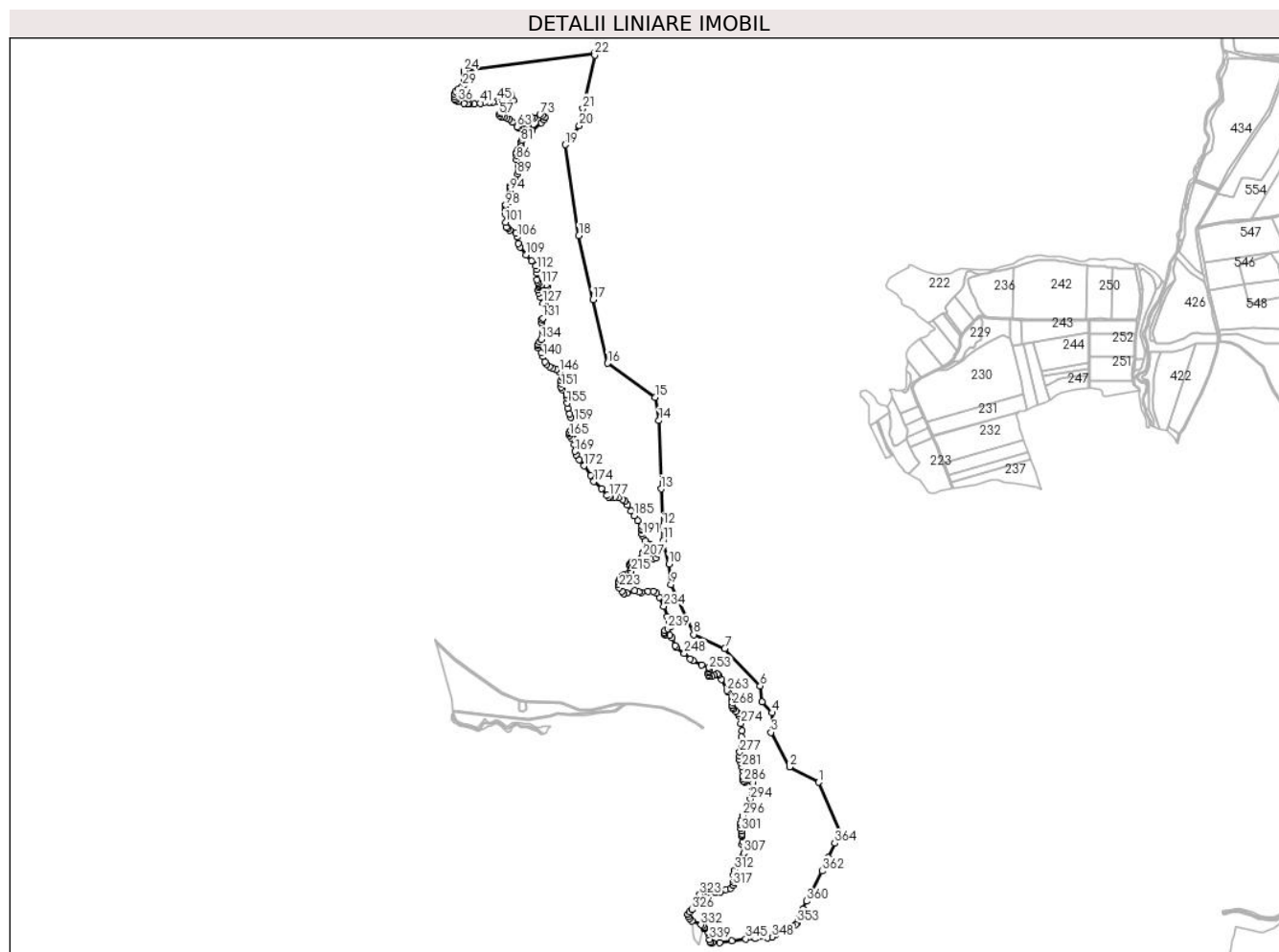

## Date referitoare la teren

Crt	Categorie folosință	Intravilan	Suprafața (mp)	Tarla	Parcelă	Nr. topo	Observații / Referințe
1	padure	NU	453.124	4	97/1	-	Diferența de suprafața se află la ID 2005, 2009, 2010, 2011, 2015, 2019

## Lungime Segmente

1) Valorile lungimilor segmentelor sunt obținute din proiecție în plan.

Punct început	X / Y	Punct sfârșit	X / Y	Lungime segment	Punct început	X / Y	Punct sfârșit	X / Y	Lungime segment	Punct început	X / Y	Punct sfârșit	X / Y	Lungime segment
1	474.975,152 487.308,414	2	474.891,766 487.353,152	94.629	2	474.891,766 487.353,152	3	474.837,626 487.453,203	113.76	3	474.837,626 487.453,203	4	474.840,801 487.509,575	56.461
4	474.840,801 487.509,575	5	474.811,861 487.540,928	42.668	5	474.811,861 487.540,928	6	474.806,581 487.587,371	46.742	6	474.806,581 487.587,371	7	474.704,17 487.695,687	149.065
7	474.704,17 487.695,687	8	474.614,209 487.736,259	98.687	8	474.614,209 487.736,259	9	474.548,1 487.880,4	158.577	9	474.548,1 487.880,4	10	474.542,051 487.939,784	59.692
10	474.542,051 487.939,784	11	474.524,808 488.008,416	70.765	11	474.524,808 488.008,416	12	474.524,371 488.050,409	41.995	12	474.524,371 488.050,409	13	474.519,644 488.157,761	107.456
13	474.519,644 488.157,761	14	474.513,002 488.355,175	197.525	14	474.513,002 488.355,175	15	474.502,007 488.422,509	68.226	15	474.502,007 488.422,509	16	474.364,628 488.521,068	169.077

Punct început	X / Y	Punct sfârșit	X / Y	Lungime segment	Punct început	X / Y	Punct sfârșit	X / Y	Lungime segment	Punct început	X / Y	Punct sfârșit	X / Y	Lungime segment
16	474.364,628 488.521,068	17	474.321,817 488.704,807	188.66	17	474.321,817 488.704,807	18	474.281,385 488.890,026	189.581	18	474.281,385 488.890,026	19	474.241,609 489.153,254	266.217
19	474.241,609 489.153,254	20	474.283,257 489.208,419	69.121	20	474.283,257 489.208,419	21	474.293,051 489.258,326	50.859	21	474.293,051 489.258,326	22	474.327,324 489.412,764	158.195
22	474.327,324 489.412,764	23	474.326,414 489.418,109	5.422	23	474.326,414 489.418,109	24	473.948,396 489.366,531	381.521	24	473.948,396 489.366,531	25	473.949,635 489.361,065	5.605
25	473.949,635 489.361,065	26	473.949,727 489.350,985	10.081	26	473.949,727 489.350,985	27	473.950,826 489.340,355	10.687	27	473.950,826 489.340,355	28	473.951,193 489.328,625	11.736
28	473.951,193 489.328,625	29	473.944,228 489.321,844	9.721	29	473.944,228 489.321,844	30	473.933,782 489.314,788	12.607	30	473.933,782 489.314,788	31	473.924,709 489.307,181	11.839
31	473.924,709 489.307,181	32	473.921,319 489.300,125	7.829	32	473.921,319 489.300,125	33	473.920,219 489.291,786	8.411	33	473.920,219 489.291,786	34	473.920,998 489.285,341	6.492
34	473.920,998 489.285,341	35	473.924,187 489.281,757	4.798	35	473.924,187 489.281,757	36	473.930,995 489.278,227	7.669	36	473.930,995 489.278,227	37	473.948,393 489.272,806	18.223
37	473.948,393 489.272,806	38	473.958,857 489.270,662	10.681	38	473.958,857 489.270,662	39	473.964,916 489.270,642	6.059	39	473.964,916 489.270,642	40	473.978,524 489.270,284	13.613
40	473.978,524 489.270,284	41	473.996,552 489.273,31	18.28	41	473.996,552 489.273,31	42	474.008,781 489.276,84	12.728	42	474.008,781 489.276,84	43	474.022,271 489.277,092	13.492
43	474.022,271 489.277,092	44	474.032,987 489.276,462	10.735	44	474.032,987 489.276,462	45	474.045,468 489.280,37	13.079	45	474.045,468 489.280,37	46	474.056,688 489.284,782	12.057
46	474.056,688 489.284,782	47	474.070,934 489.294,238	17.098	47	474.070,934 489.294,238	48	474.077,616 489.299,155	8.296	48	474.077,616 489.299,155	49	474.083,163 489.298,65	5.57
49	474.083,163 489.298,65	50	474.086,945 489.294,742	5.439	50	474.086,945 489.294,742	51	474.092,428 489.280,732	15.045	51	474.092,428 489.280,732	52	474.085,811 489.270,284	12.367
52	474.085,811 489.270,284	53	474.077,238 489.258,938	14.221	53	474.077,238 489.258,938	54	474.070,191 489.253,124	9.135	54	474.070,191 489.253,124	55	474.055,214 489.247,364	16.046
55	474.055,214 489.247,364	56	474.051,645 489.243,557	5.218	56	474.051,645 489.243,557	57	474.051,129 489.238,032	5.55	57	474.051,129 489.238,032	58	474.056,688 489.233,598	7.111
58	474.056,688 489.233,598	59	474.064,252 489.232,463	7.649	59	474.064,252 489.232,463	60	474.073,33 489.231,202	9.164	60	474.073,33 489.231,202	61	474.079,633 489.227,798	7.164
61	474.079,633 489.227,798	62	474.089,215 489.219,352	12.773	62	474.089,215 489.219,352	63	474.102,326 489.205,358	19.176	63	474.102,326 489.205,358	64	474.108,125 489.200,819	7.364
64	474.108,125 489.200,819	65	474.115,816 489.197,037	8.57	65	474.115,816 489.197,037	66	474.120,732 489.196,533	4.943	66	474.120,732 489.196,533	67	474.125,649 489.197,793	5.076
67	474.125,649 489.197,793	68	474.130,566 489.202,08	6.523	68	474.130,566 489.202,08	69	474.133,214 489.208,005	6.49	69	474.133,214 489.208,005	70	474.139,268 489.228,66	21.523
70	474.139,268 489.228,66	71	474.144,67 489.232,097	6.403	71	474.144,67 489.232,097	72	474.151,318 489.230,227	6.906	72	474.151,318 489.230,227	73	474.168,76 489.240,762	20.377
73	474.168,76 489.240,762	74	474.176,126 489.237,198	8.182	74	474.176,126 489.237,198	75	474.182,151 489.232,464	7.662	75	474.182,151 489.232,464	76	474.179,104 489.225,151	7.923
76	474.179,104 489.225,151	77	474.172,044 489.217,334	10.533	77	474.172,044 489.217,334	78	474.145,442 489.194,389	35.129	78	474.145,442 489.194,389	79	474.120,228 489.173,209	32.93
79	474.120,228 489.173,209	80	474.115,942 489.167,032	7.519	80	474.115,942 489.167,032	81	474.114,429 489.161,737	5.507	81	474.114,429 489.161,737	82	474.113,254 489.150,658	11.141
82	474.113,254 489.150,658	83	474.104,091 489.138,792	14.992	83	474.104,091 489.138,792	84	474.100,813 489.129,589	9.77	84	474.100,813 489.129,589	85	474.100,183 489.123,411	6.21
85	474.100,183 489.123,411	86	474.101,191 489.109,922	13.527	86	474.101,191 489.109,922	87	474.105,478 489.088,994	21.362	87	474.105,478 489.088,994	88	474.105,604 489.077,143	11.851
88	474.105,604 489.077,143	89	474.103,713 489.068,066	9.272	89	474.103,713 489.068,066	90	474.096,149 489.052,307	17.48	90	474.096,149 489.052,307	91	474.085,811 489.040,456	15.726
91	474.085,811 489.040,456	92	474.082,155 489.034,027	7.396	92	474.082,155 489.034,027	93	474.080,894 489.027,471	6.676	93	474.080,894 489.027,471	94	474.081,02 489.019,781	7.691
94	474.081,02 489.019,781	95	474.083,824 489.000,154	19.826	95	474.083,824 489.000,154	96	474.080,696 488.990,509	10.14	96	474.080,696 488.990,509	97	474.070,304 488.979,816	14.91
97	474.070,304 488.979,816	98	474.068,791 488.975,782	4.309	98	474.068,791 488.975,782	99	474.068,665 488.967,839	7.944	99	474.068,665 488.967,839	100	474.069,8 488.951,198	16.68
100	474.069,8 488.951,198	101	474.069,169 488.928,757	22.45	101	474.069,169 488.928,757	102	474.071,817 488.915,141	13.871	102	474.071,817 488.915,141	103	474.075,599 488.910,477	6.005
103	474.075,599 488.910,477	104	474.081,776 488.905,686	7.817	104	474.081,776 488.905,686	105	474.098,879 488.896,565	19.383	105	474.098,879 488.896,565	106	474.102,578 488.886,271	10.938
106	474.102,578 488.886,271	107	474.105,604 488.867,991	18.529	107	474.105,604 488.867,991	108	474.110,647 488.856,644	12.417	108	474.110,647 488.856,644	109	474.128,171 488.834,204	28.472
109	474.128,171 488.834,204	110	474.144,434 488.817,688	23.179	110	474.144,434 488.817,688	111	474.156,411 488.802,182	19.593	111	474.156,411 488.802,182	112	474.159,941 488.792,6	10.211
112	474.159,941 488.792,6	113	474.160,319 488.781,38	11.227	113	474.160,319 488.781,38	114	474.160,067 488.762,217	19.164	114	474.160,067 488.762,217	115	474.162,084 488.756,039	6.499

Punct început	X / Y	Punct sfârșit	X / Y	Lungime segment	Punct început	X / Y	Punct sfârșit	X / Y	Lungime segment	Punct început	X / Y	Punct sfârșit	X / Y	Lungime segment
115	474.162,084 488.756,039	116	474.165,488 488.752,005	5.278	116	474.165,488 488.752,005	117	474.173,682 488.749,106	8.692	117	474.173,682 488.749,106	118	474.186,307 488.747,741	12.698
118	474.186,307 488.747,741	119	474.189,998 488.740,886	7.785	119	474.189,998 488.740,886	120	474.181,377 488.738,013	9.087	120	474.181,377 488.738,013	121	474.175,447 488.742,802	7.622
121	474.175,447 488.742,802	122	474.169,522 488.743,18	5.937	122	474.169,522 488.743,18	123	474.165,236 488.739,65	5.553	123	474.165,236 488.739,65	124	474.163,975 488.733,094	6.676
124	474.163,975 488.733,094	125	474.165,74 488.723,387	9.867	125	474.165,74 488.723,387	126	474.170,278 488.711,788	12.455	126	474.170,278 488.711,788	127	474.177,417 488.694,769	18.456
127	474.177,417 488.694,769	128	474.182,24 488.690,325	6.558	128	474.182,24 488.690,325	129	474.192,168 488.681,01	13.614	129	474.192,168 488.681,01	130	474.192,168 488.669,795	11.215
130	474.192,168 488.669,795	131	474.177,606 488.651,747	23.19	131	474.177,606 488.651,747	132	474.174,675 488.646,546	5.97	132	474.174,675 488.646,546	133	474.172,5 488.639,455	7.417
133	474.172,5 488.639,455	134	474.171,986 488.589,78	49.678	134	474.171,986 488.589,78	135	474.166,638 488.582,345	9.159	135	474.166,638 488.582,345	136	474.163,14 488.575,726	7.487
136	474.163,14 488.575,726	137	474.161,627 488.571,566	4.427	137	474.161,627 488.571,566	138	474.162,951 488.565,703	6.01	138	474.162,951 488.565,703	139	474.172,5 488.551,709	16.942
139	474.172,5 488.551,709	140	474.178,363 488.540,079	13.024	140	474.178,363 488.540,079	141	474.183,469 488.525,518	15.431	141	474.183,469 488.525,518	142	474.188,48 488.518,143	8.917
142	474.188,48 488.518,143	143	474.197,274 488.510,39	11.723	143	474.197,274 488.510,39	144	474.205,5 488.505,756	9.441	144	474.205,5 488.505,756	145	474.215,712 488.502,258	10.794
145	474.215,712 488.502,258	146	474.224,789 488.496,206	10.909	146	474.224,789 488.496,206	147	474.232,537 488.487,302	11.804	147	474.232,537 488.487,302	148	474.233,025 488.479,501	7.816
148	474.233,025 488.479,501	149	474.230,84 488.470,961	8.815	149	474.230,84 488.470,961	150	474.230,462 488.461,789	9.179	150	474.230,462 488.461,789	151	474.230,935 488.452,428	9.373
151	474.230,935 488.452,428	152	474.234,244 488.445,053	8.084	152	474.234,244 488.445,053	153	474.245,918 488.430,136	18.943	153	474.245,918 488.430,136	154	474.248,238 488.420,753	9.665
154	474.248,238 488.420,753	155	474.247,765 488.405,624	15.136	155	474.247,765 488.405,624	156	474.250,034 488.391,441	14.363	156	474.250,034 488.391,441	157	474.255,424 488.374,516	17.762
157	474.255,424 488.374,516	158	474.258,922 488.365,155	9.993	158	474.258,922 488.365,155	159	474.268,087 488.353,373	14.927	159	474.268,087 488.353,373	160	474.271,515 488.341,675	12.189
160	474.271,515 488.341,675	161	474.266,203 488.333,574	9.687	161	474.266,203 488.333,574	162	474.258,355 488.325,821	11.032	162	474.258,355 488.325,821	163	474.254,573 488.320,621	6.43
163	474.254,573 488.320,621	164	474.252,776 488.316,46	4.532	164	474.252,776 488.316,46	165	474.253,911 488.311,165	5.415	165	474.253,911 488.311,165	166	474.260,341 488.305,019	8.895
166	474.260,341 488.305,019	167	474.268,201 488.299,665	9.51	167	474.268,201 488.299,665	168	474.269,229 488.285,73	13.973	168	474.269,229 488.285,73	169	474.270,552 488.265,78	19.995
169	474.270,552 488.265,78	170	474.273,389 488.256,702	9.51	170	474.273,389 488.256,702	171	474.282,277 488.241,29	17.791	171	474.282,277 488.241,29	172	474.295,871 488.223,834	22.125
172	474.295,871 488.223,834	173	474.315,087 488.195,999	33.824	173	474.315,087 488.195,999	174	474.325,11 488.178,412	20.242	174	474.325,11 488.178,412	175	474.346,384 488.157,705	29.688
175	474.346,384 488.157,705	176	474.362,742 488.138,227	25.436	176	474.362,742 488.138,227	177	474.368,415 488.134,35	6.871	177	474.368,415 488.134,35	178	474.373,899 488.133,026	5.642
178	474.373,899 488.133,026	179	474.386,002 488.132,932	12.103	179	474.386,002 488.132,932	180	474.396,025 488.132,27	10.045	180	474.396,025 488.132,27	181	474.407,466 488.127,637	12.343
181	474.407,466 488.127,637	182	474.415,976 488.120,924	10.839	182	474.415,976 488.120,924	183	474.422,594 488.111,279	11.697	183	474.422,594 488.111,279	184	474.432,806 488.094,26	19.848
184	474.432,806 488.094,26	185	474.441,694 488.079,509	17.221	185	474.441,694 488.079,509	186	474.452,379 488.065,515	17.607	186	474.452,379 488.065,515	187	474.464,022 488.050,202	19.237
187	474.464,022 488.050,202	188	474.464,86 488.042,066	8.179	188	474.464,86 488.042,066	189	474.463,82 488.037,622	4.564	189	474.463,82 488.037,622	190	474.464,576 488.026,938	10.711
190	474.464,576 488.026,938	191	474.466,467 488.022,494	4.83	191	474.466,467 488.022,494	192	474.473,653 488.008,31	15.9	192	474.473,653 488.008,31	193	474.480,083 487.999,99	10.515
193	474.480,083 487.999,99	194	474.488,12 487.995,64	9.138	194	474.488,12 487.995,64	195	474.504,517 487.992,412	16.712	195	474.504,517 487.992,412	196	474.509,678 487.986,09	8.161
196	474.509,678 487.986,09	197	474.511,286 487.978,81	7.456	197	474.511,286 487.978,81	198	474.509,962 487.968,787	10.11	198	474.509,962 487.968,787	199	474.503,565 487.957,08	13.341
199	474.503,565 487.957,08	200	474.495,83 487.956,048	7.803	200	474.495,83 487.956,048	201	474.491,24 487.962,168	7.65	201	474.491,24 487.962,168	202	474.487,647 487.972,191	10.647
202	474.487,647 487.972,191	203	474.483,705 487.981,172	9.808	203	474.483,705 487.981,172	204	474.475,813 487.983,26	8.163	204	474.475,813 487.983,26	205	474.469,682 487.978,904	7.521
205	474.469,682 487.978,904	206	474.467,791 487.973,231	5.98	206	474.467,791 487.973,231	207	474.466,373 487.961,885	11.435	207	474.466,373 487.961,885	208	474.462,402 487.956,59	6.619
208	474.462,402 487.956,59	209	474.455,121 487.952,146	8.53	209	474.455,121 487.952,146	210	474.436,872 487.946,567	19.082	210	474.436,872 487.946,567	211	474.433,188 487.944,13	4.417
211	474.433,188 487.944,13	212	474.429,973 487.940,537	4.821	212	474.429,973 487.940,537	213	474.429,122 487.935,998	4.618	213	474.429,122 487.935,998	214	474.430,162 487.929,947	6.14

Punct început	X / Y	Punct sfârșit	X / Y	Lungime segment	Punct început	X / Y	Punct sfârșit	X / Y	Lungime segment	Punct început	X / Y	Punct sfârșit	X / Y	Lungime segment
214	474.430,162 487.929,947	215	474.433,212 487.919,925	10.476	215	474.433,212 487.919,925	216	474.430,162 487.915,858	5.083	216	474.430,162 487.915,858	217	474.424,867 487.913,305	5.878
217	474.424,867 487.913,305	218	474.413,899 487.911,036	11.2	218	474.413,899 487.911,036	219	474.407,469 487.906,214	8.037	219	474.407,469 487.906,214	220	474.400,094 487.897,042	11.769
220	474.400,094 487.897,042	221	474.396,501 487.889,194	8.631	221	474.396,501 487.889,194	222	474.396,312 487.879,644	9.552	222	474.396,312 487.879,644	223	474.398,487 487.872,553	7.417
223	474.398,487 487.872,553	224	474.405,957 487.861,868	13.037	224	474.405,957 487.861,868	225	474.411,149 487.855,142	8.498	225	474.411,149 487.855,142	226	474.420,234 487.856,195	9.146
226	474.420,234 487.856,195	227	474.443,354 487.862,44	23.948	227	474.443,354 487.862,44	228	474.454,557 487.858,748	11.796	228	474.454,557 487.858,748	229	474.461,743 487.858,086	7.216
229	474.461,743 487.858,086	230	474.481,032 487.861,206	19.54	230	474.481,032 487.861,206	231	474.497,111 487.861,717	16.087	231	474.497,111 487.861,717	232	474.506,089 487.855,817	10.743
232	474.506,089 487.855,817	233	474.514,409 487.843,808	14.609	233	474.514,409 487.843,808	234	474.527,836 487.817,617	29.432	234	474.527,836 487.817,617	235	474.537,575 487.788,116	31.067
235	474.537,575 487.788,116	236	474.542,586 487.773,082	15.847	236	474.542,586 487.773,082	237	474.550,202 487.765,725	10.59	237	474.550,202 487.765,725	238	474.548,732 487.759,845	6.061
238	474.548,732 487.759,845	239	474.538,993 487.753,51	11.618	239	474.538,993 487.753,51	240	474.531,051 487.747,553	9.928	240	474.531,051 487.747,553	241	474.529,065 487.743,014	4.954
241	474.529,065 487.743,014	242	474.528,687 487.739,61	3.425	242	474.528,687 487.739,61	243	474.530,813 487.735,501	4.627	243	474.530,813 487.735,501	244	474.545,164 487.733,326	14.515
244	474.545,164 487.733,326	245	474.550,907 487.727,224	8.38	245	474.550,907 487.727,224	246	474.559,984 487.703,869	25.057	246	474.559,984 487.703,869	247	474.564,05 487.699,331	6.093
247	474.564,05 487.699,331	248	474.586,648 487.682,027	28.462	248	474.586,648 487.682,027	249	474.604,046 487.665,386	24.075	249	474.604,046 487.665,386	250	474.611,705 487.660,375	9.153
250	474.611,705 487.660,375	251	474.637,707 487.649,028	28.37	251	474.637,707 487.649,028	252	474.657,441 487.640,835	21.368	252	474.657,441 487.640,835	253	474.659,644 487.635,696	5.59
253	474.659,644 487.635,696	254	474.658,793 487.630,874	4.897	254	474.658,793 487.630,874	255	474.656,618 487.624,917	6.341	255	474.656,618 487.624,917	256	474.655,578 487.620,379	4.656
256	474.655,578 487.620,379	257	474.658,69 487.615,84	5.503	257	474.658,69 487.615,84	258	474.666,357 487.615,84	7.667	258	474.666,357 487.615,84	259	474.673,354 487.617,92	7.3
259	474.673,354 487.617,92	260	474.682,11 487.621,451	9.442	260	474.682,11 487.621,451	261	474.685,929 487.618,96	4.56	261	474.685,929 487.618,96	262	474.693,777 487.606,101	15.065
262	474.693,777 487.606,101	263	474.709,946 487.574,047	35.901	263	474.709,946 487.574,047	264	474.713,066 487.569,036	5.903	264	474.713,066 487.569,036	265	474.725,416 487.555,03	18.673
265	474.725,416 487.555,03	266	474.726,682 487.547,856	7.284	266	474.726,682 487.547,856	267	474.726,02 487.539,441	8.441	267	474.726,02 487.539,441	268	474.724,602 487.531,782	7.789
268	474.724,602 487.531,782	269	474.725,547 487.526,582	5.286	269	474.725,547 487.526,582	270	474.729,235 487.520,719	6.926	270	474.729,235 487.520,719	271	474.736,894 487.513,155	10.765
271	474.736,894 487.513,155	272	474.743,796 487.507,293	9.056	272	474.743,796 487.507,293	273	474.747,106 487.500,106	7.911	273	474.747,106 487.500,106	274	474.751,266 487.478,737	21.77
274	474.751,266 487.478,737	275	474.753,252 487.458,219	20.614	275	474.753,252 487.458,219	276	474.752,684 487.440,16	18.069	276	474.752,684 487.440,16	277	474.747,484 487.396,003	44.462
277	474.747,484 487.396,003	278	474.746,727 487.384,278	11.749	278	474.746,727 487.384,278	279	474.747,106 487.374,54	9.746	279	474.747,106 487.374,54	280	474.749,753 487.365,368	9.546
280	474.749,753 487.365,368	281	474.754,008 487.352,13	13.905	281	474.754,008 487.352,13	282	474.754,954 487.342,486	9.691	282	474.754,954 487.342,486	283	474.755,143 487.327,546	14.941
283	474.755,143 487.327,546	284	474.755,521 487.317,618	9.935	284	474.755,521 487.317,618	285	474.757,506 487.313,174	4.867	285	474.757,506 487.313,174	286	474.759,87 487.310,338	3.692
286	474.759,87 487.310,338	287	474.762,862 487.310,005	3.011	287	474.762,862 487.310,005	288	474.769,042 487.314,971	7.927	288	474.769,042 487.314,971	289	474.776,0 487.323,294	10.849
289	474.776,0 487.323,294	290	474.783,061 487.321,993	7.18	290	474.783,061 487.321,993	291	474.784,832 487.307,123	14.975	291	474.784,832 487.307,123	292	474.784,643 487.289,441	17.683
292	474.784,643 487.289,441	293	474.782,941 487.274,029	15.506	293	474.782,941 487.274,029	294	474.777,741 487.259,941	15.018	294	474.777,741 487.259,941	295	474.769,893 487.241,314	20.213
295	474.769,893 487.241,314	296	474.755,804 487.212,097	32.436	296	474.755,804 487.212,097	297	474.753,441 487.201,696	10.666	297	474.753,441 487.201,696	298	474.751,171 487.190,728	11.2
298	474.751,171 487.190,728	299	474.750,604 487.184,771	5.984	299	474.750,604 487.184,771	300	474.750,415 487.174,559	10.214	300	474.750,415 487.174,559	301	474.751,928 487.167,656	7.066
301	474.751,928 487.167,656	302	474.754,481 487.158,674	9.338	302	474.754,481 487.158,674	303	474.754,614 487.153,494	5.182	303	474.754,614 487.153,494	304	474.754,67 487.151,299	2.196
304	474.754,67 487.151,299	305	474.755,261 487.136,186	15.124	305	474.755,261 487.136,186	306	474.754,859 487.129,079	7.119	306	474.754,859 487.129,079	307	474.758,845 487.103,046	26.336
307	474.758,845 487.103,046	308	474.756,561 487.094,85	8.508	308	474.756,561 487.094,85	309	474.751,826 487.087,624	8.639	309	474.751,826 487.087,624	310	474.740,581 487.074,332	17.41
310	474.740,581 487.074,332	311	474.737,65 487.067,903	7.066	311	474.737,65 487.067,903	312	474.733,112 487.054,098	14.532	312	474.733,112 487.054,098	313	474.730,937 487.049,276	5.29

Punct început	X / Y	Punct sfârșit	X / Y	Lungime segment	Punct început	X / Y	Punct sfârșit	X / Y	Lungime segment	Punct început	X / Y	Punct sfârșit	X / Y	Lungime segment
313	474.730,937 487.049,276	314	474.730,18 487.040,766	8.543	314	474.730,18 487.040,766	315	474.730,937 487.026,866	13.92	315	474.730,937 487.026,866	316	474.729,897 487.018,64	8.292
316	474.729,897 487.018,64	317	474.727,628 487.010,698	8.26	317	474.727,628 487.010,698	318	474.720,725 487.001,715	11.328	318	474.720,725 487.001,715	319	474.705,986 486.998,286	15.132
319	474.705,986 486.998,286	320	474.691,559 486.990,998	16.164	320	474.691,559 486.990,998	321	474.676,691 486.990,115	14.895	321	474.676,691 486.990,115	322	474.662,264 486.989,968	14.427
322	474.662,264 486.989,968	323	474.632,041 486.983,78	30.85	323	474.632,041 486.983,78	324	474.622,502 486.964,033	21.93	324	474.622,502 486.964,033	325	474.617,312 486.953,253	11.964
325	474.617,312 486.953,253	326	474.609,834 486.939,868	15.332	326	474.609,834 486.939,868	327	474.602,896 486.933,49	9.425	327	474.602,896 486.933,49	328	474.597,239 486.926,889	8.693
328	474.597,239 486.926,889	329	474.597,728 486.919,608	7.298	329	474.597,728 486.919,608	330	474.601,662 486.913,811	7.006	330	474.601,662 486.913,811	331	474.609,253 486.907,654	9.774
331	474.609,253 486.907,654	332	474.634,733 486.896,349	27.875	332	474.634,733 486.896,349	333	474.639,693 486.893,217	5.866	333	474.639,693 486.893,217	334	474.643,182 486.887,672	6.551
334	474.643,182 486.887,672	335	474.643,132 486.886,724	0.95	335	474.643,132 486.886,724	336	474.646,528 486.884,763	3.921	336	474.646,528 486.884,763	337	474.654,26 486.876,358	11.421
337	474.654,26 486.876,358	338	474.657,958 486.867,281	9.802	338	474.657,958 486.867,281	339	474.660,144 486.854,169	13.292	339	474.660,144 486.854,169	340	474.661,152 486.845,764	8.465
340	474.661,152 486.845,764	341	474.663,001 486.844,924	2.031	341	474.663,001 486.844,924	342	474.668,212 486.844,42	5.235	342	474.668,212 486.844,42	343	474.689,392 486.844,252	21.181
343	474.689,392 486.844,252	344	474.724,02 486.849,126	34.969	344	474.724,02 486.849,126	345	474.764,699 486.855,01	41.102	345	474.764,699 486.855,01	346	474.792,939 486.856,691	28.29
346	474.792,939 486.856,691	347	474.827,566 486.859,212	34.719	347	474.827,566 486.859,212	348	474.841,014 486.860,557	13.515	348	474.841,014 486.860,557	349	474.851,268 486.868,626	13.048
349	474.851,268 486.868,626	350	474.884,046 486.888,293	38.226	350	474.884,046 486.888,293	351	474.900,015 486.892,663	16.556	351	474.900,015 486.892,663	352	474.909,26 486.897,202	10.299
352	474.909,26 486.897,202	353	474.913,799 486.901,404	6.185	353	474.913,799 486.901,404	354	474.916,32 486.909,641	8.614	354	474.916,32 486.909,641	355	474.918,17 486.917,205	7.787
355	474.918,17 486.917,205	356	474.921,868 486.922,08	6.119	356	474.921,868 486.922,08	357	474.924,108 486.923,887	2.878	357	474.924,108 486.923,887	358	474.924,789 486.925,93	2.154
358	474.924,789 486.925,93	359	474.930,383 486.942,714	17.691	359	474.930,383 486.942,714	360	474.940,245 486.964,528	23.94	360	474.940,245 486.964,528	361	474.956,382 486.994,711	34.225
361	474.956,382 486.994,711	362	474.985,668 487.051,788	64.152	362	474.985,668 487.051,788	363	475.003,598 487.090,936	43.058	363	475.003,598 487.090,936	364	475.022,723 487.132,175	45.458
364	475.022,723 487.132,175	365	475.034,976 487.150,703	22.213	365	475.034,976 487.150,703	366	475.041,201 487.155,285	7.73	366	475.041,201 487.155,285	1	474.975,152 487.308,414	166.766

\*\* Lungimile segmentelor sunt determinate în planul de proiecție Stereo 70 și sunt rotunjite la 1 milimetru.

\*\*\* Distanța dintre puncte este formată din segmente cumulate ce sunt mai mici decât valoarea 1 milimetru.

**DATE DESPRE IMOBILUL NR. 2030**

Oficiul de Cadastru și Publicitate Imobiliară SIBIU  
Biroul de Cadastru și Publicitate Imobiliară Agnita

**A. Partea I. Descrierea imobilului**

TEREN Extravilan

Adresa: Jud. Sibiu

Nr. Crt	Nr cadastral Nr. topografic	Suprafața* (mp)	Observații / Referințe
A1		4.400	Sector cadastral:9 Teren neimprejmuit;

**B. Partea II. Proprietari și acte**

Inscrieri privitoare la dreptul de proprietate și alte drepturi reale	Referințe
/	
Act Normativ nr. 268, din 28/05/2001 emis de PARLAMENTUL ROMANIEI (lege);	
B1	Intabulare, drept de PROPRIETATE, dobandit prin Lege, cota actuala 1/1 1) STATUL ROMAN - DOMENIUL PRIVAT, CIF:9999999999999
Act Administrativ nr. 318, din 31/07/2020 emis de MINISTERUL AGRICULTURII SI DEZVOLTARII RURALE (Decizie);	
B2	Intabulare, drept de ADMINISTRARE, dobandit prin Lege, cota actuala 1/1 1) AGENTIA DOMENIILOR STATULUI, CIF:14818116

**C. Partea III. SARCINI .**

Inscrieri privind dezmembramintele dreptului de proprietate, drepturi reale de garanție și sarcini	Referințe
NU SUNT	

## Anexa Nr. 1 La Partea I

## Teren

Nr cadastral	Suprafața (mp)*	Observații / Referințe
	4.400	

\* Suprafața este determinată în planul de proiecție Stereo 70.

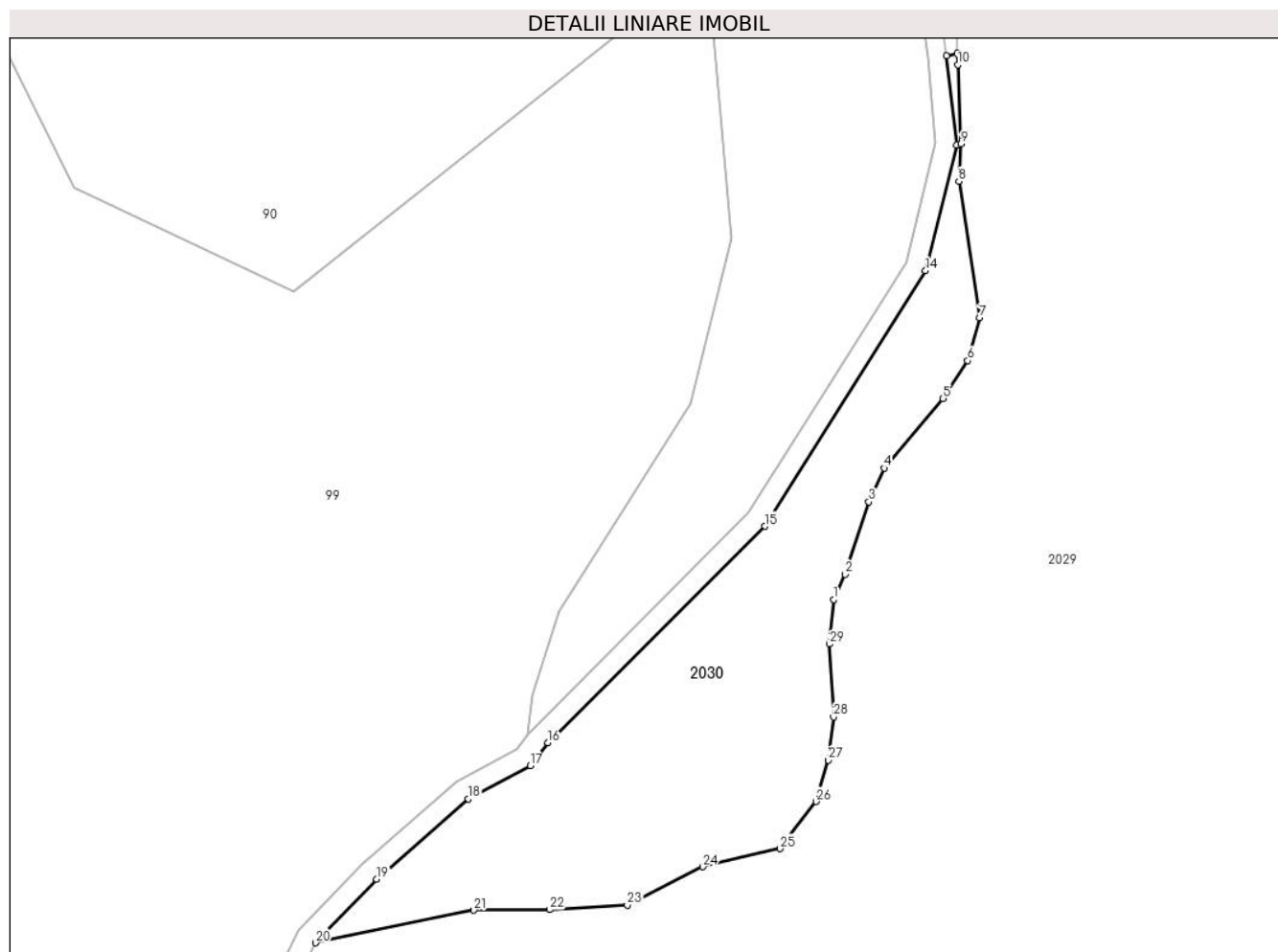

## Date referitoare la teren

Crt	Categorie folosință	Intravilan	Suprafața (mp)	Tarla	Parcelă	Nr. topo	Observații / Referințe
1	faneata	NU	4.400	4	95	-	

## Lungime Segmente

1) Valorile lungimilor segmentelor sunt obținute din proiecție în plan.

Punct început	X / Y	Punct sfârșit	X / Y	Lungime segment (** (m)
1	474.730,937 487.049,276	2	474.733,112 487.054,098	5.29
3	474.737,65 487.067,903	4	474.740,581 487.074,332	7.066
5	474.751,826 487.087,624	6	474.756,561 487.094,85	8.639
7	474.758,845 487.103,046	8	474.754,859 487.129,079	26.336
9	474.755,261 487.136,186	10	474.754,67 487.151,299	15.124

Punct început	X / Y	Punct sfârșit	X / Y	Lungime segment (** (m)
2	474.733,112 487.054,098	3	474.737,65 487.067,903	14.532
4	474.740,581 487.074,332	5	474.751,826 487.087,624	17.41
6	474.756,561 487.094,85	7	474.758,845 487.103,046	8.508
8	474.754,859 487.129,079	9	474.755,261 487.136,186	7.119
10	474.754,67 487.151,299	11	474.754,614 487.153,494	2.196



Punct început	X / Y	Punct sfârșit	X / Y	Lungime segment (** (m))
11	474.754,614 487.153,494	12	474.752,51 487.152,988	2.164
13	474.754,418 487.135,96	14	474.748,488 487.111,99	24.693
15	474.717,812 487.063,253	16	474.676,414 487.021,923	58.498
17	474.672,998 487.017,557	18	474.661,201 487.011,203	13.4
19	474.643,69 486.995,901	20	474.632,041 486.983,78	16.811
21	474.662,264 486.989,968	22	474.676,691 486.990,115	14.427
23	474.691,559 486.990,998	24	474.705,986 486.998,286	16.164
25	474.720,725 487.001,715	26	474.727,628 487.010,698	11.328
27	474.729,897 487.018,64	28	474.730,937 487.026,866	8.292
29	474.730,18 487.040,766	1	474.730,937 487.049,276	8.543

Punct început	X / Y	Punct sfârșit	X / Y	Lungime segment (** (m))
12	474.752,51 487.152,988	13	474.754,418 487.135,96	17.135
14	474.748,488 487.111,99	15	474.717,812 487.063,253	57.587
16	474.676,414 487.021,923	17	474.672,998 487.017,557	5.543
18	474.661,201 487.011,203	19	474.643,69 486.995,901	23.255
20	474.632,041 486.983,78	21	474.662,264 486.989,968	30.85
22	474.676,691 486.990,115	23	474.691,559 486.990,998	14.895
24	474.705,986 486.998,286	25	474.720,725 487.001,715	15.132
26	474.727,628 487.010,698	27	474.729,897 487.018,64	8.26
28	474.730,937 487.026,866	29	474.730,18 487.040,766	13.92

\*\* Lungimile segmentelor sunt determinate în planul de proiecție Stereo 70 și sunt rotunjite la 1 milimetru.

\*\*\* Distanța dintre puncte este formată din segmente cumulate ce sunt mai mici decât valoarea 1 milimetru.

