

**DATE DESPRE IMOBILUL NR. 4953**

Oficiul de Cadastru și Publicitate Imobiliară SIBIU  
Biroul de Cadastru și Publicitate Imobiliară Sibiu

**A. Partea I. Descrierea imobilului**

TEREN Extravilan

Adresa: Jud. Sibiu

Nr. Crt	Nr cadastral Nr. topografic	Suprafața* (mp)	Observații / Referințe
A1	105964	48.123	Sector cadastral:38 Teren neimpregmuit;

**B. Partea II. Proprietari și acte**

Inscrieri privitoare la dreptul de proprietate și alte drepturi reale		Referințe
<b>56611 / 07/06/2021</b>		
Act Normativ nr. 978, din 05/09/2002 emis de GUVERNUL ROMANIEI (act administrativ nr 11963 din 02.06.2021, emis de CONSILIUL JUDETEAN SIBIU);		
B1	se infiinteaza prezenta carte funciara, drum judetean DJ 143B (km 11+352-km 16+377)	A1
B2	Intabulare, drept de PROPRIETATE, dobandit prin Lege, cota actuala 1/1	A1
1) JUDETUL SIBIU-DOMENIUL PUBLIC, CIF:999999999999		

**C. Partea III. SARCINI .**

Inscrieri privind dezmembramintele dreptului de proprietate, drepturi reale de garanție și sarcini	Referințe
NU SUNT	

## Anexa Nr. 1 La Partea I

## Teren

Nr cadastral	Suprafața (mp)*	Observații / Referințe
105964	48.123	

\* Suprafața este determinată în planul de proiecție Stereo 70.

## DETALII LINIARE IMOBIL



## Date referitoare la teren

Crt	Categorie folosință	Intravilan	Suprafața (mp)	Tarla	Parcelă	Nr. topo	Observații / Referințe
1	drum	NU	48.123	34	DJ 143B (km 11+352-km 16+377)	-	DJ 143B (km 11+352-km 16+377). Nr. Cad. DC 792, (DC 66), DC 782, DC 777, DC 739. Diferența de suprafață se regăsește în Sectorul 25

## Lungime Segmente

1) Valorile lungimilor segmentelor sunt obținute din proiecție în plan.

Punct început	X / Y	Punct sfârșit	X / Y	Lungime segment	Punct început	X / Y	Punct sfârșit	X / Y	Lungime segment	Punct început	X / Y	Punct sfârșit	X / Y	Lungime segment
1	423.770,128 479.874,249	2	423.753,807 479.874,52	16.32 3	2	423.753,807 479.874,52	3	423.753,963 479.875,105	0.605	3	423.753,963 479.875,105	4	423.728,824 479.875,63	25.14 4
4	423.728,824 479.875,63	5	423.668,138 479.876,402	60.69 1	5	423.668,138 479.876,402	6	423.599,99 479.887,063	68.97 7	6	423.599,99 479.887,063	7	423.569,111 479.894,828	31.84
7	423.569,111 479.894,828	8	423.496,413 479.916,542	75.87 1	8	423.496,413 479.916,542	9	423.494,13 479.917,361	2.425	9	423.494,13 479.917,361	10	423.487,535 479.919,34	6.886
10	423.487,535 479.919,34	11	423.381,553 479.951,304	110.6 97	11	423.381,553 479.951,304	12	423.353,024 479.959,909	29.79 8	12	423.353,024 479.959,909	13	423.323,838 479.968,711	30.48 4
13	423.323,838 479.968,711	14	423.311,723 479.972,438	12.67 5	14	423.311,723 479.972,438	15	423.240,214 479.996,488	75.44 5	15	423.240,214 479.996,488	16	423.222,098 480.002,293	19.02 3

Punct început	X / Y	Punct sfârșit	X / Y	Lungime segment	Punct început	X / Y	Punct sfârșit	X / Y	Lungime segment	Punct început	X / Y	Punct sfârșit	X / Y	Lungime segment
16	423.222,098 480.002,293	17	423.219,386 480.003,154	2.845	17	423.219,386 480.003,154	18	423.191,37 480.012,046	29.39 3	18	423.191,37 480.012,046	19	423.192,118 480.013,99	2.083
19	423.192,118 480.013,99	20	423.059,064 480.058,287	140.2 34	20	423.059,064 480.058,287	21	422.901,156 480.106,711	165.1 67	21	422.901,156 480.106,711	22	422.865,374 480.116,14	37.00 3
22	422.865,374 480.116,14	23	422.857,409 480.119,281	8.562	23	422.857,409 480.119,281	24	422.849,646 480.122,341	8.344	24	422.849,646 480.122,341	25	422.841,515 480.125,547	8.74
25	422.841,515 480.125,547	26	422.832,719 480.129,015	9.455	26	422.832,719 480.129,015	27	422.823,604 480.132,609	9.798	27	422.823,604 480.132,609	28	422.815,926 480.135,636	8.253
28	422.815,926 480.135,636	29	422.809,163 480.138,302	7.27	29	422.809,163 480.138,302	30	422.803,095 480.141,614	6.913	30	422.803,095 480.141,614	31	422.797,058 480.145,704	7.292
31	422.797,058 480.145,704	32	422.658,385 480.234,872	164.8 67	32	422.658,385 480.234,872	33	422.461,862 480.336,066	221.0 46	33	422.461,862 480.336,066	34	422.440,395 480.350,077	25.63 5
34	422.440,395 480.350,077	35	422.433,775 480.354,097	7.745	35	422.433,775 480.354,097	36	422.420,796 480.359,231	13.95 8	36	422.420,796 480.359,231	37	422.406,602 480.363,707	14.88 3
37	422.406,602 480.363,707	38	422.388,522 480.368,202	18.63 1	38	422.388,522 480.368,202	39	422.313,002 480.379,428	76.34 9	39	422.313,002 480.379,428	40	422.186,888 480.399,287	127.6 68
40	422.186,888 480.399,287	41	422.150,565 480.404,162	36.64 9	41	422.150,565 480.404,162	42	422.122,896 480.403,28	27.68 3	42	422.122,896 480.403,28	43	421.964,167 480.396,603	158.8 69
43	421.964,167 480.396,603	44	421.912,668 480.399,635	51.58 8	44	421.912,668 480.399,635	45	421.813,265 480.386,757	100.2 34	45	421.813,265 480.386,757	46	421.780,106 480.377,436	34.44 4
46	421.780,106 480.377,436	47	421.540,583 480.255,586	268.7 35	47	421.540,583 480.255,586	48	421.527,084 480.250,632	14.37 9	48	421.527,084 480.250,632	49	421.508,664 480.246,567	18.86 3
49	421.508,664 480.246,567	50	421.172,404 480.194,066	340.3 35	50	421.172,404 480.194,066	51	421.142,188 480.190,018	30.48 6	51	421.142,188 480.190,018	52	421.122,05 480.189,383	20.14 8
52	421.122,05 480.189,383	53	421.106,88 480.190,463	15.20 8	53	421.106,88 480.190,463	54	420.936,183 480.219,083	173.0 8	54	420.936,183 480.219,083	55	420.911,18 480.225,786	25.88 5
55	420.911,18 480.225,786	56	420.877,998 480.237,06	35.04 6	56	420.877,998 480.237,06	57	420.839,867 480.256,785	42.93 1	57	420.839,867 480.256,785	58	420.778,888 480.278,378	64.68 8
58	420.778,888 480.278,378	59	420.712,732 480.307,014	72.08 8	59	420.712,732 480.307,014	60	420.698,05 480.314,855	16.64 4	60	420.698,05 480.314,855	61	420.680,432 480.327,49	21.68 1
61	420.680,432 480.327,49	62	420.672,517 480.332,862	9.565	62	420.672,517 480.332,862	63	420.663,558 480.338,108	10.38 3	63	420.663,558 480.338,108	64	420.655,088 480.341,269	9.04
64	420.655,088 480.341,269	65	420.645,472 480.343,716	9.922	65	420.645,472 480.343,716	66	420.597,885 480.351,283	48.18 5	66	420.597,885 480.351,283	67	420.565,946 480.354,906	32.14 4
67	420.565,946 480.354,906	68	420.547,341 480.354,555	18.60 8	68	420.547,341 480.354,555	69	420.537,279 480.352,988	10.18 4	69	420.537,279 480.352,988	70	420.520,098 480.348,985	17.64 1
70	420.520,098 480.348,985	71	420.437,539 480.318,96	87.85	71	420.437,539 480.318,96	72	420.414,716 480.311,094	24.14	72	420.414,716 480.311,094	73	420.402,579 480.305,24	13.47 5
73	420.402,579 480.305,24	74	420.369,346 480.283,544	39.68 9	74	420.369,346 480.283,544	75	420.355,776 480.276,338	15.36 5	75	420.355,776 480.276,338	76	420.352,053 480.274,56	4.126
76	420.352,053 480.274,56	77	420.360,572 480.263,579	13.89 8	77	420.360,572 480.263,579	78	420.377,122 480.272,986	19.03 6	78	420.377,122 480.272,986	79	420.409,559 480.293,114	38.17 5
79	420.409,559 480.293,114	80	420.420,509 480.298,596	12.24 5	80	420.420,509 480.298,596	81	420.442,28 480.306,227	23.07	81	420.442,28 480.306,227	82	420.524,912 480.334,141	87.21 9
82	420.524,912 480.334,141	83	420.540,761 480.338,19	16.35 8	83	420.540,761 480.338,19	84	420.550,279 480.339,852	9.662	84	420.550,279 480.339,852	85	420.564,259 480.340,755	14.01
85	420.564,259 480.340,755	86	420.587,128 480.338,88	22.94 6	86	420.587,128 480.338,88	87	420.595,997 480.338,153	8.899	87	420.595,997 480.338,153	88	420.642,167 480.329,823	46.91 6
88	420.642,167 480.329,823	89	420.649,987 480.327,672	8.11	89	420.649,987 480.327,672	90	420.659,323 480.323,603	10.18 4	90	420.659,323 480.323,603	91	420.669,497 480.317,559	11.83 4
91	420.669,497 480.317,559	92	420.687,99 480.304,026	22.91 6	92	420.687,99 480.304,026	93	420.688,602 480.303,578	0.758	93	420.688,602 480.303,578	94	420.706,071 480.294,096	19.87 7
94	420.706,071 480.294,096	95	420.773,444 480.266,521	72.79 8	95	420.773,444 480.266,521	96	420.833,747 480.244,676	64.13 8	96	420.833,747 480.244,676	97	420.872,447 480.226,024	42.96
97	420.872,447 480.226,024	98	420.873,715 480.225,413	1.407	98	420.873,715 480.225,413	99	420.905,649 480.213,91	33.94 3	99	420.905,649 480.213,91	100	420.934,015 480.205,648	29.54 5
100	420.934,015 480.205,648	101	421.103,945 480.178,058	172.1 56	101	421.103,945 480.178,058	102	421.120,468 480.176,369	16.60 9	102	421.120,468 480.176,369	103	421.140,806 480.176,533	20.33 8
103	421.140,806 480.176,533	104	421.173,557 480.181,485	33.12 3	104	421.173,557 480.181,485	105	421.281,364 480.198,152	109.0 88	105	421.281,364 480.198,152	106	421.511,57 480.233,742	232.9 41
106	421.511,57 480.233,742	107	421.530,387 480.238,46	19.39 9	107	421.530,387 480.238,46	108	421.545,799 480.244,282	16.47 5	108	421.545,799 480.244,282	109	421.643,812 480.293,756	109.7 92
109	421.643,812 480.293,756	110	421.654,101 480.298,949	11.52 5	110	421.654,101 480.298,949	111	421.721,223 480.332,83	75.18 8	111	421.721,223 480.332,83	112	421.785,035 480.365,039	71.48
112	421.785,035 480.365,039	113	421.815,987 480.373,558	32.10 3	113	421.815,987 480.373,558	114	421.913,202 480.385,43	97.93 7	114	421.913,202 480.385,43	115	421.964,823 480.382,07	51.73 1

Punct început	X / Y	Punct sfârșit	X / Y	Lungime segment	Punct început	X / Y	Punct sfârșit	X / Y	Lungime segment	Punct început	X / Y	Punct sfârșit	X / Y	Lungime segment
115	421.964,823 480.382,07	116	422.122,834 480.391,378	158,2 85	116	422.122,834 480.391,378	117	422.150,182 480.392,037	27,35 6	117	422.150,182 480.392,037	118	422.184,852 480.387,198	35,00 6
118	422.184,852 480.387,198	119	422.311,865 480.366,586	128,6 74	119	422.311,865 480.366,586	120	422.384,472 480.355,139	73,50 3	120	422.384,472 480.355,139	121	422.403,557 480.350,785	19,57 6
121	422.403,557 480.350,785	122	422.416,6 480.347,048	13,56 8	122	422.416,6 480.347,048	123	422.424,385 480.343,583	8,521	123	422.424,385 480.343,583	124	422.434,029 480.338,569	10,87
124	422.434,029 480.338,569	125	422.453,48 480.324,844	23,80 6	125	422.453,48 480.324,844	126	422.649,353 480.222,349	221,0 68	126	422.649,353 480.222,349	127	422.712,4 480.180,996	75,39 9
127	422.712,4 480.180,996	128	422.723,043 480.174,015	12,72 8	128	422.723,043 480.174,015	129	422.776,089 480.139,221	63,43 9	129	422.776,089 480.139,221	130	422.784,419 480.133,757	9,962
130	422.784,419 480.133,757	131	422.823,132 480.116,335	42,45 3	131	422.823,132 480.116,335	132	422.854,982 480.105,352	33,69	132	422.854,982 480.105,352	133	422.897,175 480.094,763	43,50 1
133	422.897,175 480.094,763	134	422.928,793 480.084,656	33,19 4	134	422.928,793 480.084,656	135	422.970,291 480.071,392	43,56 6	135	422.970,291 480.071,392	136	422.986,202 480.066,307	16,70 4
136	422.986,202 480.066,307	137	423.053,636 480.044,752	70,79 5	137	423.053,636 480.044,752	138	423.208,856 479.994,869	163,0 39	138	423.208,856 479.994,869	139	423.266,374 479.975,953	60,54 9
139	423.266,374 479.975,953	140	423.266,47 479.975,921	0,101	140	423.266,47 479.975,921	141	423.296,767 479.965,957	31,89 3	141	423.296,767 479.965,957	142	423.314,004 479.960,289	18,14 5
142	423.314,004 479.960,289	143	423.319,716 479.958,533	5,976	143	423.319,716 479.958,533	144	423.379,074 479.940,295	62,09 7	144	423.379,074 479.940,295	145	423.404,21 479.932,469	26,32 6
145	423.404,21 479.932,469	146	423.421,843 479.926,978	18,46 8	146	423.421,843 479.926,978	147	423.493,096 479.904,794	74,62 7	147	423.493,096 479.904,794	148	423.528,822 479.893,784	37,38 4
148	423.528,822 479.893,784	149	423.536,886 479.891,299	8,438	149	423.536,886 479.891,299	150	423.540,873 479.890,071	4,172	150	423.540,873 479.890,071	151	423.550,936 479.886,969	10,53
151	423.550,936 479.886,969	152	423.565,542 479.882,469	15,28 3	152	423.565,542 479.882,469	153	423.570,759 479.881,005	5,419	153	423.570,759 479.881,005	154	423.597,661 479.873,455	27,94 1
154	423.597,661 479.873,455	155	423.667,035 479.861,839	70,34	155	423.667,035 479.861,839	156	423.727,957 479.862,805	60,93	156	423.727,957 479.862,805	157	423.771,769 479.862,875	43,81 2
157	423.771,769 479.862,875	158	423.771,592 479.864,103	1,241	158	423.771,592 479.864,103	159	423.771,127 479.867,322	3,252	159	423.771,127 479.867,322	160	423.770,699 479.870,291	3,0
160	423.770,699 479.870,291	1	423.770,128 479.874,249	3,999										

\*\* Lungimile segmentelor sunt determinate în planul de proiecție Stereo 70 și sunt rotunjite la 1 milimetru.

\*\*\* Distanța dintre puncte este formată din segmente cumulate ce sunt mai mici decât valoarea 1 milimetru.

**DATE DESPRE IMOBILUL NR. 4954**

Oficiul de Cadastru și Publicitate Imobiliară SIBIU  
Biroul de Cadastru și Publicitate Imobiliară Sibiu

**A. Partea I. Descrierea imobilului**

TEREN Extravilan

Adresa: Jud. Sibiu

Nr. Crt	Nr cadastral Nr. topografic	Suprafața* (mp)	Observații / Referințe
A1	108244	818.543	Sector cadastral:38 Teren neimpregmuit;

**B. Partea II. Proprietari și acte**

Inscrieri privitoare la dreptul de proprietate și alte drepturi reale		Referințe
<b>42653 / 04/05/2023</b>		
Inscris Sub Semnatura Privata nr. ORDINUL PREFECTULUI nr. 142, din 18/03/2011 emis de INSTITUTIA PREFECTULUI-JUDETUL SIBIU ;		
B1	se infiinteaza CF 108244 Sura Mica pentru parcelele nr. 800, 801, 803, 804, 805, 806, 807, 808, 809, 810, 811, 812, 813, 814, 815, 816, 817, 818, 819, 820, 821, 822, 823, 824, 825, 826, 827	A1
Inscris Sub Semnatura Privata nr. ORDINUL PREFECTULUI nr. 142, din 18/03/2011 emis de INSTITUTIA PREFECTULUI-JUDETUL SIBIU;		
B2	Intabulare, drept de PROPRIETATEart. 33 si 44 din Legea 18/1991, dobandit prin Lege, cota actuala 1/1	A1
1) COMUNA SURA MICA - DOMENIUL PRIVAT, CIF:999999999999		

**C. Partea III. SARCINI .**

Inscrieri privind dezmembramintele dreptului de proprietate, drepturi reale de garanție și sarcini	Referințe
NU SUNT	

## Anexa Nr. 1 La Partea I

## Teren

Nr cadastral	Suprafața (mp)*	Observații / Referințe
108244	818.543	

\* Suprafața este determinată în planul de proiecție Stereo 70.

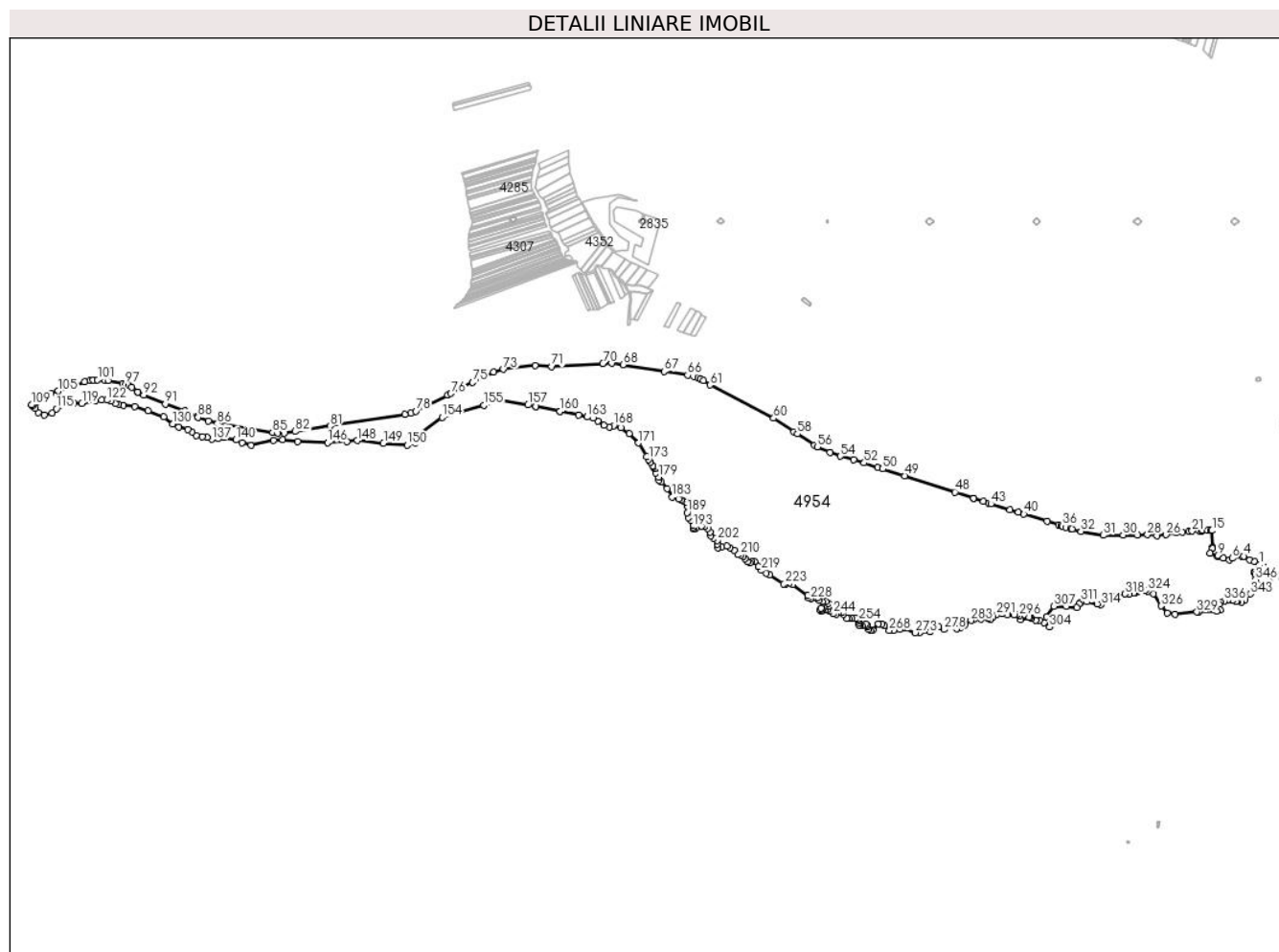

## Date referitoare la teren

Crt	Categorie folosință	Intravilan	Suprafața (mp)	Tarla	Parcelă	Nr. topo	Observații / Referințe
1	ape curgătoare	NU	500	34	800	-	Parau
2	neproductiv	NU	1.500	34	801	-	
3	neproductiv	NU	700	34	803	-	
4	neproductiv	NU	4.900	34	804	-	
5	neproductiv	NU	300	34	805	-	
6	neproductiv	NU	200	34	806	-	
7	neproductiv	NU	9.300	34	807	-	
8	pasune	NU	232.719	34	808	-	
9	neproductiv	NU	5.000	34	809	-	
10	neproductiv	NU	1.700	34	810	-	
11	neproductiv	NU	2.200	34	811	-	
12	pasune	NU	15.900	34	812	-	
13	neproductiv	NU	19.200	34	813	-	
14	neproductiv	NU	900	34	814	-	
15	neproductiv	NU	1.800	34	815	-	
16	neproductiv	NU	900	34	816	-	

Crt	Categorie folosință	Intravilan	Suprafața (mp)	Tarla	Parcelă	Nr. topo	Observații / Referințe
17	neproductiv	NU	700	34	817	-	
18	neproductiv	NU	3.300	34	818	-	
19	neproductiv	NU	4.300	34	819	-	
20	neproductiv	NU	1.500	34	820	-	
21	pasune	NU	367.917	34	821	-	
22	neproductiv	NU	7.532	34	822	-	
23	neproductiv	NU	1.200	34	823	-	
24	neproductiv	NU	1.200	34	824	-	
25	neproductiv	NU	449	34	825	-	
26	neproductiv	NU	5.500	34	826	-	Tufaris
27	pasune	NU	127.226	34	827	-	

**Lungime Segmente**

1) Valorile lungimilor segmentelor sunt obținute din proiecție în plan.

Punct început	X / Y	Punct sfârșit	X / Y	Lungime segment	Punct început	X / Y	Punct sfârșit	X / Y	Lungime segment	Punct început	X / Y	Punct sfârșit	X / Y	Lungime segment
1	424.149,308 479.771,749	2	424.133,171 479.779,405	17.861	2	424.133,171 479.779,405	3	424.118,807 479.786,416	15.984	3	424.118,807 479.786,416	4	424.099,652 479.797,253	22.008
4	424.099,652 479.797,253	5	424.094,516 479.797,89	5.176	5	424.094,516 479.797,89	6	424.064,2 479.790,528	31.196	6	424.064,2 479.790,528	7	424.055,526 479.784,96	10.308
7	424.055,526 479.784,96	8	424.036,778 479.791,282	19.786	8	424.036,778 479.791,282	9	424.019,365 479.799,21	19.133	9	424.019,365 479.799,21	10	424.018,754 479.797,115	2.183
10	424.018,754 479.797,115	11	423.995,234 479.806,097	25.176	11	423.995,234 479.806,097	12	424.002,533 479.821,734	17.257	12	424.002,533 479.821,734	13	424.002,945 479.822,617	0.975
13	424.002,945 479.822,617	14	424.003,722 479.825,068	2.572	14	424.003,722 479.825,068	15	424.002,316 479.876,102	51.053	15	424.002,316 479.876,102	16	423.996,924 479.876,678	5.423
16	423.996,924 479.876,678	17	423.988,402 479.876,226	8.534	17	423.988,402 479.876,226	18	423.970,909 479.877,005	17.51	18	423.970,909 479.877,005	19	423.970,773 479.875,451	1.56
19	423.970,773 479.875,451	20	423.961,515 479.875,754	9.263	20	423.961,515 479.875,754	21	423.940,701 479.874,504	20.852	21	423.940,701 479.874,504	22	423.930,122 479.873,817	10.601
22	423.930,122 479.873,817	23	423.910,97 479.871,65	19.274	23	423.910,97 479.871,65	24	423.892,448 479.868,995	18.711	24	423.892,448 479.868,995	25	423.892,129 479.871,059	2.089
25	423.892,129 479.871,059	26	423.859,929 479.863,45	33.087	26	423.859,929 479.863,45	27	423.831,609 479.860,949	28.43	27	423.831,609 479.860,949	28	423.802,855 479.863,191	28.841
28	423.802,855 479.863,191	29	423.771,769 479.862,875	31.088	29	423.771,769 479.862,875	30	423.727,957 479.862,805	43.812	30	423.727,957 479.862,805	31	423.667,035 479.861,839	60.93
31	423.667,035 479.861,839	32	423.597,661 479.873,455	70.34	32	423.597,661 479.873,455	33	423.570,759 479.881,005	27.941	33	423.570,759 479.881,005	34	423.565,542 479.882,469	5.419
34	423.565,542 479.882,469	35	423.550,936 479.886,969	15.283	35	423.550,936 479.886,969	36	423.540,873 479.890,071	10.53	36	423.540,873 479.890,071	37	423.536,886 479.891,299	4.172
37	423.536,886 479.891,299	38	423.528,822 479.893,784	8.438	38	423.528,822 479.893,784	39	423.493,096 479.904,794	37.384	39	423.493,096 479.904,794	40	423.421,843 479.926,978	74.627
40	423.421,843 479.926,978	41	423.404,21 479.932,469	18.468	41	423.404,21 479.932,469	42	423.379,074 479.940,295	26.326	42	423.379,074 479.940,295	43	423.319,716 479.958,533	62.097
43	423.319,716 479.958,533	44	423.314,004 479.960,289	5.976	44	423.314,004 479.960,289	45	423.296,767 479.965,957	18.145	45	423.296,767 479.965,957	46	423.266,47 479.975,921	31.893
46	423.266,47 479.975,921	47	423.266,374 479.975,953	0.101	47	423.266,374 479.975,953	48	423.208,856 479.994,869	60.549	48	423.208,856 479.994,869	49	423.053,636 480.044,752	163.039
49	423.053,636 480.044,752	50	422.986,202 480.066,307	70.795	50	422.986,202 480.066,307	51	422.970,291 480.071,392	16.704	51	422.970,291 480.071,392	52	422.928,793 480.084,656	43.566
52	422.928,793 480.084,656	53	422.897,175 480.094,763	33.194	53	422.897,175 480.094,763	54	422.854,982 480.105,352	43.501	54	422.854,982 480.105,352	55	422.823,132 480.116,335	33.69
55	422.823,132 480.116,335	56	422.784,419 480.133,757	42.453	56	422.784,419 480.133,757	57	422.776,089 480.139,221	9.962	57	422.776,089 480.139,221	58	422.723,043 480.174,015	63.439
58	422.723,043 480.174,015	59	422.712,4 480.180,996	12.728	59	422.712,4 480.180,996	60	422.649,353 480.222,349	75.399	60	422.649,353 480.222,349	61	422.453,48 480.324,844	221.068

Punct început	X / Y	Punct sfârșit	X / Y	Lungime segment	Punct început	X / Y	Punct sfârșit	X / Y	Lungime segment	Punct început	X / Y	Punct sfârșit	X / Y	Lungime segment
61	422.453,48 480.324,844	62	422.434,029 480.338,569	23.806	62	422.434,029 480.338,569	63	422.424,385 480.343,583	10.87	63	422.424,385 480.343,583	64	422.416,6 480.347,048	8.521
64	422.416,6 480.347,048	65	422.403,557 480.350,785	13.568	65	422.403,557 480.350,785	66	422.384,472 480.355,139	19.576	66	422.384,472 480.355,139	67	422.311,865 480.366,586	73.503
67	422.311,865 480.366,586	68	422.184,852 480.387,198	128.674	68	422.184,852 480.387,198	69	422.150,182 480.392,037	35.006	69	422.150,182 480.392,037	70	422.122,834 480.391,378	27.356
70	422.122,834 480.391,378	71	421.964,823 480.382,07	158.285	71	421.964,823 480.382,07	72	421.913,202 480.385,43	51.731	72	421.913,202 480.385,43	73	421.815,987 480.373,558	97.937
73	421.815,987 480.373,558	74	421.785,035 480.365,039	32.103	74	421.785,035 480.365,039	75	421.721,223 480.332,83	71.48	75	421.721,223 480.332,83	76	421.654,101 480.298,949	75.188
76	421.654,101 480.298,949	77	421.643,812 480.293,756	11.525	77	421.643,812 480.293,756	78	421.545,799 480.244,282	109.792	78	421.545,799 480.244,282	79	421.530,387 480.238,46	16.475
79	421.530,387 480.238,46	80	421.511,57 480.233,742	19.399	80	421.511,57 480.233,742	81	421.281,364 480.198,152	232.941	81	421.281,364 480.198,152	82	421.173,557 480.181,485	109.088
82	421.173,557 480.181,485	83	421.140,806 480.176,533	33.123	83	421.140,806 480.176,533	84	421.120,468 480.176,369	20.338	84	421.120,468 480.176,369	85	421.103,945 480.178,058	16.609
85	421.103,945 480.178,058	86	420.934,015 480.205,648	172.156	86	420.934,015 480.205,648	87	420.905,649 480.213,91	29.545	87	420.905,649 480.213,91	88	420.873,715 480.225,413	33.943
88	420.873,715 480.225,413	89	420.872,447 480.226,024	1.407	89	420.872,447 480.226,024	90	420.833,747 480.244,676	42.96	90	420.833,747 480.244,676	91	420.773,444 480.266,521	64.138
91	420.773,444 480.266,521	92	420.706,071 480.294,096	72.798	92	420.706,071 480.294,096	93	420.688,602 480.303,578	19.877	93	420.688,602 480.303,578	94	420.687,99 480.304,026	0.758
94	420.687,99 480.304,026	95	420.669,497 480.317,559	22.916	95	420.669,497 480.317,559	96	420.659,323 480.323,603	11.834	96	420.659,323 480.323,603	97	420.649,987 480.327,672	10.184
97	420.649,987 480.327,672	98	420.642,167 480.329,823	8.11	98	420.642,167 480.329,823	99	420.595,997 480.338,153	46.916	99	420.595,997 480.338,153	100	420.587,128 480.338,88	8.899
100	420.587,128 480.338,88	101	420.564,259 480.340,755	22.946	101	420.564,259 480.340,755	102	420.550,279 480.339,852	14.01	102	420.550,279 480.339,852	103	420.540,761 480.338,19	9.662
103	420.540,761 480.338,19	104	420.524,912 480.334,141	16.358	104	420.524,912 480.334,141	105	420.442,28 480.306,227	87.219	105	420.442,28 480.306,227	106	420.420,509 480.298,596	23.07
106	420.420,509 480.298,596	107	420.409,559 480.293,114	12.245	107	420.409,559 480.293,114	108	420.377,122 480.272,986	38.175	108	420.377,122 480.272,986	109	420.360,572 480.263,579	19.036
109	420.360,572 480.263,579	110	420.362,888 480.261,252	3.283	110	420.362,888 480.261,252	111	420.371,232 480.252,868	11.828	111	420.371,232 480.252,868	112	420.381,876 480.240,2	16.546
112	420.381,876 480.240,2	113	420.399,735 480.232,924	19.285	113	420.399,735 480.232,924	114	420.424,209 480.238,673	25.14	114	420.424,209 480.238,673	115	420.436,777 480.251,444	17.918
115	420.436,777 480.251,444	116	420.448,683 480.261,952	15.88	116	420.448,683 480.261,952	117	420.462,364 480.267,489	14.758	117	420.462,364 480.267,489	118	420.491,678 480.269,618	29.391
118	420.491,678 480.269,618	119	420.515,737 480.267,63	24.141	119	420.515,737 480.267,63	120	420.558,485 480.277,241	43.815	120	420.558,485 480.277,241	121	420.577,006 480.278,419	18.558
121	420.577,006 480.278,419	122	420.592,94 480.278,386	15.933	122	420.592,94 480.278,386	123	420.604,881 480.274,586	12.532	123	420.604,881 480.274,586	124	420.618,934 480.267,063	15.94
124	420.618,934 480.267,063	125	420.629,261 480.265,075	10.516	125	420.629,261 480.265,075	126	420.643,152 480.261,669	14.302	126	420.643,152 480.261,669	127	420.678,209 480.259,382	35.132
127	420.678,209 480.259,382	128	420.720,543 480.246,153	44.352	128	420.720,543 480.246,153	129	420.768,168 480.226,309	51.594	129	420.768,168 480.226,309	130	420.795,949 480.204,481	35.331
130	420.795,949 480.204,481	131	420.815,132 480.195,882	21.022	131	420.815,132 480.195,882	132	420.842,251 480.187,283	28.45	132	420.842,251 480.187,283	133	420.855,955 480.180,651	15.224
133	420.855,955 480.180,651	134	420.868,873 480.169,862	16.83	134	420.868,873 480.169,862	135	420.887,643 480.166,314	19.103	135	420.887,643 480.166,314	136	420.902,373 480.163,475	15.001
136	420.902,373 480.163,475	137	420.916,996 480.157,517	15.79	137	420.916,996 480.157,517	138	420.935,517 480.160,824	18.814	138	420.935,517 480.160,824	139	420.954,7 480.164,132	19.465
139	420.954,7 480.164,132	140	420.991,741 480.155,533	38.027	140	420.991,741 480.155,533	141	421.010,262 480.146,934	20.42	141	421.010,262 480.146,934	142	421.037,083 480.138,634	28.076
142	421.037,083 480.138,634	143	421.106,835 480.154,21	71.47	143	421.106,835 480.154,21	144	421.135,278 480.156,856	28.566	144	421.135,278 480.156,856	145	421.181,58 480.150,903	46.683
145	421.181,58 480.150,903	146	421.273,523 480.147,595	92.002	146	421.273,523 480.147,595	147	421.333,716 480.150,241	60.251	147	421.333,716 480.150,241	148	421.364,804 480.153,548	31.264
148	421.364,804 480.153,548	149	421.446,164 480.144,95	81.813	149	421.446,164 480.144,95	150	421.518,925 480.139,658	72.953	150	421.518,925 480.139,658	151	421.543,399 480.147,595	25.729
151	421.543,399 480.147,595	152	421.543,399 480.161,486	13.891	152	421.543,399 480.161,486	153	421.553,32 480.169,424	12.706	153	421.553,32 480.169,424	154	421.626,743 480.224,986	92.076
154	421.626,743 480.224,986	155	421.755,066 480.262,028	133.562	155	421.755,066 480.262,028	156	421.807,982 480.276,58	54.881	156	421.807,982 480.276,58	157	421.891,988 480.263,351	85.041
157	421.891,988 480.263,351	158	421.915,67 480.258,534	24.167	158	421.915,67 480.258,534	159	421.915,768 480.258,515	0.1	159	421.915,768 480.258,515	160	421.990,234 480.243,368	75.991



Punct început	X / Y	Punct sfârșit	X / Y	Lungime segment	Punct început	X / Y	Punct sfârșit	X / Y	Lungime segment	Punct început	X / Y	Punct sfârșit	X / Y	Lungime segment
160	421.990,234 480.243,368	161	421.990,332 480.243,348	0.1	161	421.990,332 480.243,348	162	422.048,092 480.231,601	58.94 3	162	422.048,092 480.231,601	163	422.073,889 480.226,309	26.33 4
163	422.073,889 480.226,309	164	422.093,072 480.223,002	19.46 5	164	422.093,072 480.223,002	165	422.107,624 480.213,741	17.24 9	165	422.107,624 480.213,741	166	422.125,483 480.200,512	22.22 5
166	422.125,483 480.200,512	167	422.142,02 480.195,22	17.36 3	167	422.142,02 480.195,22	168	422.155,91 480.199,189	14.44 7	168	422.155,91 480.199,189	169	422.179,061 480.192,575	24.07 8
169	422.179,061 480.192,575	170	422.203,535 480.174,054	30.69 2	170	422.203,535 480.174,054	171	422.232,64 480.146,272	40.23 5	171	422.232,64 480.146,272	172	422.258,11 480.104,215	49.16 9
172	422.258,11 480.104,215	173	422.263,964 480.095,227	10.72 6	173	422.263,964 480.095,227	174	422.270,028 480.086,636	10.51 5	174	422.270,028 480.086,636	175	422.276,934 480.076,855	11.97 3
175	422.276,934 480.076,855	176	422.279,58 480.071,563	5.916	176	422.279,58 480.071,563	177	422.282,775 480.067,106	5.485	177	422.282,775 480.067,106	178	422.286,744 480.054,009	13.68 5
178	422.286,744 480.054,009	179	422.295,078 480.040,515	15.86	179	422.295,078 480.040,515	180	422.295,872 480.031,784	8.767	180	422.295,872 480.031,784	181	422.302,619 480.026,227	8.74
181	422.302,619 480.026,227	182	422.320,875 480.005,987	27.25 8	182	422.320,875 480.005,987	183	422.336,75 479.980,19	30.29	183	422.336,75 479.980,19	184	422.356,991 479.973,443	21.33 6
184	422.356,991 479.973,443	185	422.363,548 479.970,474	7.198	185	422.363,548 479.970,474	186	422.369,745 479.967,667	6.803	186	422.369,745 479.967,667	187	422.378,025 479.963,918	9.089
187	422.378,025 479.963,918	188	422.382,788 479.950,821	13.93 6	188	422.382,788 479.950,821	189	422.382,788 479.931,374	19.44 7	189	422.382,788 479.931,374	190	422.385,963 479.916,69	15.02 3
190	422.385,963 479.916,69	191	422.395,488 479.907,165	13.47	191	422.395,488 479.907,165	192	422.401,044 479.892,877	15.33	192	422.401,044 479.892,877	193	422.400,647 479.886,527	6.362
193	422.400,647 479.886,527	194	422.402,631 479.880,177	6.653	194	422.402,631 479.880,177	195	422.408,981 479.882,162	6.653	195	422.408,981 479.882,162	196	422.427,635 479.889,702	20.12
196	422.427,635 479.889,702	197	422.437,557 479.888,908	9.954	197	422.437,557 479.888,908	198	422.447,082 479.882,955	11.23 2	198	422.447,082 479.882,955	199	422.453,035 479.872,24	12.25 8
199	422.453,035 479.872,24	200	422.455,019 479.859,54	12.85 4	200	422.455,019 479.859,54	201	422.464,941 479.851,999	12.46 2	201	422.464,941 479.851,999	202	422.475,26 479.845,649	12.11 6
202	422.475,26 479.845,649	203	422.476,053 479.834,14	11.53 6	203	422.476,053 479.834,14	204	422.477,641 479.823,821	10.44	204	422.477,641 479.823,821	205	422.489,15 479.825,011	11.57
205	422.489,15 479.825,011	206	422.505,025 479.828,583	16.27 2	206	422.505,025 479.828,583	207	422.515,741 479.823,821	11.72 6	207	422.515,741 479.823,821	208	422.528,441 479.815,09	15.41 2
208	422.528,441 479.815,09	209	422.538,76 479.801,993	16.67 4	209	422.538,76 479.801,993	210	422.547,888 479.800,405	9.265	210	422.547,888 479.800,405	211	422.555,032 479.796,436	8.172
211	422.555,032 479.796,436	212	422.560,588 479.789,293	9.049	212	422.560,588 479.789,293	213	422.568,129 479.779,768	12.14 9	213	422.568,129 479.779,768	214	422.577,257 479.776,196	9.802
214	422.577,257 479.776,196	215	422.582,416 479.779,768	6.275	215	422.582,416 479.779,768	216	422.590,751 479.780,164	8.344	216	422.590,751 479.780,164	217	422.601,976 479.765,859	18.18 3
217	422.601,976 479.765,859	218	422.602,038 479.765,78	0.1	218	422.602,038 479.765,78	219	422.611,904 479.753,283	15.92 2	219	422.611,904 479.753,283	220	422.627,448 479.745,345	17.45 4
220	422.627,448 479.745,345	221	422.637,701 479.739,392	11.85 6	221	422.637,701 479.739,392	222	422.679,704 479.712,272	49.99 7	222	422.679,704 479.712,272	223	422.686,318 479.711,28	6.688
223	422.686,318 479.711,28	224	422.698,225 479.712,603	11.98	224	422.698,225 479.712,603	225	422.708,146 479.709,957	10.26 8	225	422.708,146 479.709,957	226	422.754,779 479.675,892	57.75
226	422.754,779 479.675,892	227	422.756,102 479.668,616	7.395	227	422.756,102 479.668,616	228	422.763,378 479.665,97	7.742	228	422.763,378 479.665,97	229	422.772,639 479.670,931	10.50 6
229	422.772,639 479.670,931	230	422.785,207 479.667,954	12.91 6	230	422.785,207 479.667,954	231	422.791,16 479.661,009	9.147	231	422.791,16 479.661,009	232	422.800,089 479.657,04	9.771
232	422.800,089 479.657,04	233	422.810,342 479.657,04	10.25 3	233	422.810,342 479.657,04	234	422.818,941 479.651,418	10.27 4	234	422.818,941 479.651,418	235	422.821,587 479.645,134	6.818
235	422.821,587 479.645,134	236	422.815,634 479.641,827	6.81	236	422.815,634 479.641,827	237	422.795,79 479.636,535	20.53 8	237	422.795,79 479.636,535	238	422.791,88 479.631,923	6.046
238	422.791,88 479.631,923	239	422.796,123 479.627,681	6.0	239	422.796,123 479.627,681	240	422.799,759 479.630,251	4.453	240	422.799,759 479.630,251	241	422.809,019 479.631,574	9.354
241	422.809,019 479.631,574	242	422.814,641 479.631,243	5.632	242	422.814,641 479.631,243	243	422.821,587 479.627,275	7.999	243	422.821,587 479.627,275	244	422.832,832 479.619,337	13.76 5
244	422.832,832 479.619,337	245	422.842,753 479.617,684	10.05 8	245	422.842,753 479.617,684	246	422.850,691 479.623,967	10.12 4	246	422.850,691 479.623,967	247	422.860,282 479.623,637	9.597
247	422.860,282 479.623,637	248	422.865,243 479.617,684	7.749	248	422.865,243 479.617,684	249	422.876,488 479.604,785	17.11 2	249	422.876,488 479.604,785	250	422.880,787 479.605,116	4.312
250	422.880,787 479.605,116	251	422.891,371 479.605,116	10.58 4	251	422.891,371 479.605,116	252	422.903,608 479.605,116	12.23 7	252	422.903,608 479.605,116	253	422.910,884 479.603,793	7.395
253	422.910,884 479.603,793	254	422.913,53 479.599,163	5.333	254	422.913,53 479.599,163	255	422.913,53 479.592,879	6.284	255	422.913,53 479.592,879	256	422.913,199 479.585,603	7.284
256	422.913,199 479.585,603	257	422.916,176 479.582,295	4.45	257	422.916,176 479.582,295	258	422.922,79 479.582,626	6.622	258	422.922,79 479.582,626	259	422.934,035 479.587,918	12.42 8

Punct început	X / Y	Punct sfârșit	X / Y	Lungime segment	Punct început	X / Y	Punct sfârșit	X / Y	Lungime segment	Punct început	X / Y	Punct sfârșit	X / Y	Lungime segment
259	422.934,035 479.587,918	260	422.937,342 479.584,28	4.916	260	422.937,342 479.584,28	261	422.938,334 479.578,988	5.384	261	422.938,334 479.578,988	262	422.942,634 479.572,374	7.889
262	422.942,634 479.572,374	263	422.948,918 479.568,736	7.261	263	422.948,918 479.568,736	264	422.955,532 479.569,066	6.622	264	422.955,532 479.569,066	265	422.972,069 479.589,241	26.086
265	422.972,069 479.589,241	266	422.983,314 479.587,918	11.323	266	422.983,314 479.587,918	267	422.991,913 479.583,618	9.614	267	422.991,913 479.583,618	268	423.006,465 479.568,074	21.293
268	423.006,465 479.568,074	269	423.019,032 479.568,074	12.567	269	423.019,032 479.568,074	270	423.039,538 479.571,381	20.771	270	423.039,538 479.571,381	271	423.047,475 479.575,681	9.027
271	423.047,475 479.575,681	272	423.054,421 479.575,019	6.977	272	423.054,421 479.575,019	273	423.086,832 479.561,129	35.262	273	423.086,832 479.561,129	274	423.101,053 479.561,79	14.236
274	423.101,053 479.561,79	275	423.132,142 479.564,767	31.231	275	423.132,142 479.564,767	276	423.147,356 479.577,004	19.525	276	423.147,356 479.577,004	277	423.158,931 479.579,65	11.874
277	423.158,931 479.579,65	278	423.175,137 479.571,381	18.194	278	423.175,137 479.571,381	279	423.198,288 479.585,933	27.345	279	423.198,288 479.585,933	280	423.213,832 479.573,696	19.783
280	423.213,832 479.573,696	281	423.225,739 479.576,673	12.274	281	423.225,739 479.576,673	282	423.238,968 479.584,941	15.6	282	423.238,968 479.584,941	283	423.258,812 479.598,832	24.223
283	423.258,812 479.598,832	284	423.268,072 479.603,462	10.353	284	423.268,072 479.603,462	285	423.288,908 479.603,131	20.839	285	423.288,908 479.603,131	286	423.297,507 479.608,423	10.097
286	423.297,507 479.608,423	287	423.304,122 479.609,085	6.648	287	423.304,122 479.609,085	288	423.311,067 479.605,777	7.693	288	423.311,067 479.605,777	289	423.318,674 479.602,47	8.295
289	423.318,674 479.602,47	290	423.326,942 479.609,085	10.589	290	423.326,942 479.609,085	291	423.337,195 479.616,03	12.384	291	423.337,195 479.616,03	292	423.354,062 479.619,999	17.328
292	423.354,062 479.619,999	293	423.370,268 479.616,691	16.54	293	423.370,268 479.616,691	294	423.391,765 479.616,361	21.5	294	423.391,765 479.616,361	295	423.400,364 479.616,361	8.599
295	423.400,364 479.616,361	296	423.408,632 479.613,053	8.905	296	423.408,632 479.613,053	297	423.411,566 479.600,69	12.706	297	423.411,566 479.600,69	298	423.438,078 479.608,205	27.557
298	423.438,078 479.608,205	299	423.440,543 479.608,588	2.495	299	423.440,543 479.608,588	300	423.444,957 479.606,088	5.073	300	423.444,957 479.606,088	301	423.458,324 479.599,466	14.917
301	423.458,324 479.599,466	302	423.468,908 479.600,127	10.605	302	423.468,908 479.600,127	303	423.484,121 479.592,851	16.863	303	423.484,121 479.592,851	304	423.500,658 479.578,961	21.596
304	423.500,658 479.578,961	305	423.503,304 479.582,929	4.769	305	423.503,304 479.582,929	306	423.492,059 479.610,049	29.359	306	423.492,059 479.610,049	307	423.514,548 479.643,122	39.995
307	423.514,548 479.643,122	308	423.552,252 479.643,122	37.704	308	423.552,252 479.643,122	309	423.585,325 479.639,153	33.31	309	423.585,325 479.639,153	310	423.591,278 479.649,075	11.571
310	423.591,278 479.649,075	311	423.598,554 479.656,351	10.29	311	423.598,554 479.656,351	312	423.615,752 479.657,013	17.211	312	423.615,752 479.657,013	313	423.648,163 479.650,398	33.079
313	423.648,163 479.650,398	314	423.659,408 479.647,752	11.552	314	423.659,408 479.647,752	315	423.677,268 479.667,596	26.698	315	423.677,268 479.667,596	316	423.680,577 479.668,305	3.384
316	423.680,577 479.668,305	317	423.695,788 479.671,565	15.556	317	423.695,788 479.671,565	318	423.733,492 479.680,825	38.824	318	423.733,492 479.680,825	319	423.746,721 479.680,164	13.246
319	423.746,721 479.680,164	320	423.759,351 479.683,726	13.123	320	423.759,351 479.683,726	321	423.764,597 479.685,206	5.451	321	423.764,597 479.685,206	322	423.772,518 479.687,44	8.23
322	423.772,518 479.687,44	323	423.796,33 479.693,393	24.545	323	423.796,33 479.693,393	324	423.804,929 479.688,763	9.766	324	423.804,929 479.688,763	325	423.820,804 479.680,825	17.749
325	423.820,804 479.680,825	326	423.844,617 479.643,784	44.035	326	423.844,617 479.643,784	327	423.863,799 479.621,294	29.559	327	423.863,799 479.621,294	328	423.888,273 479.618,648	24.617
328	423.888,273 479.618,648	329	423.955,081 479.625,263	67.135	329	423.955,081 479.625,263	330	423.959,861 479.625,419	4.783	330	423.959,861 479.625,419	331	423.959,992 479.625,423	0.131
331	423.959,992 479.625,423	332	424.015,935 479.627,247	55.973	332	424.015,935 479.627,247	333	424.027,18 479.631,877	12.161	333	424.027,18 479.631,877	334	424.023,211 479.647,752	16.364
334	424.023,211 479.647,752	335	424.027,841 479.656,351	9.766	335	424.027,841 479.656,351	336	424.039,747 479.658,997	12.196	336	424.039,747 479.658,997	337	424.049,008 479.660,982	9.471
337	424.049,008 479.660,982	338	424.064,221 479.660,982	15.213	338	424.064,221 479.660,982	339	424.076,347 479.656,571	12.903	339	424.076,347 479.656,571	340	424.080,58 479.656,835	4.241
340	424.080,58 479.656,835	341	424.092,003 479.656,351	11.433	341	424.092,003 479.656,351	342	424.104,57 479.662,304	13.906	342	424.104,57 479.662,304	343	424.121,107 479.680,825	24.829
343	424.121,107 479.680,825	344	424.132,352 479.696,039	18.919	344	424.132,352 479.696,039	345	424.138,966 479.711,914	17.198	345	424.138,966 479.711,914	346	424.136,321 479.725,143	13.491
346	424.136,321 479.725,143	347	424.134,998 479.741,018	15.93	347	424.134,998 479.741,018	348	424.133,967 479.747,35	6.415	348	424.133,967 479.747,35	349	424.132,0 479.749,412	2.85
349	424.132,0 479.749,412	350	424.161,519 479.766,013	33.867	350	424.161,519 479.766,013	1	424.149,308 479.771,749	13.491					

\*\* Lungimile segmentelor sunt determinate în planul de proiecție Stereo 70 și sunt rotunjite la 1 milimetru.

\*\*\* Distanța dintre puncte este formată din segmente cumulate ce sunt mai mici decât valoarea 1 milimetru.