

**PLAN CADASTRAL**  
**U.A.T. CAREI județului: SATU MARE, Sect. cad. 146**  
 Scara 1:2000  
 Sistem de Proiecție Stereografic 1970  
 Copie spre Publicare

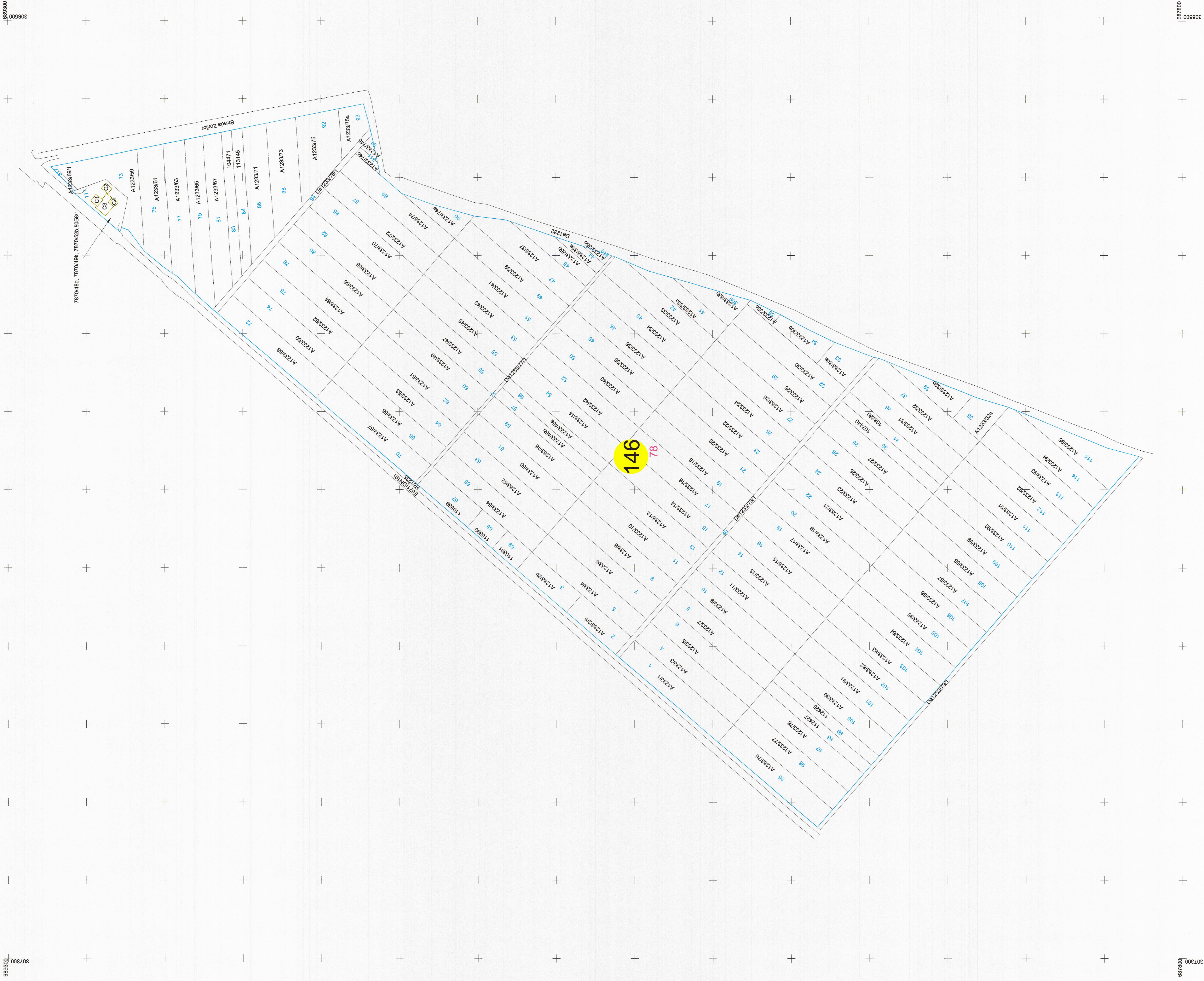

**LEGENDA**

Numar Sector	146
ID imobil	146
Limita sector	—
Limita imobil	—
Limita UAT	—
Limita intravilan	—
Numar topografic	37/20
Numar tarla	78
Carolaj	+

Kozma Ioan Alexandru  
 O = OCOT TOPO CAD SRL  
 OU = OCPI: B.SM.0078  
 19/07/2023 12:54:06 UTC+02

Executant: ing. KOZMA IOAN ALEXANDRU  
 Clasa B seria RO-SM-F nr. 0078/2012  
 OCOT TOPO CAD SRL  
 Clasa III seria RO-B-J nr. 1723/2019