

# PLAN CADASTRAL

UAT: Batarci, judetul: SATU MARE, Sect. cad. 17, plansa 1

Scara 1:2000

Sistem de proiectie: stereografic 1970  
Spre Publicare



LEGENDA	
Numar Sector	17
Cod contabilitate	C1
ID parceli	700
Limita sector	—
Limita insel	—
Hidrografie	—
Limita UAT	—
Limita sat	—
Numar cada	101
Numar postal	703
Limita comunitate	—

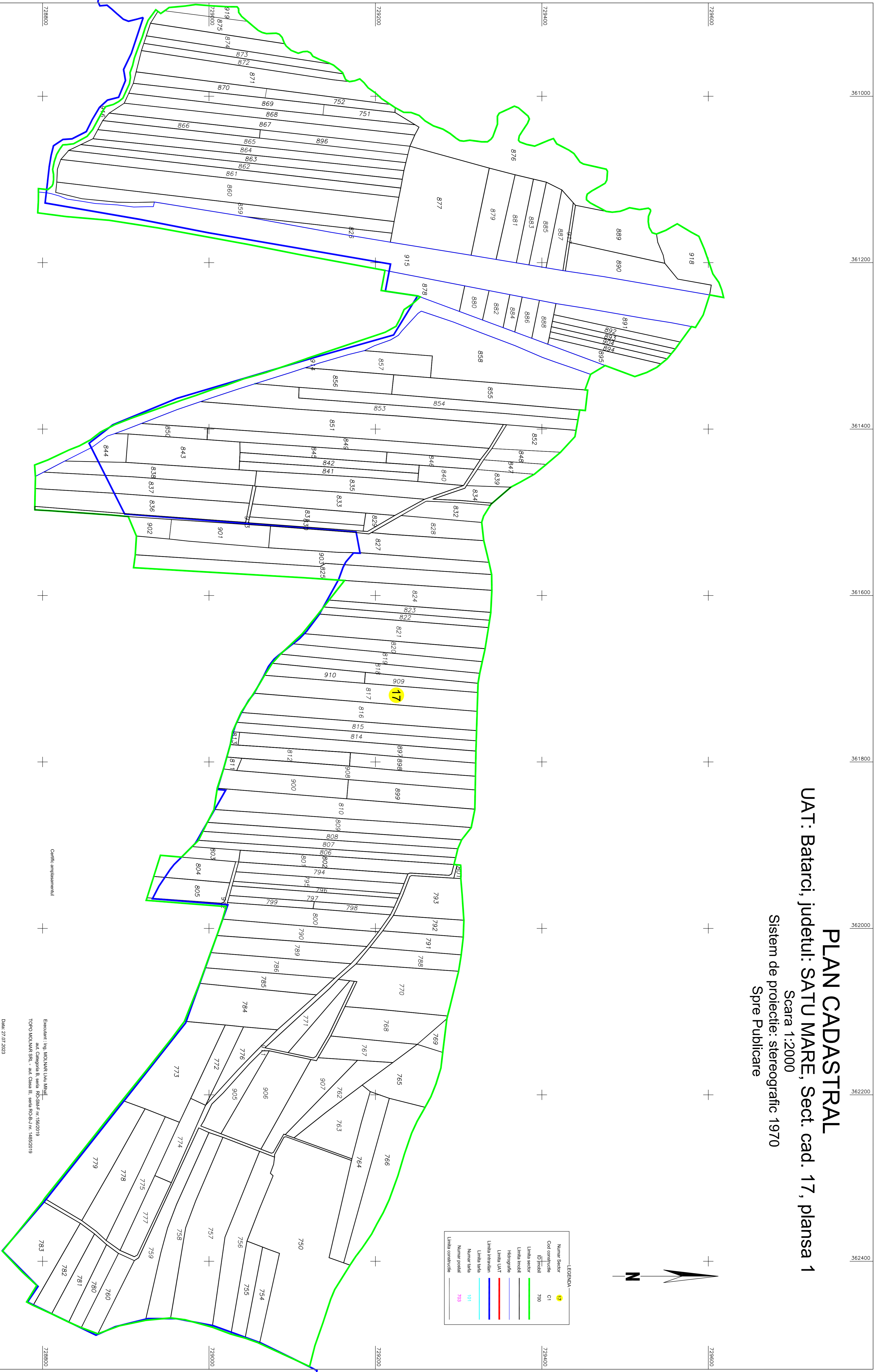

Certific angajamentului

Executant: Ing. MOLNAR Liviu Mihail  
aut. Compartia B. seria RD-SM-F nr. 14520/19  
TOPO MOLNAR SRL - aut. Clasa II, seria RC-B-I nr. 14520/19

Data: 27.07.2023