

Strejnicu

PLAN CADASTRAL
 UAT: Târgșoru Vechi, județul: PRAHOVA, Sect. cad. 31, planșa 2
 Scara 1:2000
 Sistem de proiecție: stereografic 1970
 Spre Publicare

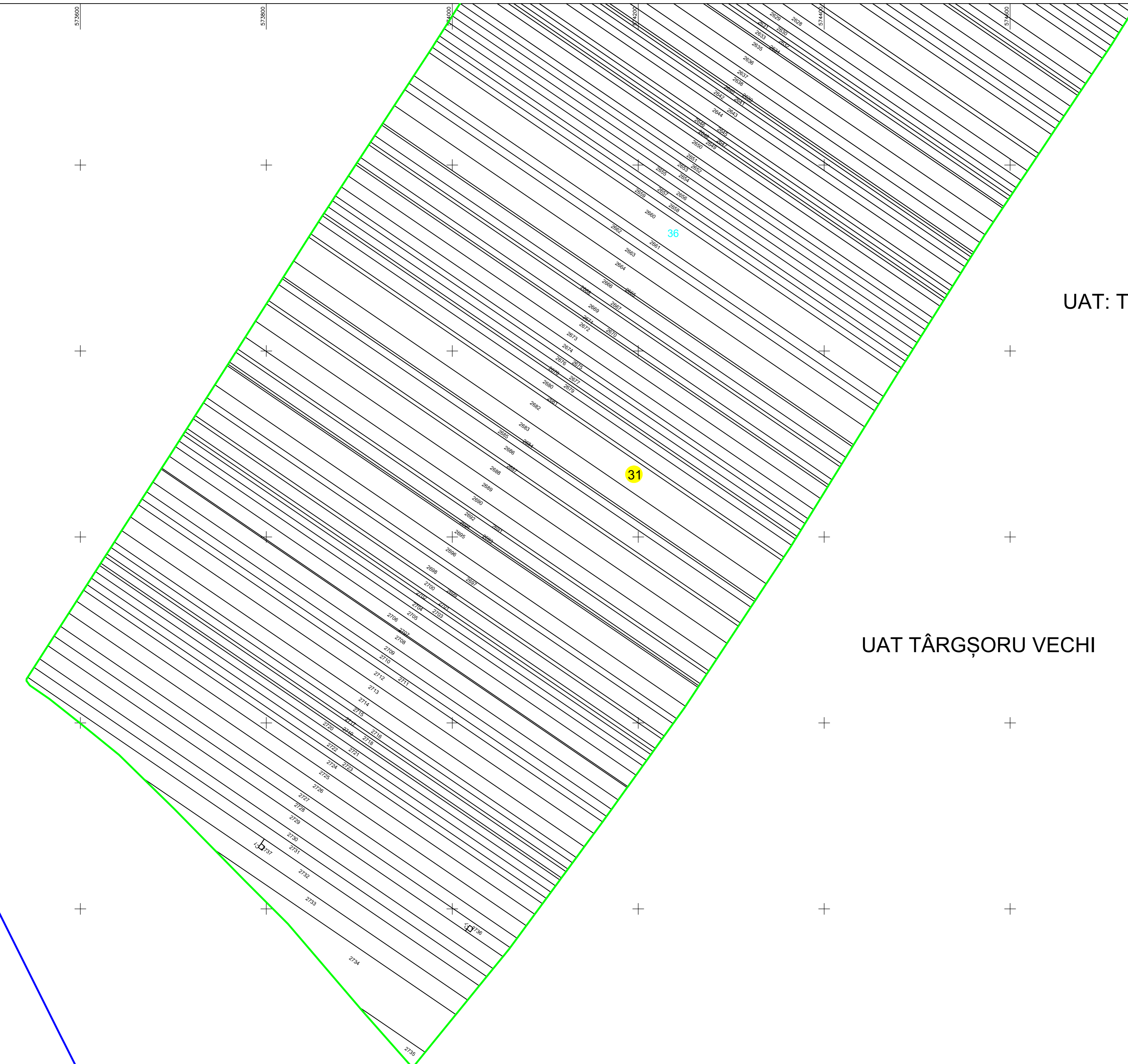
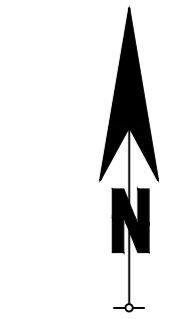

UAT TÂRGȘORU VECHI

Târgșoru Vechi

Târgșoru Vechi

SCHEMA DE RACORDARE A PLANȘELOR

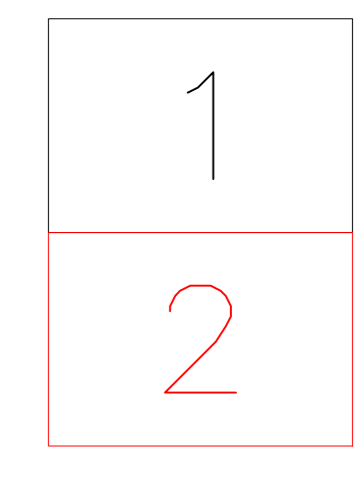

LEGENDA

Numar Sector	●
Cod constructie	C1
ID Imobil	15
Limita sector	—
Limita imobil	—
Limita UAT	—
Limita intravilan	—
Limita sate	—
Numar sate	101
Limita constructie	—

SCHEMA DE DISPUNERE A SECTOARELOR CADASTRALE

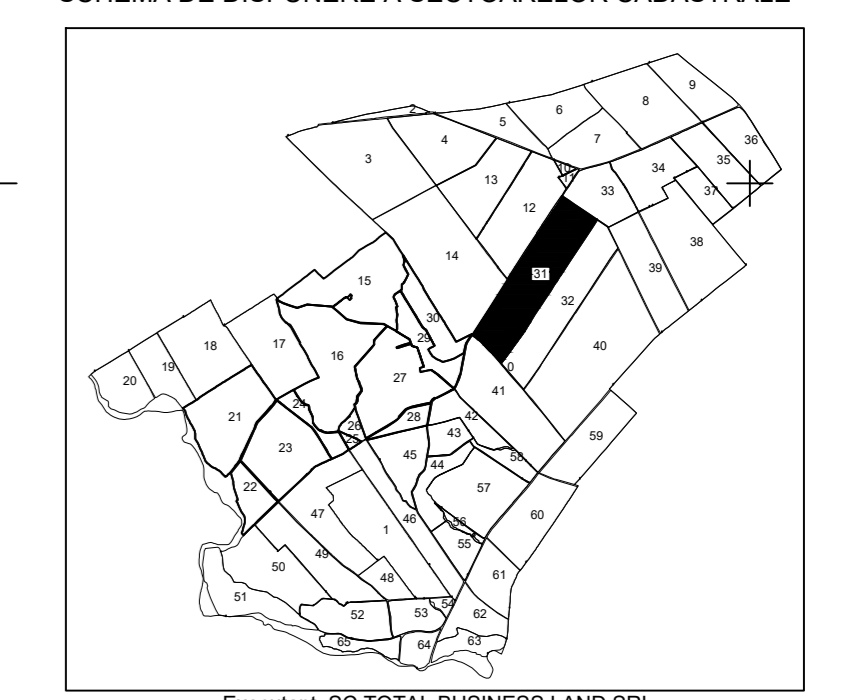

Executant: SC TOTAL BUSINESS LAND SRL
Data: 02.02.2024