

**DATE DESPRE IMOBILUL NR. 914**

Oficiul de Cadastru și Publicitate Imobiliară NEAMT  
Biroul de Cadastru și Publicitate Imobiliară Targu-Neamt

**A. Partea I. Descrierea imobilului**

TEREN Extravilan

Adresa: Jud. Neamt

| Nr. Crt | Nr cadastral Nr. topografic | Suprafața* (mp)                                   | Observații / Referințe   |
|---------|-----------------------------|---|--|
| A1      |                             | Din acte:<br>3.760.620.000<br>Masurata: 4.504.262 | Sector cadastral:137 Teren neimprejmuit;<br>DIFERENTA DE SUPRAFATA INSCRISA IN INVENTARUL BUNURILOR DIN DOMENIUL PUBLIC AL STATULUI SE REGASESTE IN ALTE SECTOARE CADASTRALE |

**B. Partea II. Proprietari și acte**

| Inscrieri privitoare la dreptul de proprietate și alte drepturi reale  |  | Referințe |
|--|--|-----------|
| <b>914 / 13/07/2022</b>  |  |           |
| Act Normativ nr. 1705, din 21/12/2006 emis de GUVERNUL ROMÂNIEI (ORDINUL 182/26.02.2018 AVIZ CTAS 324/09.12.2020 EXTRAS DIN AMENAJAMENTUL SILVIC U.P. I PIPIRIG UA 1, 2, 3, 4%, 5%, 6%, 7%, 8%, 9%, 10); |  |           |
| B0   | Intabulare, drept de PROPRIETATE, dobandit prin Lege, cota actuala 1/1, cota initiala 1/1<br>1) <b>STATUL ROMAN</b> , CIF:99999999999999, -domeniul public         | A1        |
| B0   | Intabulare, drept de ADMINISTRARE, dobandit prin Lege, cota actuala 1/1, cota initiala 1/1<br>1) <b>RNP - ROMSILVA - PRIN DIRECTIA SILVICA NEAMT</b> , CIF:1590120 | A1        |

**C. Partea III. SARCINI .**

| Inscrieri privind dezmembramintele dreptului de proprietate, drepturi reale de garanție și sarcini | Referințe |
|--|-----------|
| NU SUNT  |           |

## Anexa Nr. 1 La Partea I

## Teren

| Nr cadastral | Suprafața (mp)*                                      | Observații / Referințe   |
|--------------|--|--|
|              | Din acte:<br>3.760.620.000<br>Masurata:<br>4.504.262 | DIFERENTA DE SUPRAFATA INSCRISA IN INVENTARUL BUNURILOR DIN DOMENIUL PUBLIC AL STATULUI SE REGASESTE IN ALTE SECTOARE CADASTRALE |

\* Suprafața este determinată în planul de proiecție Stereo 70.

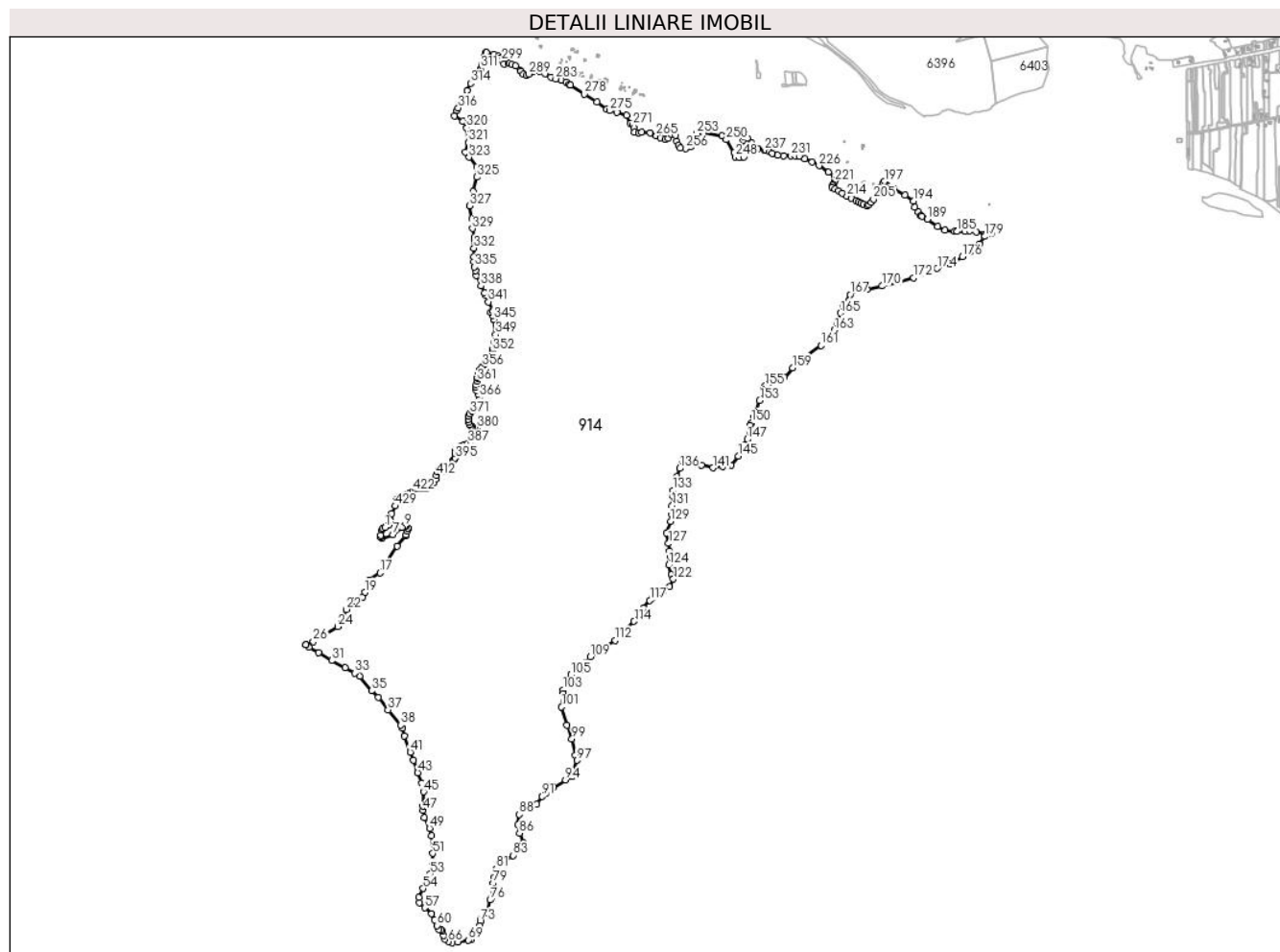

## Date referitoare la teren

| Crt | Categorie folosință | Intravilan | Suprafața (mp) | Tarla         | Parcelă                                | Nr. topo | Observații / Referințe   |
|-----|---------------------|------------|----------------|---------------|--|----------|--|
| 1   | padure              | NU         | 4.504.262      | UP I Domesnic | UA 1, 2, 3, 4%, 5%, 6%, 7%, 8%, 9%, 10 | -        | UP I Domesnic - Pipirig, PARTE DIN U.A 4%, PARTE DIN U.A. 5%, PARTE DIN U.A. 6%, PARTE DIN U.A. 7%, PARTE DIN U.A. 8%, PARTE DIN U.A. 9% |

## Lungime Segmente

1) Valorile lungimilor segmentelor sunt obținute din proiecție în plan.

| Punct început | X / Y                      | Punct sfârșit | X / Y                      | Lungime segment |
|---------------|----------------------------|---------------|----------------------------|-----------------|
| 1             | 587.119,58<br>634.753,868  | 2             | 587.108,77<br>634.749,334  | 11.72<br>2      |
| 4             | 587.099,146<br>634.719,505 | 5             | 587.099,445<br>634.709,054 | 10.45<br>5      |
| 7             | 587.156,19<br>634.720,621  | 8             | 587.195,893<br>634.754,803 | 52.39           |
| 2             | 587.108,77<br>634.749,334  | 3             | 587.105,776<br>634.743,01  | 6.997           |
| 5             | 587.099,445<br>634.709,054 | 6             | 587.104,218<br>634.704,77  | 6.414           |
| 8             | 587.195,893<br>634.754,803 | 9             | 587.208,192<br>634.761,109 | 13.82<br>1      |
| 3             | 587.105,776<br>634.743,01  | 4             | 587.099,146<br>634.719,505 | 24.42<br>2      |
| 6             | 587.104,218<br>634.704,77  | 7             | 587.156,19<br>634.720,621  | 54.33<br>5      |
| 9             | 587.208,192<br>634.761,109 | 10            | 587.216,151<br>634.758,757 | 8.299           |

| Punct început | X / Y                      | Punct sfârșit | X / Y                      | Lungime segment | Punct început | X / Y                      | Punct sfârșit | X / Y                      | Lungime segment | Punct început | X / Y                      | Punct sfârșit | X / Y                      | Lungime segment |
|---------------|----------------------------|---------------|----------------------------|-----------------|---------------|----------------------------|---------------|----------------------------|-----------------|---------------|----------------------------|---------------|----------------------------|-----------------|
| 10            | 587.216,151<br>634.758,757 | 11            | 587.223,658<br>634.752,216 | 9.957           | 11            | 587.223,658<br>634.752,216 | 12            | 587.223,825<br>634.747,856 | 4.363           | 12            | 587.223,825<br>634.747,856 | 13            | 587.221,328<br>634.737,215 | 10.93           |
| 13            | 587.221,328<br>634.737,215 | 14            | 587.216,391<br>634.721,539 | 16.435          | 14            | 587.216,391<br>634.721,539 | 15            | 587.212,031<br>634.716,15  | 6.932           | 15            | 587.212,031<br>634.716,15  | 16            | 587.173,979<br>634.669,117 | 60.498          |
| 16            | 587.173,979<br>634.669,117 | 17            | 587.096,007<br>634.547,015 | 144.874         | 17            | 587.096,007<br>634.547,015 | 18            | 587.046,177<br>634.513,693 | 59.945          | 18            | 587.046,177<br>634.513,693 | 19            | 587.027,414<br>634.457,914 | 58.85           |
| 19            | 587.027,414<br>634.457,914 | 20            | 587.015,746<br>634.436,48  | 24.404          | 20            | 587.015,746<br>634.436,48  | 21            | 586.971,717<br>634.416,554 | 48.328          | 21            | 586.971,717<br>634.416,554 | 22            | 586.941,285<br>634.379,675 | 47.814          |
| 22            | 586.941,285<br>634.379,675 | 23            | 586.919,186<br>634.319,621 | 63.991          | 23            | 586.919,186<br>634.319,621 | 24            | 586.902,592<br>634.300,733 | 25.142          | 24            | 586.902,592<br>634.300,733 | 25            | 586.844,745<br>634.264,05  | 68.498          |
| 25            | 586.844,745<br>634.264,05  | 26            | 586.791,377<br>634.231,749 | 62.382          | 26            | 586.791,377<br>634.231,749 | 27            | 586.756,873<br>634.217,496 | 37.332          | 27            | 586.756,873<br>634.217,496 | 28            | 586.757,439<br>634.217,065 | 0.711           |
| 28            | 586.757,439<br>634.217,065 | 29            | 586.772,17<br>634.205,864  | 18.506          | 29            | 586.772,17<br>634.205,864  | 30            | 586.815,465<br>634.181,202 | 49.826          | 30            | 586.815,465<br>634.181,202 | 31            | 586.874,517<br>634.145,776 | 68.863          |
| 31            | 586.874,517<br>634.145,776 | 32            | 586.937,949<br>634.114,068 | 70.916          | 32            | 586.937,949<br>634.114,068 | 33            | 586.980,741<br>634.088,4   | 49.9            | 33            | 586.980,741<br>634.088,4   | 34            | 587.003,395<br>634.073,3   | 27.225          |
| 34            | 587.003,395<br>634.073,3   | 35            | 587.057,262<br>634.007,368 | 85.139          | 35            | 587.057,262<br>634.007,368 | 36            | 587.087,667<br>633.976,942 | 43.014          | 36            | 587.087,667<br>633.976,942 | 37            | 587.132,472<br>633.920,572 | 72.007          |
| 37            | 587.132,472<br>633.920,572 | 38            | 587.191,373<br>633.851,116 | 91.068          | 38            | 587.191,373<br>633.851,116 | 39            | 587.199,428<br>633.837,024 | 16.232          | 39            | 587.199,428<br>633.837,024 | 40            | 587.206,476<br>633.799,779 | 37.906          |
| 40            | 587.206,476<br>633.799,779 | 41            | 587.234,668<br>633.726,297 | 78.704          | 41            | 587.234,668<br>633.726,297 | 42            | 587.249,931<br>633.689,736 | 39.619          | 42            | 587.249,931<br>633.689,736 | 43            | 587.268,558<br>633.632,863 | 59.846          |
| 43            | 587.268,558<br>633.632,863 | 44            | 587.287,688<br>633.585,049 | 51.499          | 44            | 587.287,688<br>633.585,049 | 45            | 587.295,24<br>633.545,792  | 39.977          | 45            | 587.295,24<br>633.545,792  | 46            | 587.291,716<br>633.480,866 | 65.022          |
| 46            | 587.291,716<br>633.480,866 | 47            | 587.292,255<br>633.462,023 | 18.851          | 47            | 587.292,255<br>633.462,023 | 48            | 587.299,303<br>633.427,295 | 35.436          | 48            | 587.299,303<br>633.427,295 | 49            | 587.322,964<br>633.378,475 | 54.252          |
| 49            | 587.322,964<br>633.378,475 | 50            | 587.331,018<br>633.344,25  | 35.16           | 50            | 587.331,018<br>633.344,25  | 51            | 587.337,563<br>633.263,722 | 80.794          | 51            | 587.337,563<br>633.263,722 | 52            | 587.335,072<br>633.208,044 | 55.734          |
| 52            | 587.335,072<br>633.208,044 | 53            | 587.327,521<br>633.169,29  | 39.483          | 53            | 587.327,521<br>633.169,29  | 54            | 587.293,791<br>633.102,854 | 74.508          | 54            | 587.293,791<br>633.102,854 | 55            | 587.273,654<br>633.061,583 | 45.922          |
| 55            | 587.273,654<br>633.061,583 | 56            | 587.276,165<br>633.037,709 | 24.006          | 56            | 587.276,165<br>633.037,709 | 57            | 587.301,337<br>633.015,061 | 33.861          | 57            | 587.301,337<br>633.015,061 | 58            | 587.332,046<br>632.986,876 | 41.683          |
| 58            | 587.332,046<br>632.986,876 | 59            | 587.346,645<br>632.959,194 | 31.296          | 59            | 587.346,645<br>632.959,194 | 60            | 587.357,721<br>632.933,525 | 27.957          | 60            | 587.357,721<br>632.933,525 | 61            | 587.365,693<br>632.915,292 | 19.9            |
| 61            | 587.365,693<br>632.915,292 | 62            | 587.375,221<br>632.914,439 | 9.566           | 62            | 587.375,221<br>632.914,439 | 63            | 587.382,35<br>632.908,284  | 9.418           | 63            | 587.382,35<br>632.908,284  | 64            | 587.386,562<br>632.888,847 | 19.888          |
| 64            | 587.386,562<br>632.888,847 | 65            | 587.393,367<br>632.871,029 | 19.073          | 65            | 587.393,367<br>632.871,029 | 66            | 587.408,92<br>632.860,014  | 19.058          | 66            | 587.408,92<br>632.860,014  | 67            | 587.425,446<br>632.854,831 | 17.32           |
| 67            | 587.425,446<br>632.854,831 | 68            | 587.452,342<br>632.857,423 | 27.021          | 68            | 587.452,342<br>632.857,423 | 69            | 587.501,271<br>632.867,465 | 49.949          | 69            | 587.501,271<br>632.867,465 | 70            | 587.513,726<br>632.869,284 | 12.587          |
| 70            | 587.513,726<br>632.869,284 | 71            | 587.533,29<br>632.906,67   | 42.196          | 71            | 587.533,29<br>632.906,67   | 72            | 587.551,72<br>632.931,87   | 31.22           | 72            | 587.551,72<br>632.931,87   | 73            | 587.554,34<br>632.952,24   | 20.538          |
| 73            | 587.554,34<br>632.952,24   | 74            | 587.558,61<br>632.962,7    | 11.298          | 74            | 587.558,61<br>632.962,7    | 75            | 587.589,1<br>632.992,68    | 42.76           | 75            | 587.589,1<br>632.992,68    | 76            | 587.599,79<br>633.050,37   | 58.672          |
| 76            | 587.599,79<br>633.050,37   | 77            | 587.604,13<br>633.059,73   | 10.317          | 77            | 587.604,13<br>633.059,73   | 78            | 587.613,06<br>633.101,9    | 43.105          | 78            | 587.613,06<br>633.101,9    | 79            | 587.614,75<br>633.126,74   | 24.897          |
| 79            | 587.614,75<br>633.126,74   | 80            | 587.619,89<br>633.153,75   | 27.495          | 80            | 587.619,89<br>633.153,75   | 81            | 587.628,33<br>633.193,09   | 40.235          | 81            | 587.628,33<br>633.193,09   | 82            | 587.658,55<br>633.219,02   | 39.82           |
| 82            | 587.658,55<br>633.219,02   | 83            | 587.703,47<br>633.254,62   | 57.316          | 83            | 587.703,47<br>633.254,62   | 84            | 587.728,82<br>633.286,35   | 40.613          | 84            | 587.728,82<br>633.286,35   | 85            | 587.751,83<br>633.310,68   | 33.487          |
| 85            | 587.751,83<br>633.310,68   | 86            | 587.733,81<br>633.356,05   | 48.818          | 86            | 587.733,81<br>633.356,05   | 87            | 587.727,88<br>633.394,25   | 38.658          | 87            | 587.727,88<br>633.394,25   | 88            | 587.733,56<br>633.441,87   | 47.958          |
| 88            | 587.733,56<br>633.441,87   | 89            | 587.771,13<br>633.461,92   | 42.585          | 89            | 587.771,13<br>633.461,92   | 90            | 587.813,49<br>633.488,1    | 49.797          | 90            | 587.813,49<br>633.488,1    | 91            | 587.838,38<br>633.524,11   | 43.775          |
| 91            | 587.838,38<br>633.524,11   | 92            | 587.856,06<br>633.540,7    | 24.245          | 92            | 587.856,06<br>633.540,7    | 93            | 587.890,94<br>633.564,65   | 42.311          | 93            | 587.890,94<br>633.564,65   | 94            | 587.945,01<br>633.599,3    | 64.22           |
| 94            | 587.945,01<br>633.599,3    | 95            | 587.976,39<br>633.615,73   | 35.421          | 95            | 587.976,39<br>633.615,73   | 96            | 587.979,66<br>633.636,62   | 21.144          | 96            | 587.979,66<br>633.636,62   | 97            | 587.996,59<br>633.689,47   | 55.495          |
| 97            | 587.996,59<br>633.689,47   | 98            | 587.989,06<br>633.713,19   | 24.887          | 98            | 587.989,06<br>633.713,19   | 99            | 587.973,9<br>633.787,07    | 75.419          | 99            | 587.973,9<br>633.787,07    | 100           | 587.950,65<br>633.849,31   | 66.441          |
| 100           | 587.950,65<br>633.849,31   | 101           | 587.927,15<br>633.933,01   | 86.936          | 101           | 587.927,15<br>633.933,01   | 102           | 587.932,85<br>633.994,74   | 61.993          | 102           | 587.932,85<br>633.994,74   | 103           | 587.935,16<br>634.011,54   | 16.958          |
| 103           | 587.935,16<br>634.011,54   | 104           | 587.957,95<br>634.056,77   | 50.647          | 104           | 587.957,95<br>634.056,77   | 105           | 587.969,22<br>634.081,98   | 27.614          | 105           | 587.969,22<br>634.081,98   | 106           | 588.007,5<br>634.107,69    | 46.112          |
| 106           | 588.007,5<br>634.107,69    | 107           | 588.029,49<br>634.105,06   | 22.147          | 107           | 588.029,49<br>634.105,06   | 108           | 588.040,33<br>634.137,06   | 33.786          | 108           | 588.040,33<br>634.137,06   | 109           | 588.058,84<br>634.163,62   | 32.374          |

| Punct început | X / Y                      | Punct sfârșit | X / Y                      | Lungime segment | Punct început | X / Y                      | Punct sfârșit | X / Y                      | Lungime segment | Punct început | X / Y                      | Punct sfârșit | X / Y                      | Lungime segment |
|---------------|----------------------------|---------------|----------------------------|-----------------|---------------|----------------------------|---------------|----------------------------|-----------------|---------------|----------------------------|---------------|----------------------------|-----------------|
| 109           | 588.058,84<br>634.163,62   | 110           | 588.088,06<br>634.184,2    | 35.74           | 110           | 588.088,06<br>634.184,2    | 111           | 588.112,94<br>634.198,17   | 28.53<br>4      | 111           | 588.112,94<br>634.198,17   | 112           | 588.171,14<br>634.237,82   | 70.42<br>3      |
| 112           | 588.171,14<br>634.237,82   | 113           | 588.207,66<br>634.264,78   | 45.39<br>3      | 113           | 588.207,66<br>634.264,78   | 114           | 588.258,23<br>634.324,54   | 78.28<br>5      | 114           | 588.258,23<br>634.324,54   | 115           | 588.281,28<br>634.360,19   | 42.45<br>3      |
| 115           | 588.281,28<br>634.360,19   | 116           | 588.301,9<br>634.385,54    | 32.67<br>7      | 116           | 588.301,9<br>634.385,54    | 117           | 588.330,42<br>634.420,99   | 45.49<br>8      | 117           | 588.330,42<br>634.420,99   | 118           | 588.339,29<br>634.431,09   | 13.44<br>2      |
| 118           | 588.339,29<br>634.431,09   | 119           | 588.367,82<br>634.448,7    | 33.52<br>7      | 119           | 588.367,82<br>634.448,7    | 120           | 588.390,74<br>634.462,04   | 26.51<br>9      | 120           | 588.390,74<br>634.462,04   | 121           | 588.420,02<br>634.483,33   | 36.20<br>2      |
| 121           | 588.420,02<br>634.483,33   | 122           | 588.437,82<br>634.518,42   | 39.34<br>7      | 122           | 588.437,82<br>634.518,42   | 123           | 588.429,95<br>634.538,45   | 21.52<br>1      | 123           | 588.429,95<br>634.538,45   | 124           | 588.417,56<br>634.584,08   | 47.28<br>2      |
| 124           | 588.417,56<br>634.584,08   | 125           | 588.423,63<br>634.623,93   | 40.31           | 125           | 588.423,63<br>634.623,93   | 126           | 588.420,2<br>634.645,72    | 22.05<br>8      | 126           | 588.420,2<br>634.645,72    | 127           | 588.415,95<br>634.681,12   | 35.65<br>4      |
| 127           | 588.415,95<br>634.681,12   | 128           | 588.406,13<br>634.729,91   | 49.76<br>8      | 128           | 588.406,13<br>634.729,91   | 129           | 588.425,92<br>634.782,14   | 55.85<br>4      | 129           | 588.425,92<br>634.782,14   | 130           | 588.431,79<br>634.813,18   | 31.59           |
| 130           | 588.431,79<br>634.813,18   | 131           | 588.432,46<br>634.854,09   | 40.91<br>5      | 131           | 588.432,46<br>634.854,09   | 132           | 588.437,58<br>634.897,69   | 43.9            | 132           | 588.437,58<br>634.897,69   | 133           | 588.436,52<br>634.924,06   | 26.39<br>1      |
| 133           | 588.436,52<br>634.924,06   | 134           | 588.450,02<br>634.963,21   | 41.41<br>2      | 134           | 588.450,02<br>634.963,21   | 135           | 588.454,87<br>634.987,71   | 24.97<br>5      | 135           | 588.454,87<br>634.987,71   | 136           | 588.466,08<br>635.024,53   | 38.48<br>9      |
| 136           | 588.466,08<br>635.024,53   | 137           | 588.480,59<br>635.057,72   | 36.22<br>3      | 137           | 588.480,59<br>635.057,72   | 138           | 588.514,56<br>635.065,32   | 34.81           | 138           | 588.514,56<br>635.065,32   | 139           | 588.538,84<br>635.045,82   | 31.14<br>1      |
| 139           | 588.538,84<br>635.045,82   | 140           | 588.567,53<br>635.037,94   | 29.75<br>2      | 140           | 588.567,53<br>635.037,94   | 141           | 588.618,91<br>635.027,36   | 52.45<br>8      | 141           | 588.618,91<br>635.027,36   | 142           | 588.663,97<br>635.033,18   | 45.43<br>4      |
| 142           | 588.663,97<br>635.033,18   | 143           | 588.684,76<br>635.042,51   | 22.78<br>8      | 143           | 588.684,76<br>635.042,51   | 144           | 588.700,91<br>635.038,28   | 16.69<br>5      | 144           | 588.700,91<br>635.038,28   | 145           | 588.735,75<br>635.080,66   | 54.86<br>2      |
| 145           | 588.735,75<br>635.080,66   | 146           | 588.763,23<br>635.133,1    | 59.20<br>4      | 146           | 588.763,23<br>635.133,1    | 147           | 588.775,99<br>635.157,1    | 27.18<br>1      | 147           | 588.775,99<br>635.157,1    | 148           | 588.787,04<br>635.185,18   | 30.17<br>6      |
| 148           | 588.787,04<br>635.185,18   | 149           | 588.788,58<br>635.220,52   | 35.37<br>4      | 149           | 588.788,58<br>635.220,52   | 150           | 588.796,0<br>635.232,97    | 14.49<br>3      | 150           | 588.796,0<br>635.232,97    | 151           | 588.807,04<br>635.258,95   | 28.22<br>8      |
| 151           | 588.807,04<br>635.258,95   | 152           | 588.814,66<br>635.280,46   | 22.82           | 152           | 588.814,66<br>635.280,46   | 153           | 588.833,17<br>635.334,9    | 57.50<br>1      | 153           | 588.833,17<br>635.334,9    | 154           | 588.851,35<br>635.388,47   | 56.57<br>1      |
| 154           | 588.851,35<br>635.388,47   | 155           | 588.857,57<br>635.400,91   | 13.90<br>8      | 155           | 588.857,57<br>635.400,91   | 156           | 588.872,08<br>635.410,1    | 17.17<br>5      | 156           | 588.872,08<br>635.410,1    | 157           | 588.906,9<br>635.423,0     | 37.13<br>3      |
| 157           | 588.906,9<br>635.423,0     | 158           | 588.946,7<br>635.439,04    | 42.91<br>1      | 158           | 588.946,7<br>635.439,04    | 159           | 588.982,74<br>635.484,93   | 58.35           | 159           | 588.982,74<br>635.484,93   | 160           | 589.031,79<br>635.524,42   | 62.97<br>1      |
| 160           | 589.031,79<br>635.524,42   | 161           | 589.114,33<br>635.585,78   | 102.8<br>49     | 161           | 589.114,33<br>635.585,78   | 162           | 589.157,7<br>635.623,39    | 57.40<br>6      | 162           | 589.157,7<br>635.623,39    | 163           | 589.174,29<br>635.657,6    | 38.02           |
| 163           | 589.174,29<br>635.657,6    | 164           | 589.188,45<br>635.687,85   | 33.4            | 164           | 589.188,45<br>635.687,85   | 165           | 589.203,1<br>635.734,75    | 49.13<br>5      | 165           | 589.203,1<br>635.734,75    | 166           | 589.214,94<br>635.769,21   | 36.43<br>7      |
| 166           | 589.214,94<br>635.769,21   | 167           | 589.245,94<br>635.819,81   | 59.34<br>1      | 167           | 589.245,94<br>635.819,81   | 168           | 589.280,41<br>635.839,36   | 39.62<br>8      | 168           | 589.280,41<br>635.839,36   | 169           | 589.323,81<br>635.842,35   | 43.50<br>3      |
| 169           | 589.323,81<br>635.842,35   | 170           | 589.392,158<br>635.858,521 | 70.23<br>5      | 170           | 589.392,158<br>635.858,521 | 171           | 589.464,306<br>635.877,089 | 74.49<br>9      | 171           | 589.464,306<br>635.877,089 | 172           | 589.536,419<br>635.895,464 | 74.41<br>7      |
| 172           | 589.536,419<br>635.895,464 | 173           | 589.593,296<br>635.916,702 | 60.71<br>3      | 173           | 589.593,296<br>635.916,702 | 174           | 589.645,77<br>635.939,344  | 57.15<br>1      | 174           | 589.645,77<br>635.939,344  | 175           | 589.708,98<br>635.959,94   | 66.48<br>1      |
| 175           | 589.708,98<br>635.959,94   | 176           | 589.760,0<br>635.992,27    | 60.40<br>1      | 176           | 589.760,0<br>635.992,27    | 177           | 589.798,19<br>636.017,65   | 45.85<br>4      | 177           | 589.798,19<br>636.017,65   | 178           | 589.836,91<br>636.051,84   | 51.65<br>5      |
| 178           | 589.836,91<br>636.051,84   | 179           | 589.862,0<br>636.085,21    | 41.75           | 179           | 589.862,0<br>636.085,21    | 180           | 589.893,32<br>636.099,45   | 34.40<br>5      | 180           | 589.893,32<br>636.099,45   | 181           | 589.861,573<br>636.096,157 | 31.91<br>7      |
| 181           | 589.861,573<br>636.096,157 | 182           | 589.824,553<br>636.104,842 | 38.02<br>5      | 182           | 589.824,553<br>636.104,842 | 183           | 589.794,157<br>636.110,192 | 30.86<br>3      | 183           | 589.794,157<br>636.110,192 | 184           | 589.772,054<br>636.109,3   | 22.12<br>1      |
| 184           | 589.772,054<br>636.109,3   | 185           | 589.735,346<br>636.108,065 | 36.72<br>9      | 185           | 589.735,346<br>636.108,065 | 186           | 589.723,369<br>636.108,762 | 11.99<br>7      | 186           | 589.723,369<br>636.108,762 | 187           | 589.681,575<br>636.113,88  | 42.10<br>6      |
| 187           | 589.681,575<br>636.113,88  | 188           | 589.646,199<br>636.129,697 | 38.75<br>1      | 188           | 589.646,199<br>636.129,697 | 189           | 589.600,858<br>636.164,126 | 56.93<br>1      | 189           | 589.600,858<br>636.164,126 | 190           | 589.576,263<br>636.176,939 | 27.73<br>2      |
| 190           | 589.576,263<br>636.176,939 | 191           | 589.569,59<br>636.181,889  | 8.309           | 191           | 589.569,59<br>636.181,889  | 192           | 589.559,726<br>636.198,105 | 18.98           | 192           | 589.559,726<br>636.198,105 | 193           | 589.542,592<br>636.219,481 | 27.39<br>5      |
| 193           | 589.542,592<br>636.219,481 | 194           | 589.536,533<br>636.246,617 | 27.80<br>4      | 194           | 589.536,533<br>636.246,617 | 195           | 589.497,446<br>636.273,455 | 47.41<br>4      | 195           | 589.497,446<br>636.273,455 | 196           | 589.447,322<br>636.301,063 | 57.22<br>4      |
| 196           | 589.447,322<br>636.301,063 | 197           | 589.403,239<br>636.337,271 | 57.04<br>7      | 197           | 589.403,239<br>636.337,271 | 198           | 589.398,802<br>636.330,763 | 7.877           | 198           | 589.398,802<br>636.330,763 | 199           | 589.396,601<br>636.326,954 | 4.399           |
| 199           | 589.396,601<br>636.326,954 | 200           | 589.383,224<br>636.309,435 | 22.04<br>2      | 200           | 589.383,224<br>636.309,435 | 201           | 589.394,972<br>636.301,937 | 13.93<br>7      | 201           | 589.394,972<br>636.301,937 | 202           | 589.385,57<br>636.288,661  | 16.26<br>8      |
| 202           | 589.385,57<br>636.288,661  | 203           | 589.382,406<br>636.282,685 | 6.762           | 203           | 589.382,406<br>636.282,685 | 204           | 589.370,725<br>636.273,798 | 14.67<br>7      | 204           | 589.370,725<br>636.273,798 | 205           | 589.353,643<br>636.256,06  | 24.62<br>6      |
| 205           | 589.353,643<br>636.256,06  | 206           | 589.342,56<br>636.241,405  | 18.37<br>4      | 206           | 589.342,56<br>636.241,405  | 207           | 589.331,207<br>636.230,381 | 15.82<br>5      | 207           | 589.331,207<br>636.230,381 | 208           | 589.324,203<br>636.223,896 | 9.545           |

| Punct început | X / Y                      | Punct sfârșit | X / Y                      | Lungime segment | Punct început | X / Y                      | Punct sfârșit | X / Y                      | Lungime segment | Punct început | X / Y                      | Punct sfârșit | X / Y                      | Lungime segment |
|---------------|----------------------------|---------------|----------------------------|-----------------|---------------|----------------------------|---------------|----------------------------|-----------------|---------------|----------------------------|---------------|----------------------------|-----------------|
| 208           | 589.324,203<br>636.223,896 | 209           | 589.306,401<br>636.233,796 | 20.37           | 209           | 589.306,401<br>636.233,796 | 210           | 589.297,291<br>636.239,254 | 10.62           | 210           | 589.297,291<br>636.239,254 | 211           | 589.285,284<br>636.244,438 | 13.078          |
| 211           | 589.285,284<br>636.244,438 | 212           | 589.273,634<br>636.248,298 | 12.273          | 212           | 589.273,634<br>636.248,298 | 213           | 589.252,96<br>636.259,805  | 23.661          | 213           | 589.252,96<br>636.259,805  | 214           | 589.232,451<br>636.268,881 | 22.428          |
| 214           | 589.232,451<br>636.268,881 | 215           | 589.211,96<br>636.281,439  | 24.033          | 215           | 589.211,96<br>636.281,439  | 216           | 589.194,908<br>636.293,002 | 20.603          | 216           | 589.194,908<br>636.293,002 | 217           | 589.176,143<br>636.303,11  | 21.314          |
| 217           | 589.176,143<br>636.303,11  | 218           | 589.163,224<br>636.309,792 | 14.545          | 218           | 589.163,224<br>636.309,792 | 219           | 589.165,441<br>636.318,698 | 9.178           | 219           | 589.165,441<br>636.318,698 | 220           | 589.170,507<br>636.324,654 | 7.819           |
| 220           | 589.170,507<br>636.324,654 | 221           | 589.176,194<br>636.336,726 | 13.344          | 221           | 589.176,194<br>636.336,726 | 222           | 589.185,136<br>636.350,892 | 16.752          | 222           | 589.185,136<br>636.350,892 | 223           | 589.183,446<br>636.352,456 | 2.303           |
| 223           | 589.183,446<br>636.352,456 | 224           | 589.174,451<br>636.362,157 | 13.229          | 224           | 589.174,451<br>636.362,157 | 225           | 589.147,738<br>636.380,001 | 32.125          | 225           | 589.147,738<br>636.380,001 | 226           | 589.105,013<br>636.408,896 | 51.579          |
| 226           | 589.105,013<br>636.408,896 | 227           | 589.073,648<br>636.425,937 | 35.695          | 227           | 589.073,648<br>636.425,937 | 228           | 589.039,32<br>636.441,249  | 37.588          | 228           | 589.039,32<br>636.441,249  | 229           | 589.014,376<br>636.450,88  | 26.739          |
| 229           | 589.014,376<br>636.450,88  | 230           | 588.994,125<br>636.455,079 | 20.682          | 230           | 588.994,125<br>636.455,079 | 231           | 588.975,108<br>636.455,326 | 19.019          | 231           | 588.975,108<br>636.455,326 | 232           | 588.943,99<br>636.454,091  | 31.142          |
| 232           | 588.943,99<br>636.454,091  | 233           | 588.915,095<br>636.457,795 | 29.131          | 233           | 588.915,095<br>636.457,795 | 234           | 588.891,386<br>636.465,698 | 24.991          | 234           | 588.891,386<br>636.465,698 | 235           | 588.875,372<br>636.473,941 | 18.011          |
| 235           | 588.875,372<br>636.473,941 | 236           | 588.861,414<br>636.478,063 | 14.554          | 236           | 588.861,414<br>636.478,063 | 237           | 588.853,106<br>636.480,516 | 8.663           | 237           | 588.853,106<br>636.480,516 | 238           | 588.825,124<br>636.486,843 | 28.688          |
| 238           | 588.825,124<br>636.486,843 | 239           | 588.824,856<br>636.487,097 | 0.369           | 239           | 588.824,856<br>636.487,097 | 240           | 588.797,137<br>636.513,283 | 38.132          | 240           | 588.797,137<br>636.513,283 | 241           | 588.776,84<br>636.534,059  | 29.045          |
| 241           | 588.776,84<br>636.534,059  | 242           | 588.763,653<br>636.539,807 | 14.385          | 242           | 588.763,653<br>636.539,807 | 243           | 588.758,743<br>636.526,258 | 14.411          | 243           | 588.758,743<br>636.526,258 | 244           | 588.771,817<br>636.495,101 | 33.789          |
| 244           | 588.771,817<br>636.495,101 | 245           | 588.774,058<br>636.474,768 | 20.456          | 245           | 588.774,058<br>636.474,768 | 246           | 588.760,089<br>636.448,74  | 29.54           | 246           | 588.760,089<br>636.448,74  | 247           | 588.740,667<br>636.445,437 | 19.701          |
| 247           | 588.740,667<br>636.445,437 | 248           | 588.721,512<br>636.449,452 | 19.571          | 248           | 588.721,512<br>636.449,452 | 249           | 588.716,525<br>636.469,371 | 20.534          | 249           | 588.716,525<br>636.469,371 | 250           | 588.680,21<br>636.527,631  | 68.651          |
| 250           | 588.680,21<br>636.527,631  | 251           | 588.661,708<br>636.546,657 | 26.539          | 251           | 588.661,708<br>636.546,657 | 252           | 588.576,129<br>636.560,665 | 86.718          | 252           | 588.576,129<br>636.560,665 | 253           | 588.545,185<br>636.556,618 | 31.208          |
| 253           | 588.545,185<br>636.556,618 | 254           | 588.527,799<br>636.536,043 | 26.937          | 254           | 588.527,799<br>636.536,043 | 255           | 588.516,352<br>636.496,411 | 41.252          | 255           | 588.516,352<br>636.496,411 | 256           | 588.493,994<br>636.488,668 | 23.661          |
| 256           | 588.493,994<br>636.488,668 | 257           | 588.469,805<br>636.489,877 | 24.219          | 257           | 588.469,805<br>636.489,877 | 258           | 588.461,452<br>636.501,282 | 14.137          | 258           | 588.461,452<br>636.501,282 | 259           | 588.454,867<br>636.521,842 | 21.589          |
| 259           | 588.454,867<br>636.521,842 | 260           | 588.447,799<br>636.547,865 | 26.966          | 260           | 588.447,799<br>636.547,865 | 261           | 588.431,054<br>636.550,065 | 16.889          | 261           | 588.431,054<br>636.550,065 | 262           | 588.414,179<br>636.533,168 | 23.88           |
| 262           | 588.414,179<br>636.533,168 | 263           | 588.400,976<br>636.529,27  | 13.766          | 263           | 588.400,976<br>636.529,27  | 264           | 588.378,992<br>636.536,931 | 23.281          | 264           | 588.378,992<br>636.536,931 | 265           | 588.360,425<br>636.546,109 | 20.712          |
| 265           | 588.360,425<br>636.546,109 | 266           | 588.331,682<br>636.558,386 | 31.255          | 266           | 588.331,682<br>636.558,386 | 267           | 588.293,345<br>636.561,819 | 38.49           | 267           | 588.293,345<br>636.561,819 | 268           | 588.279,899<br>636.560,422 | 13.518          |
| 268           | 588.279,899<br>636.560,422 | 269           | 588.259,798<br>636.561,968 | 20.16           | 269           | 588.259,798<br>636.561,968 | 270           | 588.258,472<br>636.580,523 | 18.602          | 270           | 588.258,472<br>636.580,523 | 271           | 588.250,852<br>636.593,818 | 15.324          |
| 271           | 588.250,852<br>636.593,818 | 272           | 588.242,13<br>636.603,98   | 13.392          | 272           | 588.242,13<br>636.603,98   | 273           | 588.224,495<br>636.638,345 | 38.626          | 273           | 588.224,495<br>636.638,345 | 274           | 588.178,683<br>636.652,726 | 48.016          |
| 274           | 588.178,683<br>636.652,726 | 275           | 588.146,376<br>636.660,562 | 33.244          | 275           | 588.146,376<br>636.660,562 | 276           | 588.133,815<br>636.668,233 | 14.718          | 276           | 588.133,815<br>636.668,233 | 277           | 588.089,109<br>636.699,278 | 54.428          |
| 277           | 588.089,109<br>636.699,278 | 278           | 588.031,177<br>636.736,116 | 68.652          | 278           | 588.031,177<br>636.736,116 | 279           | 587.966,576<br>636.777,991 | 76.986          | 279           | 587.966,576<br>636.777,991 | 280           | 587.962,936<br>636.780,582 | 4.468           |
| 280           | 587.962,936<br>636.780,582 | 281           | 587.948,046<br>636.791,179 | 18.276          | 281           | 587.948,046<br>636.791,179 | 282           | 587.925,747<br>636.798,715 | 23.538          | 282           | 587.925,747<br>636.798,715 | 283           | 587.899,679<br>636.806,251 | 27.135          |
| 283           | 587.899,679<br>636.806,251 | 284           | 587.878,322<br>636.814,728 | 22.978          | 284           | 587.878,322<br>636.814,728 | 285           | 587.851,214<br>636.829,551 | 30.896          | 285           | 587.851,214<br>636.829,551 | 286           | 587.827,03<br>636.839,913  | 26.31           |
| 286           | 587.827,03<br>636.839,913  | 287           | 587.811,64<br>636.843,367  | 15.773          | 287           | 587.811,64<br>636.843,367  | 288           | 587.794,68<br>636.840,855  | 17.145          | 288           | 587.794,68<br>636.840,855  | 289           | 587.777,318<br>636.828,274 | 21.441          |
| 289           | 587.777,318<br>636.828,274 | 290           | 587.766,012<br>636.821,994 | 12.933          | 290           | 587.766,012<br>636.821,994 | 291           | 587.752,82<br>636.827,646  | 14.352          | 291           | 587.752,82<br>636.827,646  | 292           | 587.741,347<br>636.840,756 | 17.421          |
| 292           | 587.741,347<br>636.840,756 | 293           | 587.737,431<br>636.845,23  | 5.946           | 293           | 587.737,431<br>636.845,23  | 294           | 587.716,702<br>636.865,011 | 28.653          | 294           | 587.716,702<br>636.865,011 | 295           | 587.698,486<br>636.872,233 | 19.595          |
| 295           | 587.698,486<br>636.872,233 | 296           | 587.687,845<br>636.875,889 | 11.252          | 296           | 587.687,845<br>636.875,889 | 297           | 587.685,5<br>636.876,695   | 2.48            | 297           | 587.685,5<br>636.876,695   | 298           | 587.664,143<br>636.875,124 | 21.415          |
| 298           | 587.664,143<br>636.875,124 | 299           | 587.653,464<br>636.890,196 | 18.472          | 299           | 587.653,464<br>636.890,196 | 300           | 587.644,984<br>636.902,128 | 14.638          | 300           | 587.644,984<br>636.902,128 | 301           | 587.638,713<br>636.910,98  | 10.848          |
| 301           | 587.638,713<br>636.910,98  | 302           | 587.616,516<br>636.917,85  | 23.236          | 302           | 587.616,516<br>636.917,85  | 303           | 587.582,621<br>636.926,556 | 34.995          | 303           | 587.582,621<br>636.926,556 | 304           | 587.580,61<br>636.927,349  | 2.162           |
| 304           | 587.580,61<br>636.927,349  | 305           | 587.579,919<br>636.924,586 | 2.848           | 305           | 587.579,919<br>636.924,586 | 306           | 587.576,896<br>636.920,771 | 4.868           | 306           | 587.576,896<br>636.920,771 | 307           | 587.572,85<br>636.908,231  | 13.177          |

| Punct început | X / Y                      | Punct sfârșit | X / Y                      | Lungime segment | Punct început | X / Y                      | Punct sfârșit | X / Y                      | Lungime segment | Punct început | X / Y                      | Punct sfârșit | X / Y                      | Lungime segment |
|---------------|----------------------------|---------------|----------------------------|-----------------|---------------|----------------------------|---------------|----------------------------|-----------------|---------------|----------------------------|---------------|----------------------------|-----------------|
| 307           | 587.572,85<br>636.908,231  | 308           | 587.567,251<br>636.888,939 | 20.088          | 308           | 587.567,251<br>636.888,939 | 309           | 587.562,189<br>636.871,992 | 17.687          | 309           | 587.562,189<br>636.871,992 | 310           | 587.562,026<br>636.865,94  | 6.054           |
| 310           | 587.562,026<br>636.865,94  | 311           | 587.558,321<br>636.851,712 | 14.702          | 311           | 587.558,321<br>636.851,712 | 312           | 587.543,865<br>636.829,138 | 26.806          | 312           | 587.543,865<br>636.829,138 | 313           | 587.522,942<br>636.804,948 | 31.983          |
| 313           | 587.522,942<br>636.804,948 | 314           | 587.510,263<br>636.785,401 | 23.299          | 314           | 587.510,263<br>636.785,401 | 315           | 587.493,669<br>636.752,896 | 36.496          | 315           | 587.493,669<br>636.752,896 | 316           | 587.454,423<br>636.673,496 | 88.57           |
| 316           | 587.454,423<br>636.673,496 | 317           | 587.448,114<br>636.660,671 | 14.293          | 317           | 587.448,114<br>636.660,671 | 318           | 587.437,212<br>636.636,046 | 26.93           | 318           | 587.437,212<br>636.636,046 | 319           | 587.474,973<br>636.611,853 | 44.846          |
| 319           | 587.474,973<br>636.611,853 | 320           | 587.493,21<br>636.581,475  | 35.432          | 320           | 587.493,21<br>636.581,475  | 321           | 587.499,97<br>636.515,071  | 66.747          | 321           | 587.499,97<br>636.515,071  | 322           | 587.486,275<br>636.471,356 | 45.81           |
| 322           | 587.486,275<br>636.471,356 | 323           | 587.502,936<br>636.448,113 | 28.598          | 323           | 587.502,936<br>636.448,113 | 324           | 587.537,981<br>636.404,441 | 55.995          | 324           | 587.537,981<br>636.404,441 | 325           | 587.537,981<br>636.356,83  | 47.611          |
| 325           | 587.537,981<br>636.356,83  | 326           | 587.521,568<br>636.291,089 | 67.759          | 326           | 587.521,568<br>636.291,089 | 327           | 587.505,077<br>636.225,035 | 68.081          | 327           | 587.505,077<br>636.225,035 | 328           | 587.515,994<br>636.166,264 | 59.776          |
| 328           | 587.515,994<br>636.166,264 | 329           | 587.518,373<br>636.121,219 | 45.108          | 329           | 587.518,373<br>636.121,219 | 330           | 587.528,959<br>636.080,991 | 41.598          | 330           | 587.528,959<br>636.080,991 | 331           | 587.528,959<br>636.061,407 | 19.584          |
| 331           | 587.528,959<br>636.061,407 | 332           | 587.525,783<br>636.032,294 | 29.286          | 332           | 587.525,783<br>636.032,294 | 333           | 587.524,27<br>635.992,148  | 40.175          | 333           | 587.524,27<br>635.992,148  | 334           | 587.524,27<br>635.971,374  | 20.774          |
| 334           | 587.524,27<br>635.971,374  | 335           | 587.528,721<br>635.945,159 | 26.59           | 335           | 587.528,721<br>635.945,159 | 336           | 587.532,678<br>635.928,837 | 16.795          | 336           | 587.532,678<br>635.928,837 | 337           | 587.536,635<br>635.907,074 | 22.12           |
| 337           | 587.536,635<br>635.907,074 | 338           | 587.557,409<br>635.859,095 | 52.283          | 338           | 587.557,409<br>635.859,095 | 339           | 587.574,958<br>635.826,729 | 36.817          | 339           | 587.574,958<br>635.826,729 | 340           | 587.580,625<br>635.815,859 | 12.259          |
| 340           | 587.580,625<br>635.815,859 | 341           | 587.591,888<br>635.786,167 | 31.756          | 341           | 587.591,888<br>635.786,167 | 342           | 587.612,371<br>635.744,385 | 46.533          | 342           | 587.612,371<br>635.744,385 | 343           | 587.602,809<br>635.737,91  | 11.548          |
| 343           | 587.602,809<br>635.737,91  | 344           | 587.609,804<br>635.725,575 | 14.18           | 344           | 587.609,804<br>635.725,575 | 345           | 587.616,666<br>635.706,089 | 20.659          | 345           | 587.616,666<br>635.706,089 | 346           | 587.618,109<br>635.701,99  | 4.346           |
| 346           | 587.618,109<br>635.701,99  | 347           | 587.628,407<br>635.679,401 | 24.826          | 347           | 587.628,407<br>635.679,401 | 348           | 587.630,068<br>635.661,795 | 17.684          | 348           | 587.630,068<br>635.661,795 | 349           | 587.625,417<br>635.635,885 | 26.324          |
| 349           | 587.625,417<br>635.635,885 | 350           | 587.617,112<br>635.600,673 | 36.178          | 350           | 587.617,112<br>635.600,673 | 351           | 587.613,064<br>635.572,852 | 28.114          | 351           | 587.613,064<br>635.572,852 | 352           | 587.612,13<br>635.562,389  | 10.505          |
| 352           | 587.612,13<br>635.562,389  | 353           | 587.597,742<br>635.534,547 | 31.34           | 353           | 587.597,742<br>635.534,547 | 354           | 587.588,586<br>635.516,983 | 19.807          | 354           | 587.588,586<br>635.516,983 | 355           | 587.575,88<br>635.502,969  | 18.917          |
| 355           | 587.575,88<br>635.502,969  | 356           | 587.564,855<br>635.490,263 | 16.822          | 356           | 587.564,855<br>635.490,263 | 357           | 587.553,083<br>635.474,754 | 19.471          | 357           | 587.553,083<br>635.474,754 | 358           | 587.543,18<br>635.454,013  | 22.984          |
| 358           | 587.543,18<br>635.454,013  | 359           | 587.541,947<br>635.439,682 | 14.384          | 359           | 587.541,947<br>635.439,682 | 360           | 587.541,685<br>635.436,635 | 3.058           | 360           | 587.541,685<br>635.436,635 | 361           | 587.542,059<br>635.422,247 | 14.393          |
| 361           | 587.542,059<br>635.422,247 | 362           | 587.535,332<br>635.405,43  | 18.113          | 362           | 587.535,332<br>635.405,43  | 363           | 587.532,903<br>635.396,275 | 9.472           | 363           | 587.532,903<br>635.396,275 | 364           | 587.537,388<br>635.382,074 | 14.892          |
| 364           | 587.537,388<br>635.382,074 | 365           | 587.544,301<br>635.365,07  | 18.356          | 365           | 587.544,301<br>635.365,07  | 366           | 587.551,028<br>635.348,066 | 18.286          | 366           | 587.551,028<br>635.348,066 | 367           | 587.550,841<br>635.334,799 | 13.268          |
| 367           | 587.550,841<br>635.334,799 | 368           | 587.544,675<br>635.320,598 | 15.482          | 368           | 587.544,675<br>635.320,598 | 369           | 587.532,156<br>635.304,902 | 20.077          | 369           | 587.532,156<br>635.304,902 | 370           | 587.516,46<br>635.287,338  | 23.555          |
| 370           | 587.516,46<br>635.287,338  | 371           | 587.507,117<br>635.274,632 | 15.771          | 371           | 587.507,117<br>635.274,632 | 372           | 587.501,325<br>635.262,113 | 13.794          | 372           | 587.501,325<br>635.262,113 | 373           | 587.500,39<br>635.250,341  | 11.809          |
| 373           | 587.500,39<br>635.250,341  | 374           | 587.501,698<br>635.234,458 | 15.937          | 374           | 587.501,698<br>635.234,458 | 375           | 587.506,37<br>635.223,247  | 12.146          | 375           | 587.506,37<br>635.223,247  | 376           | 587.510,294<br>635.218,762 | 5.959           |
| 376           | 587.510,294<br>635.218,762 | 377           | 587.518,702<br>635.215,399 | 9.056           | 377           | 587.518,702<br>635.215,399 | 378           | 587.531,035<br>635.212,409 | 12.69           | 378           | 587.531,035<br>635.212,409 | 379           | 587.538,322<br>635.210,354 | 7.571           |
| 379           | 587.538,322<br>635.210,354 | 380           | 587.538,82<br>635.208,473  | 1.946           | 380           | 587.538,82<br>635.208,473  | 381           | 587.540,003<br>635.204,001 | 4.626           | 381           | 587.540,003<br>635.204,001 | 382           | 587.535,145<br>635.194,845 | 10.365          |
| 382           | 587.535,145<br>635.194,845 | 383           | 587.531,093<br>635.188,729 | 7.336           | 383           | 587.531,093<br>635.188,729 | 384           | 587.525,242<br>635.179,897 | 10.594          | 384           | 587.525,242<br>635.179,897 | 385           | 587.518,328<br>635.160,277 | 20.803          |
| 385           | 587.518,328<br>635.160,277 | 386           | 587.510,667<br>635.149,813 | 12.969          | 386           | 587.510,667<br>635.149,813 | 387           | 587.497,774<br>635.138,789 | 16.963          | 387           | 587.497,774<br>635.138,789 | 388           | 587.481,518<br>635.131,875 | 17.665          |
| 388           | 587.481,518<br>635.131,875 | 389           | 587.464,701<br>635.126,269 | 17.727          | 389           | 587.464,701<br>635.126,269 | 390           | 587.458,095<br>635.122,041 | 7.843           | 390           | 587.458,095<br>635.122,041 | 391           | 587.455,358<br>635.120,29  | 3.249           |
| 391           | 587.455,358<br>635.120,29  | 392           | 587.449,192<br>635.114,684 | 8.333           | 392           | 587.449,192<br>635.114,684 | 393           | 587.443,586<br>635.104,22  | 11.871          | 393           | 587.443,586<br>635.104,22  | 394           | 587.438,168<br>635.092,262 | 13.128          |
| 394           | 587.438,168<br>635.092,262 | 395           | 587.439,102<br>635.070,773 | 21.509          | 395           | 587.439,102<br>635.070,773 | 396           | 587.436,112<br>635.066,289 | 5.389           | 396           | 587.436,112<br>635.066,289 | 397           | 587.431,815<br>635.060,87  | 6.916           |
| 397           | 587.431,815<br>635.060,87  | 398           | 587.431,254<br>635.050,593 | 10.292          | 398           | 587.431,254<br>635.050,593 | 399           | 587.429,946<br>635.040,877 | 9.804           | 399           | 587.429,946<br>635.040,877 | 400           | 587.429,012<br>635.036,392 | 4.581           |
| 400           | 587.429,012<br>635.036,392 | 401           | 587.421,538<br>635.030,039 | 9.809           | 401           | 587.421,538<br>635.030,039 | 402           | 587.412,942<br>635.019,015 | 13.979          | 402           | 587.412,942<br>635.019,015 | 403           | 587.408,084<br>635.015,091 | 6.245           |
| 403           | 587.408,084<br>635.015,091 | 404           | 587.403,039<br>635.012,288 | 5.771           | 404           | 587.403,039<br>635.012,288 | 405           | 587.399,115<br>635.012,662 | 3.942           | 405           | 587.399,115<br>635.012,662 | 406           | 587.391,454<br>635.016,212 | 8.444           |

| Punct început | X / Y                      | Punct sfârșit | X / Y                      | Lungime segment | Punct început | X / Y                      | Punct sfârșit | X / Y                      | Lungime segment | Punct început | X / Y                      | Punct sfârșit | X / Y                      | Lungime segment |
|---------------|----------------------------|---------------|----------------------------|-----------------|---------------|----------------------------|---------------|----------------------------|-----------------|---------------|----------------------------|---------------|----------------------------|-----------------|
| 406           | 587.391,454<br>635.016,212 | 407           | 587.380,803<br>635.022,004 | 12.124          | 407           | 587.380,803<br>635.022,004 | 408           | 587.375,384<br>635.023,125 | 5.534           | 408           | 587.375,384<br>635.023,125 | 409           | 587.369,218<br>635.021,631 | 6.344           |
| 409           | 587.369,218<br>635.021,631 | 410           | 587.364,36<br>635.017,893  | 6.13            | 410           | 587.364,36<br>635.017,893  | 411           | 587.358,941<br>635.007,43  | 11.783          | 411           | 587.358,941<br>635.007,43  | 412           | 587.353,709<br>634.992,107 | 16.192          |
| 412           | 587.353,709<br>634.992,107 | 413           | 587.351,841<br>634.974,356 | 17.849          | 413           | 587.351,841<br>634.974,356 | 414           | 587.344,18<br>634.958,66   | 17.466          | 414           | 587.344,18<br>634.958,66   | 415           | 587.323,439<br>634.939,414 | 28.295          |
| 415           | 587.323,439<br>634.939,414 | 416           | 587.311,854<br>634.934,182 | 12.712          | 416           | 587.311,854<br>634.934,182 | 417           | 587.298,774<br>634.930,259 | 13.656          | 417           | 587.298,774<br>634.930,259 | 418           | 587.288,31<br>634.930,072  | 10.466          |
| 418           | 587.288,31<br>634.930,072  | 419           | 587.278,033<br>634.933,435 | 10.813          | 419           | 587.278,033<br>634.933,435 | 420           | 587.269,998<br>634.934,743 | 8.141           | 420           | 587.269,998<br>634.934,743 | 421           | 587.260,469<br>634.932,127 | 9.882           |
| 421           | 587.260,469<br>634.932,127 | 422           | 587.245,147<br>634.919,047 | 20.146          | 422           | 587.245,147<br>634.919,047 | 423           | 587.229,077<br>634.909,704 | 18.589          | 423           | 587.229,077<br>634.909,704 | 424           | 587.223,591<br>634.907,0   | 6.116           |
| 424           | 587.223,591<br>634.907,0   | 425           | 587.215,81<br>634.903,165  | 8.675           | 425           | 587.215,81<br>634.903,165  | 426           | 587.186,848<br>634.894,569 | 30.211          | 426           | 587.186,848<br>634.894,569 | 427           | 587.174,142<br>634.885,04  | 15.882          |
| 427           | 587.174,142<br>634.885,04  | 428           | 587.170,778<br>634.878,5   | 7.354           | 428           | 587.170,778<br>634.878,5   | 429           | 587.165,733<br>634.852,527 | 26.458          | 429           | 587.165,733<br>634.852,527 | 430           | 587.150,598<br>634.818,519 | 37.224          |
| 430           | 587.150,598<br>634.818,519 | 431           | 587.144,058<br>634.786,754 | 32.431          | 431           | 587.144,058<br>634.786,754 | 432           | 587.137,144<br>634.767,695 | 20.274          | 432           | 587.137,144<br>634.767,695 | 1             | 587.119,58<br>634.753,868  | 22.354          |

\*\* Lungimile segmentelor sunt determinate în planul de proiecție Stereo 70 și sunt rotunjite la 1 milimetru.

\*\*\* Distanța dintre puncte este formată din segmente cumulate ce sunt mai mici decât valoarea 1 milimetru.





**DATE DESPRE IMOBILUL NR. 915**

Oficiul de Cadastru și Publicitate Imobiliară NEAMT  
Biroul de Cadastru și Publicitate Imobiliară Targu-Neamt

**A. Partea I. Descrierea imobilului**

TEREN Extravilan

Adresa: Jud. Neamt, UP I Domesnic - Pipirig, U.A 48%, U.A. 49%, U.A. 50%, U.A. 50%

| Nr. Crt | Nr cadastral Nr. topografic | Suprafața* (mp)                                | Observații / Referințe   |
|---------|-----------------------------|--|--|
| A1      |                             | Din acte:<br>3.760.620.000<br>Masurata: 25.795 | Sector cadastral:137 Teren neimprejmuit;<br>DIFERENTA DE SUPRAFATA INSCRISA IN INVENTARUL BUNURILOR DIN DOMENIUL PUBLIC AL STATULUI SE REGASESTE IN ALTE SECTOARE CADASTRALE |

**B. Partea II. Proprietari și acte**

| Inscrieri privitoare la dreptul de proprietate și alte drepturi reale   |  | Referințe |
|---|--|-----------|
| <b>914 / 13/07/2022</b>   |  |           |
| Act Normativ nr. 1705, din 21/12/2006 emis de GUVERNUL ROMÂNIEI (ORDINUL 182/26.02.2018 AVIZ CTAS 324/09.12.2020 EXTRAS DIN AMENAJAMENTUL SILVIC U.P. I PIPIRIG UA 48%, 49%, 50%, 51%); |  |           |
| B0  | Intabulare, drept de PROPRIETATE, dobandit prin Lege, cota actuala 1/1, cota initiala 1/1<br>1) <b>STATUL ROMAN</b> , CIF:9999999999999, -domeniul public          | A1        |
| B0  | Intabulare, drept de ADMINISTRARE, dobandit prin Lege, cota actuala 1/1, cota initiala 1/1<br>1) <b>RNP - ROMSILVA - PRIN DIRECTIA SILVICA NEAMT</b> , CIF:1590120 | A1        |

**C. Partea III. SARCINI .**

| Inscrieri privind dezmembramintele dreptului de proprietate, drepturi reale de garanție și sarcini | Referințe |
|--|-----------|
| NU SUNT  |           |

## Anexa Nr. 1 La Partea I

## Teren

| Nr cadastral | Suprafața (mp)*                                   | Observații / Referințe   |
|--------------|---|--|
|              | Din acte:<br>3.760.620.000<br>Masurata:<br>25.795 | DIFERENTA DE SUPRAFATA INSCRISA IN INVENTARUL BUNURILOR DIN DOMENIUL PUBLIC AL STATULUI SE REGASESTE IN ALTE SECTOARE CADASTRALE |

\* Suprafața este determinată în planul de proiecție Stereo 70.

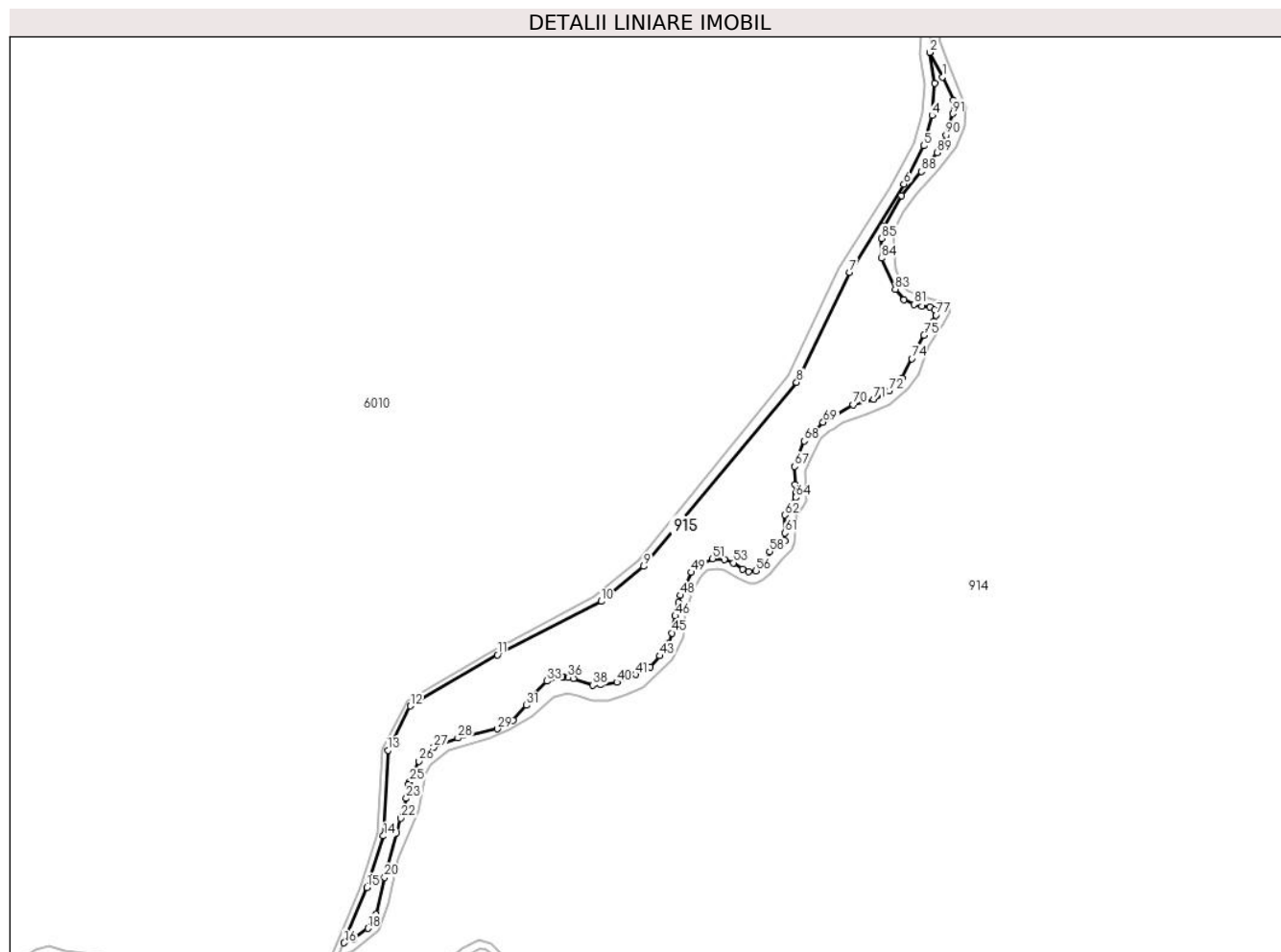

## Date referitoare la teren

| Crt | Categorie folosință | Intravilan | Suprafața (mp) | Tarla         | Parcelă                     | Nr. topo | Observații / Referințe   |
|-----|---------------------|------------|----------------|---------------|-----------------------------|----------|--|
| 1   | padure              | NU         | 25.795         | UP I Domesnic | UA 48%,<br>49%, 50%,<br>51% | -        | UP I Domesnic - Pipirig, PARTE DIN U.A 48%, PARTE DIN U.A. 49%, PARTE DIN U.A. 50%, PARTE DIN U.A. 50% |

## Lungime Segmente

1) Valorile lungimilor segmentelor sunt obținute din proiecție în plan.

| Punct început | X / Y                      | Punct sfârșit | X / Y                      | Lungime segment | Punct început | X / Y                      | Punct sfârșit | X / Y                      | Lungime segment | Punct început | X / Y                      | Punct sfârșit | X / Y                      | Lungime segment |
|---------------|----------------------------|---------------|----------------------------|-----------------|---------------|----------------------------|---------------|----------------------------|-----------------|---------------|----------------------------|---------------|----------------------------|-----------------|
| 1             | 587.534,717<br>635.369,682 | 2             | 587.525,796<br>635.387,042 | 19.518          | 2             | 587.525,796<br>635.387,042 | 3             | 587.529,372<br>635.365,194 | 22.139          | 3             | 587.529,372<br>635.365,194 | 4             | 587.527,662<br>635.342,484 | 22.774          |
| 4             | 587.527,662<br>635.342,484 | 5             | 587.521,681<br>635.321,135 | 22.171          | 5             | 587.521,681<br>635.321,135 | 6             | 587.507,633<br>635.294,077 | 30.487          | 6             | 587.507,633<br>635.294,077 | 7             | 587.469,398<br>635.231,978 | 72.926          |
| 7             | 587.469,398<br>635.231,978 | 8             | 587.432,024<br>635.154,337 | 86.168          | 8             | 587.432,024<br>635.154,337 | 9             | 587.324,183<br>635.024,534 | 168.756         | 9             | 587.324,183<br>635.024,534 | 10            | 587.294,305<br>634.999,94  | 38.698          |
| 10            | 587.294,305<br>634.999,94  | 11            | 587.220,914<br>634.962,164 | 82.543          | 11            | 587.220,914<br>634.962,164 | 12            | 587.159,606<br>634.926,14  | 71.108          | 12            | 587.159,606<br>634.926,14  | 13            | 587.143,762<br>634.894,94  | 34.992          |

| Punct început | X / Y                      | Punct sfârșit | X / Y                      | Lungime segment | Punct început | X / Y                      | Punct sfârșit | X / Y                      | Lungime segment | Punct început | X / Y                      | Punct sfârșit | X / Y                      | Lungime segment |
|---------------|----------------------------|---------------|----------------------------|-----------------|---------------|----------------------------|---------------|----------------------------|-----------------|---------------|----------------------------|---------------|----------------------------|-----------------|
| 13            | 587.143,762<br>634.894,94  | 14            | 587.140,546<br>634.834,478 | 60.547          | 14            | 587.140,546<br>634.834,478 | 15            | 587.128,922<br>634.798,133 | 38.159          | 15            | 587.128,922<br>634.798,133 | 16            | 587.112,9<br>634.759,177   | 42.122          |
| 16            | 587.112,9<br>634.759,177   | 17            | 587.119,633<br>634.761,625 | 7.164           | 17            | 587.119,633<br>634.761,625 | 18            | 587.129,583<br>634.769,333 | 12.586          | 18            | 587.129,583<br>634.769,333 | 19            | 587.135,468<br>634.779,143 | 11.44           |
| 19            | 587.135,468<br>634.779,143 | 20            | 587.141,495<br>634.805,209 | 26.754          | 20            | 587.141,495<br>634.805,209 | 21            | 587.149,903<br>634.837,021 | 32.904          | 21            | 587.149,903<br>634.837,021 | 22            | 587.152,764<br>634.847,006 | 10.387          |
| 22            | 587.152,764<br>634.847,006 | 23            | 587.156,77<br>634.860,985  | 14.542          | 23            | 587.156,77<br>634.860,985  | 24            | 587.158,452<br>634.870,795 | 9.953           | 24            | 587.158,452<br>634.870,795 | 25            | 587.159,246<br>634.872,567 | 1.942           |
| 25            | 587.159,246<br>634.872,567 | 26            | 587.165,739<br>634.887,052 | 15.874          | 26            | 587.165,739<br>634.887,052 | 27            | 587.176,25<br>634.897,142  | 14.57           | 27            | 587.176,25<br>634.897,142  | 28            | 587.193,067<br>634.903,588 | 18.01           |
| 28            | 587.193,067<br>634.903,588 | 29            | 587.220,815<br>634.910,035 | 28.487          | 29            | 587.220,815<br>634.910,035 | 30            | 587.231,886<br>634.916,201 | 12.672          | 30            | 587.231,886<br>634.916,201 | 31            | 587.241,555<br>634.926,571 | 14.178          |
| 31            | 587.241,555<br>634.926,571 | 32            | 587.245,62<br>634.933,719  | 8.223           | 32            | 587.245,62<br>634.933,719  | 33            | 587.255,99<br>634.943,669  | 14.371          | 33            | 587.255,99<br>634.943,669  | 34            | 587.266,641<br>634.946,892 | 11.128          |
| 34            | 587.266,641<br>634.946,892 | 35            | 587.267,522<br>634.946,753 | 0.892           | 35            | 587.267,522<br>634.946,753 | 36            | 587.270,849<br>634.946,227 | 3.368           | 36            | 587.270,849<br>634.946,227 | 37            | 587.274,629<br>634.945,631 | 3.827           |
| 37            | 587.274,629<br>634.945,631 | 38            | 587.288,082<br>634.940,726 | 14.319          | 38            | 587.288,082<br>634.940,726 | 39            | 587.293,918<br>634.941,188 | 5.854           | 39            | 587.293,918<br>634.941,188 | 40            | 587.305,264<br>634.942,869 | 11.47           |
| 40            | 587.305,264<br>634.942,869 | 41            | 587.318,413<br>634.948,353 | 14.247          | 41            | 587.318,413<br>634.948,353 | 42            | 587.328,583<br>634.953,759 | 11.518          | 42            | 587.328,583<br>634.953,759 | 43            | 587.335,59<br>634.961,467  | 10.417          |
| 43            | 587.335,59<br>634.961,467  | 44            | 587.341,476<br>634.970,295 | 10.61           | 44            | 587.341,476<br>634.970,295 | 45            | 587.343,999<br>634.977,583 | 7.712           | 45            | 587.343,999<br>634.977,583 | 46            | 587.346,301<br>634.989,638 | 12.273          |
| 46            | 587.346,301<br>634.989,638 | 47            | 587.348,79<br>634.999,025  | 9.711           | 47            | 587.348,79<br>634.999,025  | 48            | 587.350,165<br>635.004,21  | 5.364           | 48            | 587.350,165<br>635.004,21  | 49            | 587.357,592<br>635.020,326 | 17.745          |
| 49            | 587.357,592<br>635.020,326 | 50            | 587.363,758<br>635.025,791 | 8.239           | 50            | 587.363,758<br>635.025,791 | 51            | 587.372,727<br>635.029,996 | 9.906           | 51            | 587.372,727<br>635.029,996 | 52            | 587.380,996<br>635.029,435 | 8.288           |
| 52            | 587.380,996<br>635.029,435 | 53            | 587.387,302<br>635.027,053 | 6.741           | 53            | 587.387,302<br>635.027,053 | 54            | 587.393,749<br>635.022,428 | 7.934           | 54            | 587.393,749<br>635.022,428 | 55            | 587.398,093<br>635.020,746 | 4.658           |
| 55            | 587.398,093<br>635.020,746 | 56            | 587.403,138<br>635.021,447 | 5.093           | 56            | 587.403,138<br>635.021,447 | 57            | 587.410,005<br>635.027,473 | 9.136           | 57            | 587.410,005<br>635.027,473 | 58            | 587.413,016<br>635.034,908 | 8.022           |
| 58            | 587.413,016<br>635.034,908 | 59            | 587.419,955<br>635.039,385 | 8.258           | 59            | 587.419,955<br>635.039,385 | 60            | 587.423,599<br>635.042,748 | 4.959           | 60            | 587.423,599<br>635.042,748 | 61            | 587.423,739<br>635.048,214 | 5.468           |
| 61            | 587.423,739<br>635.048,214 | 62            | 587.423,739<br>635.060,827 | 12.613          | 62            | 587.423,739<br>635.060,827 | 63            | 587.428,083<br>635.068,254 | 8.604           | 63            | 587.428,083<br>635.068,254 | 64            | 587.431,447<br>635.073,159 | 5.948           |
| 64            | 587.431,447<br>635.073,159 | 65            | 587.431,587<br>635.076,102 | 2.946           | 65            | 587.431,587<br>635.076,102 | 66            | 587.431,115<br>635.082,382 | 6.298           | 66            | 587.431,115<br>635.082,382 | 67            | 587.430,45<br>635.095,006  | 12.642          |
| 67            | 587.430,45<br>635.095,006  | 68            | 587.437,426<br>635.112,944 | 19.247          | 68            | 587.437,426<br>635.112,944 | 69            | 587.450,714<br>635.126,231 | 18.791          | 69            | 587.450,714<br>635.126,231 | 70            | 587.471,973<br>635.138,522 | 24.556          |
| 70            | 587.471,973<br>635.138,522 | 71            | 587.486,368<br>635.142,514 | 14.938          | 71            | 587.486,368<br>635.142,514 | 72            | 587.497,299<br>635.148,4   | 12.415          | 72            | 587.497,299<br>635.148,4   | 73            | 587.506,268<br>635.157,369 | 12.684          |
| 73            | 587.506,268<br>635.157,369 | 74            | 587.513,135<br>635.171,102 | 15.354          | 74            | 587.513,135<br>635.171,102 | 75            | 587.521,824<br>635.187,639 | 18.681          | 75            | 587.521,824<br>635.187,639 | 76            | 587.528,551<br>635.197,449 | 11.895          |
| 76            | 587.528,551<br>635.197,449 | 77            | 587.530,372<br>635.201,793 | 4.71            | 77            | 587.530,372<br>635.201,793 | 78            | 587.529,392<br>635.205,577 | 3.909           | 78            | 587.529,392<br>635.205,577 | 79            | 587.525,748<br>635.207,399 | 4.074           |
| 79            | 587.525,748<br>635.207,399 | 80            | 587.520,563<br>635.207,959 | 5.215           | 80            | 587.520,563<br>635.207,959 | 81            | 587.514,677<br>635.209,221 | 6.02            | 81            | 587.514,677<br>635.209,221 | 82            | 587.507,53<br>635.212,584  | 7.899           |
| 82            | 587.507,53<br>635.212,584  | 83            | 587.501,503<br>635.220,012 | 9.566           | 83            | 587.501,503<br>635.220,012 | 84            | 587.491,834<br>635.241,874 | 23.905          | 84            | 587.491,834<br>635.241,874 | 85            | 587.491,834<br>635.255,888 | 14.014          |
| 85            | 587.491,834<br>635.255,888 | 86            | 587.493,936<br>635.264,576 | 8.939           | 86            | 587.493,936<br>635.264,576 | 87            | 587.505,848<br>635.286,018 | 24.529          | 87            | 587.505,848<br>635.286,018 | 88            | 587.519,862<br>635.302,975 | 21.998          |
| 88            | 587.519,862<br>635.302,975 | 89            | 587.531,213<br>635.316,289 | 17.496          | 89            | 587.531,213<br>635.316,289 | 90            | 587.537,38<br>635.328,621  | 13.788          | 90            | 587.537,38<br>635.328,621  | 91            | 587.542,144<br>635.343,756 | 15.867          |
| 91            | 587.542,144<br>635.343,756 | 92            | 587.542,425<br>635.353,146 | 9.394           | 92            | 587.542,425<br>635.353,146 | 1             | 587.534,717<br>635.369,682 | 18.244          |               |                            |               |                            |                 |

\*\* Lungimile segmentelor sunt determinate în planul de proiecție Stereo 70 și sunt rotunjite la 1 milimetru.

\*\*\* Distanța dintre puncte este formată din segmente cumulate ce sunt mai mici decât valoarea 1 milimetru.



**DATE DESPRE IMOBILUL NR. 916**

Oficiul de Cadastru și Publicitate Imobiliară NEAMT  
Biroul de Cadastru și Publicitate Imobiliară Targu-Neamt

**A. Partea I. Descrierea imobilului**

TEREN Extravilan

Adresa: Jud. Neamt, UP I Domesnic - Pipirig, PARTE DIN U.A 52%

| Nr. Crt | Nr cadastral<br>Nr. topografic | Suprafața* (mp)                                | Observații / Referințe   |
|---------|--------------------------------|--|--|
| A1      |                                | Din acte:<br>3.760.620.000<br>Masurata: 15.651 | Sector cadastral:137 Teren neimprejmuit;<br>DIFERENTA DE SUPRAFATA INSCRISA IN INVENTARUL BUNURILOR DIN<br>DOMENIUL PUBLIC AL STATULUI SE REGASESTE IN ALTE SECTOARE<br>CADASTRALE |

**B. Partea II. Proprietari și acte**

| Inscrieri privitoare la dreptul de proprietate și alte drepturi reale  |  | Referințe |
|--|--|-----------|
| <b>914 / 13/07/2022</b>  |  |           |
| Act Normativ nr. 1705, din 21/12/2006 emis de GUVERNUL ROMÂNIEI (ORDINUL 182/26.02.2018 AVIZ CTAS 324/09.12.2020 EXTRAS DIN AMENAJAMENTUL SILVIC U.P. I PIPIRIG UA 52%); |  |           |
| B0   | Intabulare, drept de PROPRIETATE, dobandit prin Lege, cota actuala 1/1, cota initiala 1/1<br>1) <b>STATUL ROMAN</b> , CIF:9999999999999, -domeniul public          | A1        |
| B0   | Intabulare, drept de ADMINISTRARE, dobandit prin Lege, cota actuala 1/1, cota initiala 1/1<br>1) <b>RNP - ROMSILVA - PRIN DIRECTIA SILVICA NEAMT</b> , CIF:1590120 | A1        |

**C. Partea III. SARCINI .**

| Inscrieri privind dezmembramintele dreptului de proprietate, drepturi reale de garanție și sarcini | Referințe |
|--|-----------|
| NU SUNT  |           |

## Anexa Nr. 1 La Partea I

## Teren

| Nr cadastral | Suprafața (mp)*                                   | Observații / Referințe   |
|--------------|---|--|
|              | Din acte:<br>3.760.620.000<br>Masurata:<br>15.651 | DIFERENTA DE SUPRAFATA INSCRISA IN INVENTARUL BUNURILOR DIN DOMENIUL PUBLIC AL STATULUI SE REGASESTE IN ALTE SECTOARE CADASTRALE |

\* Suprafața este determinată în planul de proiecție Stereo 70.

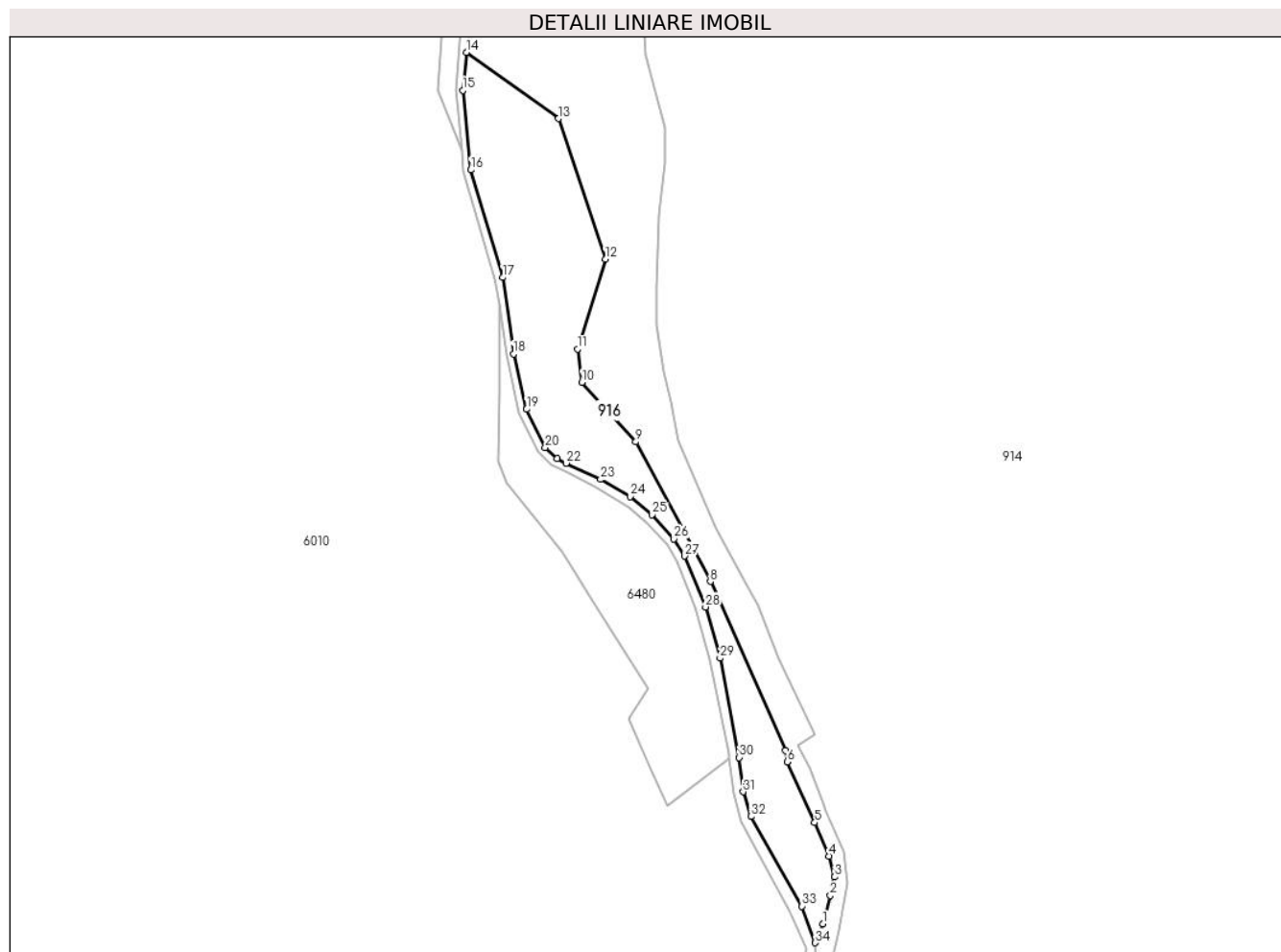

## Date referitoare la teren

| Crt | Categorie folosință | Intra vilan | Suprafața (mp) | Tarla         | Parcelă | Nr. topo | Observații / Referințe                     |
|-----|---------------------|-------------|----------------|---------------|---------|----------|--|
| 1   | padure              | NU          | 15.651         | UP I Domesnic | UA 52%  | -        | UP I Domesnic - Pipirig, PARTE DIN U.A 52% |

## Lungime Segmente

1) Valorile lungimilor segmentelor sunt obținute din proiecție în plan.

| Punct început | X / Y                      | Punct sfârșit | X / Y                      | Lungime segment (** (m) |
|---------------|----------------------------|---------------|----------------------------|-------------------------|
| 1             | 587.616,562<br>635.639,248 | 2             | 587.620,766<br>635.654,804 | 16.114                  |
| 3             | 587.623,149<br>635.665,174 | 4             | 587.620,102<br>635.676,744 | 11.964                  |
| 5             | 587.612,13<br>635.695,346  | 6             | 587.596,849<br>635.728,897 | 36.867                  |
| 7             | 587.595,825<br>635.735,162 | 8             | 587.554,195<br>635.829,016 | 102.672                 |

| Punct început | X / Y                      | Punct sfârșit | X / Y                      | Lungime segment (** (m) |
|---------------|----------------------------|---------------|----------------------------|-------------------------|
| 2             | 587.620,766<br>635.654,804 | 3             | 587.623,149<br>635.665,174 | 10.64                   |
| 4             | 587.620,102<br>635.676,744 | 5             | 587.612,13<br>635.695,346  | 20.238                  |
| 6             | 587.596,849<br>635.728,897 | 7             | 587.595,825<br>635.735,162 | 6.348                   |
| 8             | 587.554,195<br>635.829,016 | 9             | 587.512,875<br>635.906,436 | 87.756                  |

| Punct început | X / Y                      | Punct sfârșit | X / Y                      | Lungime segment (** (m) |
|---------------|----------------------------|---------------|----------------------------|-------------------------|
| 9             | 587.512,875<br>635.906,436 | 10            | 587.483,051<br>635.939,466 | 44.502                  |
| 11            | 587.480,533<br>635.957,901 | 12            | 587.496,007<br>636.007,732 | 52.178                  |
| 13            | 587.470,068<br>636.085,766 | 14            | 587.418,915<br>636.122,464 | 62.955                  |
| 15            | 587.416,893<br>636.101,426 | 16            | 587.421,411<br>636.057,246 | 44.41                   |
| 17            | 587.439,087<br>635.997,61  | 18            | 587.445,06<br>635.955,27   | 42.759                  |
| 19            | 587.452,324<br>635.924,527 | 20            | 587.462,656<br>635.903,267 | 23.638                  |
| 21            | 587.469,247<br>635.897,31  | 22            | 587.474,183<br>635.894,596 | 5.633                   |
| 23            | 587.493,405<br>635.885,626 | 24            | 587.509,775<br>635.876,143 | 18.918                  |
| 25            | 587.521,919<br>635.866,143 | 26            | 587.534,086<br>635.852,636 | 18.179                  |
| 27            | 587.540,004<br>635.843,097 | 28            | 587.551,518<br>635.814,841 | 30.512                  |
| 29            | 587.559,591<br>635.786,466 | 30            | 587.570,142<br>635.731,38  | 56.087                  |
| 31            | 587.572,457<br>635.712,374 | 32            | 587.576,743<br>635.698,724 | 14.307                  |
| 33            | 587.605,087<br>635.648,97  | 34            | 587.612,478<br>635.628,65  | 21.622                  |

| Punct început | X / Y                      | Punct sfârșit | X / Y                      | Lungime segment (** (m) |
|---------------|----------------------------|---------------|----------------------------|-------------------------|
| 10            | 587.483,051<br>635.939,466 | 11            | 587.480,533<br>635.957,901 | 18.606                  |
| 12            | 587.496,007<br>636.007,732 | 13            | 587.470,068<br>636.085,766 | 82.232                  |
| 14            | 587.418,915<br>636.122,464 | 15            | 587.416,893<br>636.101,426 | 21.135                  |
| 16            | 587.421,411<br>636.057,246 | 17            | 587.439,087<br>635.997,61  | 62.2                    |
| 18            | 587.445,06<br>635.955,27   | 19            | 587.452,324<br>635.924,527 | 31.59                   |
| 20            | 587.462,656<br>635.903,267 | 21            | 587.469,247<br>635.897,31  | 8.884                   |
| 22            | 587.474,183<br>635.894,596 | 23            | 587.493,405<br>635.885,626 | 21.212                  |
| 24            | 587.509,775<br>635.876,143 | 25            | 587.521,919<br>635.866,143 | 15.731                  |
| 26            | 587.534,086<br>635.852,636 | 27            | 587.540,004<br>635.843,097 | 11.226                  |
| 28            | 587.551,518<br>635.814,841 | 29            | 587.559,591<br>635.786,466 | 29.501                  |
| 30            | 587.570,142<br>635.731,38  | 31            | 587.572,457<br>635.712,374 | 19.146                  |
| 32            | 587.576,743<br>635.698,724 | 33            | 587.605,087<br>635.648,97  | 57.261                  |
| 34            | 587.612,478<br>635.628,65  | 1             | 587.616,562<br>635.639,248 | 11.358                  |

\*\* Lungimile segmentelor sunt determinate în planul de proiecție Stereo 70 și sunt rotunjite la 1 milimetru.

\*\*\* Distanța dintre puncte este formată din segmente cumulate ce sunt mai mici decât valoarea 1 milimetru.





**DATE DESPRE IMOBILUL NR. 917**

Oficiul de Cadastru și Publicitate Imobiliară NEAMT  
Biroul de Cadastru și Publicitate Imobiliară Targu-Neamt

**A. Partea I. Descrierea imobilului**

TEREN Extravilan

Adresa: Jud. Neamt, UP I Domesnic - Pipirig, U.A 4%, U.A 5%, U.A 6%, U.A 7%, U.A 8%, U.A 9%

| Nr. Crt | Nr cadastral Nr. topografic | Suprafața* (mp)                                | Observații / Referințe   |
|---------|-----------------------------|--|--|
| A1      |                             | Din acte:<br>3.760.620.000<br>Masurata: 43.733 | Sector cadastral:137 Teren neimprejmuit;<br>DIFERENTA DE SUPRAFATA INSCRISA IN INVENTARUL BUNURILOR DIN DOMENIUL PUBLIC AL STATULUI SE REGASESTE IN ALTE SECTOARE CADASTRALE |

**B. Partea II. Proprietari și acte**

| Inscrieri privitoare la dreptul de proprietate și alte drepturi reale   |  | Referințe |
|---|--|-----------|
| <b>914 / 13/07/2022</b>   |  |           |
| Act Normativ nr. 1705, din 21/12/2006 emis de GUVERNUL ROMÂNIEI (ORDINUL 182/26.02.2018 AVIZ CTAS 324/09.12.2020 EXTRAS DIN AMENAJAMENTUL SILVIC U.P. I PIPIRIG UA 4%, 5%, 6%, 7%, 8%, 9%); |  |           |
| B0  | Intabulare, drept de PROPRIETATE, dobandit prin Lege, cota actuala 1/1, cota initiala 1/1<br>1) <b>STATUL ROMAN</b> , CIF:9999999999999, -domeniul public          | A1        |
| B0  | Intabulare, drept de ADMINISTRARE, dobandit prin Lege, cota actuala 1/1, cota initiala 1/1<br>1) <b>RNP - ROMSILVA - PRIN DIRECTIA SILVICA NEAMT</b> , CIF:1590120 | A1        |

**C. Partea III. SARCINI .**

| Inscrieri privind dezmembramintele dreptului de proprietate, drepturi reale de garanție și sarcini | Referințe |
|--|-----------|
| NU SUNT  |           |

## Anexa Nr. 1 La Partea I

## Teren

| Nr cadastral | Suprafața (mp)*                                   | Observații / Referințe   |
|--------------|---|--|
|              | Din acte:<br>3.760.620.000<br>Masurata:<br>43.733 | DIFERENTA DE SUPRAFATA INSCRISA IN INVENTARUL BUNURILOR DIN DOMENIUL PUBLIC AL STATULUI SE REGASESTE IN ALTE SECTOARE CADASTRALE |

\* Suprafața este determinată în planul de proiecție Stereo 70.

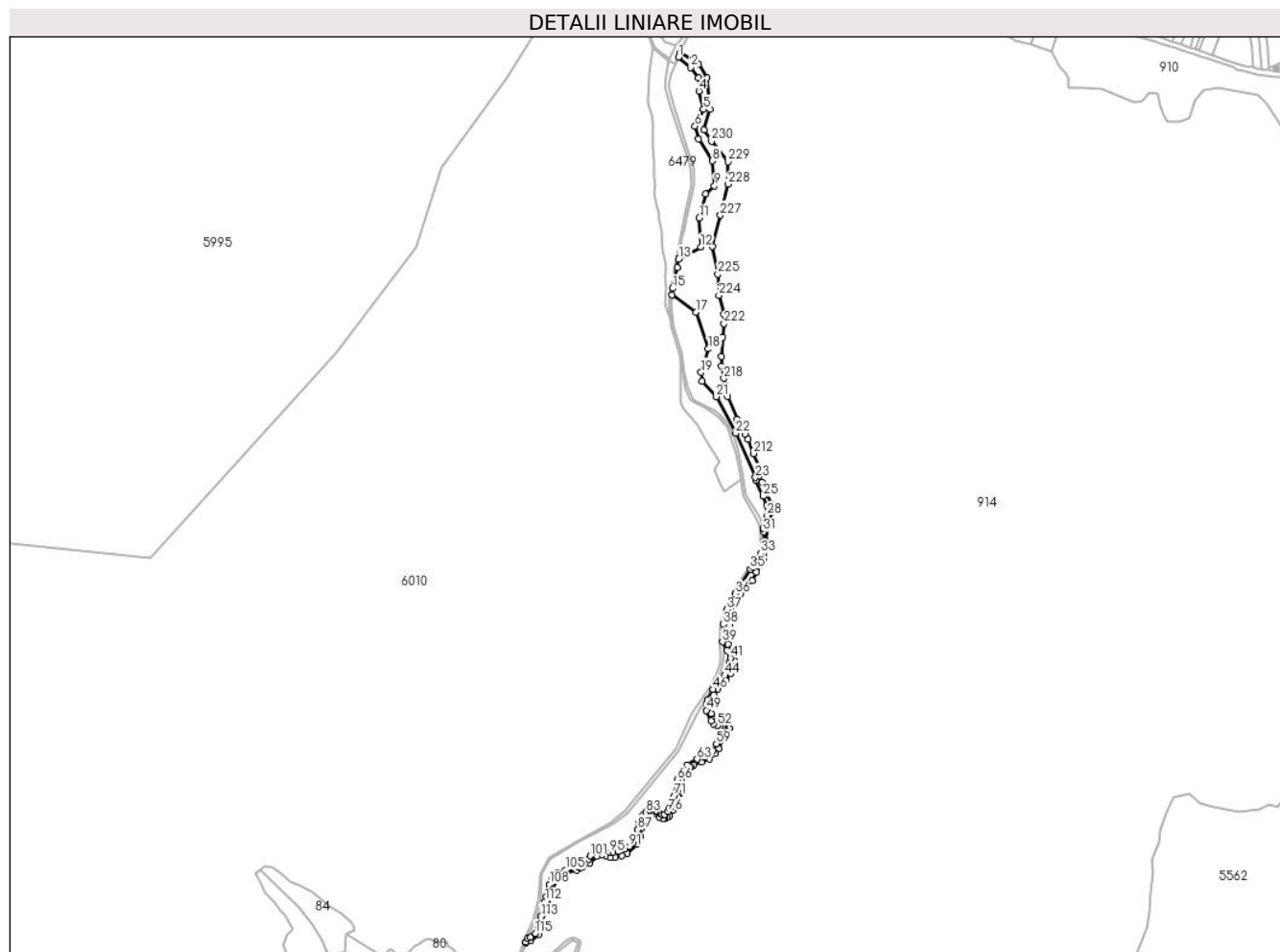

## Date referitoare la teren

| Crt | Categorie folosință | Intravilan | Suprafața (mp) | Tarla         | Parcelă                   | Nr. topo | Observații / Referințe   |
|-----|---------------------|------------|----------------|---------------|---------------------------|----------|--|
| 1   | ape curgătoare      | NU         | 43.733         | UP I Domesnic | UA 4%, 5%, 6%, 7%, 8%, 9% | -        | UP I Domesnic - Pipirig, PARTE DIN U.A 4%, PARTE DIN U.A 5%, PARTE DIN U.A 6%, PARTE DIN U.A 7%, PARTE DIN U.A 8%, PARTE DIN U.A 9%, |

## Lungime Segmente

1) Valorile lungimilor segmentelor sunt obținute din proiecție în plan.

| Punct început | X / Y                      | Punct sfârșit | X / Y                      | Lungime segment | Punct început | X / Y                      | Punct sfârșit | X / Y                      | Lungime segment | Punct început | X / Y                      | Punct sfârșit | X / Y                      | Lungime segment |
|---------------|----------------------------|---------------|----------------------------|-----------------|---------------|----------------------------|---------------|----------------------------|-----------------|---------------|----------------------------|---------------|----------------------------|-----------------|
| 1             | 587.432,561<br>636.625,539 | 2             | 587.458,303<br>636.603,746 | 33.728          | 2             | 587.458,303<br>636.603,746 | 3             | 587.474,423<br>636.581,755 | 27.266          | 3             | 587.474,423<br>636.581,755 | 4             | 587.476,018<br>636.553,945 | 27.856          |
| 4             | 587.476,018<br>636.553,945 | 5             | 587.485,621<br>636.515,096 | 40.018          | 5             | 587.485,621<br>636.515,096 | 6             | 587.467,916<br>636.479,597 | 39.669          | 6             | 587.467,916<br>636.479,597 | 7             | 587.475,192<br>636.452,783 | 27.784          |
| 7             | 587.475,192<br>636.452,783 | 8             | 587.504,75<br>636.405,973  | 55.361          | 8             | 587.504,75<br>636.405,973  | 9             | 587.508,768<br>636.353,232 | 52.894          | 9             | 587.508,768<br>636.353,232 | 10            | 587.490,391<br>636.335,546 | 25.505          |





| Punct început | X / Y                      | Punct sfârșit | X / Y                      | Lungime segment | Punct început | X / Y                      | Punct sfârșit | X / Y                      | Lungime segment | Punct început | X / Y                      | Punct sfârșit | X / Y                      | Lungime segment |
|---------------|----------------------------|---------------|----------------------------|-----------------|---------------|----------------------------|---------------|----------------------------|-----------------|---------------|----------------------------|---------------|----------------------------|-----------------|
| 208           | 587.616,666<br>635.706,089 | 209           | 587.609,804<br>635.725,575 | 20.659          | 209           | 587.609,804<br>635.725,575 | 210           | 587.602,809<br>635.737,91  | 14.18           | 210           | 587.602,809<br>635.737,91  | 211           | 587.612,371<br>635.744,385 | 11.548          |
| 211           | 587.612,371<br>635.744,385 | 212           | 587.591,888<br>635.786,167 | 46.533          | 212           | 587.591,888<br>635.786,167 | 213           | 587.580,625<br>635.815,859 | 31.756          | 213           | 587.580,625<br>635.815,859 | 214           | 587.574,958<br>635.826,729 | 12.259          |
| 214           | 587.574,958<br>635.826,729 | 215           | 587.557,409<br>635.859,095 | 36.817          | 215           | 587.557,409<br>635.859,095 | 216           | 587.536,635<br>635.907,074 | 52.283          | 216           | 587.536,635<br>635.907,074 | 217           | 587.532,678<br>635.928,837 | 22.12           |
| 217           | 587.532,678<br>635.928,837 | 218           | 587.528,721<br>635.945,159 | 16.795          | 218           | 587.528,721<br>635.945,159 | 219           | 587.524,27<br>635.971,374  | 26.59           | 219           | 587.524,27<br>635.971,374  | 220           | 587.524,27<br>635.992,148  | 20.774          |
| 220           | 587.524,27<br>635.992,148  | 221           | 587.525,783<br>636.032,294 | 40.175          | 221           | 587.525,783<br>636.032,294 | 222           | 587.528,959<br>636.061,407 | 29.286          | 222           | 587.528,959<br>636.061,407 | 223           | 587.528,959<br>636.080,991 | 19.584          |
| 223           | 587.528,959<br>636.080,991 | 224           | 587.518,373<br>636.121,219 | 41.598          | 224           | 587.518,373<br>636.121,219 | 225           | 587.515,994<br>636.166,264 | 45.108          | 225           | 587.515,994<br>636.166,264 | 226           | 587.505,077<br>636.225,035 | 59.776          |
| 226           | 587.505,077<br>636.225,035 | 227           | 587.521,568<br>636.291,089 | 68.081          | 227           | 587.521,568<br>636.291,089 | 228           | 587.537,981<br>636.356,83  | 67.759          | 228           | 587.537,981<br>636.356,83  | 229           | 587.537,981<br>636.404,441 | 47.611          |
| 229           | 587.537,981<br>636.404,441 | 230           | 587.502,936<br>636.448,113 | 55.995          | 230           | 587.502,936<br>636.448,113 | 231           | 587.486,275<br>636.471,356 | 28.598          | 231           | 587.486,275<br>636.471,356 | 232           | 587.499,97<br>636.515,071  | 45.81           |
| 232           | 587.499,97<br>636.515,071  | 233           | 587.493,21<br>636.581,475  | 66.747          | 233           | 587.493,21<br>636.581,475  | 234           | 587.474,973<br>636.611,853 | 35.432          | 234           | 587.474,973<br>636.611,853 | 235           | 587.437,212<br>636.636,046 | 44.846          |
| 235           | 587.437,212<br>636.636,046 | 1             | 587.432,561<br>636.625,539 | 11.49           |               |                            |               |                            |                 |               |                            |               |                            |                 |

\*\* Lungimile segmentelor sunt determinate în planul de proiecție Stereo 70 și sunt rotunjite la 1 milimetru.

\*\*\* Distanța dintre puncte este formată din segmente cumulate ce sunt mai mici decât valoarea 1 milimetru.



**DATE DESPRE IMOBILUL NR. 918**

Oficiul de Cadastru și Publicitate Imobiliară NEAMT  
Biroul de Cadastru și Publicitate Imobiliară Targu-Neamt

**A. Partea I. Descrierea imobilului**

TEREN Extravilan

Adresa: Jud. Neamt

| Nr. Crt | Nr cadastral Nr. topografic | Suprafața* (mp)                                | Observații / Referințe   |
|---------|-----------------------------|--|--|
| A1      |                             | Din acte:<br>3.760.620.000<br>Masurata: 16.734 | Sector cadastral:137 Teren neimprejmuit;<br>DIFERENTA DE SUPRAFATA INSCRISA IN INVENTARUL BUNURILOR DIN DOMENIUL PUBLIC AL STATULUI SE REGASESTE IN ALTE SECTOARE CADASTRALE |

**B. Partea II. Proprietari și acte**

| Inscrieri privitoare la dreptul de proprietate și alte drepturi reale  |  | Referințe |
|--|--|-----------|
| <b>914 / 13/07/2022</b>  |  |           |
| Act Normativ nr. 1705, din 21/12/2006 emis de GUVERNUL ROMÂNIEI (ORDINUL 182/26.02.2018 AVIZ CTAS 324/09.12.2020 EXTRAS DIN AMENAJAMENTUL SILVIC U.P. I PIPIRIG UA 52%); |  |           |
| B0   | Intabulare, drept de PROPRIETATE, dobandit prin Lege, cota actuala 1/1, cota initiala 1/1<br>1) <b>STATUL ROMAN</b> , CIF:9999999999999, -domeniul public          | A1        |
| B0   | Intabulare, drept de ADMINISTRARE, dobandit prin Lege, cota actuala 1/1, cota initiala 1/1<br>1) <b>RNP - ROMSILVA - PRIN DIRECTIA SILVICA NEAMT</b> , CIF:1590120 | A1        |

**C. Partea III. SARCINI .**

| Inscrieri privind dezmembramintele dreptului de proprietate, drepturi reale de garanție și sarcini | Referințe |
|--|-----------|
| NU SUNT  |           |

## Anexa Nr. 1 La Partea I

## Teren

| Nr cadastral | Suprafața (mp)*                                   | Observații / Referințe   |
|--------------|---|--|
|              | Din acte:<br>3.760.620.000<br>Masurata:<br>16.734 | DIFERENTA DE SUPRAFATA INSCRISA IN INVENTARUL BUNURILOR DIN DOMENIUL PUBLIC AL STATULUI SE REGASESTE IN ALTE SECTOARE CADASTRALE |

\* Suprafața este determinată în planul de proiecție Stereo 70.

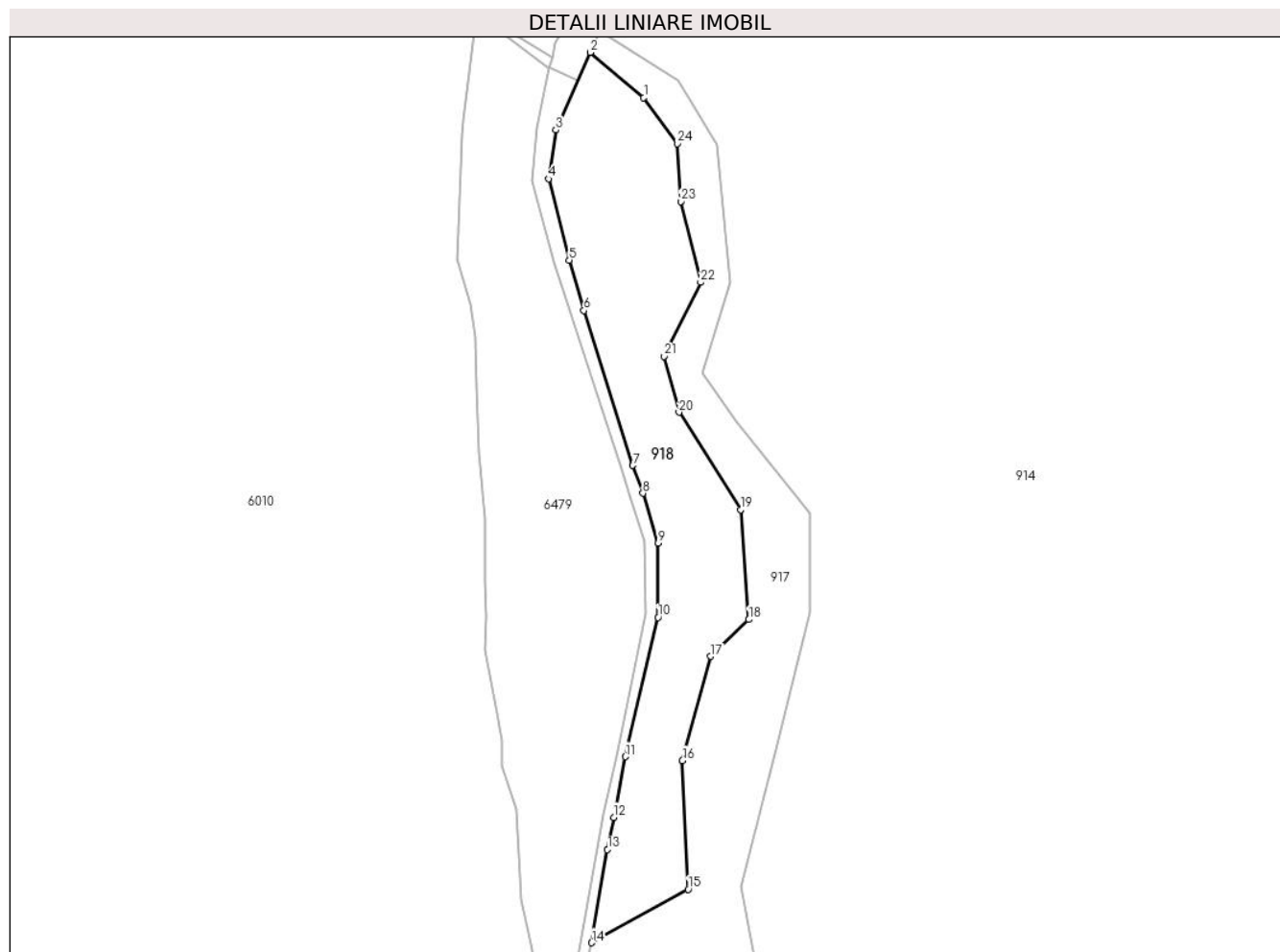

## Date referitoare la teren

| Crt | Categorie folosință | Intravilan | Suprafața (mp) | Tarla         | Parcelă | Nr. topo | Observații / Referințe                     |
|-----|---------------------|------------|----------------|---------------|---------|----------|--|
| 1   | padure              | NU         | 16.734         | UP I Domesnic | UA 52%  | -        | UP I Domesnic - Pipirig, PARTE DIN U.A 52% |

## Lungime Segmente

1) Valorile lungimilor segmentelor sunt obținute din proiecție în plan.

| Punct început | X / Y                      | Punct sfârșit | X / Y                      | Lungime segment (** (m) |
|---------------|----------------------------|---------------|----------------------------|-------------------------|
| 1             | 587.458,303<br>636.603,746 | 2             | 587.432,561<br>636.625,539 | 33.728                  |
| 3             | 587.416,059<br>636.588,263 | 4             | 587.412,492<br>636.564,795 | 23.738                  |
| 5             | 587.422,476<br>636.525,8   | 6             | 587.429,537<br>636.501,585 | 25.223                  |
| 7             | 587.452,983<br>636.427,239 | 8             | 587.457,874<br>636.413,831 | 14.272                  |

| Punct început | X / Y                      | Punct sfârșit | X / Y                      | Lungime segment (** (m) |
|---------------|----------------------------|---------------|----------------------------|-------------------------|
| 2             | 587.432,561<br>636.625,539 | 3             | 587.416,059<br>636.588,263 | 40.765                  |
| 4             | 587.412,492<br>636.564,795 | 5             | 587.422,476<br>636.525,8   | 40.253                  |
| 6             | 587.429,537<br>636.501,585 | 7             | 587.452,983<br>636.427,239 | 77.955                  |
| 8             | 587.457,874<br>636.413,831 | 9             | 587.465,231<br>636.389,855 | 25.079                  |



| Punct început | X / Y                      | Punct sfârșit | X / Y                      | Lungime segment (** (m) |
|---------------|----------------------------|---------------|----------------------------|-------------------------|
| 9             | 587.465,231<br>636.389,855 | 10            | 587.465,137<br>636.354,298 | 35.557                  |
| 11            | 587.449,419<br>636.287,404 | 12            | 587.443,876<br>636.258,245 | 29.681                  |
| 13            | 587.440,862<br>636.242,8   | 14            | 587.433,184<br>636.198,051 | 45.403                  |
| 15            | 587.479,616<br>636.223,75  | 16            | 587.476,859<br>636.285,498 | 61.81                   |
| 17            | 587.490,391<br>636.335,546 | 18            | 587.508,768<br>636.353,232 | 25.505                  |
| 19            | 587.504,75<br>636.405,973  | 20            | 587.475,192<br>636.452,783 | 55.361                  |
| 21            | 587.467,916<br>636.479,597 | 22            | 587.485,621<br>636.515,096 | 39.669                  |
| 23            | 587.476,018<br>636.553,945 | 24            | 587.474,423<br>636.581,755 | 27.856                  |

| Punct început | X / Y                      | Punct sfârșit | X / Y                      | Lungime segment (** (m) |
|---------------|----------------------------|---------------|----------------------------|-------------------------|
| 10            | 587.465,137<br>636.354,298 | 11            | 587.449,419<br>636.287,404 | 68.716                  |
| 12            | 587.443,876<br>636.258,245 | 13            | 587.440,862<br>636.242,8   | 15.736                  |
| 14            | 587.433,184<br>636.198,051 | 15            | 587.479,616<br>636.223,75  | 53.069                  |
| 16            | 587.476,859<br>636.285,498 | 17            | 587.490,391<br>636.335,546 | 51.845                  |
| 18            | 587.508,768<br>636.353,232 | 19            | 587.504,75<br>636.405,973  | 52.894                  |
| 20            | 587.475,192<br>636.452,783 | 21            | 587.467,916<br>636.479,597 | 27.784                  |
| 22            | 587.485,621<br>636.515,096 | 23            | 587.476,018<br>636.553,945 | 40.018                  |
| 24            | 587.474,423<br>636.581,755 | 1             | 587.458,303<br>636.603,746 | 27.266                  |

\*\* Lungimile segmentelor sunt determinate în planul de proiecție Stereo 70 și sunt rotunjite la 1 milimetru.

\*\*\* Distanța dintre puncte este formată din segmente cumulate ce sunt mai mici decât valoarea 1 milimetru.

