

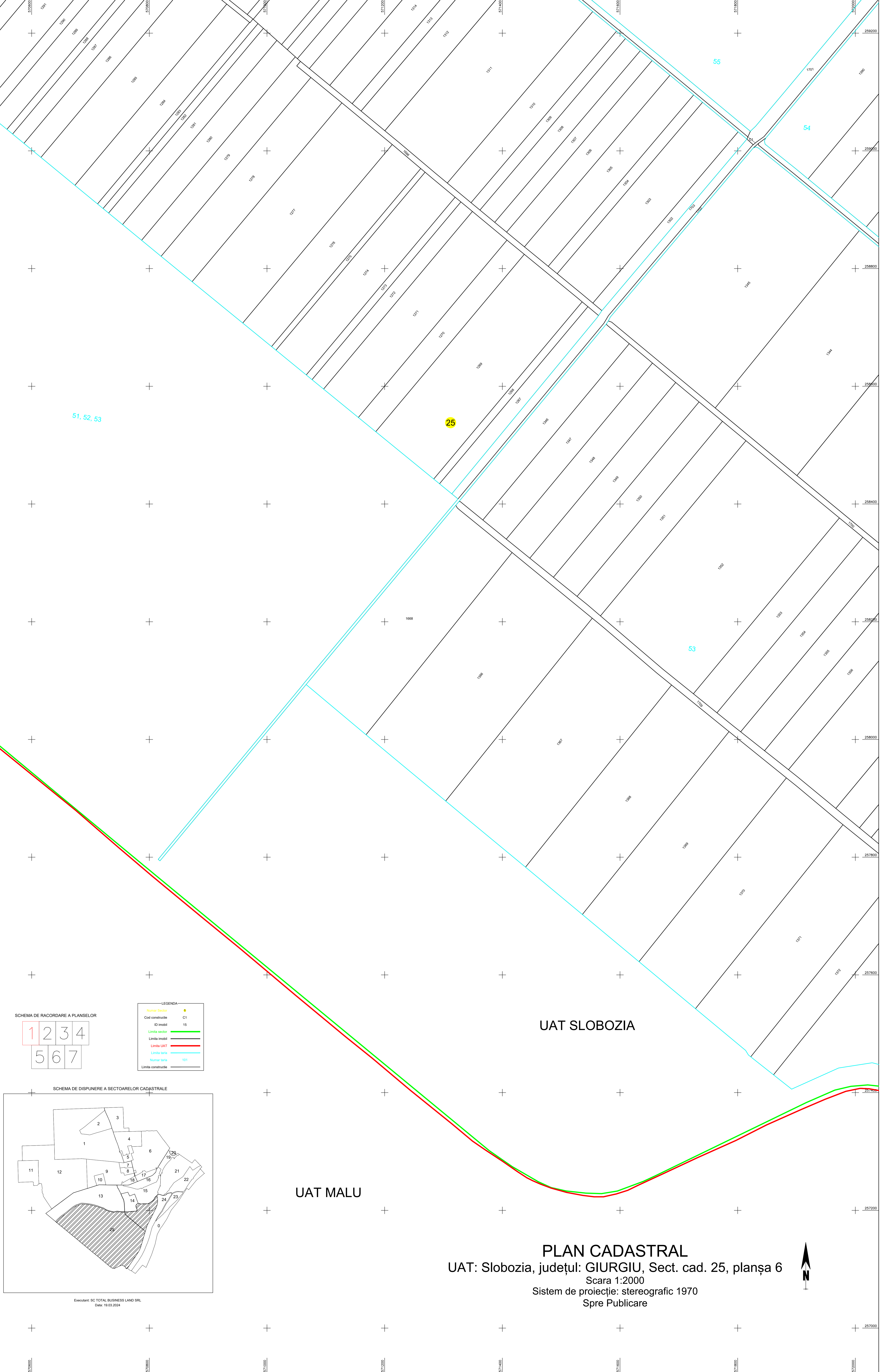

258200
259000
258800
258600
258400
258200
258000
257800
257600
257400
257200
257000

52
51, 52, 53
25
55
54
53



570500
571000
571500
572000
572500
573000
573500
574000
574500
575000

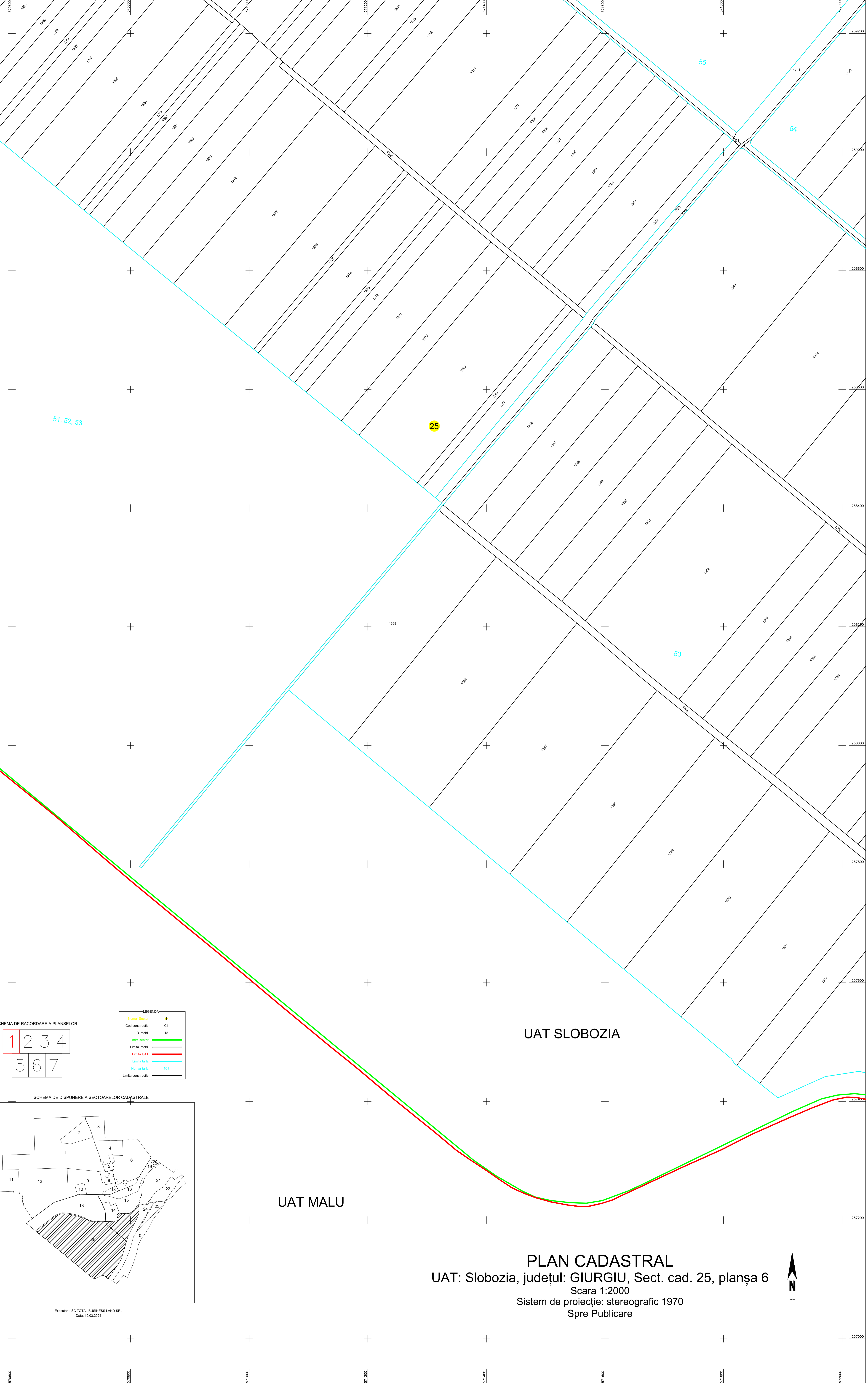

1091
1092
1093
1094
1095
1096
1097
1098
1099
1100
1101
1102
1103
1104
1105
1106
1107
1108
1109
1110
1111
1112
1113
1114
1115
1116
1117
1118
1119
1120
1121
1122
1123
1124
1125
1126
1127
1128
1129
1130
1131
1132
1133
1134
1135
1136
1137
1138
1139
1140
1141
1142
1143
1144
1145
1146
1147
1148
1149
1150
1151
1152
1153
1154
1155
1156
1157
1158
1159
1160
1161
1162
1163
1164
1165
1166
1167
1168
1169
1170
1171
1172
1173
1174
1175
1176
1177
1178
1179
1180
1181
1182
1183
1184
1185
1186
1187
1188
1189
1190
1191
1192
1193
1194
1195
1196
1197
1198
1199
1200

SCHEMA DE RACORDARE A PLANSELOR

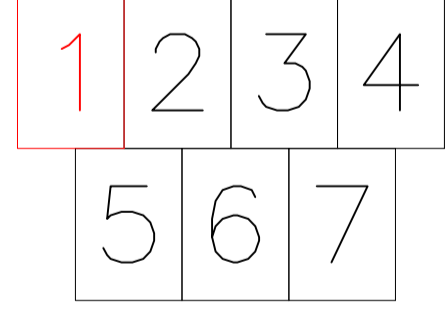

LEGENDA	
Linia sector	15
Cod constructie	C1
ID imobil	15
Linia sector	15
Linia imobil	15
Linia UAT	15
Linia tarla	101
Numar tarla	101
Linia constructie	15

SCHEMA DE DISPUNERE A SECTOARELOR CADASTRALE

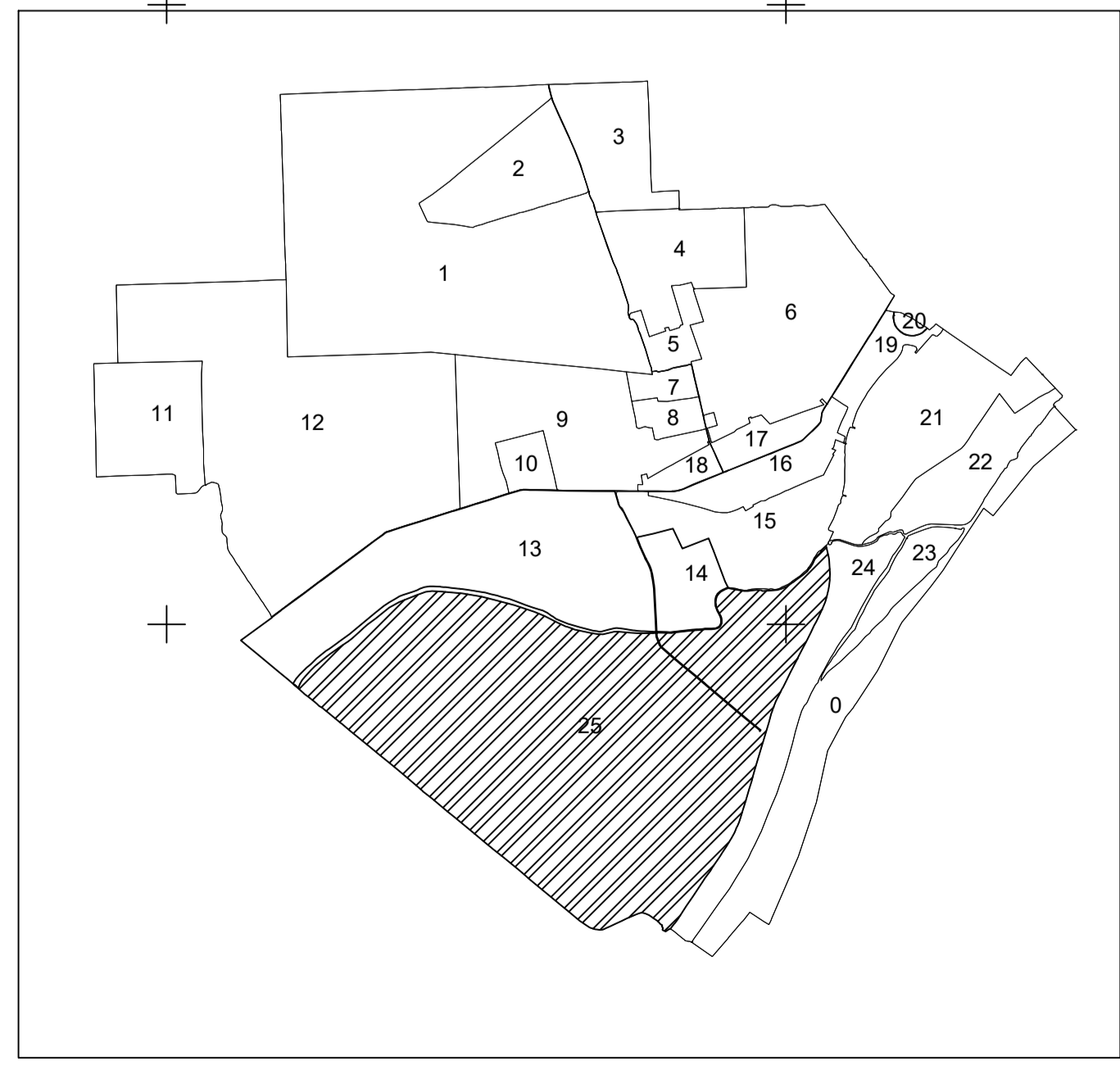

Executant: SC TOTAL BUSINESS LAND SRL
Data: 19.03.2024

UAT SLOBOZIA

UAT MALU

PLAN CADASTRAL
UAT: Slobozia, județul: GIURGIU, Sect. cad. 25, planșa 6
Scara 1:2000
Sistem de proiecție: stereografic 1970
Spre Publicare

