

COMUNA
APAHIDA

COMUNA
COJOCNA

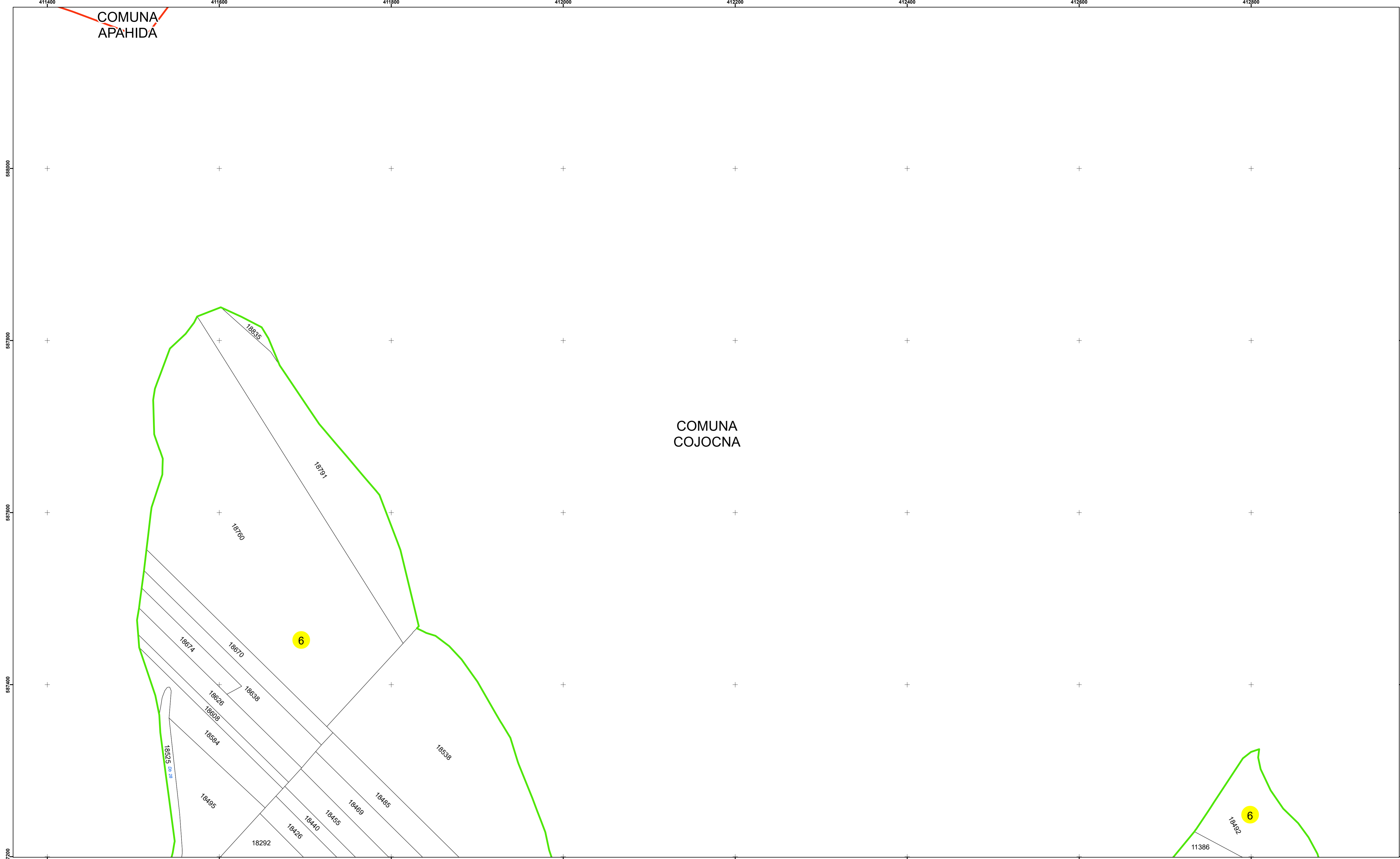

Disponerea Sectoarelor Cadastrale

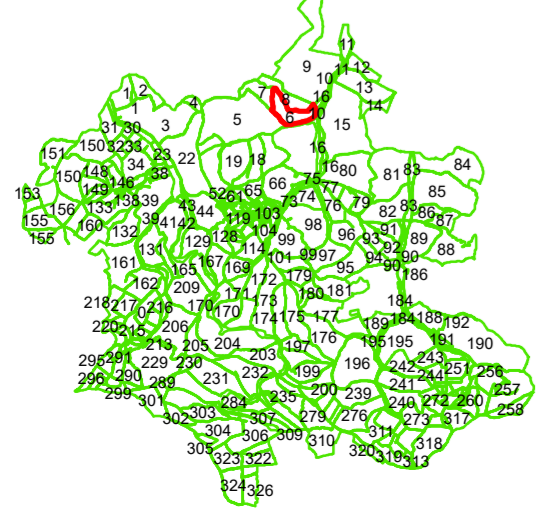

Racordare planșe

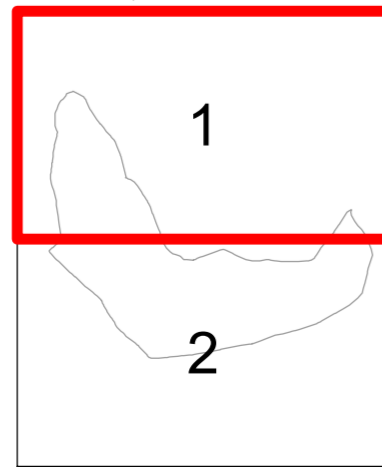

Planșa 1 din 2

Legendă

- Limită UAT
- Limită Intravilan
- Sector Cadastral
- Limită Imobil
- 3 Număr Sector Cadastral
- 458 Identificator Teren

Executant: SC MEGAGIS SRL

Spre publicare

Data: noiembrie 2023





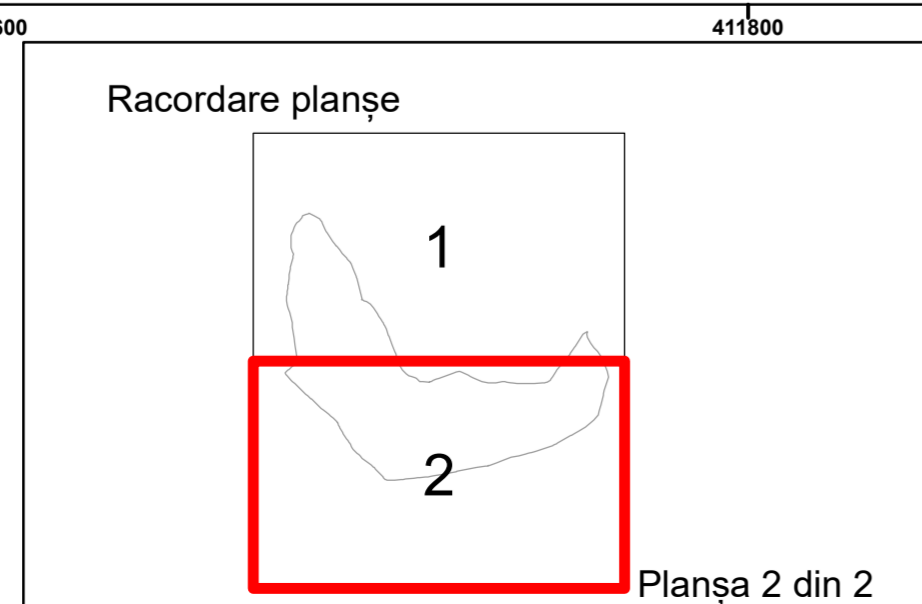
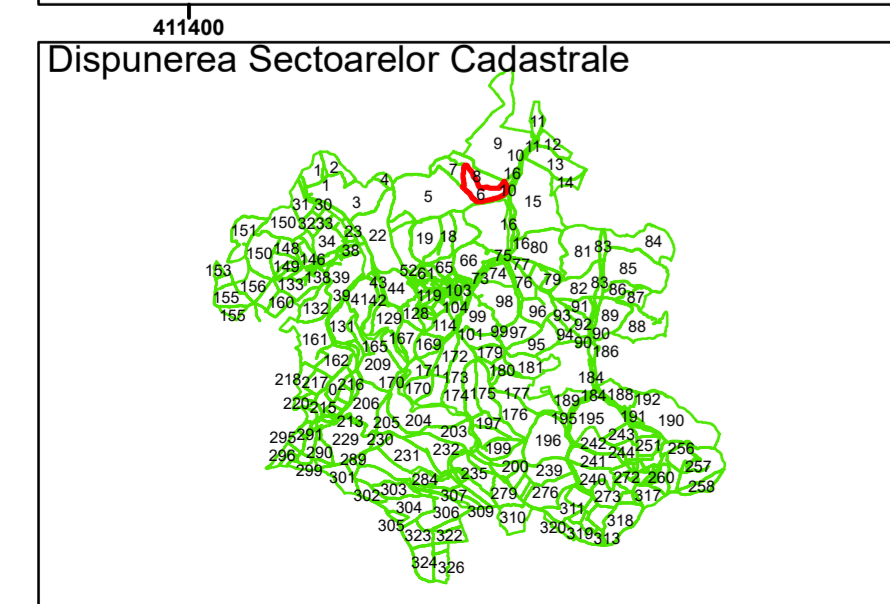
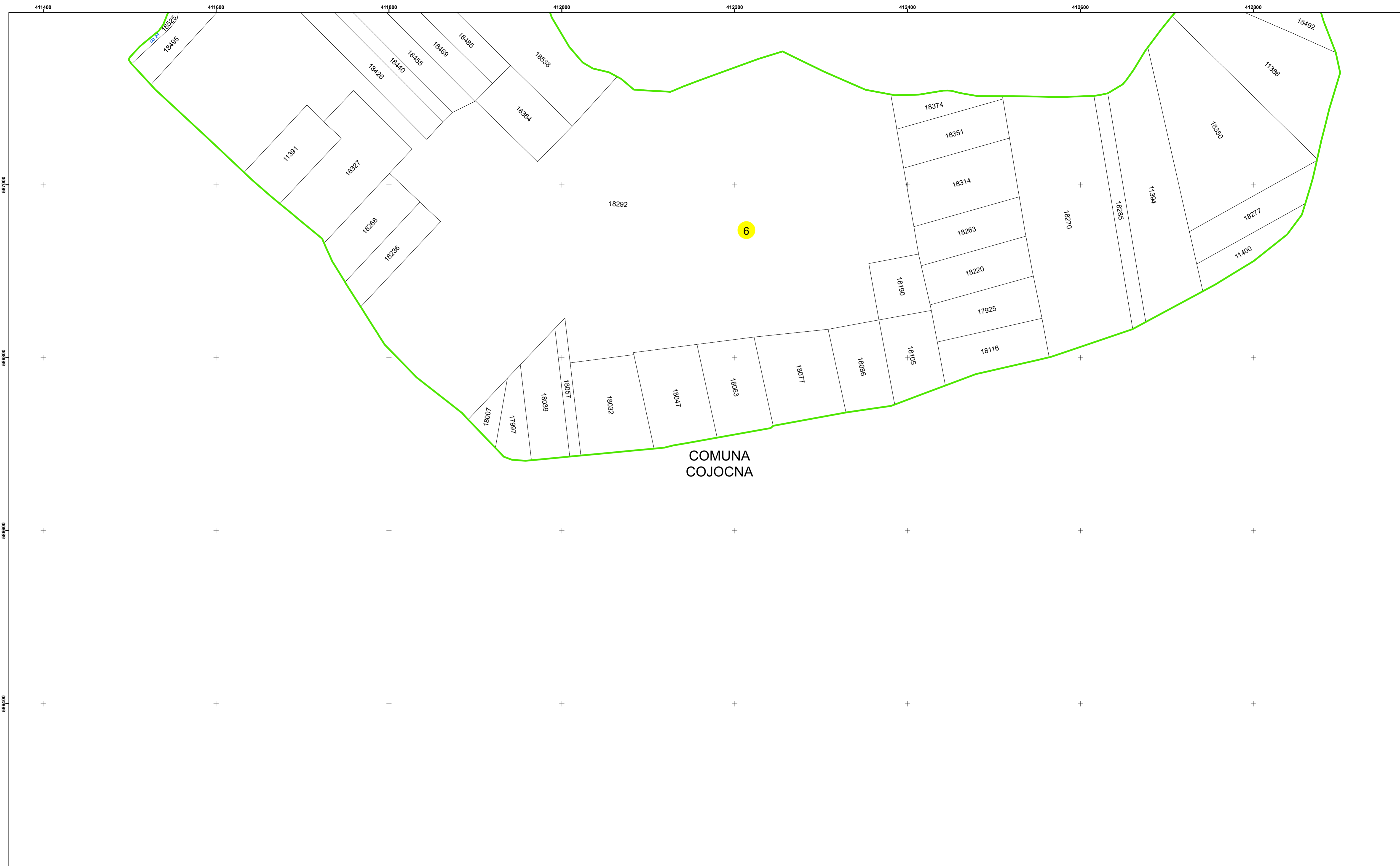

PLAN CADASTRAL

Comuna Cojocna
Județul Cluj
Sector Cadastral 6

Scara 1:2000, sistem de proiecție STEREO 70

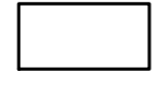

Legendă

	Limită UAT		Limită Imobil
	Limită Intravilan		Număr Sector Cadastral
	Sector Cadastral	458	Identificator Teren

Executant: SC MEGAGIS SRL

Spre publicare

Data: noiembrie 2023

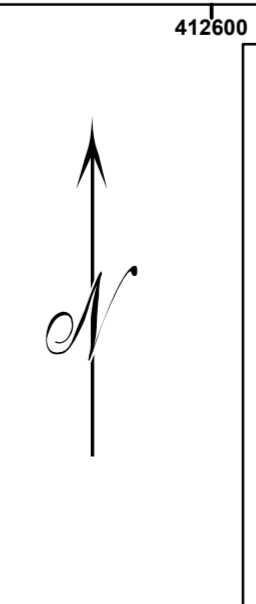

PLAN CADASTRAL

Comuna Cojocna
Județul Cluj
Sector Cadastral 6

Scara 1:2000, sistem de proiecție STEREO 70