

PLAN CADASTRAL

UAT: Catina, judetul: CLUJ, Sect. cad. 182, plansa 1
 Scara 1:2000
 Sistem de proiectie: stereografic 1970
 Spre Publicare

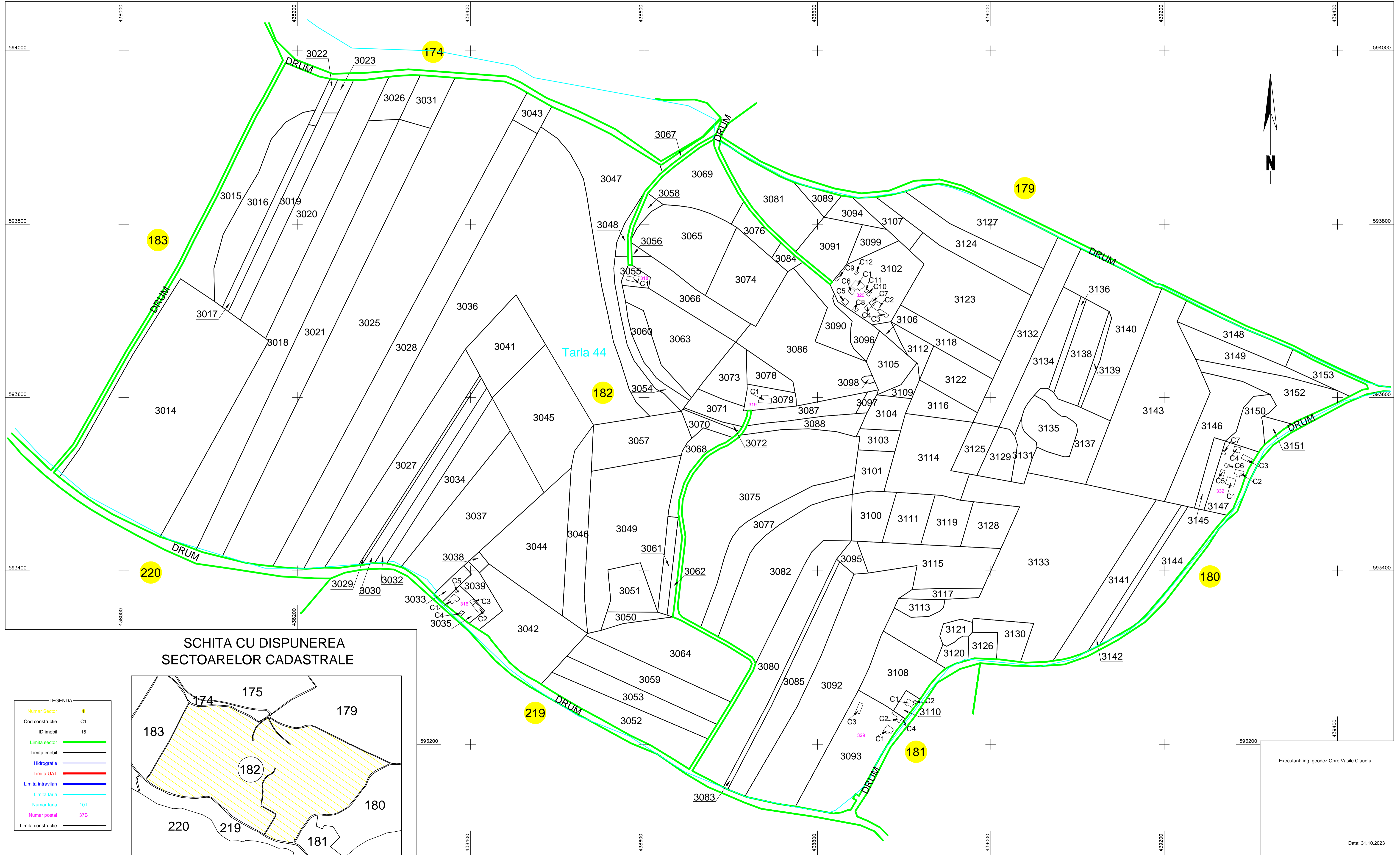

**SCHITA CU DISPUNEREA
SECTOARELOR CADASTRALE**

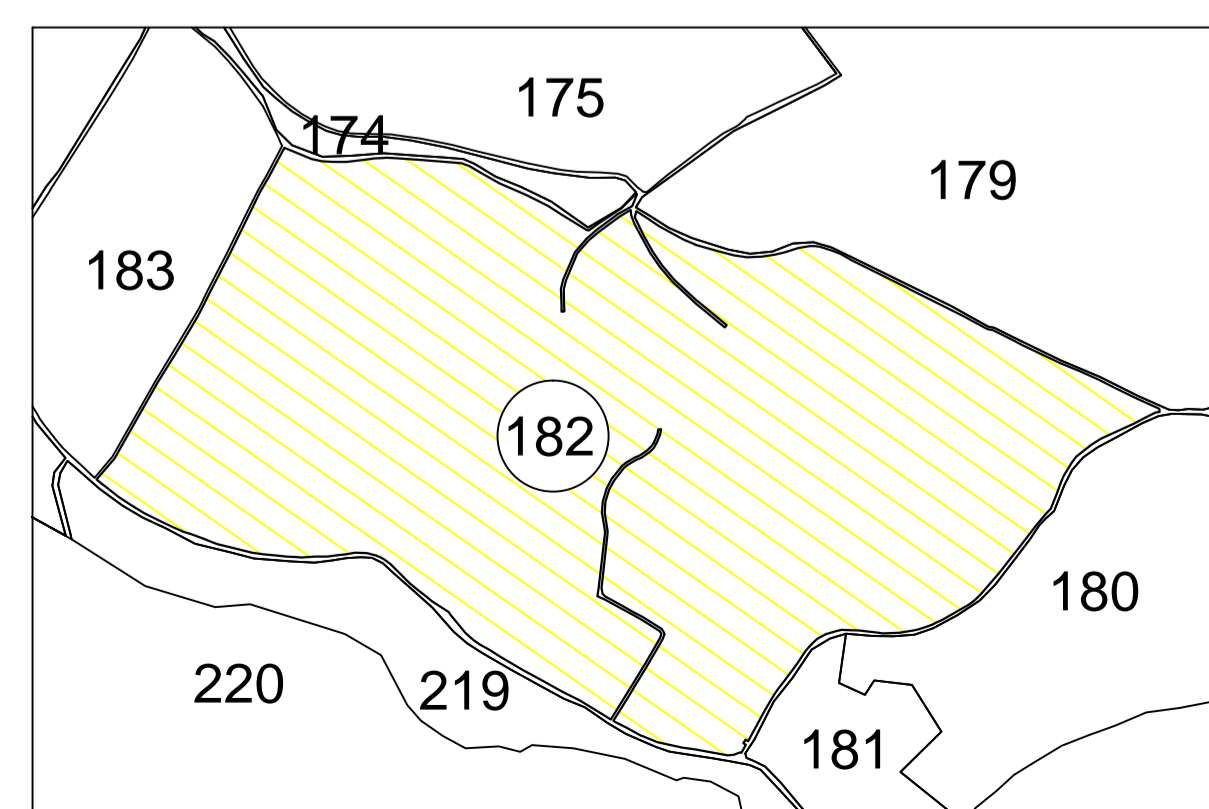

LEGENDA

Numar Sector	182
Cod constructie	C1
ID imobil	15
Limita sector	— (green line)
Limita imobil	— (black line)
Hidrografie	— (blue line)
Limita UAT	— (red line)
Limita intravilan	— (blue line)
Limita tarla	— (cyan line)
Numar tarla	101
Numar postal	37B
Limita constructie	— (black line)

Executant: ing. geodez Opre Vasile Claudiu