

**PLAN CADASTRAL**  
 UAT SLATINA-TIMIS, judetul CARAS-SEVERIN  
 SECTOR 46  
 Scara 1:1000  
 Sistem de proiectie STEREO 70  
 Plansa 1/2

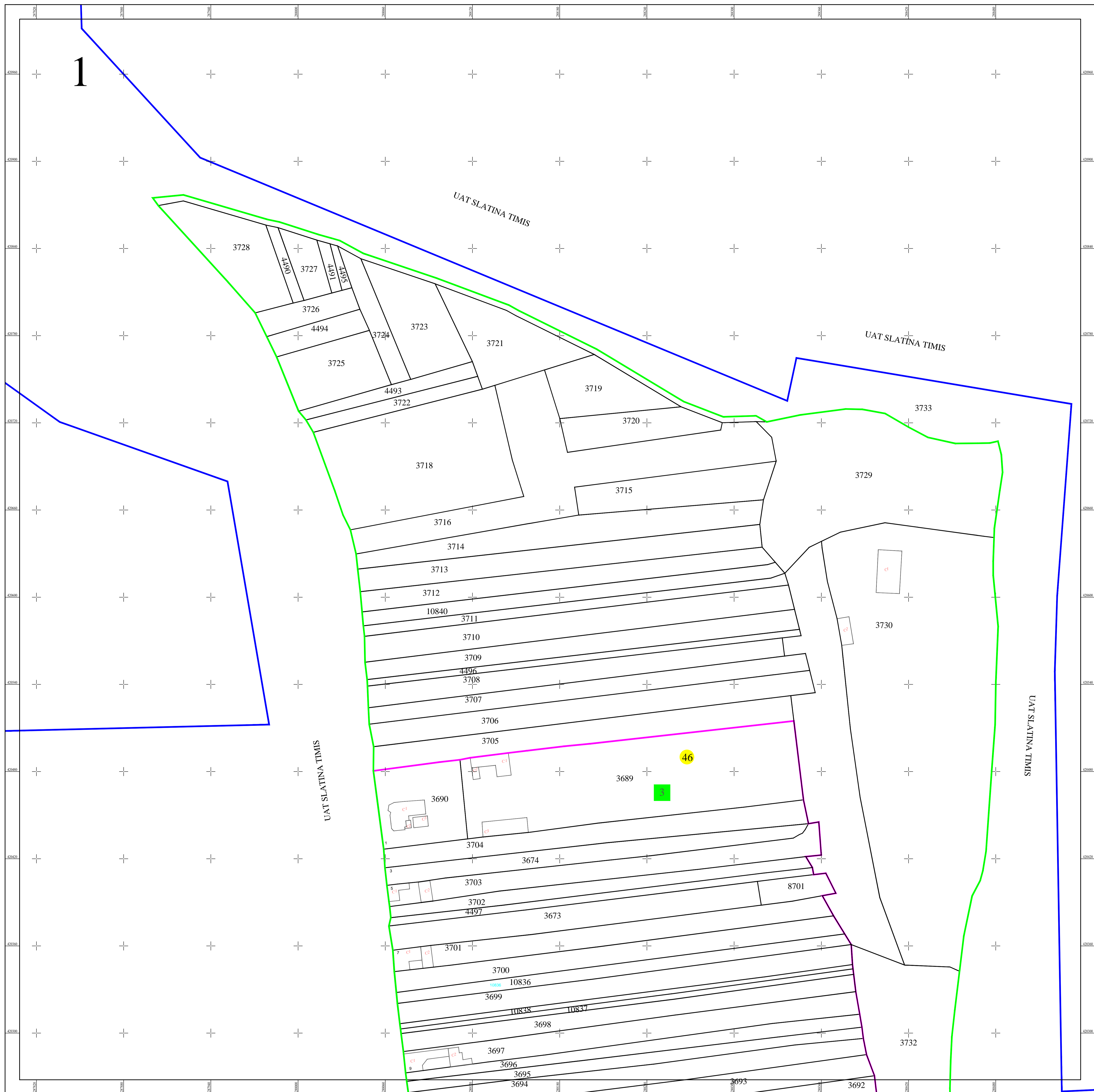

Schita dispunerii planselor

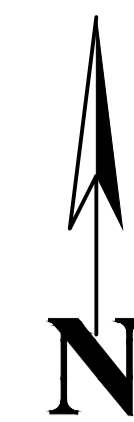
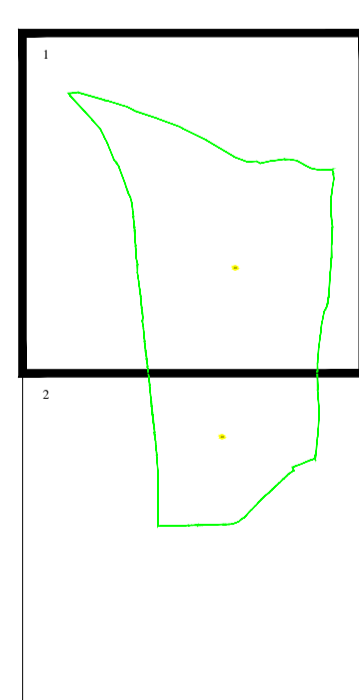

**LEGENDĂ**

<span style="background-color: yellow; border-radius: 50%; padding: 2px;">46</span>	Numar sector cadastral
CARAS-SEVERIN	Judet
SLATINA-TIMIS	UAT
SADOVA-VECHE	Localitati
<b>PLAN CADASTRAL</b>	<b>Titlu</b>
Sector cadastral nr. 46	Subtitluri, Sector cadastral
1:1000	Scara
3690	ID
<span style="border-bottom: 1px solid magenta; width: 20px; display: inline-block;"></span>	Limita tarlalelor
<span style="border-bottom: 1px solid red; width: 20px; display: inline-block;"></span>	Limita de judet
<span style="border-bottom: 1px solid orange; width: 20px; display: inline-block;"></span>	Limita UAT
<span style="border-bottom: 1px solid green; width: 20px; display: inline-block;"></span>	Limita sectoarelor cadastrale
<span style="border-bottom: 1px solid blue; width: 20px; display: inline-block;"></span>	Limita intravilan
<span style="border-bottom: 1px solid black; width: 20px; display: inline-block;"></span>	Limita imobil
<span style="border-bottom: 1px solid gray; width: 20px; display: inline-block;"></span>	Limita constructiilor cu caracter permanent

Documente spre publicare

ANCPI

**Servicii de înregistrare sistematică în  
Sistemul Integrat de Cadastru și Carte  
Funciară a imobilelor situate în UAT  
Slatina-Timis, jud. Caras-Severin**

S.C. GEODETIC SYS S.R.L.

Data  
martie 2024