

PLAN CADASTRAL  
UAT CARBUNARI, judetul CARAS-SEVERIN, Sector cadastral 9, plansa 1  
Scara 1:1000  
Sistem de proiectie: stereografic 1970  
„spre publicare,,

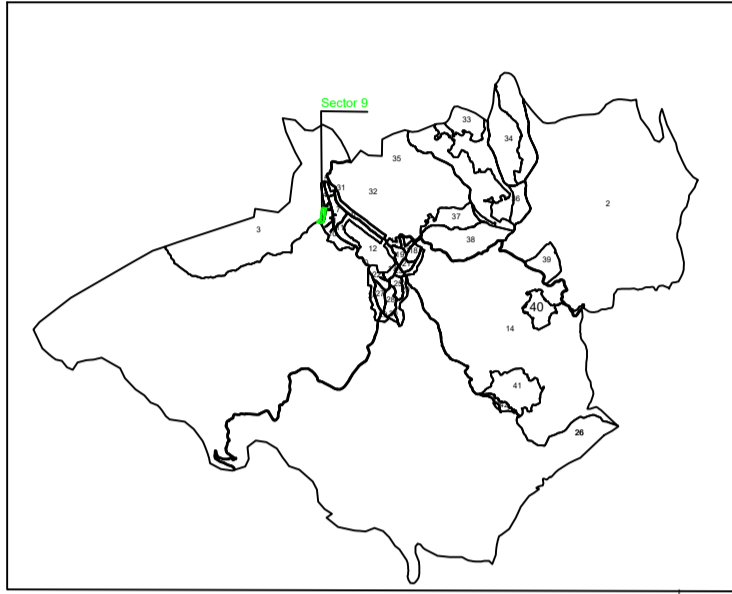

DISPUNEREA SECTOARELOR CADASTRALE  
UAT: CARBUNARI, JUDEȚ: CARAS-SEVERIN



LEGENDA	
Numar Sector	9
Cod constructie	C1
ID imobil	15
Limita sector	
Limita imobil	
Hidrografie	
Limita UAT	
Limita intravilan	
Limita tarla	
Numar tarla	101
Numar postal	37B
Limita constructie	

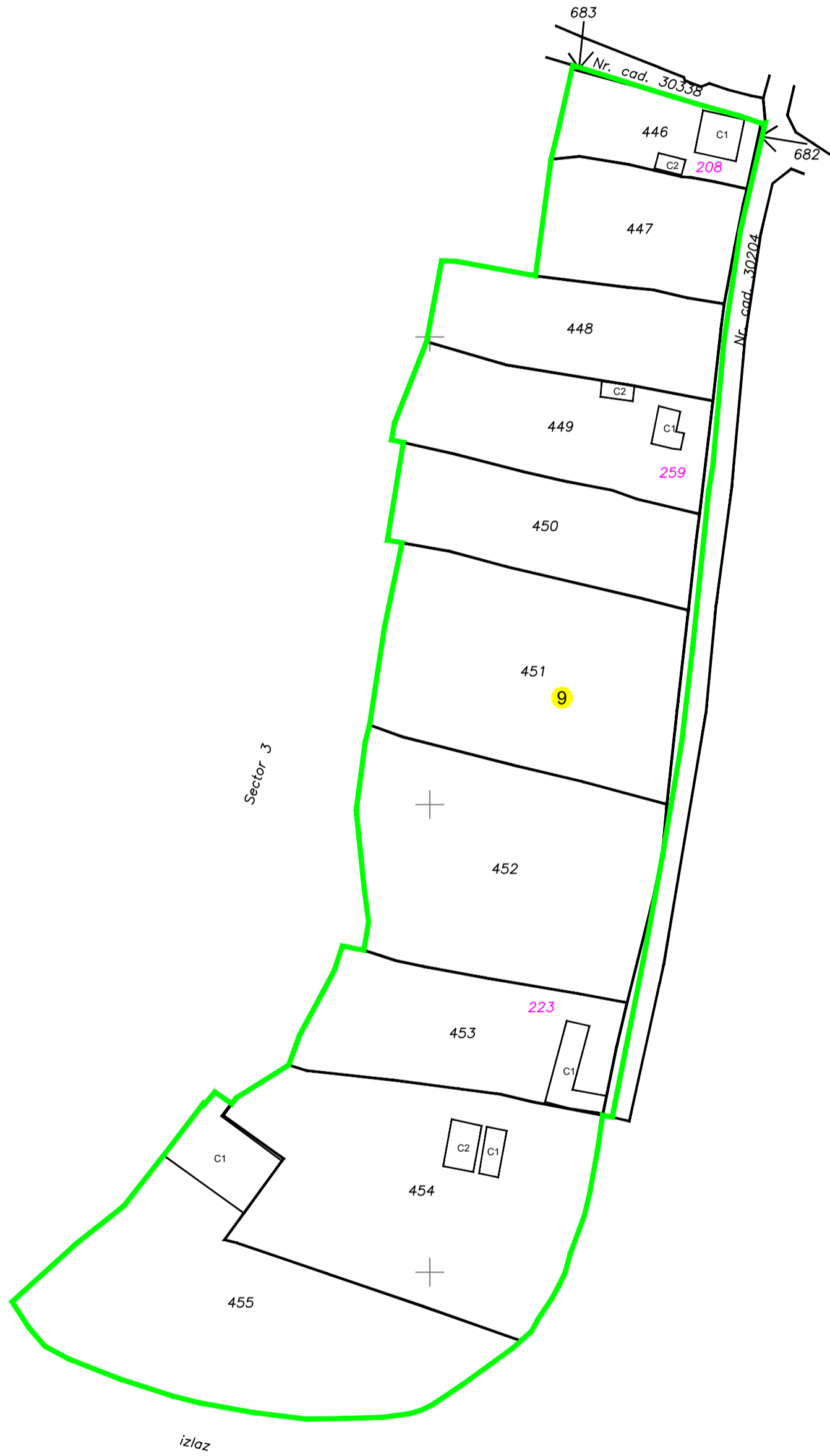

Primaria Comunei Carbuinari  
Data: 15.01.2025

Executant: SC WGS-TOPOTEAM SRL  
Inginer Iacubovschi Sergiu Adrian

Data: 15.01.2025