

PLAN CADASTRAL
UAT: Merei, judetul: BUZAU, Sect. cad. 10,11,12,13,14,15,31,32,33,34, plansa 1
Scara 1:10000
Sistem de proiectie: stereografic 1970
Spre Publicare

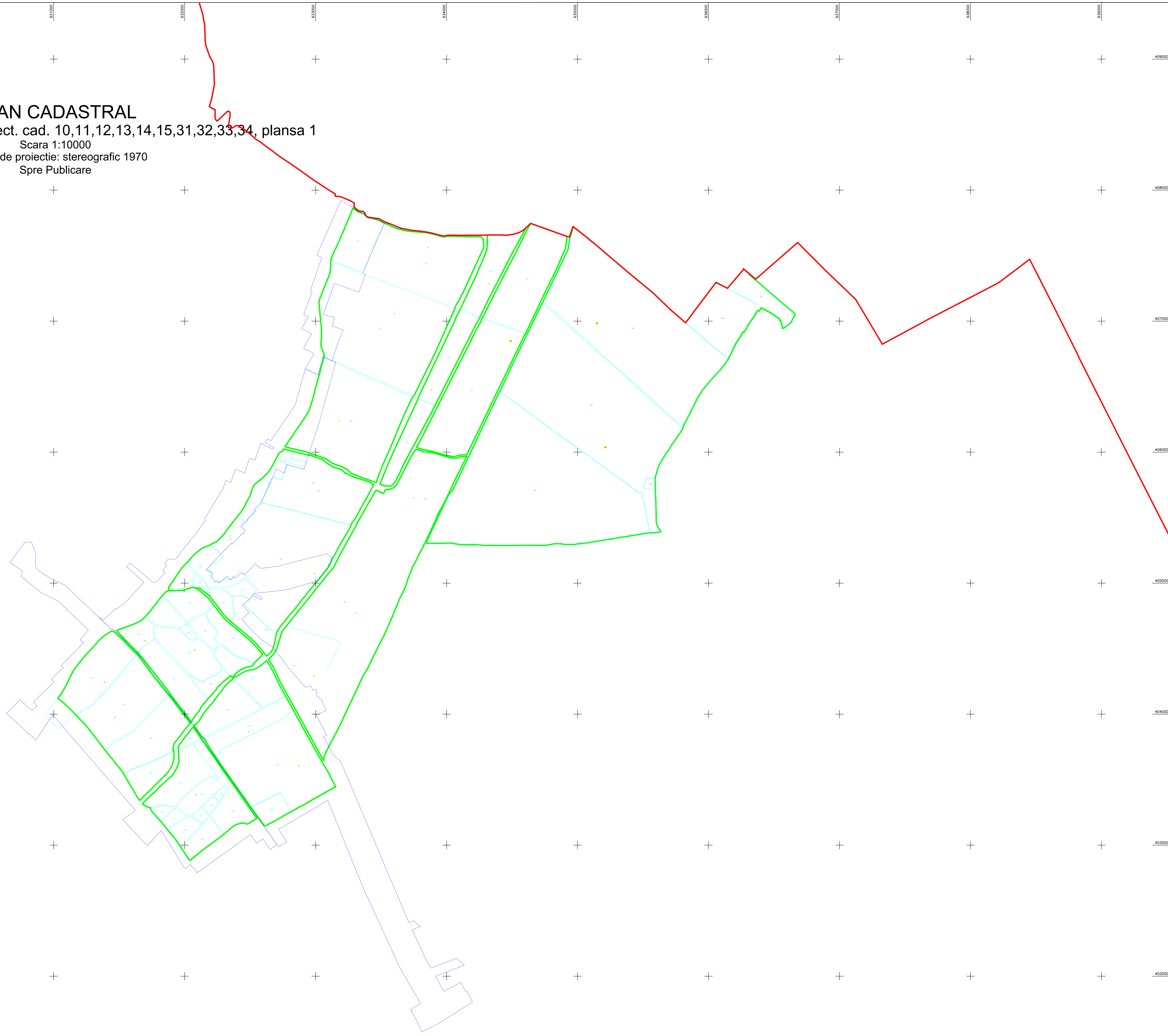

LEGENDA	
Numar Sector	●
Cod constructie	C1
ID imobil	15
Limta sector	—
Limta imobil	—
Hidrografe	—
Limta UAT	—
Limta intravilan	—
Limta tarla	—
Numar tarla	101
Numar punct	378
Limta constructie	—

Executant: SC TOTAL BUSINESS LAND SRL
Data: 11.05.2023