

PLAN CADASTRAL
 UAT: Helegiu, judetul: BACAU, Sect. cad. 42, plansa 1
 Scara 1:1000
 Sistem de proiectie: stereografic 1970
 Spre Publicare

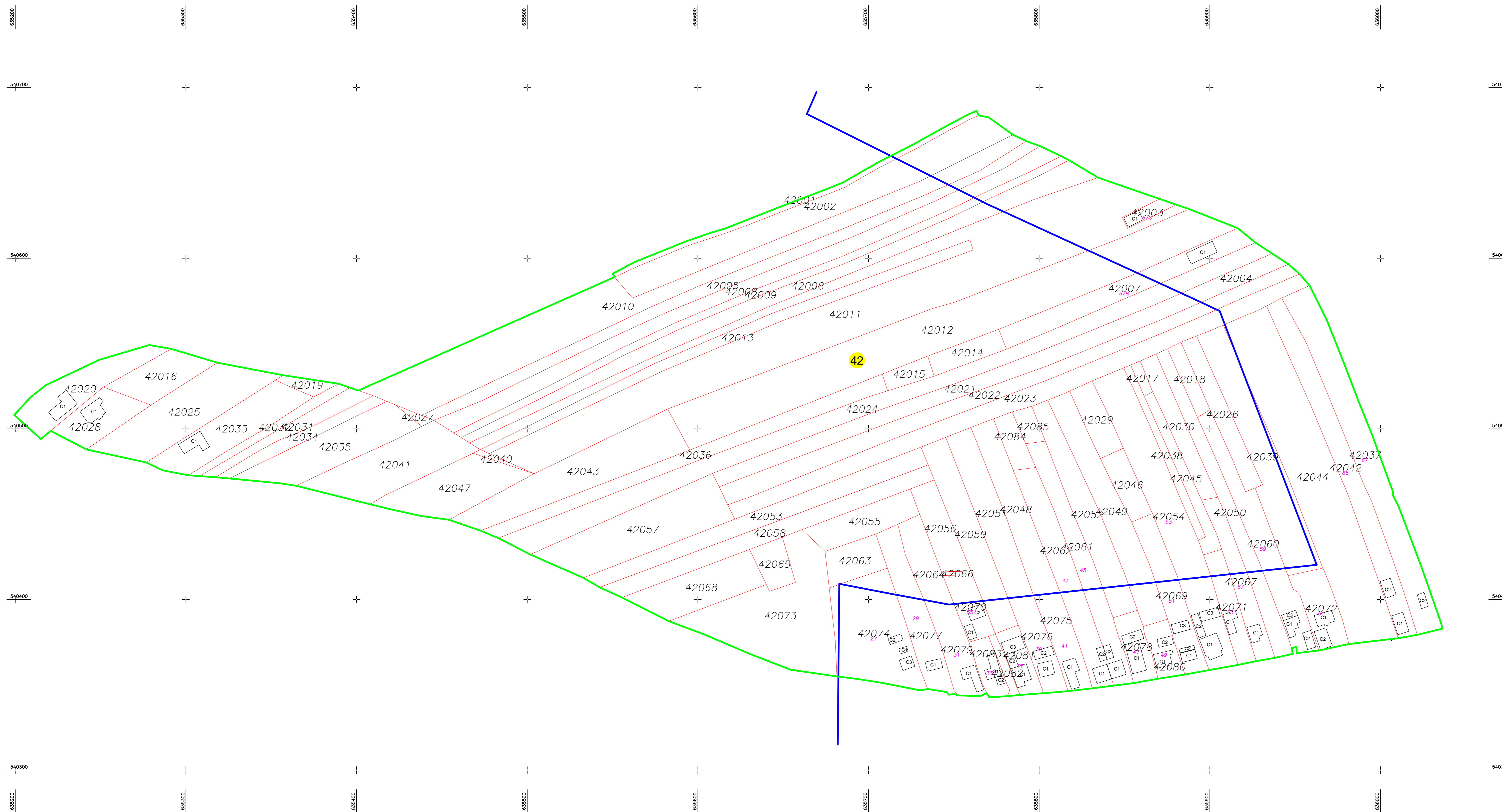

LEGENDA	
Numar secti	42
Cod constructie	C1
ID parcel	15
Limita sectoi	—
Limita imobil	—
Hekografie	—
Limita UAT	—
Limita intravilan	—
Limita tarie	—
Numar tarie	101
Numar parcel	378
Limita constructie	—