

PLAN CADASTRAL
 UAT: Helegiu, judetul: BACAU, Sect. cad. 32, plansa 3
 Scara 1:2000
 Sistem de proiectie: stereografic 1970
 Spre Publicare

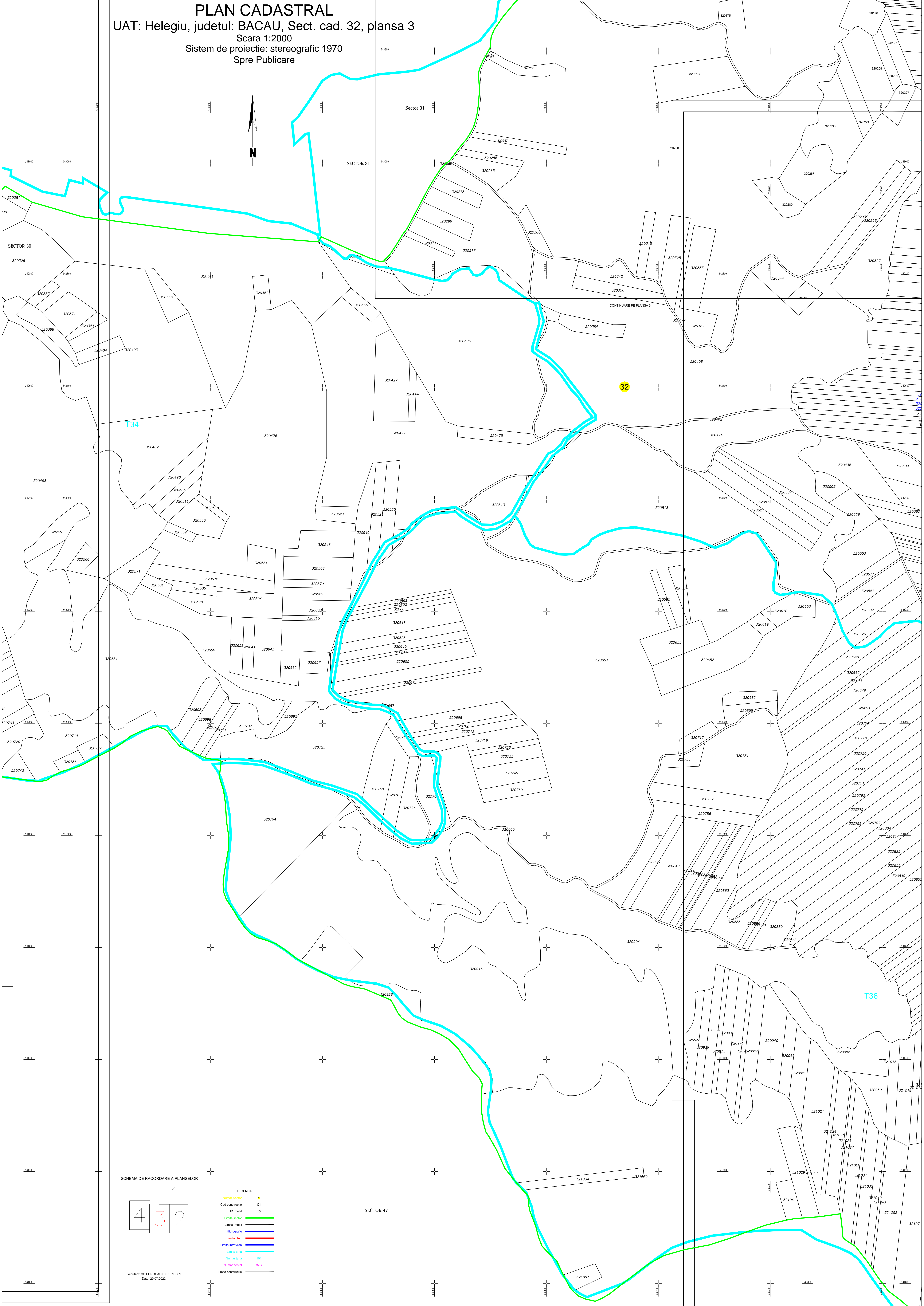

SCHEMA DE RACORDARE A PLANSELOR

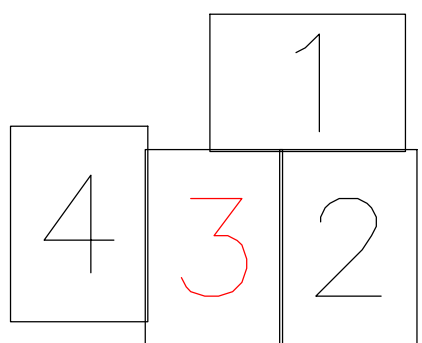

LEGENDA	
Numar plan	1
Cod constructie	C1
ID mobil	15
Limita sectoi	—
Limita mobil	—
Hidrografa	—
Limita UAT	—
Limita intravilan	—
Limita tarit	—
Numar tarit	101
Numar postei	378
Limita constructio	—

Executant: SC EUROCAD EXPERT SRL
 Data: 29.07.2022