

**DATE DESPRE IMOBILUL NR. 7052**

Oficiul de Cadastru și Publicitate Imobiliară ARGES  
Biroul de Cadastru și Publicitate Imobiliară Costesti

**A. Partea I. Descrierea imobilului**

TEREN Extravilan

Adresa: Jud. Arges

Nr. Crt	Nr cadastral Nr. topografic	Suprafața* (mp)	Observații / Referințe
A1		3.241	Sector cadastral:46 Teren neimprejmuit;

**B. Partea II. Proprietari și acte**

Inscrieri privitoare la dreptul de proprietate și alte drepturi reale	Referințe
/	
Act Normativ nr. 7, din 13/03/1996 emis de PARLAMENT (art. 13 alin. 15);	
B1	A1
Inscrierea provizorie, drept de PROPRIETATE, dobandit prin Lege, cota actuala 1/1, cota initiala 1/1 1) COMUNA HÂRSEȘTI, CIF:4122388	

**C. Partea III. SARCINI .**

Inscrieri privind dezmembramintele dreptului de proprietate, drepturi reale de garanție și sarcini	Referințe
NU SUNT	

## Anexa Nr. 1 La Partea I

## Teren

Nr cadastral	Suprafața (mp)*	Observații / Referințe
	3.241	

\* Suprafața este determinată în planul de proiecție Stereo 70.

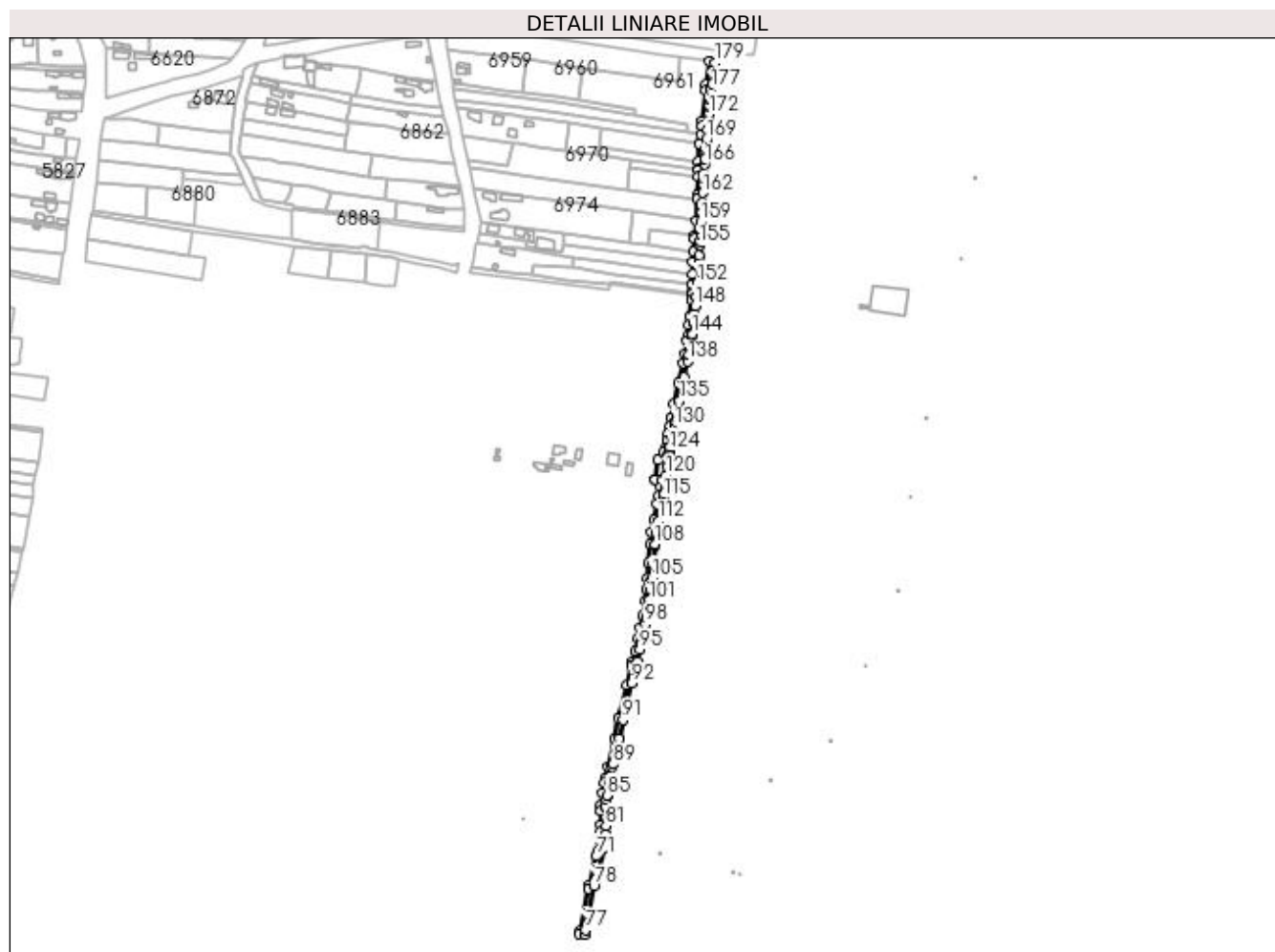

## Date referitoare la teren

Crt	Categorie folosință	Intra vilan	Suprafața (mp)	Tarla	Parcelă	Nr. topo	Observații / Referințe
1	drum	NU	3.241	7	De480/1	-	

## Lungime Segmente

1) Valorile lungimilor segmentelor sunt obținute din proiecție în plan.

Punct început	X / Y	Punct sfârșit	X / Y	Lungime segment	Punct început	X / Y	Punct sfârșit	X / Y	Lungime segment	Punct început	X / Y	Punct sfârșit	X / Y	Lungime segment
1	483.767,267 333.715,96	2	483.763,832 333.696,379	19.88	2	483.763,832 333.696,379	3	483.763,332 333.691,986	4.421	3	483.763,332 333.691,986	4	483.760,487 333.665,529	26.61
4	483.760,487 333.665,529	5	483.760,527 333.661,055	4.474	5	483.760,527 333.661,055	6	483.759,452 333.654,478	6.664	6	483.759,452 333.654,478	7	483.758,365 333.646,621	7.932
7	483.758,365 333.646,621	8	483.757,585 333.631,333	15.308	8	483.757,585 333.631,333	9	483.757,268 333.625,115	6.226	9	483.757,268 333.625,115	10	483.757,181 333.623,915	1.203
10	483.757,181 333.623,915	11	483.756,971 333.618,71	5.209	11	483.756,971 333.618,71	12	483.756,318 333.602,53	16.193	12	483.756,318 333.602,53	13	483.756,21 333.599,676	2.856
13	483.756,21 333.599,676	14	483.755,734 333.580,918	18.764	14	483.755,734 333.580,918	15	483.754,268 333.568,352	12.651	15	483.754,268 333.568,352	16	483.754,009 333.566,131	2.236
16	483.754,009 333.566,131	17	483.753,107 333.554,596	11.57	17	483.753,107 333.554,596	18	483.752,359 333.546,076	8.553	18	483.752,359 333.546,076	19	483.752,293 333.536,091	9.985

Punct început	X / Y	Punct sfârșit	X / Y	Lungime segment	Punct început	X / Y	Punct sfârșit	X / Y	Lungime segment	Punct început	X / Y	Punct sfârșit	X / Y	Lungime segment
19	483.752,293 333.536,091	20	483.752,102 333.527,173	8.92	20	483.752,102 333.527,173	21	483.751,958 333.520,223	6.951	21	483.751,958 333.520,223	22	483.751,912 333.518,082	2.141
22	483.751,912 333.518,082	23	483.751,515 333.513,756	4.344	23	483.751,515 333.513,756	24	483.750,365 333.499,899	13.905	24	483.750,365 333.499,899	25	483.749,779 333.493,2	6.725
25	483.749,779 333.493,2	26	483.748,707 333.483,879	9.382	26	483.748,707 333.483,879	27	483.747,956 333.479,642	4.303	27	483.747,956 333.479,642	28	483.745,948 333.468,23	11.587
28	483.745,948 333.468,23	29	483.744,304 333.460,807	7.603	29	483.744,304 333.460,807	30	483.740,678 333.443,655	17.531	30	483.740,678 333.443,655	31	483.736,962 333.426,003	18.039
31	483.736,962 333.426,003	32	483.734,508 333.414,47	11.791	32	483.734,508 333.414,47	33	483.733,209 333.407,352	7.236	33	483.733,209 333.407,352	34	483.731,958 333.400,52	6.946
34	483.731,958 333.400,52	35	483.731,054 333.395,58	5.022	35	483.731,054 333.395,58	36	483.729,186 333.388,162	7.65	36	483.729,186 333.388,162	37	483.727,644 333.385,293	3.257
37	483.727,644 333.385,293	38	483.723,182 333.378,585	8.056	38	483.723,182 333.378,585	39	483.720,588 333.361,825	16.96	39	483.720,588 333.361,825	40	483.720,581 333.361,727	0.098
40	483.720,581 333.361,727	41	483.726,565 333.361,047	6.023	41	483.726,565 333.361,047	42	483.725,782 333.355,681	5.423	42	483.725,782 333.355,681	43	483.724,293 333.348,853	6.988
43	483.724,293 333.348,853	44	483.722,687 333.341,49	7.536	44	483.722,687 333.341,49	45	483.720,282 333.327,737	13.962	45	483.720,282 333.327,737	46	483.717,871 333.317,154	10.854
46	483.717,871 333.317,154	47	483.716,859 333.307,341	9.865	47	483.716,859 333.307,341	48	483.715,585 333.291,676	15.717	48	483.715,585 333.291,676	49	483.714,492 333.278,232	13.488
49	483.714,492 333.278,232	50	483.713,669 333.269,262	9.008	50	483.713,669 333.269,262	51	483.712,921 333.259,577	9.714	51	483.712,921 333.259,577	52	483.710,592 333.246,832	12.956
52	483.710,592 333.246,832	53	483.708,41 333.236,271	10.784	53	483.708,41 333.236,271	54	483.706,558 333.228,093	8.385	54	483.706,558 333.228,093	55	483.704,021 333.216,812	11.563
55	483.704,021 333.216,812	56	483.701,696 333.207,805	9.302	56	483.701,696 333.207,805	57	483.700,872 333.204,792	3.124	57	483.700,872 333.204,792	58	483.696,791 333.188,33	16.96
58	483.696,791 333.188,33	59	483.690,087 333.159,875	29.234	59	483.690,087 333.159,875	60	483.686,644 333.143,133	17.092	60	483.686,644 333.143,133	61	483.680,868 333.119,23	24.591
61	483.680,868 333.119,23	62	483.678,96 333.109,409	10.005	62	483.678,96 333.109,409	63	483.678,15 333.105,626	3.869	63	483.678,15 333.105,626	64	483.676,481 333.096,55	9.228
64	483.676,481 333.096,55	65	483.674,616 333.086,407	10.313	65	483.674,616 333.086,407	66	483.674,561 333.081,645	4.762	66	483.674,561 333.081,645	67	483.674,791 333.069,858	11.789
67	483.674,791 333.069,858	68	483.674,391 333.064,504	5.369	68	483.674,391 333.064,504	69	483.673,876 333.056,652	7.869	69	483.673,876 333.056,652	70	483.672,047 333.047,764	9.074
70	483.672,047 333.047,764	71	483.671,088 333.043,101	4.761	71	483.671,088 333.043,101	72	483.664,869 333.018,532	25.344	72	483.664,869 333.018,532	73	483.664,336 333.015,939	2.647
73	483.664,336 333.015,939	74	483.656,92 332.979,865	36.828	74	483.656,92 332.979,865	75	483.656,22 332.977,655	2.318	75	483.656,22 332.977,655	76	483.661,056 332.977,02	4.878
76	483.661,056 332.977,02	77	483.661,821 332.980,954	4.008	77	483.661,821 332.980,954	78	483.668,958 333.017,662	37.395	78	483.668,958 333.017,662	79	483.677,591 333.050,923	34.363
79	483.677,591 333.050,923	80	483.678,692 333.061,698	10.831	80	483.678,692 333.061,698	81	483.679,155 333.069,167	7.483	81	483.679,155 333.069,167	82	483.678,657 333.085,158	15.999
82	483.678,657 333.085,158	83	483.678,637 333.085,803	0.645	83	483.678,637 333.085,803	84	483.679,417 333.091,105	5.359	84	483.679,417 333.091,105	85	483.679,955 333.094,66	3.595
85	483.679,955 333.094,66	86	483.681,562 333.105,27	10.731	86	483.681,562 333.105,27	87	483.682,134 333.108,63	3.408	87	483.682,134 333.108,63	88	483.684,6 333.118,668	10.336
88	483.684,6 333.118,668	89	483.685,214 333.121,162	2.568	89	483.685,214 333.121,162	90	483.690,425 333.142,444	21.911	90	483.690,425 333.142,444	91	483.693,604 333.158,56	16.427
91	483.693,604 333.158,56	92	483.701,225 333.189,567	31.93	92	483.701,225 333.189,567	93	483.705,28 333.206,49	17.402	93	483.705,28 333.206,49	94	483.705,687 333.208,19	1.748
94	483.705,687 333.208,19	95	483.708,075 333.218,31	10.398	95	483.708,075 333.218,31	96	483.710,002 333.226,2	8.122	96	483.710,002 333.226,2	97	483.710,277 333.227,452	1.282
97	483.710,277 333.227,452	98	483.712,703 333.239,527	12.316	98	483.712,703 333.239,527	99	483.714,063 333.246,282	6.891	99	483.714,063 333.246,282	100	483.716,099 333.257,942	11.836
100	483.716,099 333.257,942	101	483.716,195 333.258,916	0.979	101	483.716,195 333.258,916	102	483.716,323 333.260,205	1.295	102	483.716,323 333.260,205	103	483.717,148 333.268,816	8.65
103	483.717,148 333.268,816	104	483.718,013 333.277,297	8.525	104	483.718,013 333.277,297	105	483.718,119 333.278,82	1.527	105	483.718,119 333.278,82	106	483.718,949 333.290,754	11.963
106	483.718,949 333.290,754	107	483.720,656 333.306,694	16.031	107	483.720,656 333.306,694	108	483.720,738 333.307,458	0.768	108	483.720,738 333.307,458	109	483.721,681 333.315,612	8.208
109	483.721,681 333.315,612	110	483.721,874 333.317,287	1.686	110	483.721,874 333.317,287	111	483.723,618 333.325,518	8.414	111	483.723,618 333.325,518	112	483.723,913 333.327,009	1.52
112	483.723,913 333.327,009	113	483.726,119 333.339,119	12.309	113	483.726,119 333.339,119	114	483.726,541 333.341,434	2.353	114	483.726,541 333.341,434	115	483.727,637 333.346,732	5.41
115	483.727,637 333.346,732	116	483.728,276 333.349,822	3.155	116	483.728,276 333.349,822	117	483.729,266 333.354,969	5.241	117	483.729,266 333.354,969	118	483.729,862 333.358,068	3.156

Punct început	X / Y	Punct sfârșit	X / Y	Lungime segment	Punct început	X / Y	Punct sfârșit	X / Y	Lungime segment	Punct început	X / Y	Punct sfârșit	X / Y	Lungime segment
118	483.729,862 333.358,068	119	483.730,262 333.360,147	2.117	119	483.730,262 333.360,147	120	483.730,564 333.365,643	5.504	120	483.730,564 333.365,643	121	483.731,195 333.372,751	7.136
121	483.731,195 333.372,751	122	483.732,156 333.383,568	10.86	122	483.732,156 333.383,568	123	483.732,576 333.385,394	1.874	123	483.732,576 333.385,394	124	483.732,996 333.387,221	1.875
124	483.732,996 333.387,221	125	483.733,416 333.389,049	1.876	125	483.733,416 333.389,049	126	483.733,494 333.389,388	0.348	126	483.733,494 333.389,388	127	483.735,435 333.398,806	9.616
127	483.735,435 333.398,806	128	483.735,658 333.399,823	1.041	128	483.735,658 333.399,823	129	483.736,462 333.403,495	3.759	129	483.736,462 333.403,495	130	483.737,2 333.406,868	3.453
130	483.737,2 333.406,868	131	483.738,028 333.410,849	4.066	131	483.738,028 333.410,849	132	483.738,719 333.414,17	3.392	132	483.738,719 333.414,17	133	483.739,5 333.418,222	4.127
133	483.739,5 333.418,222	134	483.741,131 333.426,685	8.619	134	483.741,131 333.426,685	135	483.741,565 333.428,749	2.109	135	483.741,565 333.428,749	136	483.744,783 333.444,067	15.652
136	483.744,783 333.444,067	137	483.745,824 333.448,771	4.818	137	483.745,824 333.448,771	138	483.748,824 333.462,293	13.851	138	483.748,824 333.462,293	139	483.749,8 333.467,504	5.302
139	483.749,8 333.467,504	140	483.751,467 333.476,402	9.053	140	483.751,467 333.476,402	141	483.751,55 333.477,187	0.789	141	483.751,55 333.477,187	142	483.752,142 333.482,285	5.132
142	483.752,142 333.482,285	143	483.752,34 333.483,987	1.713	143	483.752,34 333.483,987	144	483.752,465 333.485,173	1.193	144	483.752,465 333.485,173	145	483.753,476 333.494,781	9.661
145	483.753,476 333.494,781	146	483.753,558 333.495,752	0.974	146	483.753,558 333.495,752	147	483.754,05 333.501,565	5.834	147	483.754,05 333.501,565	148	483.754,703 333.509,279	7.742
148	483.754,703 333.509,279	149	483.755,364 333.517,085	7.834	149	483.755,364 333.517,085	150	483.755,378 333.517,252	0.168	150	483.755,378 333.517,252	151	483.756,513 333.526,859	9.674
151	483.756,513 333.526,859	152	483.756,626 333.528,565	1.71	152	483.756,626 333.528,565	153	483.757,838 333.546,837	18.312	153	483.757,838 333.546,837	154	483.758,145 333.551,458	4.631
154	483.758,145 333.551,458	155	483.758,741 333.560,447	9.009	155	483.758,741 333.560,447	156	483.758,948 333.563,563	3.123	156	483.758,948 333.563,563	157	483.759,334 333.569,381	5.831
157	483.759,334 333.569,381	158	483.759,606 333.574,499	5.125	158	483.759,606 333.574,499	159	483.759,912 333.580,244	5.753	159	483.759,912 333.580,244	160	483.760,345 333.588,391	8.158
160	483.760,345 333.588,391	161	483.760,779 333.596,545	8.166	161	483.760,779 333.596,545	162	483.761,221 333.604,853	8.32	162	483.761,221 333.604,853	163	483.761,621 333.612,375	7.533
163	483.761,621 333.612,375	164	483.761,844 333.616,564	4.195	164	483.761,844 333.616,564	165	483.762,173 333.620,685	4.134	165	483.762,173 333.620,685	166	483.762,846 333.629,118	8.46
166	483.762,846 333.629,118	167	483.763,22 333.633,798	4.695	167	483.763,22 333.633,798	168	483.763,912 333.642,46	8.69	168	483.763,912 333.642,46	169	483.764,507 333.649,918	7.482
169	483.764,507 333.649,918	170	483.765,245 333.657,947	8.063	170	483.765,245 333.657,947	171	483.765,893 333.664,704	6.788	171	483.765,893 333.664,704	172	483.766,542 333.671,472	6.799
172	483.766,542 333.671,472	173	483.767,207 333.678,416	6.976	173	483.767,207 333.678,416	174	483.767,765 333.684,236	5.847	174	483.767,765 333.684,236	175	483.768,15 333.688,251	4.033
175	483.768,15 333.688,251	176	483.768,471 333.691,596	3.36	176	483.768,471 333.691,596	177	483.768,621 333.692,6	1.015	177	483.768,621 333.692,6	178	483.769,269 333.696,933	4.381
178	483.769,269 333.696,933	179	483.771,915 333.714,621	17.885	179	483.771,915 333.714,621	1	483.767,267 333.715,96	4.837					

\*\* Lungimile segmentelor sunt determinate în planul de proiecție Stereo 70 și sunt rotunjite la 1 milimetru.

\*\*\* Distanța dintre puncte este formată din segmente cumulate ce sunt mai mici decât valoarea 1 milimetru.