

**DATE DESPRE IMOBILUL NR. 5950**

Oficiul de Cadastru și Publicitate Imobiliară SIBIU
Biroul de Cadastru și Publicitate Imobiliară Saliste

A. Partea I. Descrierea imobilului

TEREN Extravilan

Adresa: Jud. Sibiu

Nr. Crt	Nr cadastral Nr. topografic	Suprafața* (mp)	Observații / Referințe
A1		373.698	Sector cadastral:29 Teren neimprejmuit; Diferenta de suprafata se afla la imobilele nr. cad. 741/1, 743, 745, 1139/1, 1141/1

B. Partea II. Proprietari și acte

Inscrieri privitoare la dreptul de proprietate și alte drepturi reale	Referințe
/	
Act Administrativ nr. 58, din 14/02/2002 emis de CJSDPAT Sibiu (titlu de proprietate);	
B1	A1
Intabulare, drept de PROPRIETATE, dobandit prin Lege, cota actuala 1/1 1) ORAȘUL SĂLIȘTE, CIF:4306950	

C. Partea III. SARCINI .

Inscrieri privind dezmembramintele dreptului de proprietate, drepturi reale de garanție și sarcini	Referințe
NU SUNT	

Anexa Nr. 1 La Partea I

Teren

Nr cadastral	Suprafața (mp)*	Observații / Referințe
	373.698	Diferenta de suprafata se afla la imobilele nr. cad. 741/1, 743, 745, 1139/1, 1141/1

* Suprafața este determinată în planul de proiecție Stereo 70.

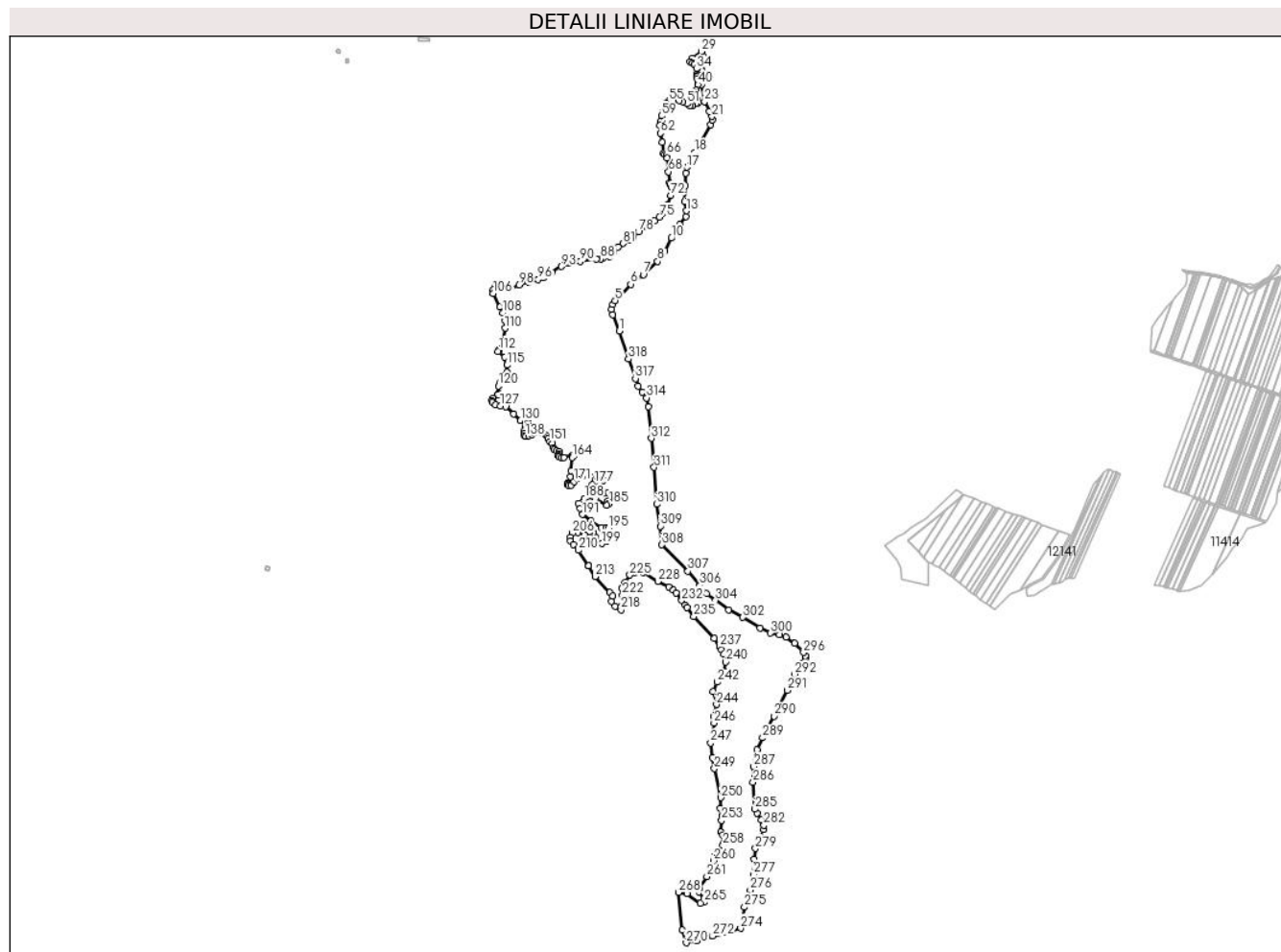

Date referitoare la teren

Crt	Categorie folosință	Intravilan	Suprafața (mp)	Tarla	Parcelă	Nr. topo	Observații / Referințe
1	padure	NU	373.698	25	685	-	

Lungime Segmente

1) Valorile lungimilor segmentelor sunt obținute din proiecție în plan.

Punct început	X / Y	Punct sfârșit	X / Y	Lungime segment	Punct început	X / Y	Punct sfârșit	X / Y	Lungime segment	Punct început	X / Y	Punct sfârșit	X / Y	Lungime segment
1	416.728,244 485.887,234	2	416.711,934 485.928,875	44.721	2	416.711,934 485.928,875	3	416.708,223 485.942,916	14.523	3	416.708,223 485.942,916	4	416.711,041 485.955,308	12.709
4	416.711,041 485.955,308	5	416.717,732 485.964,94	11.728	5	416.717,732 485.964,94	6	416.757,309 486.006,465	57.364	6	416.757,309 486.006,465	7	416.789,733 486.030,59	40.415
7	416.789,733 486.030,59	8	416.826,684 486.064,887	50.415	8	416.826,684 486.064,887	9	416.844,996 486.091,513	32.315	9	416.844,996 486.091,513	10	416.861,56 486.124,436	36.855
10	416.861,56 486.124,436	11	416.883,636 486.159,741	41.639	11	416.883,636 486.159,741	12	416.899,295 486.180,066	25.658	12	416.899,295 486.180,066	13	416.900,165 486.194,435	14.395
13	416.900,165 486.194,435	14	416.896,292 486.217,662	23.548	14	416.896,292 486.217,662	15	416.896,784 486.258,443	40.783	15	416.896,784 486.258,443	16	416.898,775 486.290,786	32.404
16	416.898,775 486.290,786	17	416.901,357 486.305,755	15.191	17	416.901,357 486.305,755	18	416.922,342 486.343,512	43.197	18	416.922,342 486.343,512	19	416.961,619 486.414,519	81.146

Punct început	X / Y	Punct sfârșit	X / Y	Lungime segment	Punct început	X / Y	Punct sfârșit	X / Y	Lungime segment	Punct început	X / Y	Punct sfârșit	X / Y	Lungime segment
19	416.961,619 486.414,519	20	416.966,959 486.426,975	13.55 2	20	416.966,959 486.426,975	21	416.965,941 486.435,92	9.003	21	416.965,941 486.435,92	22	416.959,222 486.449,353	15.01 9
22	416.959,222 486.449,353	23	416.946,572 486.473,615	27.36 3	23	416.946,572 486.473,615	24	416.938,415 486.517,101	44.24 4	24	416.938,415 486.517,101	25	416.936,628 486.533,178	16.17 6
25	416.936,628 486.533,178	26	416.940,414 486.551,599	18.80 6	26	416.940,414 486.551,599	27	416.945,156 486.571,031	20.00 2	27	416.945,156 486.571,031	28	416.944,242 486.589,525	18.51 7
28	416.944,242 486.589,525	29	416.939,011 486.602,176	13.69	29	416.939,011 486.602,176	30	416.915,968 486.585,091	28.68 6	30	416.915,968 486.585,091	31	416.909,446 486.576,006	11.18 4
31	416.909,446 486.576,006	32	416.915,288 486.572,999	6.57	32	416.915,288 486.572,999	33	416.920,585 486.568,891	6.703	33	416.920,585 486.568,891	34	416.925,944 486.557,781	12.33 5
34	416.925,944 486.557,781	35	416.928,595 486.544,117	13.91 9	35	416.928,595 486.544,117	36	416.928,732 486.539,554	4.565	36	416.928,732 486.539,554	37	416.926,997 486.536,313	3.676
37	416.926,997 486.536,313	38	416.927,499 486.532,434	3.911	38	416.927,499 486.532,434	39	416.929,328 486.525,94	6.747	39	416.929,328 486.525,94	40	416.929,921 486.517,132	8.828
40	416.929,921 486.517,132	41	416.924,845 486.503,453	14.59	41	416.924,845 486.503,453	42	416.923,703 486.496,653	6.895	42	416.923,703 486.496,653	43	416.924,887 486.490,06	6.698
43	416.924,887 486.490,06	44	416.928,403 486.479,152	11.46 1	44	416.928,403 486.479,152	45	416.930,032 486.470,957	8.355	45	416.930,032 486.470,957	46	416.924,461 486.468,174	6.227
46	416.924,461 486.468,174	47	416.915,875 486.472,235	9.498	47	416.915,875 486.472,235	48	416.914,14 486.471,277	1.982	48	416.914,14 486.471,277	49	416.915,266 486.462,422	8.926
49	416.915,266 486.462,422	50	416.909,192 486.463,243	6.129	50	416.909,192 486.463,243	51	416.901,657 486.468,172	9.004	51	416.901,657 486.468,172	52	416.891,229 486.473,844	11.87 1
52	416.891,229 486.473,844	53	416.881,045 486.476,308	10.47 8	53	416.881,045 486.476,308	54	416.866,773 486.476,812	14.28 1	54	416.866,773 486.476,812	55	416.854,671 486.474,849	12.26
55	416.854,671 486.474,849	56	416.846,953 486.468,369	10.07 8	56	416.846,953 486.468,369	57	416.841,028 486.455,84	13.85 9	57	416.841,028 486.455,84	58	416.840,077 486.452,28	3.685
58	416.840,077 486.452,28	59	416.836,118 486.437,453	15.34 6	59	416.836,118 486.437,453	60	416.833,034 486.421,682	16.07	60	416.833,034 486.421,682	61	416.831,974 486.412,98	8.766
61	416.831,974 486.412,98	62	416.834,335 486.393,208	19.91 2	62	416.834,335 486.393,208	63	416.838,189 486.369,639	23.88 2	63	416.838,189 486.369,639	64	416.842,22 486.342,455	27.48 1
64	416.842,22 486.342,455	65	416.845,014 486.338,829	4.577	65	416.845,014 486.338,829	66	416.849,323 486.337,135	4.63	66	416.849,323 486.337,135	67	416.851,273 486.328,887	8.475
67	416.851,273 486.328,887	68	416.854,616 486.294,356	34.69 2	68	416.854,616 486.294,356	69	416.857,709 486.265,898	28.62 6	69	416.857,709 486.265,898	70	416.858,914 486.260,662	5.373
70	416.858,914 486.260,662	71	416.861,868 486.255,358	6.071	71	416.861,868 486.255,358	72	416.860,406 486.233,539	21.86 8	72	416.860,406 486.233,539	73	416.852,225 486.209,727	25.17 8
73	416.852,225 486.209,727	74	416.840,08 486.188,354	24.58 3	74	416.840,08 486.188,354	75	416.831,085 486.177,713	13.93 3	75	416.831,085 486.177,713	76	416.818,63 486.168,84	15.29 2
76	416.818,63 486.168,84	77	416.797,424 486.154,24	25.74 6	77	416.797,424 486.154,24	78	416.777,372 486.140,18	24.49 1	78	416.777,372 486.140,18	79	416.764,462 486.126,353	18.91 7
79	416.764,462 486.126,353	80	416.753,353 486.118,325	13.70 6	80	416.753,353 486.118,325	81	416.737,998 486.110,627	17.17 7	81	416.737,998 486.110,627	82	416.725,521 486.102,469	14.90 7
82	416.725,521 486.102,469	83	416.715,098 486.090,214	16.08 8	83	416.715,098 486.090,214	84	416.710,923 486.085,404	6.369	84	416.710,923 486.085,404	85	416.709,114 486.083,32	2.76
85	416.709,114 486.083,32	86	416.704,007 486.077,437	7.79	86	416.704,007 486.077,437	87	416.685,869 486.071,966	18.94 5	87	416.685,869 486.071,966	88	416.680,664 486.071,407	5.235
88	416.680,664 486.071,407	89	416.669,798 486.070,309	10.92 1	89	416.669,798 486.070,309	90	416.628,632 486.064,681	41.54 9	90	416.628,632 486.064,681	91	416.597,972 486.060,716	30.91 5
91	416.597,972 486.060,716	92	416.589,736 486.059,65	8.305	92	416.589,736 486.059,65	93	416.579,71 486.051,93	12.65 4	93	416.579,71 486.051,93	94	416.555,556 486.036,635	28.58 9
94	416.555,556 486.036,635	95	416.533,224 486.022,447	26.45 8	95	416.533,224 486.022,447	96	416.520,39 486.018,974	13.29 6	96	416.520,39 486.018,974	97	416.497,107 486.012,674	24.12
97	416.497,107 486.012,674	98	416.471,145 486.004,144	27.32 7	98	416.471,145 486.004,144	99	416.445,45 485.995,701	27.04 7	99	416.445,45 485.995,701	100	416.433,137 486.002,28	13.96
100	416.433,137 486.002,28	101	416.426,328 486.004,755	7.245	101	416.426,328 486.004,755	102	416.418,266 486.007,483	8.511	102	416.418,266 486.007,483	103	416.411,175 486.008,492	7.162
103	416.411,175 486.008,492	104	416.409,165 485.999,161	9.545	104	416.409,165 485.999,161	105	416.405,44 485.992,562	7.578	105	416.405,44 485.992,562	106	416.405,378 485.982,955	9.607
106	416.405,378 485.982,955	107	416.422,627 485.947,99	38.98 8	107	416.422,627 485.947,99	108	416.429,44 485.932,69	16.74 8	108	416.429,44 485.932,69	109	416.435,719 485.912,554	21.09 2
109	416.435,719 485.912,554	110	416.436,354 485.893,92	18.64 5	110	416.436,354 485.893,92	111	416.431,059 485.863,507	30.87	111	416.431,059 485.863,507	112	416.419,383 485.837,825	28.21 2
112	416.419,383 485.837,825	113	416.417,142 485.833,892	4.527	113	416.417,142 485.833,892	114	416.434,351 485.819,529	22.41 5	114	416.434,351 485.819,529	115	416.440,512 485.799,603	20.85 6
115	416.440,512 485.799,603	116	416.440,853 485.781,164	18.44 2	116	416.440,853 485.781,164	117	416.431,783 485.773,125	12.12	117	416.431,783 485.773,125	118	416.428,788 485.762,863	10.69

Punct început	X / Y	Punct sfârșit	X / Y	Lungime segment	Punct început	X / Y	Punct sfârșit	X / Y	Lungime segment	Punct început	X / Y	Punct sfârșit	X / Y	Lungime segment
118	416.428,788 485.762,863	119	416.422,028 485.753,798	11.308	119	416.422,028 485.753,798	120	416.418,349 485.746,272	8.377	120	416.418,349 485.746,272	121	416.419,397 485.727,861	18.441
121	416.419,397 485.727,861	122	416.417,095 485.723,685	4.768	122	416.417,095 485.723,685	123	416.404,901 485.714,566	15.226	123	416.404,901 485.714,566	124	416.401,917 485.708,43	6.823
124	416.401,917 485.708,43	125	416.403,196 485.703,828	4.776	125	416.403,196 485.703,828	126	416.411,552 485.698,63	9.842	126	416.411,552 485.698,63	127	416.423,746 485.695,647	12.553
127	416.423,746 485.695,647	128	416.437,048 485.692,579	13.651	128	416.437,048 485.692,579	129	416.458,366 485.675,502	27.314	129	416.458,366 485.675,502	130	416.475,276 485.657,073	25.011
130	416.475,276 485.657,073	131	416.487,597 485.653,506	12.827	131	416.487,597 485.653,506	132	416.494,99 485.652,826	7.424	132	416.494,99 485.652,826	133	416.495,33 485.648,41	4.429
133	416.495,33 485.648,41	134	416.489,297 485.640,172	10.211	134	416.489,297 485.640,172	135	416.485,133 485.633,633	7.752	135	416.485,133 485.633,633	136	416.485,898 485.625,31	8.358
136	416.485,898 485.625,31	137	416.485,558 485.619,45	5.87	137	416.485,558 485.619,45	138	416.488,107 485.617,837	3.017	138	416.488,107 485.617,837	139	416.495,84 485.619,705	7.955
139	416.495,84 485.619,705	140	416.503,912 485.622,593	8.573	140	416.503,912 485.622,593	141	416.511,05 485.626,499	8.137	141	416.511,05 485.626,499	142	416.517,168 485.631,765	8.072
142	416.517,168 485.631,765	143	416.517,678 485.632,529	0.919	143	416.517,678 485.632,529	144	416.520,142 485.637,88	5.891	144	416.520,142 485.637,88	145	416.522,692 485.639,493	3.017
145	416.522,692 485.639,493	146	416.530,877 485.626,04	15.748	146	416.530,877 485.626,04	147	416.535,949 485.624,688	5.249	147	416.535,949 485.624,688	148	416.542,036 485.621,562	6.842
148	416.542,036 485.621,562	149	416.544,233 485.617,676	4.465	149	416.544,233 485.617,676	150	416.545,332 485.610,579	7.181	150	416.545,332 485.610,579	151	416.550,151 485.604,242	7.96
151	416.550,151 485.604,242	152	416.556,744 485.598,751	8.581	152	416.556,744 485.598,751	153	416.560,433 485.588,718	10.69	153	416.560,433 485.588,718	154	416.562,04 485.583,311	5.641
154	416.562,04 485.583,311	155	416.568,042 485.579,594	7.06	155	416.568,042 485.579,594	156	416.573,282 485.578,242	5.412	156	416.573,282 485.578,242	157	416.574,128 485.572,666	5.64
157	416.574,128 485.572,666	158	416.572,691 485.568,104	4.783	158	416.572,691 485.568,104	159	416.573,621 485.565,147	3.1	159	416.573,621 485.565,147	160	416.579,369 485.563,542	5.968
160	416.579,369 485.563,542	161	416.586,639 485.562,697	7.319	161	416.586,639 485.562,697	162	416.609,208 485.570,274	23.808	162	416.609,208 485.570,274	163	416.610,477 485.568,019	2.587
163	416.610,477 485.568,019	164	416.607,772 485.563,119	5.597	164	416.607,772 485.563,119	165	416.604,315 485.529,911	33.387	165	416.604,315 485.529,911	166	416.602,788 485.513,704	16.279
166	416.602,788 485.513,704	167	416.595,839 485.496,392	18.655	167	416.595,839 485.496,392	168	416.595,839 485.493,761	2.631	168	416.595,839 485.493,761	169	416.597,997 485.491,92	2.838
169	416.597,997 485.491,92	170	416.604,157 485.492,025	6.161	170	416.604,157 485.492,025	171	416.612,063 485.501,504	12.343	171	416.612,063 485.501,504	172	416.621,902 485.509,71	12.811
172	416.621,902 485.509,71	173	416.634,477 485.514,885	13.598	173	416.634,477 485.514,885	174	416.654,816 485.515,453	20.347	174	416.654,816 485.515,453	175	416.684,689 485.506,903	31.073
175	416.684,689 485.506,903	176	416.686,269 485.504,482	2.89	176	416.686,269 485.504,482	177	416.663,576 485.497,747	23.671	177	416.663,576 485.497,747	178	416.659,259 485.493,958	5.744
178	416.659,259 485.493,958	179	416.660,454 485.486,333	7.718	179	416.660,454 485.486,333	180	416.682,578 485.469,716	27.669	180	416.682,578 485.469,716	181	416.688,21 485.472,263	6.18
181	416.688,21 485.472,263	182	416.700,813 485.473,067	12.629	182	416.700,813 485.473,067	183	416.707,115 485.458,996	15.418	183	416.707,115 485.458,996	184	416.699,338 485.452,43	10.178
184	416.699,338 485.452,43	185	416.701,414 485.444,338	8.353	185	416.701,414 485.444,338	186	416.696,488 485.441,77	5.555	186	416.696,488 485.441,77	187	416.667,342 485.458,117	33.418
187	416.667,342 485.458,117	188	416.639,522 485.458,679	27.826	188	416.639,522 485.458,679	189	416.622,562 485.445,477	21.493	189	416.622,562 485.445,477	190	416.628,6 485.432,566	14.253
190	416.628,6 485.432,566	191	416.633,954 485.417,37	16.112	191	416.633,954 485.417,37	192	416.655,55 485.401,219	26.968	192	416.655,55 485.401,219	193	416.682,485 485.384,349	31.782
193	416.682,485 485.384,349	194	416.695,009 485.384,276	12.524	194	416.695,009 485.384,276	195	416.700,792 485.382,564	6.031	195	416.700,792 485.382,564	196	416.699,507 485.371,862	10.779
196	416.699,507 485.371,862	197	416.699,078 485.359,447	12.422	197	416.699,078 485.359,447	198	416.696,316 485.349,141	10.67	198	416.696,316 485.349,141	199	416.684,266 485.343,031	13.511
199	416.684,266 485.343,031	200	416.663,1 485.348,531	21.869	200	416.663,1 485.348,531	201	416.666,063 485.359,906	11.754	201	416.666,063 485.359,906	202	416.662,029 485.370,792	11.609
202	416.662,029 485.370,792	203	416.651,749 485.372,29	10.388	203	416.651,749 485.372,29	204	416.638,685 485.365,869	14.557	204	416.638,685 485.365,869	205	416.621,552 485.371,22	17.949
205	416.621,552 485.371,22	206	416.608,06 485.369,721	13.575	206	416.608,06 485.369,721	207	416.602,492 485.359,447	11.686	207	416.602,492 485.359,447	208	416.602,92 485.349,816	9.641
208	416.602,92 485.349,816	209	416.610,479 485.341,191	11.468	209	416.610,479 485.341,191	210	416.623,969 485.325,799	20.467	210	416.623,969 485.325,799	211	416.648,496 485.288,217	44.878
211	416.648,496 485.288,217	212	416.649,314 485.286,84	1.602	212	416.649,314 485.286,84	213	416.666,296 485.258,219	33.28	213	416.666,296 485.258,219	214	416.704,538 485.218,868	54.872
214	416.704,538 485.218,868	215	416.711,643 485.209,346	11.88	215	416.711,643 485.209,346	216	416.707,7 485.195,26	14.627	216	416.707,7 485.195,26	217	416.717,736 485.182,198	16.472

Punct început	X / Y	Punct sfârșit	X / Y	Lungime segment	Punct început	X / Y	Punct sfârșit	X / Y	Lungime segment	Punct început	X / Y	Punct sfârșit	X / Y	Lungime segment
217	416.717,736 485.182,198	218	416.732,685 485.173,362	17.365	218	416.732,685 485.173,362	219	416.734,334 485.183,479	10.25	219	416.734,334 485.183,479	220	416.747,711 485.189,49	14.665
220	416.747,711 485.189,49	221	416.747,057 485.201,156	11.684	221	416.747,057 485.201,156	222	416.736,602 485.210,3	13.889	222	416.736,602 485.210,3	223	416.734,977 485.229,054	18.824
223	416.734,977 485.229,054	224	416.742,534 485.243,278	16.107	224	416.742,534 485.243,278	225	416.755,385 485.262,761	23.34	225	416.755,385 485.262,761	226	416.769,098 485.268,772	14.973
226	416.769,098 485.268,772	227	416.789,587 485.269,085	20.491	227	416.789,587 485.269,085	228	416.826,863 485.245,962	43.865	228	416.826,863 485.245,962	229	416.855,092 485.232,255	31.381
229	416.855,092 485.232,255	230	416.867,008 485.223,656	14.695	230	416.867,008 485.223,656	231	416.873,467 485.216,419	9.7	231	416.873,467 485.216,419	232	416.888,616 485.197,486	24.248
232	416.888,616 485.197,486	233	416.897,507 485.185,606	14.838	233	416.897,507 485.185,606	234	416.902,284 485.179,224	7.972	234	416.902,284 485.179,224	235	416.919,242 485.156,885	28.046
235	416.919,242 485.156,885	236	416.971,797 485.101,326	76.477	236	416.971,797 485.101,326	237	416.986,098 485.078,304	27.103	237	416.986,098 485.078,304	238	416.990,16 485.070,634	8.679
238	416.990,16 485.070,634	239	416.995,655 485.060,258	11.741	239	416.995,655 485.060,258	240	417.000,122 485.040,146	20.602	240	417.000,122 485.040,146	241	416.998,208 485.015,064	25.155
241	416.998,208 485.015,064	242	416.978,944 484.988,405	32.891	242	416.978,944 484.988,405	243	416.968,217 484.964,404	26.289	243	416.968,217 484.964,404	244	416.977,143 484.931,234	34.35
244	416.977,143 484.931,234	245	416.970,616 484.901,006	30.924	245	416.970,616 484.901,006	246	416.971,153 484.883,773	17.242	246	416.971,153 484.883,773	247	416.962,282 484.832,913	51.628
247	416.962,282 484.832,913	248	416.966,955 484.795,867	37.34	248	416.966,955 484.795,867	249	416.972,175 484.767,485	28.858	249	416.972,175 484.767,485	250	416.987,985 484.692,876	76.266
250	416.987,985 484.692,876	251	416.987,027 484.665,408	27.484	251	416.987,027 484.665,408	252	416.991,756 484.646,611	19.383	252	416.991,756 484.646,611	253	416.990,65 484.634,636	12.026
253	416.990,65 484.634,636	254	416.987,96 484.604,629	30.127	254	416.987,96 484.604,629	255	416.993,475 484.597,835	8.751	255	416.993,475 484.597,835	256	416.999,546 484.590,795	9.296
256	416.999,546 484.590,795	257	416.996,832 484.576,673	14.381	257	416.996,832 484.576,673	258	416.993,572 484.570,583	6.908	258	416.993,572 484.570,583	259	416.974,915 484.552,794	25.779
259	416.974,915 484.552,794	260	416.969,514 484.531,582	21.888	260	416.969,514 484.531,582	261	416.952,674 484.490,81	44.113	261	416.952,674 484.490,81	262	416.932,886 484.461,199	35.614
262	416.932,886 484.461,199	263	416.932,764 484.451,34	9.86	263	416.932,764 484.451,34	264	416.945,432 484.434,994	20.68	264	416.945,432 484.434,994	265	416.944,582 484.425,429	9.603
265	416.944,582 484.425,429	266	416.936,436 484.423,108	8.47	266	416.936,436 484.423,108	267	416.901,752 484.447,748	42.546	267	416.901,752 484.447,748	268	416.880,645 484.450,337	21.265
268	416.880,645 484.450,337	269	416.889,507 484.353,974	96.769	269	416.889,507 484.353,974	270	416.899,61 484.321,745	33.776	270	416.899,61 484.321,745	271	416.927,283 484.327,118	28.19
271	416.927,283 484.327,118	272	416.967,383 484.338,795	41.766	272	416.967,383 484.338,795	273	417.007,445 484.349,005	41.343	273	417.007,445 484.349,005	274	417.039,009 484.358,689	33.016
274	417.039,009 484.358,689	275	417.048,69 484.412,725	54.897	275	417.048,69 484.412,725	276	417.063,872 484.456,474	46.309	276	417.063,872 484.456,474	277	417.071,585 484.496,116	40.385
277	417.071,585 484.496,116	278	417.073,186 484.536,036	39.952	278	417.073,186 484.536,036	279	417.077,369 484.562,882	27.17	279	417.077,369 484.562,882	280	417.085,863 484.585,99	24.619
280	417.085,863 484.585,99	281	417.098,685 484.610,895	28.012	281	417.098,685 484.610,895	282	417.098,845 484.622,252	11.358	282	417.098,845 484.622,252	283	417.092,778 484.636,401	15.395
283	417.092,778 484.636,401	284	417.081,179 484.653,069	20.307	284	417.081,179 484.653,069	285	417.075,882 484.663,774	11.944	285	417.075,882 484.663,774	286	417.071,192 484.732,216	68.602
286	417.071,192 484.732,216	287	417.072,667 484.772,806	40.618	287	417.072,667 484.772,806	288	417.080,84 484.815,168	43.143	288	417.080,84 484.815,168	289	417.095,15 484.846,061	34.046
289	417.095,15 484.846,061	290	417.125,154 484.901,215	62.787	290	417.125,154 484.901,215	291	417.158,857 484.967,38	74.254	291	417.158,857 484.967,38	292	417.176,496 485.008,242	44.506
292	417.176,496 485.008,242	293	417.197,076 485.036,426	34.898	293	417.197,076 485.036,426	294	417.204,88 485.048,968	14.771	294	417.204,88 485.048,968	295	417.205,251 485.056,21	7.252
295	417.205,251 485.056,21	296	417.200,288 485.064,48	9.645	296	417.200,288 485.064,48	297	417.177,498 485.087,496	32.389	297	417.177,498 485.087,496	298	417.155,131 485.104,206	27.92
298	417.155,131 485.104,206	299	417.138,746 485.109,973	17.37	299	417.138,746 485.109,973	300	417.115,74 485.114,132	23.379	300	417.115,74 485.114,132	301	417.088,294 485.126,353	30.045
301	417.088,294 485.126,353	302	417.044,893 485.154,137	51.532	302	417.044,893 485.154,137	303	417.008,852 485.173,853	41.081	303	417.008,852 485.173,853	304	416.974,968 485.197,478	41.307
304	416.974,968 485.197,478	305	416.951,922 485.214,322	28.545	305	416.951,922 485.214,322	306	416.934,835 485.235,115	26.913	306	416.934,835 485.235,115	307	416.904,082 485.272,391	48.325
307	416.904,082 485.272,391	308	416.837,322 485.340,108	95.092	308	416.837,322 485.340,108	309	416.833,558 485.387,516	47.558	309	416.833,558 485.387,516	310	416.824,807 485.443,399	56.564
310	416.824,807 485.443,399	311	416.817,491 485.538,198	95.081	311	416.817,491 485.538,198	312	416.810,201 485.612,522	74.681	312	416.810,201 485.612,522	313	416.803,173 485.693,432	81.215
313	416.803,173 485.693,432	314	416.798,27 485.715,684	22.786	314	416.798,27 485.715,684	315	416.787,827 485.730,762	18.341	315	416.787,827 485.730,762	316	416.776,821 485.745,265	18.207

Punct început	X / Y	Punct sfârșit	X / Y	Lungime segment	Punct început	X / Y	Punct sfârșit	X / Y	Lungime segment	Punct început	X / Y	Punct sfârșit	X / Y	Lungime segment
316	416.776,821 485.745,265	317	416.769,56 485.765,285	21.297	317	416.769,56 485.765,285	318	416.752,04 485.815,145	52.848	318	416.752,04 485.815,145	1416.728,244 485.887,234	75.916	

** Lungimile segmentelor sunt determinate în planul de proiecție Stereo 70 și sunt rotunjite la 1 milimetru.

*** Distanța dintre puncte este formată din segmente cumulate ce sunt mai mici decât valoarea 1 milimetru.

**DATE DESPRE IMOBILUL NR. 5951**

Oficiul de Cadastru și Publicitate Imobiliară SIBIU
Biroul de Cadastru și Publicitate Imobiliară Saliste

A. Partea I. Descrierea imobilului

TEREN Extravilan

Adresa: Jud. Sibiu

Nr. Crt	Nr cadastral Nr. topografic	Suprafața* (mp)	Observații / Referințe
A1		10.300	Sector cadastral:29 Teren neimprejmuit;

B. Partea II. Proprietari și acte

Inscrieri privitoare la dreptul de proprietate și alte drepturi reale		Referințe
/		
Act Normativ nr. 7, din 13/03/1996 emis de Parlamentul Romaniei (ar. 13 alin. 15);		
B1	Inscrierea provizorie, drept de PROPRIETATE, dobandit prin Lege, cota actuala 1/1 1) ORAȘUL SĂLIȘTE, CIF:4306950, Proprietar neidentificat	A1

C. Partea III. SARCINI .

Inscrieri privind dezmembramintele dreptului de proprietate, drepturi reale de garanție și sarcini	Referințe
NU SUNT	

Anexa Nr. 1 La Partea I

Teren

Nr cadastral	Suprafața (mp)*	Observații / Referințe
	10.300	

* Suprafața este determinată în planul de proiecție Stereo 70.

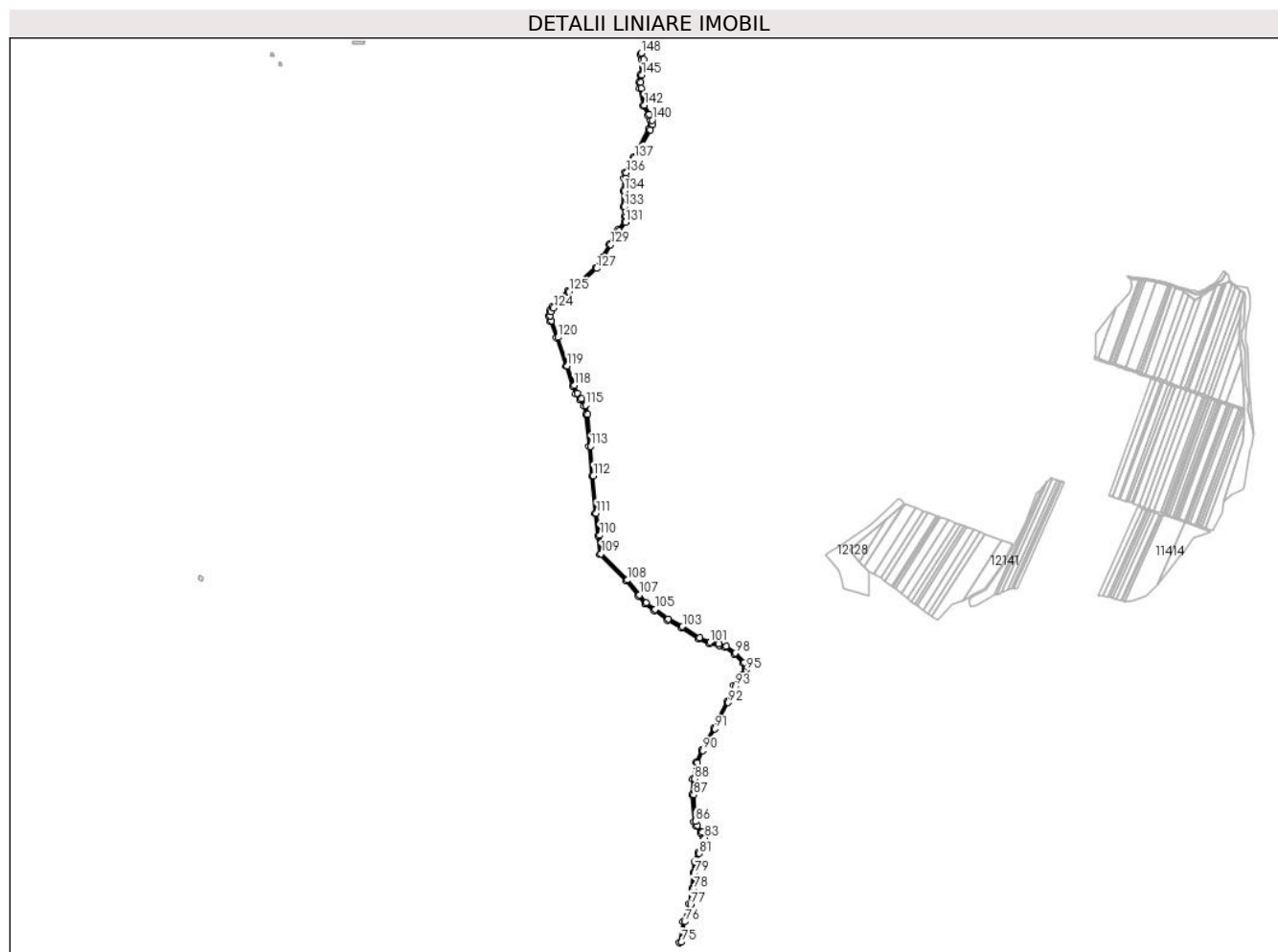

Date referitoare la teren

Crt	Categorie folosință	Intra vilan	Suprafața (mp)	Tarla	Parcelă	Nr. topo	Observații / Referințe
1	drum	NU	10.300	25	686	-	

Lungime Segmente

1) Valorile lungimilor segmentelor sunt obținute din proiecție în plan.

Punct început	X / Y	Punct sfârșit	X / Y	Lungime segment	Punct început	X / Y	Punct sfârșit	X / Y	Lungime segment	Punct început	X / Y	Punct sfârșit	X / Y	Lungime segment
1	416.939,011 486.602,176	2	416.944,242 486.589,525	13.69	2	416.944,242 486.589,525	3	416.945,156 486.571,031	18.517	3	416.945,156 486.571,031	4	416.940,414 486.551,599	20.002
4	416.940,414 486.551,599	5	416.936,628 486.533,178	18.806	5	416.936,628 486.533,178	6	416.938,415 486.517,101	16.176	6	416.938,415 486.517,101	7	416.946,572 486.473,615	44.244
7	416.946,572 486.473,615	8	416.959,222 486.449,353	27.363	8	416.959,222 486.449,353	9	416.965,941 486.435,92	15.019	9	416.965,941 486.435,92	10	416.966,959 486.426,975	9.003
10	416.966,959 486.426,975	11	416.961,619 486.414,519	13.552	11	416.961,619 486.414,519	12	416.922,342 486.343,512	81.146	12	416.922,342 486.343,512	13	416.901,357 486.305,755	43.197
13	416.901,357 486.305,755	14	416.898,775 486.290,786	15.191	14	416.898,775 486.290,786	15	416.896,784 486.258,443	32.404	15	416.896,784 486.258,443	16	416.896,292 486.217,662	40.783
16	416.896,292 486.217,662	17	416.900,165 486.194,435	23.548	17	416.900,165 486.194,435	18	416.899,295 486.180,066	14.395	18	416.899,295 486.180,066	19	416.883,636 486.159,741	25.658

Punct început	X / Y	Punct sfârșit	X / Y	Lungime segment	Punct început	X / Y	Punct sfârșit	X / Y	Lungime segment	Punct început	X / Y	Punct sfârșit	X / Y	Lungime segment
118	416.773,299 485.766,62	119	416.755,799 485.816,425	52.79	119	416.755,799 485.816,425	120	416.731,98 485.888,582	75.98 6	120	416.731,98 485.888,582	121	416.715,714 485.930,11	44.6
121	416.715,714 485.930,11	122	416.712,311 485.942,987	13.31 9	122	416.712,311 485.942,987	123	416.714,742 485.953,676	10.96 3	123	416.714,742 485.953,676	124	416.720,818 485.962,423	10.65
124	416.720,818 485.962,423	125	416.759,95 486.003,481	56.71 9	125	416.759,95 486.003,481	126	416.792,276 486.027,534	40.29 2	126	416.792,276 486.027,534	127	416.829,706 486.062,276	51.06 9
127	416.829,706 486.062,276	128	416.848,421 486.089,486	33.02 5	128	416.848,421 486.089,486	129	416.865,024 486.122,487	36.94 2	129	416.865,024 486.122,487	130	416.886,899 486.157,472	41.26 1
130	416.886,899 486.157,472	131	416.903,184 486.178,609	26.68 3	131	416.903,184 486.178,609	132	416.904,155 486.194,644	16.06 4	132	416.904,155 486.194,644	133	416.900,266 486.217,967	23.64 5
133	416.900,266 486.217,967	134	416.900,753 486.258,297	40.33 3	134	416.900,753 486.258,297	135	416.902,724 486.290,325	32.08 9	135	416.902,724 486.290,325	136	416.905,154 486.304,416	14.29 9
136	416.905,154 486.304,416	137	416.925,814 486.341,587	42.52 7	137	416.925,814 486.341,587	138	416.965,189 486.412,772	81.34 9	138	416.965,189 486.412,772	139	416.971,022 486.426,378	14.80 3
139	416.971,022 486.426,378	140	416.969,806 486.437,067	10.75 9	140	416.969,806 486.437,067	141	416.962,758 486.451,159	15.75 6	141	416.962,758 486.451,159	142	416.950,365 486.474,928	26.80 6
142	416.950,365 486.474,928	143	416.942,344 486.517,687	43.50 5	143	416.942,344 486.517,687	144	416.940,643 486.532,993	15.4	144	416.940,643 486.532,993	145	416.944,289 486.550,728	18.10 6
145	416.944,289 486.550,728	146	416.949,149 486.570,65	20.50 7	146	416.949,149 486.570,65	147	416.948,178 486.590,329	19.70 3	147	416.948,178 486.590,329	148	416.942,344 486.606,12	16.83 4
148	416.942,344 486.606,12	1	416.939,011 486.602,176	5.164										

** Lungimile segmentelor sunt determinate în planul de proiecție Stereo 70 și sunt rotunjite la 1 milimetru.

*** Distanța dintre puncte este formată din segmente cumulate ce sunt mai mici decât valoarea 1 milimetru.

**DATE DESPRE IMOBILUL NR. 5952**

Oficiul de Cadastru și Publicitate Imobiliară SIBIU
Biroul de Cadastru și Publicitate Imobiliară Saliste

A. Partea I. Descrierea imobilului

TEREN Extravilan

Adresa: Jud. Sibiu

Nr. Crt	Nr cadastral Nr. topografic	Suprafața* (mp)	Observații / Referințe
A1		2.600	Sector cadastral:29 Teren neimprejmuit;

B. Partea II. Proprietari și acte

Inscrieri privitoare la dreptul de proprietate și alte drepturi reale		Referințe
/		
Act Normativ nr. 7, din 13/03/1996 emis de Parlamentul Romaniei (ar. 13 alin. 15);		
B1	Inscrierea provizorie, drept de PROPRIETATE, dobandit prin Lege, cota actuala 1/1 1) ORAȘUL SĂLIȘTE, CIF:4306950, Proprietar neidentificat	A1

C. Partea III. SARCINI .

Inscrieri privind dezmembramintele dreptului de proprietate, drepturi reale de garanție și sarcini	Referințe
NU SUNT	

Anexa Nr. 1 La Partea I

Teren

Nr cadastral	Suprafața (mp)*	Observații / Referințe
	2.600	

* Suprafața este determinată în planul de proiecție Stereo 70.

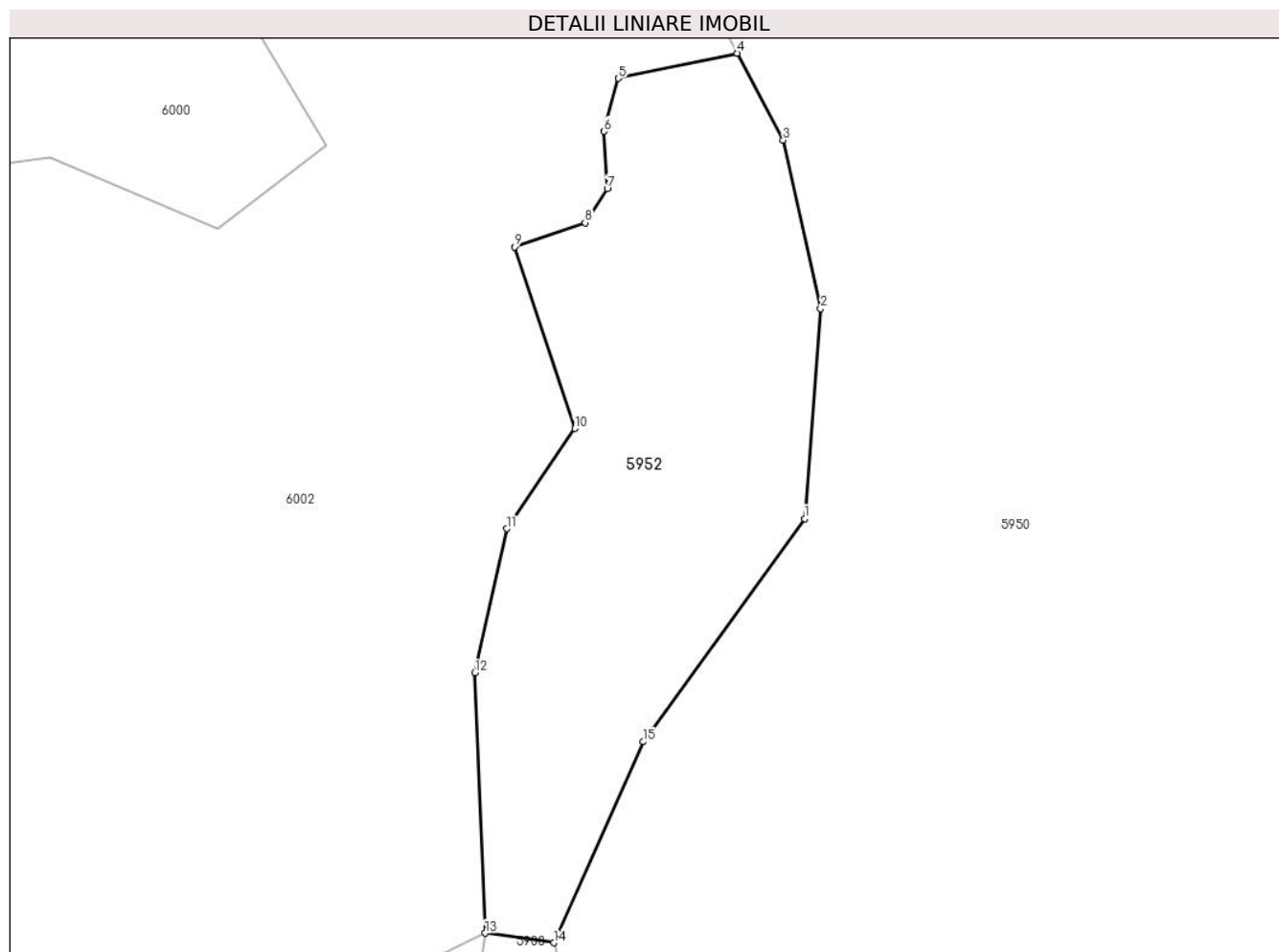

Date referitoare la teren

Crt	Categorie folosință	Intra vilan	Suprafața (mp)	Tarla	Parcelă	Nr. topo	Observații / Referințe
1	faneata	NU	2.600	25	687	-	

Lungime Segmente

1) Valorile lungimilor segmentelor sunt obținute din proiecție în plan.

Punct început	X / Y	Punct sfârșit	X / Y	Lungime segment (** (m)
1	416.998,208 485.015,064	2	417.000,122 485.040,146	25.155
2	417.000,122 485.040,146	3	416.995,655 485.060,258	20.602
3	416.995,655 485.060,258	4	416.990,16 485.070,634	11.741
4	416.990,16 485.070,634	5	416.975,948 485.067,631	14.525
5	416.975,948 485.067,631	6	416.974,245 485.061,302	6.554

Punct început	X / Y	Punct sfârșit	X / Y	Lungime segment (** (m)
6	416.974,245 485.061,302	7	416.974,628 485.054,44	6.872
7	416.974,628 485.054,44	8	416.971,983 485.050,389	4.838
8	416.971,983 485.050,389	9	416.963,571 485.047,505	8.892
9	416.963,571 485.047,505	10	416.970,745 485.025,814	22.847
10	416.970,745 485.025,814	11	416.962,612 485.013,86	14.458
11	416.962,612 485.013,86	12	416.958,784 484.996,646	17.634
12	416.958,784 484.996,646	13	416.960,028 484.965,543	31.128
13	416.960,028 484.965,543	14	416.968,217 484.964,404	8.267
14	416.968,217 484.964,404	15	416.978,944 484.988,405	26.289
15	416.978,944 484.988,405	1	416.998,208 485.015,064	32.891

** Lungimile segmentelor sunt determinate în planul de proiecție Stereo 70 și sunt rotunjite la 1 milimetru.

*** Distanța dintre puncte este formată din segmente cumulate ce sunt mai mici decât valoarea 1 milimetru.

