

SCHEMĂ
DISPUNERE PLANȘE

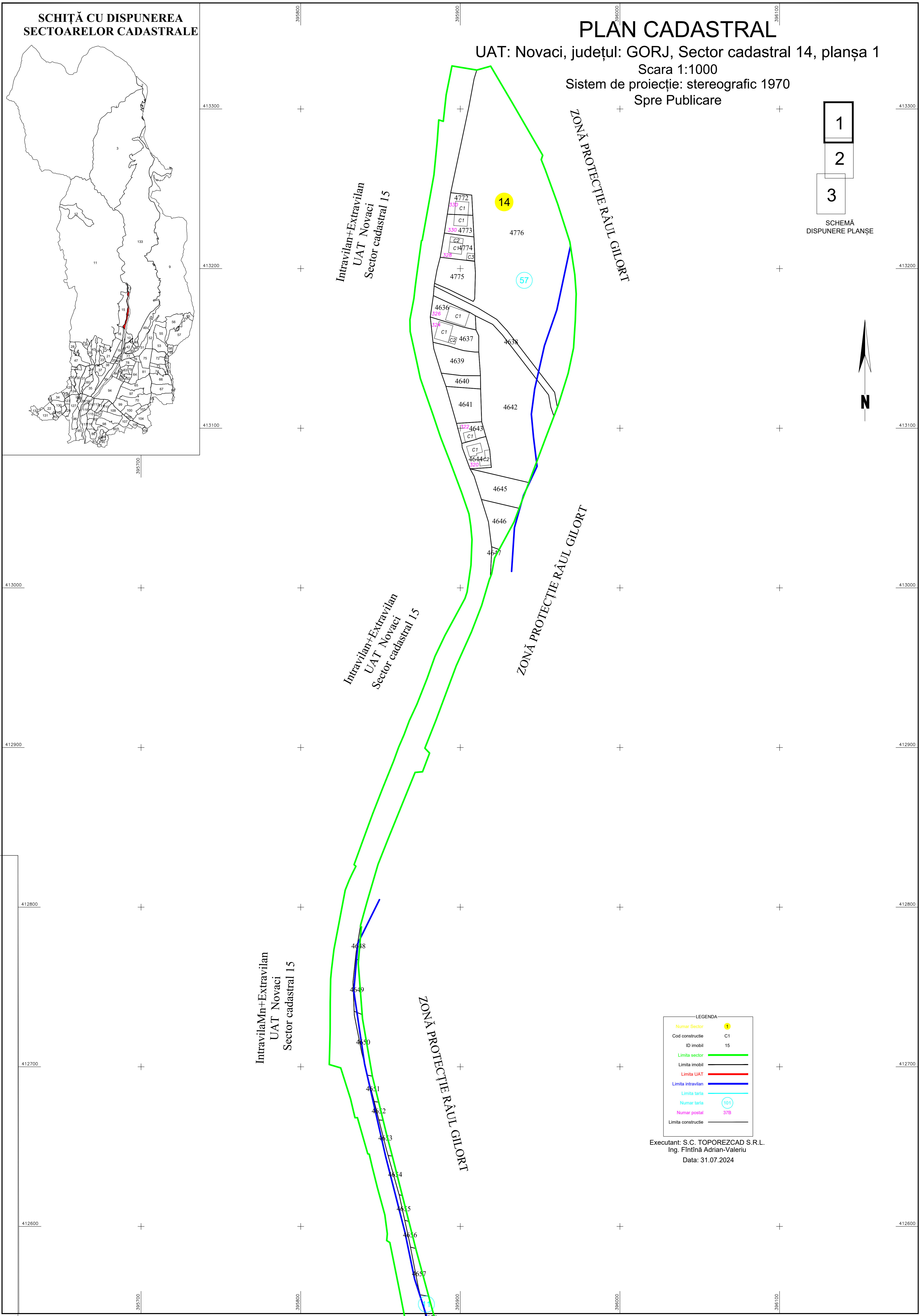

LEGENDA

Numar Sector	14
Cod constructie	C1
ID imobil	15
Limita sector	[Green line]
Limita imobil	[Black line]
Limita UAT	[Red line]
Limita intravilan	[Blue line]
Limita tarla	[Cyan line]
Numar tarla	101
Numar postal	37B
Limita constructie	[Black line]

Executant: S.C. TOPOREZCAD S.R.L.
Ing. Fintina Adrian-Valeriu
Data: 31.07.2024

PLAN CADASTRAL

UAT: Novaci, județul: GORJ, Sector cadastral 14, planșa 2

Scara 1:1000

Sistem de proiectie: stereografic 1970

Spre Publicare

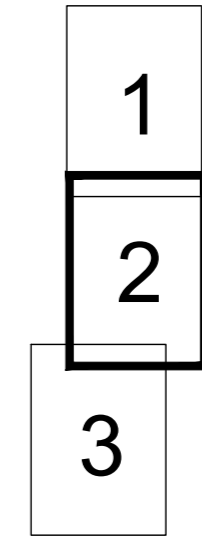

SCHEMĂ
DISPUNERE PLANȘE



Intravilan+Extravilan
UAT Novaci
Sector cadastral 15

ZONĂ PROTECȚIE RÂUL GILORT

Intravilan+Extravilan
UAT Novaci
Sector cadastral 15

ZONĂ PROTECȚIE RÂUL GILORT

Intravilan+Extravilan
UAT Novaci
Sector cadastral 15

ZONĂ PROTECȚIE RÂUL GILORT

LEGENDA	
Numar Sector	1
Cod constructie	C1
ID imobil	15
Limita sector	
Limita imobil	
Limita UAT	
Limita intravilan	
Limita tarla	
Numar tarla	101
Numar postal	37B
Limita constructie	

Executant: S.C. TOPOREZCAD S.R.L.
Ing. Fintină Adrian-Valeriu
Data: 31.07.2024

PLAN CADASTRAL

UAT: Novaci, județul: GORJ,
Sector cadastral 14, planșa 3

Scara 1:1000

Sistem de proiecție: stereografic 1970
Spre Publicare

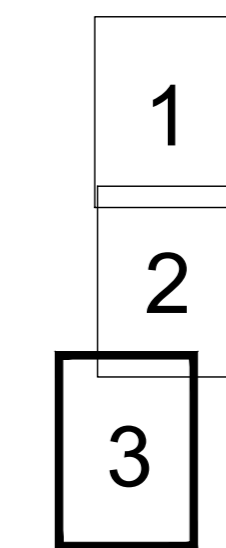

SCHEMĂ
DISPUNERE PLANȘE

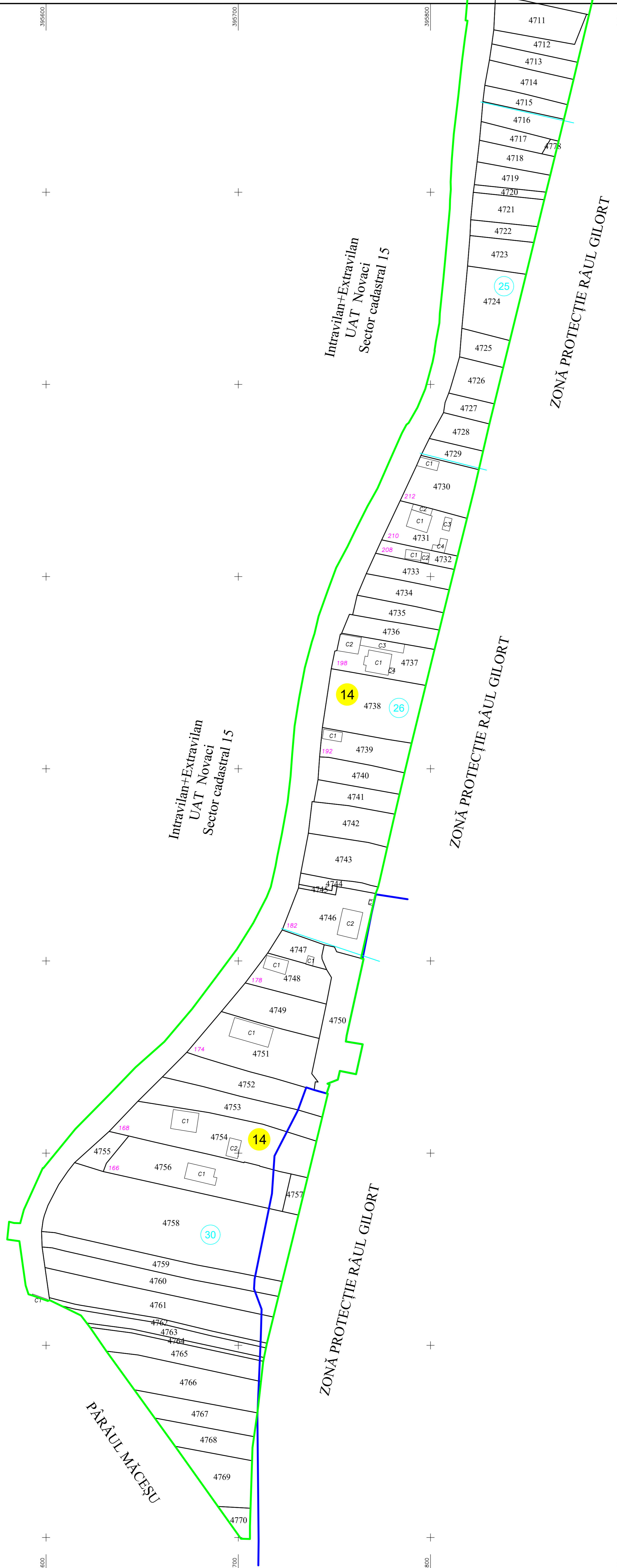

LEGENDA	
Numar Sector	1
Cod constructie	C1
ID imobil	15
Limita sector	(Green line)
Limita imobil	(Black line)
Limita UAT	(Red line)
Limita intravilan	(Blue line)
Limita tarla	(Light blue line)
Numar tarla	101
Numar postal	37B
Limita constructie	(Black line)

Executant: S.C. TOPOREZCAD S.R.L.
Ing. Fintină Adrian-Valeriu
Data: 31.07.2024