

**DATE DESPRE IMOBILUL NR. 6204**

Oficiul de Cadastru și Publicitate Imobiliară DOLJ
Biroul de Cadastru și Publicitate Imobiliară Craiova

A. Partea I. Descrierea imobilului

TEREN Necunoscut

Adresa: Loc. Vela, Jud. Dolj, DC 1524 care face legatura intre DJ 52B si DC 63.

Nr. Crt	Nr cadastral Nr. topografic	Suprafața* (mp)	Observații / Referințe
A1	31454	12.545	Sector cadastral:14 Teren neimprejmit;

B. Partea II. Proprietari și acte

Inscrieri privitoare la dreptul de proprietate și alte drepturi reale		Referințe
167161 / 09/09/2022		
Act Administrativ nr. HCL:33, din 21/07/2022 emis de CONSILIUL LOCAL VELA (act administrativ nr Anexa nr. 1 la HCL nr. 19 din 08.04.2022, emis de Consiliul Local Vela;act normativ nr Referat de legalitate nr. 8929 din 12.08.2022, emis de Institutia Prefectului - Judetul Dolj;act administrativ nr Anexa nr. 1 la HCL nr. 33 din 21.07.2022, emis de Consiliul Local Vela;act administrativ nr Hotararea nr. 19 din 08.04.2022, emis de Consiliul Local VELA;);		
B1	Intabulare, drept de PROPRIETATE, dobandit prin Lege, cota actuala 1/1, cota initiala 1/1	A1
	1) COMUNA VELA - DOMENIUL PUBLIC , CIF:99999999999999, LIPSA CUI	

C. Partea III. SARCINI .

Inscrieri privind dezmembramintele dreptului de proprietate, drepturi reale de garanție și sarcini	Referințe
NU SUNT	

Anexa Nr. 1 La Partea I

Teren

Nr cadastral	Suprafața (mp)*	Observații / Referințe
31454	12.545	

* Suprafața este determinată în planul de proiecție Stereo 70.

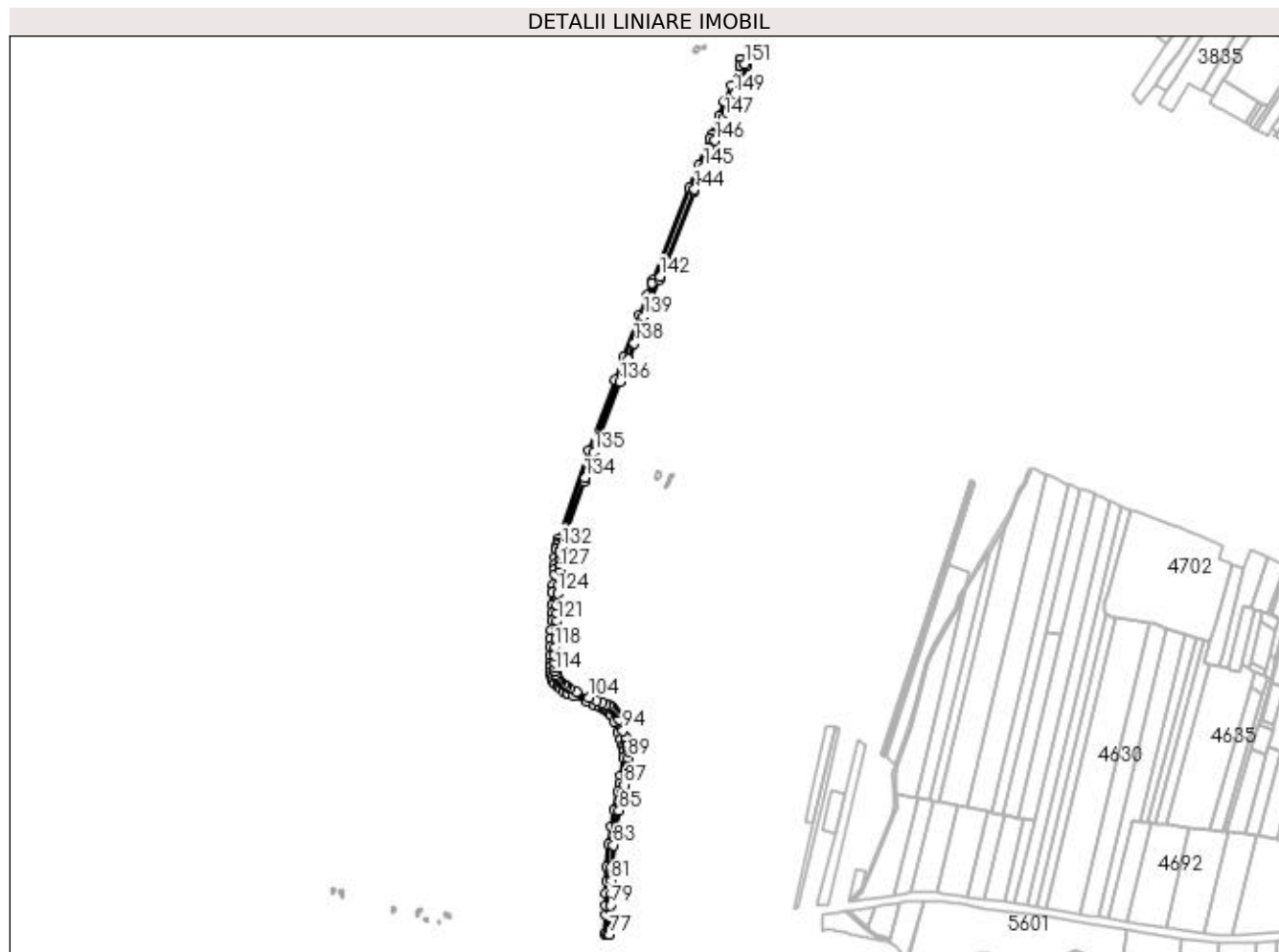

Date referitoare la teren

Crt	Categorie folosință	Intra vilan	Suprafața (mp)	Tarla	Parcelă	Nr. topo	Observații / Referințe
1	drum	DA	803			-	
2	drum	NU	11.742			-	

Lungime Segmente

1) Valorile lungimilor segmentelor sunt obținute din proiecție în plan.

Punct început	X / Y	Punct sfârșit	X / Y	Lungime segment	Punct început	X / Y	Punct sfârșit	X / Y	Lungime segment	Punct început	X / Y	Punct sfârșit	X / Y	Lungime segment
1	373.463,401 310.068,252	2	373.463,189 310.068,437	0.281	2	373.463,189 310.068,437	3	373.463,555 310.058,549	9.895	3	373.463,555 310.058,549	4	373.449,726 310.025,686	35.654
4	373.449,726 310.025,686	5	373.438,534 310.000,322	27.724	5	373.438,534 310.000,322	6	373.438,212 309.999,593	0.797	6	373.438,212 309.999,593	7	373.430,613 309.977,278	23.573
7	373.430,613 309.977,278	8	373.417,449 309.945,563	34.338	8	373.417,449 309.945,563	9	373.414,841 309.939,28	6.803	9	373.414,841 309.939,28	10	373.396,321 309.895,271	47.747
10	373.396,321 309.895,271	11	373.381,381 309.858,764	39.446	11	373.381,381 309.858,764	12	373.321,327 309.706,99	163.223	12	373.321,327 309.706,99	13	373.319,833 309.703,214	4.061

Punct început	X / Y	Punct sfârșit	X / Y	Lungime segment	Punct început	X / Y	Punct sfârșit	X / Y	Lungime segment	Punct început	X / Y	Punct sfârșit	X / Y	Lungime segment
13	373.319,833 309.703,214	14	373.311,455 309.682,04	22.771	14	373.311,455 309.682,04	15	373.298,387 309.650,715	33.942	15	373.298,387 309.650,715	16	373.272,635 309.580,385	74.896
16	373.272,635 309.580,385	17	373.258,824 309.543,629	39.265	17	373.258,824 309.543,629	18	373.216,624 309.428,567	122.557	18	373.216,624 309.428,567	19	373.167,181 309.284,132	152.663
19	373.167,181 309.284,132	20	373.165,115 309.278,098	6.378	20	373.165,115 309.278,098	21	373.163,472 309.273,298	5.073	21	373.163,472 309.273,298	22	373.161,965 309.266,502	6.961
22	373.161,965 309.266,502	23	373.160,827 309.253,759	12.794	23	373.160,827 309.253,759	24	373.160,484 309.242,861	10.903	24	373.160,484 309.242,861	25	373.160,338 309.234,646	8.216
25	373.160,338 309.234,646	26	373.159,992 309.225,543	9.11	26	373.159,992 309.225,543	27	373.158,042 309.209,087	16.571	27	373.158,042 309.209,087	28	373.156,681 309.195,409	13.746
28	373.156,681 309.195,409	29	373.156,298 309.175,35	20.063	29	373.156,298 309.175,35	30	373.156,068 309.161,91	13.442	30	373.156,068 309.161,91	31	373.156,006 309.149,541	12.369
31	373.156,006 309.149,541	32	373.155,121 309.135,129	14.439	32	373.155,121 309.135,129	33	373.153,598 309.120,459	14.749	33	373.153,598 309.120,459	34	373.153,133 309.106,61	13.857
34	373.153,133 309.106,61	35	373.152,689 309.092,372	14.245	35	373.152,689 309.092,372	36	373.152,668 309.081,011	11.361	36	373.152,668 309.081,011	37	373.152,624 309.073,451	7.56
37	373.152,624 309.073,451	38	373.153,112 309.065,814	7.653	38	373.153,112 309.065,814	39	373.154,084 309.059,717	6.174	39	373.154,084 309.059,717	40	373.155,247 309.055,429	4.443
40	373.155,247 309.055,429	41	373.157,433 309.050,076	5.782	41	373.157,433 309.050,076	42	373.160,01 309.046,237	4.624	42	373.160,01 309.046,237	43	373.164,956 309.041,581	6.793
43	373.164,956 309.041,581	44	373.169,122 309.038,371	5.259	44	373.169,122 309.038,371	45	373.174,432 309.035,123	6.225	45	373.174,432 309.035,123	46	373.180,622 309.031,66	7.093
46	373.180,622 309.031,66	47	373.191,985 309.026,121	12.641	47	373.191,985 309.026,121	48	373.213,27 309.016,953	23.175	48	373.213,27 309.016,953	49	373.225,906 309.011,947	13.591
49	373.225,906 309.011,947	50	373.234,66 309.008,327	9.473	50	373.234,66 309.008,327	51	373.240,708 309.005,86	6.532	51	373.240,708 309.005,86	52	373.244,158 309.003,978	3.93
52	373.244,158 309.003,978	53	373.247,33 309.001,699	3.906	53	373.247,33 309.001,699	54	373.249,949 308.999,227	3.601	54	373.249,949 308.999,227	55	373.251,804 308.997,175	2.766
55	373.251,804 308.997,175	56	373.253,462 308.994,709	2.972	56	373.253,462 308.994,709	57	373.257,54 308.985,455	10.113	57	373.257,54 308.985,455	58	373.264,125 308.967,151	19.452
58	373.264,125 308.967,151	59	373.268,388 308.956,09	11.854	59	373.268,388 308.956,09	60	373.271,674 308.945,774	10.827	60	373.271,674 308.945,774	61	373.272,627 308.940,874	4.992
61	373.272,627 308.940,874	62	373.273,183 308.935,301	5.601	62	373.273,183 308.935,301	63	373.272,979 308.925,78	9.523	63	373.272,979 308.925,78	64	373.268,652 308.895,964	30.128
64	373.268,652 308.895,964	65	373.266,019 308.882,855	13.371	65	373.266,019 308.882,855	66	373.263,011 308.869,259	13.925	66	373.263,011 308.869,259	67	373.257,325 308.840,539	29.277
67	373.257,325 308.840,539	68	373.252,179 308.813,369	27.653	68	373.252,179 308.813,369	69	373.248,294 308.783,278	30.341	69	373.248,294 308.783,278	70	373.245,554 308.746,894	36.487
70	373.245,554 308.746,894	71	373.244,704 308.724,228	22.682	71	373.244,704 308.724,228	72	373.244,354 308.703,282	20.949	72	373.244,354 308.703,282	73	373.243,748 308.684,144	19.148
73	373.243,748 308.684,144	74	373.243,744 308.668,756	15.388	74	373.243,744 308.668,756	75	373.242,351 308.636,594	32.192	75	373.242,351 308.636,594	76	373.246,347 308.636,421	4.0
76	373.246,347 308.636,421	77	373.250,343 308.636,248	4.0	77	373.250,343 308.636,248	78	373.251,744 308.668,582	32.364	78	373.251,744 308.668,582	79	373.251,748 308.684,016	15.434
79	373.251,748 308.684,016	80	373.252,352 308.703,088	19.082	80	373.252,352 308.703,088	81	373.252,702 308.724,012	20.927	81	373.252,702 308.724,012	82	373.253,542 308.746,438	22.442
82	373.253,542 308.746,438	83	373.256,299 308.782,448	36.115	83	373.256,299 308.782,448	84	373.260,085 308.812,117	29.91	84	373.260,085 308.812,117	85	373.265,179 308.839,017	27.378
85	373.265,179 308.839,017	86	373.270,841 308.867,617	29.155	86	373.270,841 308.867,617	87	373.273,847 308.881,203	13.915	87	373.273,847 308.881,203	88	373.276,538 308.894,6	13.665
88	373.276,538 308.894,6	89	373.280,967 308.925,118	30.838	89	373.280,967 308.925,118	90	373.281,191 308.935,613	10.497	90	373.281,191 308.935,613	91	373.280,551 308.942,038	6.457
91	373.280,551 308.942,038	92	373.279,438 308.947,758	5.827	92	373.279,438 308.947,758	93	373.275,938 308.958,744	11.53	93	373.275,938 308.958,744	94	373.271,623 308.969,943	12.002
94	373.271,623 308.969,943	95	373.264,974 308.988,427	19.644	95	373.264,974 308.988,427	96	373.260,496 308.998,583	11.099	96	373.260,496 308.998,583	97	373.258,124 309.002,113	4.253
97	373.258,124 309.002,113	98	373.255,671 309.004,827	3.658	98	373.255,671 309.004,827	99	373.252,432 309.007,883	4.453	99	373.252,432 309.007,883	100	373.248,424 309.010,764	4.936
100	373.248,424 309.010,764	101	373.244,146 309.013,098	4.873	101	373.244,146 309.013,098	102	373.237,7 309.015,727	6.962	102	373.237,7 309.015,727	103	373.228,908 309.019,363	9.514
103	373.228,908 309.019,363	104	373.216,326 309.024,347	13.533	104	373.216,326 309.024,347	105	373.195,321 309.033,395	22.871	105	373.195,321 309.033,395	106	373.184,33 309.038,752	12.227
106	373.184,33 309.038,752	107	373.178,474 309.042,029	6.711	107	373.178,474 309.042,029	108	373.173,664 309.044,971	5.638	108	373.173,664 309.044,971	109	373.170,152 309.047,677	4.434
109	373.170,152 309.047,677	110	373.166,15 309.051,445	5.497	110	373.166,15 309.051,445	111	373.164,531 309.053,856	2.904	111	373.164,531 309.053,856	112	373.162,839 309.057,999	4.475

Punct început	X / Y	Punct sfârșit	X / Y	Lungime segment	Punct început	X / Y	Punct sfârșit	X / Y	Lungime segment	Punct început	X / Y	Punct sfârșit	X / Y	Lungime segment
112	373.162,839 309.057,999	113	373.161,916 309.061,399	3.523	113	373.161,916 309.061,399	114	373.161,072 309.066,7	5.368	114	373.161,072 309.066,7	115	373.160,626 309.073,683	6.997
115	373.160,626 309.073,683	116	373.160,668 309.080,981	7.298	116	373.160,668 309.080,981	117	373.160,689 309.092,24	11.259	117	373.160,689 309.092,24	118	373.161,129 309.106,352	14.119
118	373.161,129 309.106,352	119	373.161,584 309.119,911	13.567	119	373.161,584 309.119,911	120	373.163,095 309.134,471	14.638	120	373.163,095 309.134,471	121	373.164,004 309.149,275	14.832
121	373.164,004 309.149,275	122	373.164,068 309.161,822	12.547	122	373.164,068 309.161,822	123	373.164,296 309.175,206	13.386	123	373.164,296 309.175,206	124	373.164,673 309.194,935	19.733
124	373.164,673 309.194,935	125	373.165,996 309.208,221	13.352	125	373.165,996 309.208,221	126	373.167,974 309.224,919	16.815	126	373.167,974 309.224,919	127	373.168,336 309.234,422	9.51
127	373.168,336 309.234,422	128	373.168,482 309.242,665	8.244	128	373.168,482 309.242,665	129	373.168,819 309.253,373	10.713	129	373.168,819 309.253,373	130	373.169,236 309.259,78	6.421
130	373.169,236 309.259,78	131	373.169,863 309.265,17	5.426	131	373.169,863 309.265,17	132	373.171,186 309.271,13	6.105	132	373.171,186 309.271,13	133	373.207,732 309.377,891	112.843
133	373.207,732 309.377,891	134	373.209,733 309.383,735	6.177	134	373.209,733 309.383,735	135	373.224,164 309.425,893	44.56	135	373.224,164 309.425,893	136	373.266,324 309.540,845	122.439
136	373.266,324 309.540,845	137	373.280,135 309.577,603	39.267	137	373.280,135 309.577,603	138	373.290,022 309.604,605	28.755	138	373.290,022 309.604,605	139	373.305,839 309.647,799	45.999
139	373.305,839 309.647,799	140	373.318,867 309.679,028	33.838	140	373.318,867 309.679,028	141	373.330,854 309.709,322	32.579	141	373.330,854 309.709,322	142	373.332,471 309.713,411	4.397
142	373.332,471 309.713,411	143	373.387,607 309.852,756	149.857	143	373.387,607 309.852,756	144	373.388,803 309.855,778	3.25	144	373.388,803 309.855,778	145	373.403,711 309.892,205	39.36
145	373.403,711 309.892,205	146	373.422,223 309.936,196	47.727	146	373.422,223 309.936,196	147	373.438,001 309.974,208	41.156	147	373.438,001 309.974,208	148	373.442,792 309.982,853	9.884
148	373.442,792 309.982,853	149	373.453,809 310.012,256	31.399	149	373.453,809 310.012,256	150	373.474,765 310.057,696	50.039	150	373.474,765 310.057,696	151	373.470,836 310.061,346	5.363
151	373.470,836 310.061,346	1	373.463,401 310.068,252	10.148										

** Lungimile segmentelor sunt determinate în planul de proiecție Stereo 70 și sunt rotunjite la 1 milimetru.

*** Distanța dintre puncte este formată din segmente cumulate ce sunt mai mici decât valoarea 1 milimetru.