

**DATE DESPRE IMOBILUL NR. 3876**

Oficiul de Cadastru și Publicitate Imobiliară DOLJ
Biroul de Cadastru și Publicitate Imobiliară Craiova

A. Partea I. Descrierea imobilului

TEREN Extravilan

Adresa: Jud. Dolj, DE 2416

Nr. Crt	Nr cadastral Nr. topografic	Suprafața* (mp)	Observații / Referințe
A1		2.725	Sector cadastral:16 Teren neimprejmuit; DE 2416

B. Partea II. Proprietari și acte

Inscrieri privitoare la dreptul de proprietate și alte drepturi reale		Referințe
0 / 24/10/2022		
Act Normativ nr. LEGE:7, din 13/03/1996 emis de PARLAMENTUL ROMANIEI;		
B1	Inscrierea provizorie, drept de PROPRIETATE, dobandit prin Lege, cota actuala 1/1, cota initiala 1/1 1) NEIDENTIFICAT NEIDENTIFICAT	A1

C. Partea III. SARCINI .

Inscrieri privind dezmembramintele dreptului de proprietate, drepturi reale de garanție și sarcini	Referințe
NU SUNT	

Anexa Nr. 1 La Partea I

Teren

Nr cadastral	Suprafața (mp)*	Observații / Referințe
	2.725	DE 2416

* Suprafața este determinată în planul de proiecție Stereo 70.

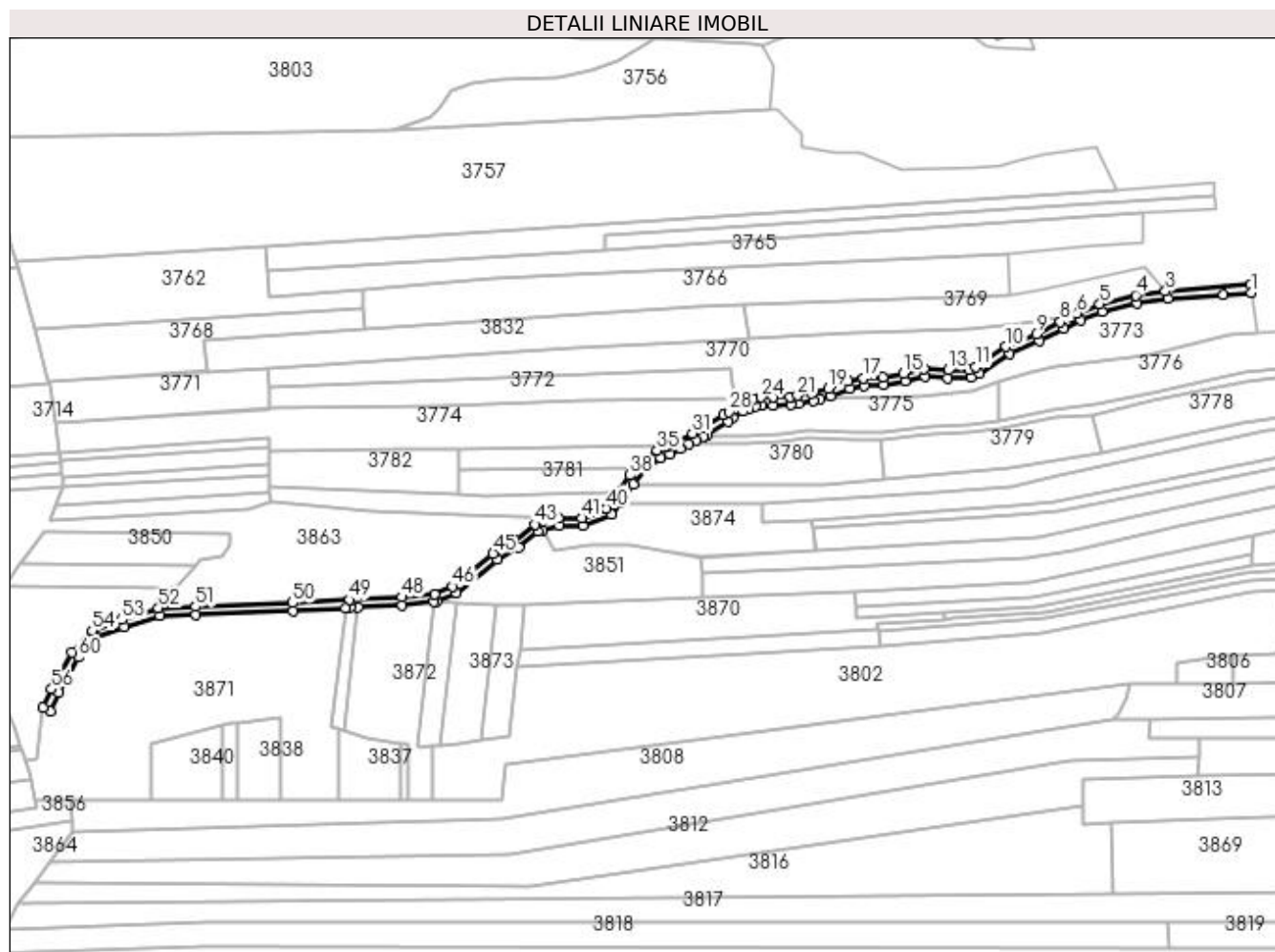

Date referitoare la teren

Crt	Categorie folosință	Intravilan	Suprafața (mp)	Tarla	Parcelă	Nr. topo	Observații / Referințe
1	drum	NU	2.725	95		-	

Lungime Segmente

1) Valorile lungimilor segmentelor sunt obținute din proiecție în plan.

Punct început	X / Y	Punct sfârșit	X / Y	Lungime segment
1	399.854,817 348.388,275	2	399.854,544 348.392,266	4.0
4	399.796,026 348.386,85	5	399.777,543 348.382,444	19.00 1
7	399.762,855 348.376,043	8	399.757,521 348.373,283	6.006
10	399.729,784 348.360,67	11	399.714,198 348.350,283	18.73
13	399.700,219 348.348,676	14	399.687,848 348.349,542	12.40 1
2	399.854,544 348.392,266	3	399.811,15 348.388,927	43.52 2
5	399.777,543 348.382,444	6	399.766,091 348.377,717	12.38 9
8	399.757,521 348.373,283	9	399.745,151 348.367,101	13.82 9
11	399.714,198 348.350,283	12	399.710,981 348.348,8	3.542
14	399.687,848 348.349,542	15	399.677,32 348.346,933	10.84 6
3	399.811,15 348.388,927	4	399.796,026 348.386,85	15.26 6
6	399.766,091 348.377,717	7	399.762,855 348.376,043	3.643
9	399.745,151 348.367,101	10	399.729,784 348.360,67	16.65 8
12	399.710,981 348.348,8	13	399.700,219 348.348,676	10.76 3
15	399.677,32 348.346,933	16	399.667,053 348.345,078	10.43 3

Punct început	X / Y	Punct sfârșit	X / Y	Lungime segment	Punct început	X / Y	Punct sfârșit	X / Y	Lungime segment	Punct început	X / Y	Punct sfârșit	X / Y	Lungime segment
16	399.667,053 348.345,078	17	399.657,032 348.344,46	10.04	17	399.657,032 348.344,46	18	399.649,115 348.343,1	8.033	18	399.649,115 348.343,1	19	399.639,066 348.339,358	10.723
19	399.639,066 348.339,358	20	399.630,538 348.336,923	8.869	20	399.630,538 348.336,923	21	399.623,29 348.335,705	7.35	21	399.623,29 348.335,705	22	399.619,558 348.335,027	3.793
22	399.619,558 348.335,027	23	399.610,665 348.334,844	8.895	23	399.610,665 348.334,844	24	399.604,757 348.334,844	5.908	24	399.604,757 348.334,844	25	399.600,676 348.334,174	4.136
25	399.600,676 348.334,174	26	399.597,082 348.332,591	3.927	26	399.597,082 348.332,591	27	399.593,664 348.331,307	3.651	27	399.593,664 348.331,307	28	399.588,243 348.327,532	6.606
28	399.588,243 348.327,532	29	399.585,563 348.325,645	3.278	29	399.585,563 348.325,645	30	399.575,33 348.319,496	11.938	30	399.575,33 348.319,496	31	399.569,587 348.316,439	6.506
31	399.569,587 348.316,439	32	399.561,546 348.311,933	9.217	32	399.561,546 348.311,933	33	399.558,975 348.310,632	2.881	33	399.558,975 348.310,632	34	399.556,613 348.309,437	2.647
34	399.556,613 348.309,437	35	399.551,614 348.307,642	5.311	35	399.551,614 348.307,642	36	399.543,512 348.302,121	9.804	36	399.543,512 348.302,121	37	399.541,185 348.299,235	3.707
37	399.541,185 348.299,235	38	399.537,86 348.295,112	5.297	38	399.537,86 348.295,112	39	399.531,845 348.286,523	10.486	39	399.531,845 348.286,523	40	399.525,83 348.278,18	10.285
40	399.525,83 348.278,18	41	399.513,109 348.273,17	13.672	41	399.513,109 348.273,17	42	399.501,398 348.273,17	11.711	42	399.501,398 348.273,17	43	399.489,136 348.270,003	12.664
43	399.489,136 348.270,003	44	399.478,819 348.261,703	13.241	44	399.478,819 348.261,703	45	399.467,908 348.255,209	12.697	45	399.467,908 348.255,209	46	399.447,197 348.238,403	26.672
46	399.447,197 348.238,403	47	399.437,895 348.234,476	10.097	47	399.437,895 348.234,476	48	399.421,272 348.232,815	16.706	48	399.421,272 348.232,815	49	399.394,694 348.231,514	26.61
49	399.394,694 348.231,514	50	399.365,609 348.229,992	29.125	50	399.365,609 348.229,992	51	399.316,075 348.228,004	49.574	51	399.316,075 348.228,004	52	399.297,04 348.227,243	19.05
52	399.297,04 348.227,243	53	399.278,463 348.221,307	19.502	53	399.278,463 348.221,307	54	399.263,217 348.215,803	16.209	54	399.263,217 348.215,803	55	399.252,863 348.204,54	15.299
55	399.252,863 348.204,54	56	399.242,492 348.185,947	21.29	56	399.242,492 348.185,947	57	399.238,228 348.176,359	10.493	57	399.238,228 348.176,359	58	399.241,883 348.174,733	4.0
58	399.241,883 348.174,733	59	399.246,074 348.184,157	10.314	59	399.246,074 348.184,157	60	399.256,126 348.202,18	20.637	60	399.256,126 348.202,18	61	399.265,498 348.212,374	13.847
61	399.265,498 348.212,374	62	399.279,751 348.217,52	15.154	62	399.279,751 348.217,52	63	399.297,742 348.223,268	18.887	63	399.297,742 348.223,268	64	399.316,235 348.224,007	18.508
64	399.316,235 348.224,007	65	399.365,794 348.225,996	49.599	65	399.365,794 348.225,996	66	399.392,475 348.227,392	26.717	66	399.392,475 348.227,392	67	399.394,896 348.227,519	2.424
67	399.394,896 348.227,519	68	399.398,971 348.227,719	4.08	68	399.398,971 348.227,719	69	399.421,569 348.228,824	22.625	69	399.421,569 348.228,824	70	399.437,873 348.230,454	16.385
70	399.437,873 348.230,454	71	399.438,894 348.230,556	1.026	71	399.438,894 348.230,556	72	399.449,276 348.234,939	11.269	72	399.449,276 348.234,939	73	399.470,203 348.251,92	26.95
73	399.470,203 348.251,92	74	399.481,107 348.258,41	12.689	74	399.481,107 348.258,41	75	399.490,971 348.266,345	12.659	75	399.490,971 348.266,345	76	399.493,311 348.266,95	2.417
76	399.493,311 348.266,95	77	399.501,906 348.269,17	8.877	77	399.501,906 348.269,17	78	399.513,869 348.269,17	11.963	78	399.513,869 348.269,17	79	399.528,388 348.274,889	15.605
79	399.528,388 348.274,889	80	399.532,695 348.280,863	7.365	80	399.532,695 348.280,863	81	399.535,106 348.284,206	4.122	81	399.535,106 348.284,206	82	399.539,356 348.290,275	7.409
82	399.539,356 348.290,275	83	399.546,254 348.299,149	11.24	83	399.546,254 348.299,149	84	399.553,446 348.304,049	8.703	84	399.553,446 348.304,049	85	399.558,198 348.305,757	5.05
85	399.558,198 348.305,757	86	399.563,428 348.308,403	5.861	86	399.563,428 348.308,403	87	399.567,817 348.310,862	5.031	87	399.567,817 348.310,862	88	399.571,504 348.312,928	4.226
88	399.571,504 348.312,928	89	399.575,281 348.314,939	4.279	89	399.575,281 348.314,939	90	399.577,301 348.316,014	2.288	90	399.577,301 348.316,014	91	399.587,747 348.322,291	12.187
91	399.587,747 348.322,291	92	399.590,537 348.324,255	3.412	92	399.590,537 348.324,255	93	399.595,539 348.327,738	6.095	93	399.595,539 348.327,738	94	399.598,593 348.328,886	3.263
94	399.598,593 348.328,886	95	399.601,824 348.330,309	3.53	95	399.601,824 348.330,309	96	399.605,083 348.330,844	3.303	96	399.605,083 348.330,844	97	399.610,706 348.330,844	5.623
97	399.610,706 348.330,844	98	399.619,96 348.331,034	9.256	98	399.619,96 348.331,034	99	399.623,979 348.331,765	4.085	99	399.623,979 348.331,765	100	399.631,421 348.333,015	7.546
100	399.631,421 348.333,015	101	399.634,944 348.334,021	3.664	101	399.634,944 348.334,021	102	399.640,315 348.335,555	5.586	102	399.640,315 348.335,555	103	399.650,161 348.339,221	10.506
103	399.650,161 348.339,221	104	399.657,496 348.340,481	7.442	104	399.657,496 348.340,481	105	399.667,533 348.341,1	10.056	105	399.667,533 348.341,1	106	399.678,157 348.343,019	10.796
106	399.678,157 348.343,019	107	399.688,198 348.345,507	10.345	107	399.688,198 348.345,507	108	399.700,102 348.344,674	11.933	108	399.700,102 348.344,674	109	399.711,881 348.344,81	11.78
109	399.711,881 348.344,81	110	399.716,156 348.346,782	4.708	110	399.716,156 348.346,782	111	399.731,683 348.357,128	18.658	111	399.731,683 348.357,128	112	399.746,819 348.363,463	16.408
112	399.746,819 348.363,463	113	399.759,334 348.369,718	13.991	113	399.759,334 348.369,718	114	399.767,776 348.374,085	9.505	114	399.767,776 348.374,085	115	399.778,777 348.378,627	11.902

Punct început	X / Y	Punct sfârșit	X / Y	Lungime segment
115	399.778,777 348.378,627	116	399.796,763 348.382,914	18.49
118	399.840,825 348.387,182	1	399.854,817 348.388,275	14.035

Punct început	X / Y	Punct sfârșit	X / Y	Lungime segment
116	399.796,763 348.382,914	117	399.812,462 348.385,371	15.89

Punct început	X / Y	Punct sfârșit	X / Y	Lungime segment
117	399.812,462 348.385,371	118	399.840,825 348.387,182	28.421

** Lungimile segmentelor sunt determinate în planul de proiecție Stereo 70 și sunt rotunjite la 1 milimetru.

*** Distanța dintre puncte este formată din segmente cumulate ce sunt mai mici decât valoarea 1 milimetru.