

**DATE DESPRE IMOBILUL NR. 3686**

Oficiul de Cadastru și Publicitate Imobiliară DOLJ
Biroul de Cadastru și Publicitate Imobiliară Craiova

A. Partea I. Descrierea imobilului

TEREN Extravilan

Adresa: Jud. Dolj, T 94

Nr. Crt	Nr cadastral Nr. topografic	Suprafața* (mp)	Observații / Referințe
A1		632.161	Sector cadastral:16 Teren neimprejmuit;

B. Partea II. Proprietari și acte

Inscrieri privitoare la dreptul de proprietate și alte drepturi reale		Referințe
0 / 24/10/2022		
Act Normativ nr. LEGE:7, din 13/03/1996 emis de PARLAMENTUL ROMANIEI;		
B1	Inscrierea provizorie, drept de PROPRIETATE, dobandit prin Lege, cota actuala 1/1, cota initiala 1/1 1) NEIDENTIFICAT NEIDENTIFICAT	A1

C. Partea III. SARCINI .

Inscrieri privind dezmembramintele dreptului de proprietate, drepturi reale de garanție și sarcini	Referințe
NU SUNT	

Anexa Nr. 1 La Partea I

Teren

Nr cadastral	Suprafața (mp)*	Observații / Referințe
	632.161	

* Suprafața este determinată în planul de proiecție Stereo 70.

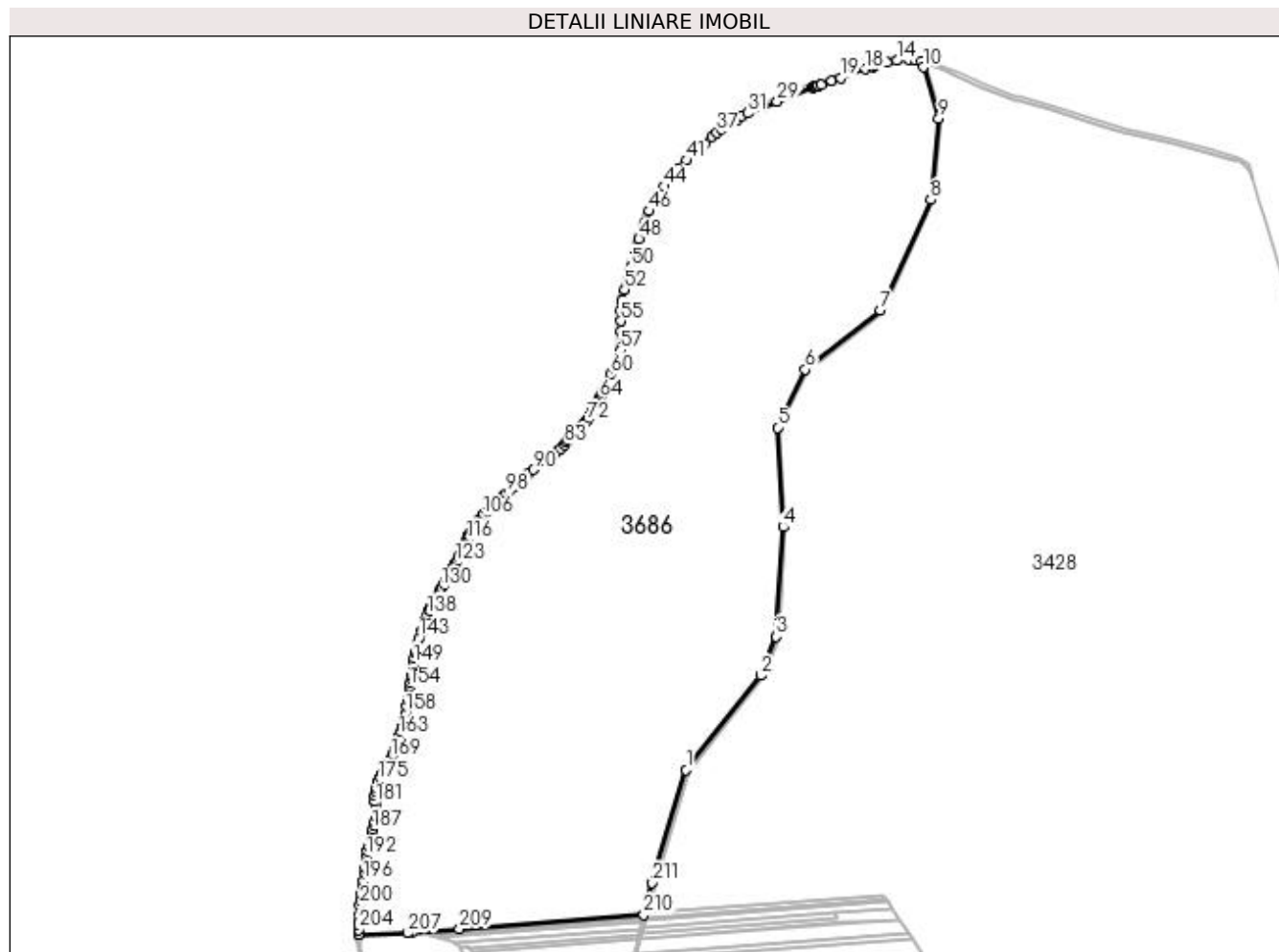

Date referitoare la teren

Crt	Categorie folosință	Intra vilan	Suprafața (mp)	Tarla	Parcelă	Nr. topo	Observații / Referințe
1	padure	NU	632.161	94		-	

Lungime Segmente

1) Valorile lungimilor segmentelor sunt obținute din proiecție în plan.

Punct început	X / Y	Punct sfârșit	X / Y	Lungime segment	Punct început	X / Y	Punct sfârșit	X / Y	Lungime segment	Punct început	X / Y	Punct sfârșit	X / Y	Lungime segment
1	398.214,077 352.027,828	2	398.337,288 352.183,441	198.485	2	398.337,288 352.183,441	3	398.362,891 352.247,063	68.58	3	398.362,891 352.247,063	4	398.374,461 352.427,74	181.047
4	398.374,461 352.427,74	5	398.364,746 352.591,604	164.152	5	398.364,746 352.591,604	6	398.410,332 352.687,334	106.03	6	398.410,332 352.687,334	7	398.534,338 352.784,712	157.67
7	398.534,338 352.784,712	8	398.617,142 352.967,035	200.245	8	398.617,142 352.967,035	9	398.630,343 353.101,009	134.623	9	398.630,343 353.101,009	10	398.605,031 353.185,352	88.059
10	398.605,031 353.185,352	11	398.602,709 353.194,553	9.489	11	398.602,709 353.194,553	12	398.590,82 353.197,142	12.168	12	398.590,82 353.197,142	13	398.580,181 353.197,53	10.646
13	398.580,181 353.197,53	14	398.561,558 353.195,883	18.696	14	398.561,558 353.195,883	15	398.544,188 353.192,684	17.662	15	398.544,188 353.192,684	16	398.524,253 353.186,694	20.815

Punct început	X / Y	Punct sfârșit	X / Y	Lungime segment	Punct început	X / Y	Punct sfârșit	X / Y	Lungime segment	Punct început	X / Y	Punct sfârșit	X / Y	Lungime segment
16	398.524,253 353.186,694	17	398.521,701 353.185,887	2.677	17	398.521,701 353.185,887	18	398.509,98 353.182,176	12.294	18	398.509,98 353.182,176	19	398.468,833 353.167,741	43.606
19	398.468,833 353.167,741	20	398.454,376 353.162,67	15.321	20	398.454,376 353.162,67	21	398.437,106 353.156,612	18.302	21	398.437,106 353.156,612	22	398.432,499 353.154,995	4.883
22	398.432,499 353.154,995	23	398.430,332 353.154,235	2.296	23	398.430,332 353.154,235	24	398.427,579 353.153,27	2.917	24	398.427,579 353.153,27	25	398.425,781 353.152,639	1.906
25	398.425,781 353.152,639	26	398.425,404 353.152,506	0.4	26	398.425,404 353.152,506	27	398.425,332 353.152,481	0.076	27	398.425,332 353.152,481	28	398.423,171 353.151,642	2.318
28	398.423,171 353.151,642	29	398.364,059 353.128,674	63.417	29	398.364,059 353.128,674	30	398.339,71 353.118,909	26.234	30	398.339,71 353.118,909	31	398.315,153 353.109,258	26.385
31	398.315,153 353.109,258	32	398.306,089 353.104,437	10.266	32	398.306,089 353.104,437	33	398.298,348 353.098,397	9.819	33	398.298,348 353.098,397	34	398.290,785 353.094,326	8.589
34	398.290,785 353.094,326	35	398.280,059 353.088,43	12.24	35	398.280,059 353.088,43	36	398.272,959 353.083,65	8.559	36	398.272,959 353.083,65	37	398.265,496 353.078,024	9.346
37	398.265,496 353.078,024	38	398.256,3 353.070,323	11.995	38	398.256,3 353.070,323	39	398.244,488 353.059,274	16.174	39	398.244,488 353.059,274	40	398.229,36 353.043,764	21.666
40	398.229,36 353.043,764	41	398.215,526 353.031,605	18.418	41	398.215,526 353.031,605	42	398.200,418 353.017,357	20.767	42	398.200,418 353.017,357	43	398.189,479 353.003,905	17.338
43	398.189,479 353.003,905	44	398.177,552 352.988,64	19.372	44	398.177,552 352.988,64	45	398.168,29 352.974,801	16.652	45	398.168,29 352.974,801	46	398.153,768 352.948,064	30.426
46	398.153,768 352.948,064	47	398.145,56 352.927,444	22.194	47	398.145,56 352.927,444	48	398.136,391 352.902,109	26.943	48	398.136,391 352.902,109	49	398.130,13 352.878,241	24.676
49	398.130,13 352.878,241	50	398.123,401 352.855,817	23.412	50	398.123,401 352.855,817	51	398.117,159 352.834,802	21.922	51	398.117,159 352.834,802	52	398.112,735 352.819,005	16.405
52	398.112,735 352.819,005	53	398.108,727 352.800,478	18.956	53	398.108,727 352.800,478	54	398.106,776 352.783,943	16.65	54	398.106,776 352.783,943	55	398.106,509 352.766,878	17.067
55	398.106,509 352.766,878	56	398.107,336 352.750,347	16.552	56	398.107,336 352.750,347	57	398.106,216 352.719,175	31.192	57	398.106,216 352.719,175	58	398.101,789 352.704,427	15.398
58	398.101,789 352.704,427	59	398.095,814 352.689,921	15.688	59	398.095,814 352.689,921	60	398.090,202 352.678,982	12.295	60	398.090,202 352.678,982	61	398.077,437 352.654,348	27.745
61	398.077,437 352.654,348	62	398.075,837 352.650,347	4.309	62	398.075,837 352.650,347	63	398.073,704 352.645,227	5.547	63	398.073,704 352.645,227	64	398.071,472 352.639,872	5.802
64	398.071,472 352.639,872	65	398.068,411 352.634,187	6.457	65	398.068,411 352.634,187	66	398.065,402 352.628,169	6.728	66	398.065,402 352.628,169	67	398.062,507 352.623,206	5.746
67	398.062,507 352.623,206	68	398.060,825 352.619,421	4.142	68	398.060,825 352.619,421	69	398.058,999 352.616,226	3.68	69	398.058,999 352.616,226	70	398.056,851 352.612,36	4.423
70	398.056,851 352.612,36	71	398.054,137 352.607,836	5.276	71	398.054,137 352.607,836	72	398.049,634 352.601,532	7.747	72	398.049,634 352.601,532	73	398.047,2 352.598,611	3.802
73	398.047,2 352.598,611	74	398.044,467 352.595,878	3.865	74	398.044,467 352.595,878	75	398.041,645 352.593,057	3.99	75	398.041,645 352.593,057	76	398.038,786 352.589,789	4.342
76	398.038,786 352.589,789	77	398.034,96 352.585,538	5.719	77	398.034,96 352.585,538	78	398.031,27 352.581,386	5.555	78	398.031,27 352.581,386	79	398.026,476 352.577,464	6.194
79	398.026,476 352.577,464	80	398.023,019 352.574,007	4.889	80	398.023,019 352.574,007	81	398.020,301 352.570,901	4.127	81	398.020,301 352.570,901	82	398.017,357 352.567,115	4.796
82	398.017,357 352.567,115	83	398.014,574 352.563,868	4.276	83	398.014,574 352.563,868	84	398.007,898 352.557,193	9.441	84	398.007,898 352.557,193	85	398.001,819 352.551,982	8.007
85	398.001,819 352.551,982	86	397.998,356 352.548,952	4.601	86	397.998,356 352.548,952	87	397.993,976 352.545,447	5.61	87	397.993,976 352.545,447	88	397.988,266 352.541,055	7.204
88	397.988,266 352.541,055	89	397.980,842 352.536,106	8.922	89	397.980,842 352.536,106	90	397.962,449 352.522,201	23.058	90	397.962,449 352.522,201	91	397.955,627 352.516,233	9.064
91	397.955,627 352.516,233	92	397.950,074 352.511,533	7.275	92	397.950,074 352.511,533	93	397.945,478 352.507,774	5.937	93	397.945,478 352.507,774	94	397.940,545 352.503,252	6.692
94	397.940,545 352.503,252	95	397.937,132 352.499,838	4.827	95	397.937,132 352.499,838	96	397.929,769 352.493,342	9.819	96	397.929,769 352.493,342	97	397.923,454 352.488,289	8.088
97	397.923,454 352.488,289	98	397.918,009 352.483,263	7.41	98	397.918,009 352.483,263	99	397.911,593 352.477,703	8.49	99	397.911,593 352.477,703	100	397.906,138 352.473,087	7.146
100	397.906,138 352.473,087	101	397.900,757 352.468,12	7.323	101	397.900,757 352.468,12	102	397.896,58 352.463,943	5.907	102	397.896,58 352.463,943	103	397.891,01 352.458,372	7.878
103	397.891,01 352.458,372	104	397.886,353 352.454,139	6.293	104	397.886,353 352.454,139	105	397.881,045 352.448,831	7.507	105	397.881,045 352.448,831	106	397.879,045 352.446,431	3.124
106	397.879,045 352.446,431	107	397.874,793 352.441,329	6.642	107	397.874,793 352.441,329	108	397.872,136 352.438,228	4.084	108	397.872,136 352.438,228	109	397.868,92 352.435,013	4.547
109	397.868,92 352.435,013	110	397.865,718 352.430,209	5.773	110	397.865,718 352.430,209	111	397.863,643 352.427,305	3.569	111	397.863,643 352.427,305	112	397.860,321 352.421,906	6.339
112	397.860,321 352.421,906	113	397.858,371 352.418,786	3.679	113	397.858,371 352.418,786	114	397.856,363 352.413,966	5.222	114	397.856,363 352.413,966	115	397.854,65 352.410,114	4.216

Punct început	X / Y	Punct sfârșit	X / Y	Lungime segment	Punct început	X / Y	Punct sfârșit	X / Y	Lungime segment	Punct început	X / Y	Punct sfârșit	X / Y	Lungime segment
115	397.854,65 352.410,114	116	397.852,885 352.406,141	4.347	116	397.852,885 352.406,141	117	397.850,76 352.402,316	4.376	117	397.850,76 352.402,316	118	397.848,679 352.397,739	5.028
118	397.848,679 352.397,739	119	397.845,745 352.391,869	6.562	119	397.845,745 352.391,869	120	397.843,61 352.386,746	5.55	120	397.843,61 352.386,746	121	397.839,76 352.379,475	8.227
121	397.839,76 352.379,475	122	397.836,817 352.373,168	6.96	122	397.836,817 352.373,168	123	397.834,58 352.368,693	5.003	123	397.834,58 352.368,693	124	397.830,675 352.362,618	7.222
124	397.830,675 352.362,618	125	397.827,4 352.357,298	6.247	125	397.827,4 352.357,298	126	397.824,912 352.352,322	5.563	126	397.824,912 352.352,322	127	397.821,975 352.346,866	6.196
127	397.821,975 352.346,866	128	397.819,015 352.340,523	7.0	128	397.819,015 352.340,523	129	397.815,485 352.333,906	7.5	129	397.815,485 352.333,906	130	397.811,242 352.327,54	7.65
130	397.811,242 352.327,54	131	397.808,821 352.323,102	5.055	131	397.808,821 352.323,102	132	397.805,765 352.316,991	6.833	132	397.805,765 352.316,991	133	397.800,967 352.310,012	8.469
133	397.800,967 352.310,012	134	397.798,542 352.306,374	4.372	134	397.798,542 352.306,374	135	397.796,121 352.301,935	5.056	135	397.796,121 352.301,935	136	397.792,734 352.295,162	7.573
136	397.792,734 352.295,162	137	397.790,33 352.290,755	5.02	137	397.790,33 352.290,755	138	397.787,883 352.283,414	7.738	138	397.787,883 352.283,414	139	397.784,889 352.275,285	8.663
139	397.784,889 352.275,285	140	397.782,831 352.269,935	5.732	140	397.782,831 352.269,935	141	397.780,762 352.262,487	7.73	141	397.780,762 352.262,487	142	397.779,012 352.256,361	6.371
142	397.779,012 352.256,361	143	397.774,335 352.244,456	12.79 1	143	397.774,335 352.244,456	144	397.771,873 352.236,66	8.176	144	397.771,873 352.236,66	145	397.770,671 352.231,853	4.955
145	397.770,671 352.231,853	146	397.769,409 352.224,285	7.673	146	397.769,409 352.224,285	147	397.768,538 352.220,361	4.02	147	397.768,538 352.220,361	148	397.766,472 352.211,27	9.323
148	397.766,472 352.211,27	149	397.765,632 352.203,293	8.021	149	397.765,632 352.203,293	150	397.763,48 352.192,105	11.39 3	150	397.763,48 352.192,105	151	397.761,791 352.183,658	8.614
151	397.761,791 352.183,658	152	397.760,973 352.179,159	4.573	152	397.760,973 352.179,159	153	397.760,142 352.172,1	7.108	153	397.760,142 352.172,1	154	397.759,293 352.164,455	7.692
154	397.759,293 352.164,455	155	397.758,004 352.154,575	9.964	155	397.758,004 352.154,575	156	397.755,875 352.143,075	11.69 5	156	397.755,875 352.143,075	157	397.754,186 352.132,94	10.27 5
157	397.754,186 352.132,94	158	397.752,053 352.120,572	12.55 1	158	397.752,053 352.120,572	159	397.750,758 352.114,528	6.181	159	397.750,758 352.114,528	160	397.749,043 352.107,241	7.486
160	397.749,043 352.107,241	161	397.746,896 352.099,081	8.438	161	397.746,896 352.099,081	162	397.744,309 352.090,457	9.004	162	397.744,309 352.090,457	163	397.741,778 352.083,285	7.605
163	397.741,778 352.083,285	164	397.740,106 352.077,437	6.082	164	397.740,106 352.077,437	165	397.738,353 352.071,738	5.963	165	397.738,353 352.071,738	166	397.735,742 352.065,209	7.032
166	397.735,742 352.065,209	167	397.733,606 352.060,084	5.552	167	397.733,606 352.060,084	168	397.731,029 352.054,07	6.543	168	397.731,029 352.054,07	169	397.727,24 352.046,071	8.851
169	397.727,24 352.046,071	170	397.724,684 352.039,682	6.881	170	397.724,684 352.039,682	171	397.722,012 352.034,337	5.976	171	397.722,012 352.034,337	172	397.719,009 352.029,19	5.959
172	397.719,009 352.029,19	173	397.714,311 352.020,647	9.75	173	397.714,311 352.020,647	174	397.710,515 352.014,742	7.02	174	397.710,515 352.014,742	175	397.707,381 352.008,867	6.659
175	397.707,381 352.008,867	176	397.705,349 352.002,364	6.813	176	397.705,349 352.002,364	177	397.703,684 351.997,787	4.87	177	397.703,684 351.997,787	178	397.702,107 351.991,871	6.123
178	397.702,107 351.991,871	179	397.701,335 351.985,699	6.22	179	397.701,335 351.985,699	180	397.701,732 351.976,183	9.524	180	397.701,732 351.976,183	181	397.702,573 351.971,977	4.289
181	397.702,573 351.971,977	182	397.703,018 351.963,962	8.027	182	397.703,018 351.963,962	183	397.703,018 351.957,078	6.884	183	397.703,018 351.957,078	184	397.703,018 351.950,821	6.257
184	397.703,018 351.950,821	185	397.701,642 351.942,564	8.371	185	397.701,642 351.942,564	186	397.699,899 351.937,332	5.515	186	397.699,899 351.937,332	187	397.698,222 351.930,628	6.911
187	397.698,222 351.930,628	188	397.696,128 351.923,508	7.422	188	397.696,128 351.923,508	189	397.694,035 351.913,464	10.26	189	397.694,035 351.913,464	190	397.691,478 351.902,38	11.37 5
190	397.691,478 351.902,38	191	397.689,405 351.894,091	8.544	191	397.689,405 351.894,091	192	397.688,202 351.885,263	8.91	192	397.688,202 351.885,263	193	397.688,202 351.876,737	8.526
193	397.688,202 351.876,737	194	397.686,466 351.866,321	10.56	194	397.686,466 351.866,321	195	397.685,191 351.856,548	9.856	195	397.685,191 351.856,548	196	397.683,062 351.845,048	11.69 5
196	397.683,062 351.845,048	197	397.681,374 351.834,924	10.26 4	197	397.681,374 351.834,924	198	397.679,282 351.822,371	12.72 6	198	397.679,282 351.822,371	199	397.678,439 351.813,104	9.305
199	397.678,439 351.813,104	200	397.677,173 351.804,237	8.957	200	397.677,173 351.804,237	201	397.675,918 351.788,347	15.93 9	201	397.675,918 351.788,347	202	397.675,489 351.778,484	9.872
202	397.675,489 351.778,484	203	397.674,669 351.772,743	5.799	203	397.674,669 351.772,743	204	397.675,073 351.764,672	8.081	204	397.675,073 351.764,672	205	397.675,493 351.757,119	7.565
205	397.675,493 351.757,119	206	397.675,506 351.756,955	0.165	206	397.675,506 351.756,955	207	397.756,05 351.759,229	80.57 6	207	397.756,05 351.759,229	208	397.762,374 351.758,9	6.333
208	397.762,374 351.758,9	209	397.840,745 351.765,536	78.65 1	209	397.840,745 351.765,536	210	398.144,734 351.789,046	304.8 97	210	398.144,734 351.789,046	211	398.158,516 351.841,354	54.09 3
211	398.158,516 351.841,354	1	398.214,077 352.027,828	194.5 75										

**** Lungimile segmentelor sunt determinate în planul de proiecție Stereo 70 și sunt rotunjite la 1 milimetru.**

***** Distanța dintre puncte este formată din segmente cumulate ce sunt mai mici decât valoarea 1 milimetru.**