

**DATE DESPRE IMOBILUL NR. 3362**

Oficiul de Cadastru și Publicitate Imobiliară DOLJ
Biroul de Cadastru și Publicitate Imobiliară Craiova

A. Partea I. Descrierea imobilului

TEREN Extravilan

Adresa: Jud. Dolj, T 93

Nr. Crt	Nr cadastral Nr. topografic	Suprafața* (mp)	Observații / Referințe
A1		43.720	Sector cadastral:16 Teren neimprejmuit;

B. Partea II. Proprietari și acte

Inscrieri privitoare la dreptul de proprietate și alte drepturi reale		Referințe
0 / 24/10/2022		
Act Normativ nr. LEGE:7, din 13/03/1996 emis de PARLAMENTUL ROMANIEI;		
B1	Inscrierea provizorie, drept de PROPRIETATE, dobandit prin Lege, cota actuala 1/1, cota initiala 1/1 1) NEIDENTIFICAT NEIDENTIFICAT	A1

C. Partea III. SARCINI .

Inscrieri privind dezmembramintele dreptului de proprietate, drepturi reale de garanție și sarcini	Referințe
NU SUNT	

Anexa Nr. 1 La Partea I

Teren

Nr cadastral	Suprafața (mp)*	Observații / Referințe
	43.720	

* Suprafața este determinată în planul de proiecție Stereo 70.

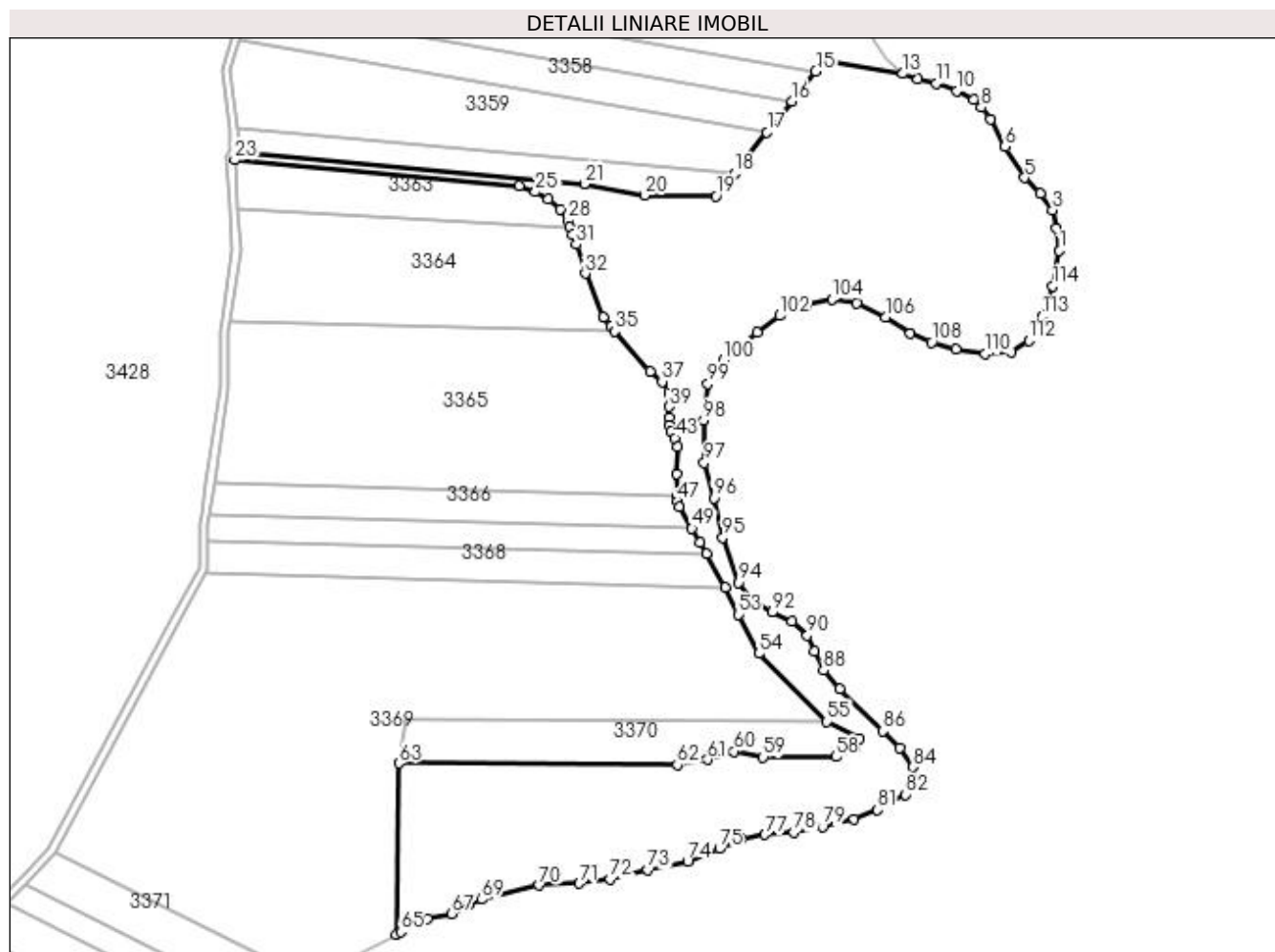

Date referitoare la teren

Crt	Categorie folosință	Intravilan	Suprafața (mp)	Tarla	Parcelă	Nr. topo	Observații / Referințe
1	neproductiv	NU	43.720	93		-	

Lungime Segmente

1) Valorile lungimilor segmentelor sunt obținute din proiecție în plan.

Punct început	X / Y	Punct sfârșit	X / Y	Lungime segment	Punct început	X / Y	Punct sfârșit	X / Y	Lungime segment	Punct început	X / Y	Punct sfârșit	X / Y	Lungime segment
1	400.860,557 349.103,823	2	400.858,86 349.115,326	11.628	2	400.858,86 349.115,326	3	400.856,972 349.124,754	9.615	3	400.856,972 349.124,754	4	400.850,747 349.133,24	10.524
4	400.850,747 349.133,24	5	400.842,633 349.141,348	11.471	5	400.842,633 349.141,348	6	400.832,522 349.157,323	18.906	6	400.832,522 349.157,323	7	400.825,164 349.171,466	15.943
7	400.825,164 349.171,466	8	400.820,258 349.177,5	7.777	8	400.820,258 349.177,5	9	400.816,484 349.181,46	5.47	9	400.816,484 349.181,46	10	400.807,616 349.185,986	9.956
10	400.807,616 349.185,986	11	400.797,239 349.189,757	11.041	11	400.797,239 349.189,757	12	400.787,805 349.191,831	9.659	12	400.787,805 349.191,831	13	400.780,069 349.194,849	8.304
13	400.780,069 349.194,849	14	400.739,294 349.201,061	41.245	14	400.739,294 349.201,061	15	400.735,284 349.196,035	6.43	15	400.735,284 349.196,035	16	400.722,947 349.180,578	19.777

Punct început	X / Y	Punct sfârșit	X / Y	Lungime segment	Punct început	X / Y	Punct sfârșit	X / Y	Lungime segment	Punct început	X / Y	Punct sfârșit	X / Y	Lungime segment
16	400.722,947 349.180,578	17	400.710,248 349.164,666	20.358	17	400.710,248 349.164,666	18	400.693,446 349.143,612	26.937	18	400.693,446 349.143,612	19	400.684,085 349.131,884	15.006
19	400.684,085 349.131,884	20	400.647,223 349.132,282	36.864	20	400.647,223 349.132,282	21	400.616,375 349.138,214	31.413	21	400.616,375 349.138,214	22	400.440,159 349.154,19	176.939
22	400.440,159 349.154,19	23	400.436,619 349.150,495	5.117	23	400.436,619 349.150,495	24	400.582,906 349.137,232	146.887	24	400.582,906 349.137,232	25	400.591,143 349.134,086	8.817
25	400.591,143 349.134,086	26	400.597,823 349.130,162	7.747	26	400.597,823 349.130,162	27	400.603,941 349.124,913	8.061	27	400.603,941 349.124,913	28	400.607,765 349.119,511	6.619
28	400.607,765 349.119,511	29	400.608,845 349.116,156	3.525	29	400.608,845 349.116,156	30	400.610,118 349.112,199	4.157	30	400.610,118 349.112,199	31	400.612,158 349.107,154	5.442
31	400.612,158 349.107,154	32	400.616,822 349.092,227	15.639	32	400.616,822 349.092,227	33	400.626,19 349.069,884	24.227	33	400.626,19 349.069,884	34	400.629,806 349.064,792	6.245
34	400.629,806 349.064,792	35	400.631,83 349.062,499	3.059	35	400.631,83 349.062,499	36	400.650,065 349.041,831	27.562	36	400.650,065 349.041,831	37	400.656,297 349.036,654	8.102
37	400.656,297 349.036,654	38	400.659,874 349.030,426	7.182	38	400.659,874 349.030,426	39	400.660,078 349.023,802	6.627	39	400.660,078 349.023,802	40	400.659,976 349.018,298	5.505
40	400.659,976 349.018,298	41	400.659,874 349.014,018	4.281	41	400.659,874 349.014,018	42	400.661,048 349.011,112	3.134	42	400.661,048 349.011,112	43	400.662,908 349.007,737	3.854
43	400.662,908 349.007,737	44	400.664,464 349.003,07	4.92	44	400.664,464 349.003,07	45	400.663,964 348.989,355	13.724	45	400.663,964 348.989,355	46	400.664,249 348.977,939	11.42
46	400.664,249 348.977,939	47	400.664,317 348.975,239	2.701	47	400.664,317 348.975,239	48	400.665,019 348.972,178	3.14	48	400.665,019 348.972,178	49	400.671,588 348.961,226	12.771
49	400.671,588 348.961,226	50	400.675,91 348.954,018	8.404	50	400.675,91 348.954,018	51	400.679,066 348.948,345	6.492	51	400.679,066 348.948,345	52	400.688,712 348.931,007	19.841
52	400.688,712 348.931,007	53	400.695,369 348.917,001	15.508	53	400.695,369 348.917,001	54	400.706,084 348.897,054	22.643	54	400.706,084 348.897,054	55	400.741,083 348.861,941	49.577
55	400.741,083 348.861,941	56	400.757,628 348.853,181	18.721	56	400.757,628 348.853,181	57	400.755,588 348.848,722	4.903	57	400.755,588 348.848,722	58	400.745,518 348.844,008	11.119
58	400.745,518 348.844,008	59	400.708,298 348.843,753	37.221	59	400.708,298 348.843,753	60	400.693,118 348.846,667	15.457	60	400.693,118 348.846,667	61	400.679,734 348.842,591	13.991
61	400.679,734 348.842,591	62	400.664,15 348.839,834	15.826	62	400.664,15 348.839,834	63	400.521,127 348.840,547	143.025	63	400.521,127 348.840,547	64	400.519,667 348.752,744	87.815
64	400.519,667 348.752,744	65	400.521,884 348.753,97	2.533	65	400.521,884 348.753,97	66	400.535,845 348.760,758	15.524	66	400.535,845 348.760,758	67	400.548,11 348.763,398	12.546
67	400.548,11 348.763,398	68	400.556,6 348.767,924	9.621	68	400.556,6 348.767,924	69	400.563,581 348.770,752	7.532	69	400.563,581 348.770,752	70	400.593,129 348.777,946	30.411
70	400.593,129 348.777,946	71	400.613,695 348.778,889	20.588	71	400.613,695 348.778,889	72	400.629,544 348.780,963	15.984	72	400.629,544 348.780,963	73	400.648,79 348.785,866	19.861
73	400.648,79 348.785,866	74	400.669,355 348.790,203	21.017	74	400.669,355 348.790,203	75	400.685,77 348.796,803	17.692	75	400.685,77 348.796,803	76	400.697,091 348.801,706	12.337
76	400.697,091 348.801,706	77	400.709,166 348.803,969	12.285	77	400.709,166 348.803,969	78	400.723,883 348.805,1	14.76	78	400.723,883 348.805,1	79	400.738,789 348.807,929	15.172
79	400.738,789 348.807,929	80	400.755,016 348.811,888	16.703	80	400.755,016 348.811,888	81	400.767,058 348.816,666	12.955	81	400.767,058 348.816,666	82	400.781,209 348.824,586	16.217
82	400.781,209 348.824,586	83	400.785,737 348.830,809	7.696	83	400.785,737 348.830,809	84	400.785,36 348.838,729	7.929	84	400.785,36 348.838,729	85	400.778,567 348.848,535	11.929
85	400.778,567 348.848,535	86	400.769,7 348.857,209	12.404	86	400.769,7 348.857,209	87	400.747,732 348.878,804	30.805	87	400.747,732 348.878,804	88	400.739,241 348.888,421	12.829
88	400.739,241 348.888,421	89	400.734,713 348.898,227	10.801	89	400.734,713 348.898,227	90	400.730,939 348.906,335	8.943	90	400.730,939 348.906,335	91	400.723,015 348.913,501	10.684
91	400.723,015 348.913,501	92	400.712,827 348.918,215	11.226	92	400.712,827 348.918,215	93	400.702,072 348.924,815	12.619	93	400.702,072 348.924,815	94	400.695,657 348.933,489	10.788
94	400.695,657 348.933,489	95	400.687,521 348.956,61	24.511	95	400.687,521 348.956,61	96	400.682,804 348.976,787	20.721	96	400.682,804 348.976,787	97	400.677,898 348.994,89	18.756
97	400.677,898 348.994,89	98	400.677,521 349.016,764	21.877	98	400.677,521 349.016,764	99	400.679,785 349.035,432	18.805	99	400.679,785 349.035,432	100	400.687,898 349.047,5	14.542
100	400.687,898 349.047,5	101	400.705,086 349.061,96	22.461	101	400.705,086 349.061,96	102	400.716,785 349.070,446	14.453	102	400.716,785 349.070,446	103	400.730,18 349.075,726	14.398
103	400.730,18 349.075,726	104	400.743,577 349.078,931	13.775	104	400.743,577 349.078,931	105	400.756,407 349.076,857	12.997	105	400.756,407 349.076,857	106	400.771,312 349.069,88	16.457
106	400.771,312 349.069,88	107	400.783,954 349.061,583	15.122	107	400.783,954 349.061,583	108	400.794,897 349.056,869	11.915	108	400.794,897 349.056,869	109	400.807,351 349.053,286	12.959
109	400.807,351 349.053,286	110	400.822,445 349.050,835	15.292	110	400.822,445 349.050,835	111	400.835,652 349.051,966	13.255	111	400.835,652 349.051,966	112	400.844,708 349.057,812	10.779
112	400.844,708 349.057,812	113	400.851,501 349.070,069	14.014	113	400.851,501 349.070,069	114	400.857,162 349.085,72	16.643	114	400.857,162 349.085,72	1	400.860,557 349.103,823	18.419

**** Lungimile segmentelor sunt determinate în planul de proiecție Stereo 70 și sunt rotunjite la 1 milimetru.**

***** Distanța dintre puncte este formată din segmente cumulate ce sunt mai mici decât valoarea 1 milimetru.**