

PLAN CADASTRAL  
=COPIE SPRE PUBLICARE=

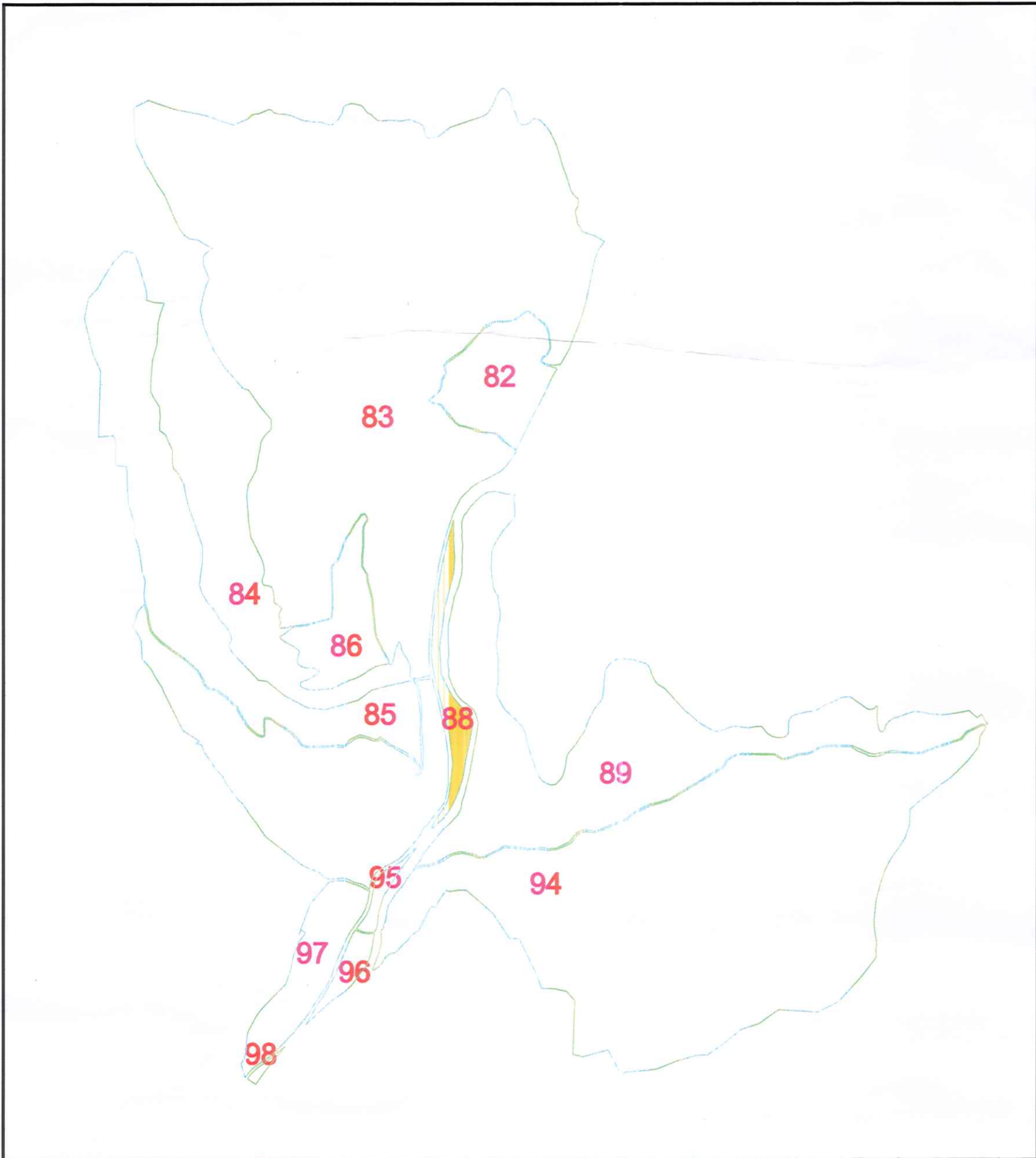

U.A.T: Rodna  
JUDEȚUL: BISTRIȚA-NĂȘĂUD  
Sector cadastral nr. 88



DISPUNEREA SECTOARELOR CADASTRALE  
PROIECȚIE STEREOGRAFICĂ 1970

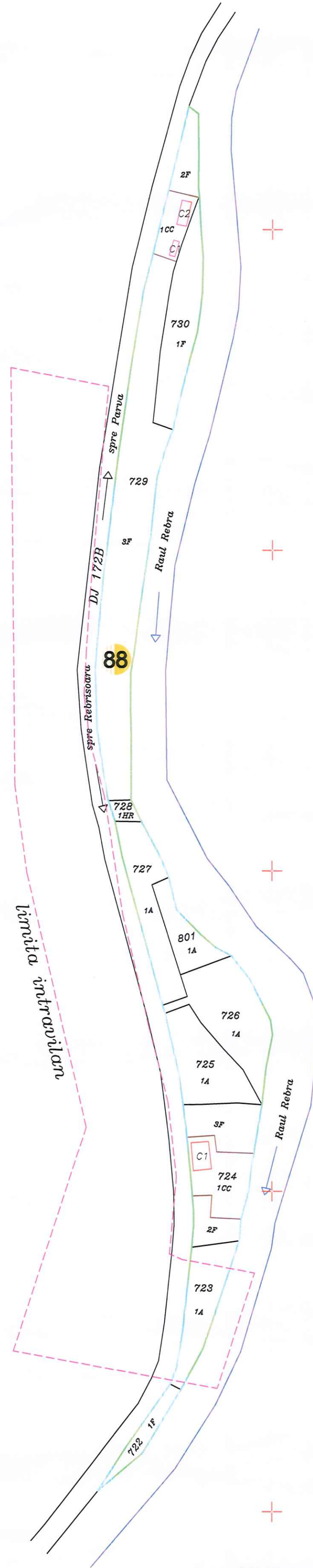

- 725 - Identificator
- 1A - Categorie de folosinta
- C 1 - Nr. constructie
- 88 - Sector Cadastral
- [Solid line] - limita teren
- [Dashed line] - limita parcela
- [Red outline] - Constructie
- [Green outline] - limita Sector cadastral
- [Red dashed line] - limita intravilan
- [Blue dashed line] - Hidrografie

Executant:

SC Topo Construct Solution SRL . Clasa III, seria RO-B-J, nr. 2195/07.10.2021  
reprezentata prin Ing. Poenar Ioan-Mihai( certificat de autorizare Cat. B, Seria RO-BN-F, Nr. 0126)



CONTRASEMNEAZĂ  
DANCI STEFAN  
PRIMARUL COMUNEI REBRA



Scara 1:2000  
Data: Mai, 2022