

PLAN CADASTRAL
=COPIE SPRE PUBLICARE=

U.A.T: Cetate
JUDEȚUL: BISTRIȚA-NĂSAUD
Sector cadastral nr. 143

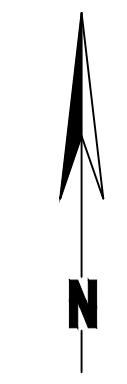

DISPUNEREA SECTOARELOR CADASTRALE
PROIECȚIE STEREOGRAFICĂ 1970

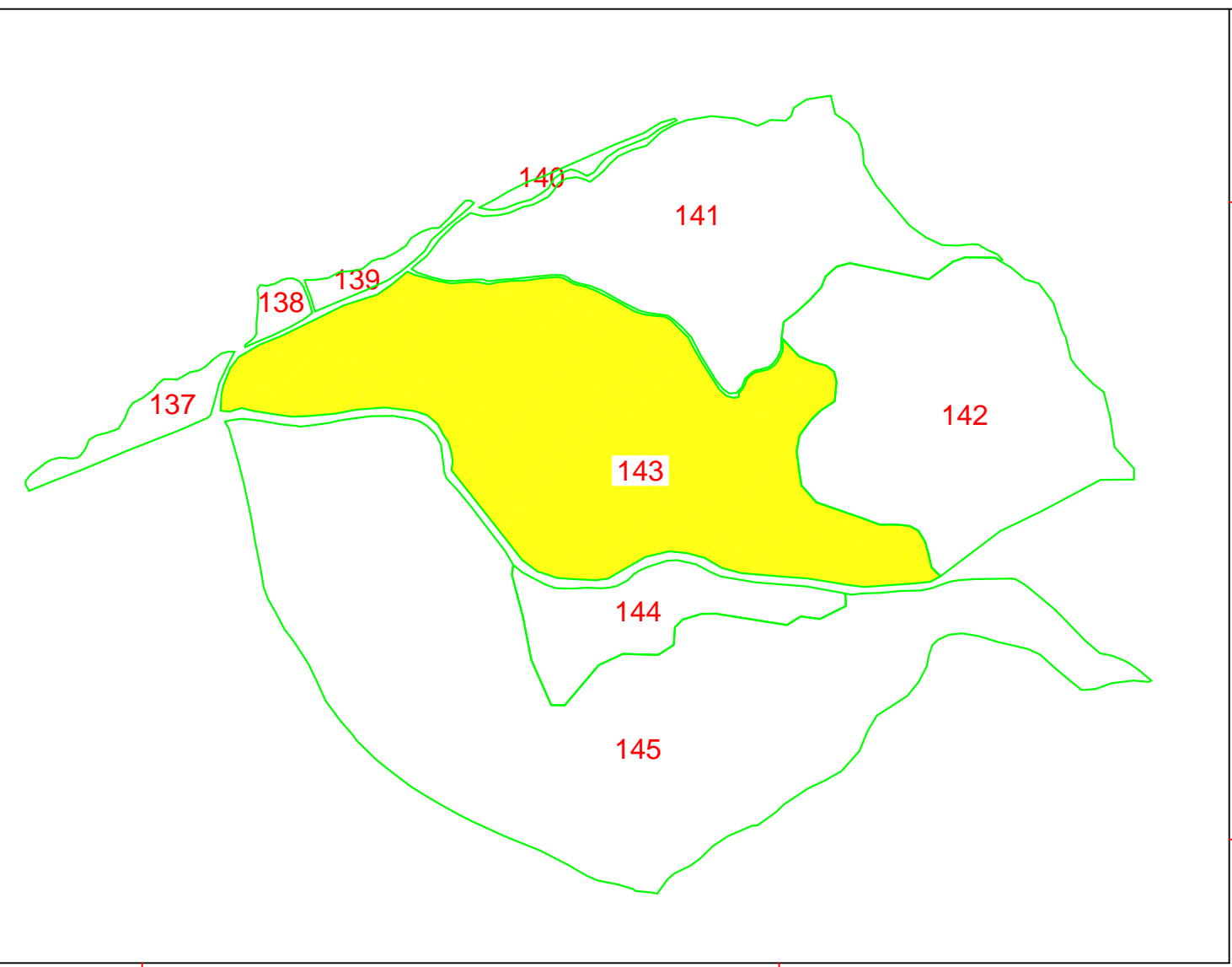
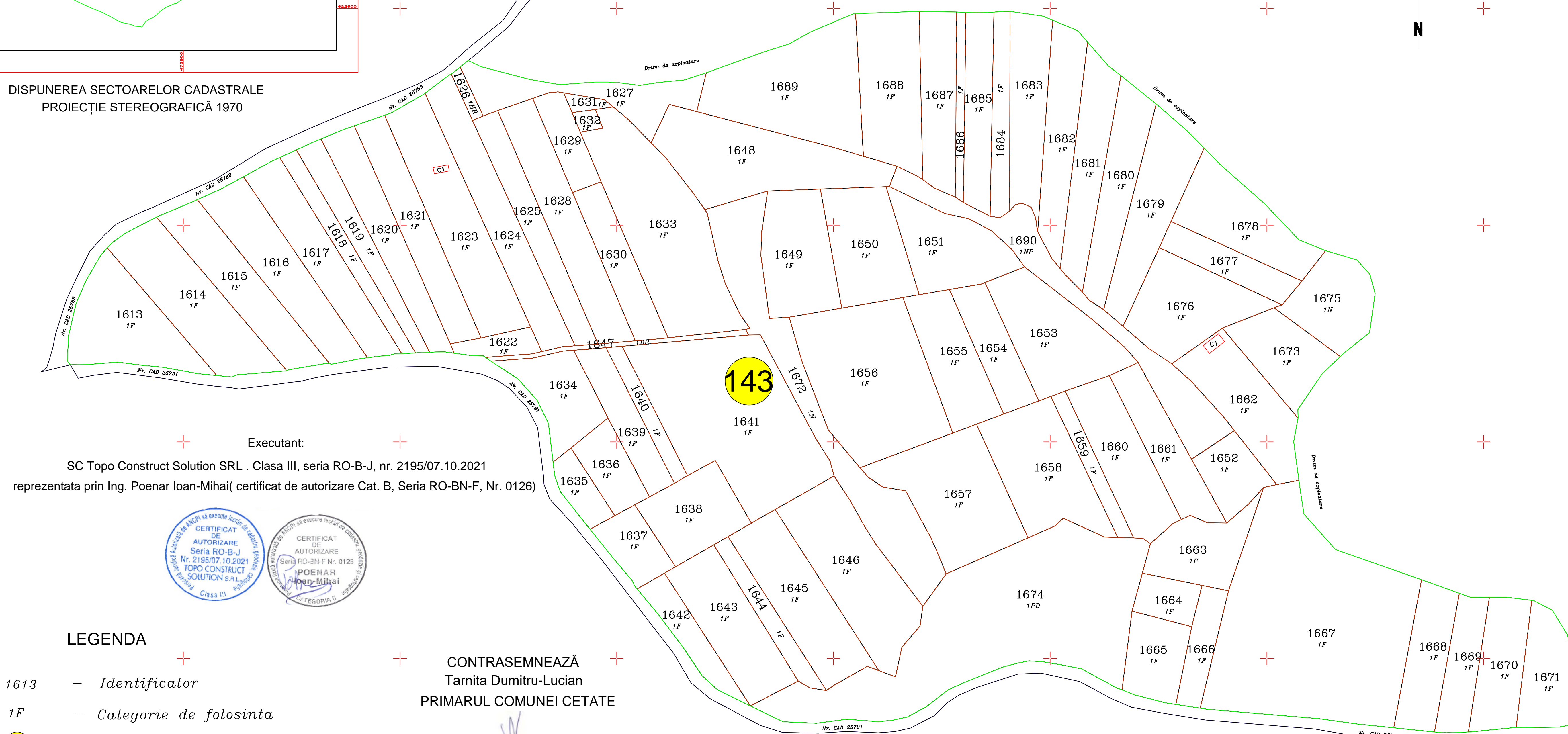

Executant:
SC Topo Construct Solution SRL . Clasa III, seria RO-B-J, nr. 2195/07.10.2021
reprezentata prin Ing. Poenar Ioan-Mihai(certificat de autorizare Cat. B, Seria RO-BN-F, Nr. 0126)



LEGENDA

- 1613 - Identificator
- 1F - Categorie de folosinta
- 143 - Sector Cadastral
- [Solid line] - limita teren
- [Dashed line] - limita parcela
- [Red outline] - Constructie
- [Green outline] - limita Sector cadastral

CONTRASEMNEAZĂ
Tarnita Dumitru-Lucian
PRIMARUL COMUNEI CETATE

